

DWG. NO.

GGD94 | BL1

BILL OF MATERIALS

LETTER	QTY	DESCRIPTION
A	1	GRILL - GGD-94 BL1
B	1	DRIVER'S SIDE TOP MOUNTING BRACKET
C	1	PASSENGER'S SIDE TOP MOUNTING BRACKET
D	1	DRIVER BOTTOM MOUNTING BRACKET
E	1	PASSENGER BOTTOM MOUNTING BRACKET
F	6	#5 - 1/2"-13 X 1 1/2" HEX HEAD BOLT
G	6	#5 - 1/2" L.W. (NOT SHOWN)
H	12	#5 - 1/2" x 1 3/8" O.D. F.W. (NOT SHOWN)
I	6	#5 - 1/2"-13 NUT (NOT SHOWN)

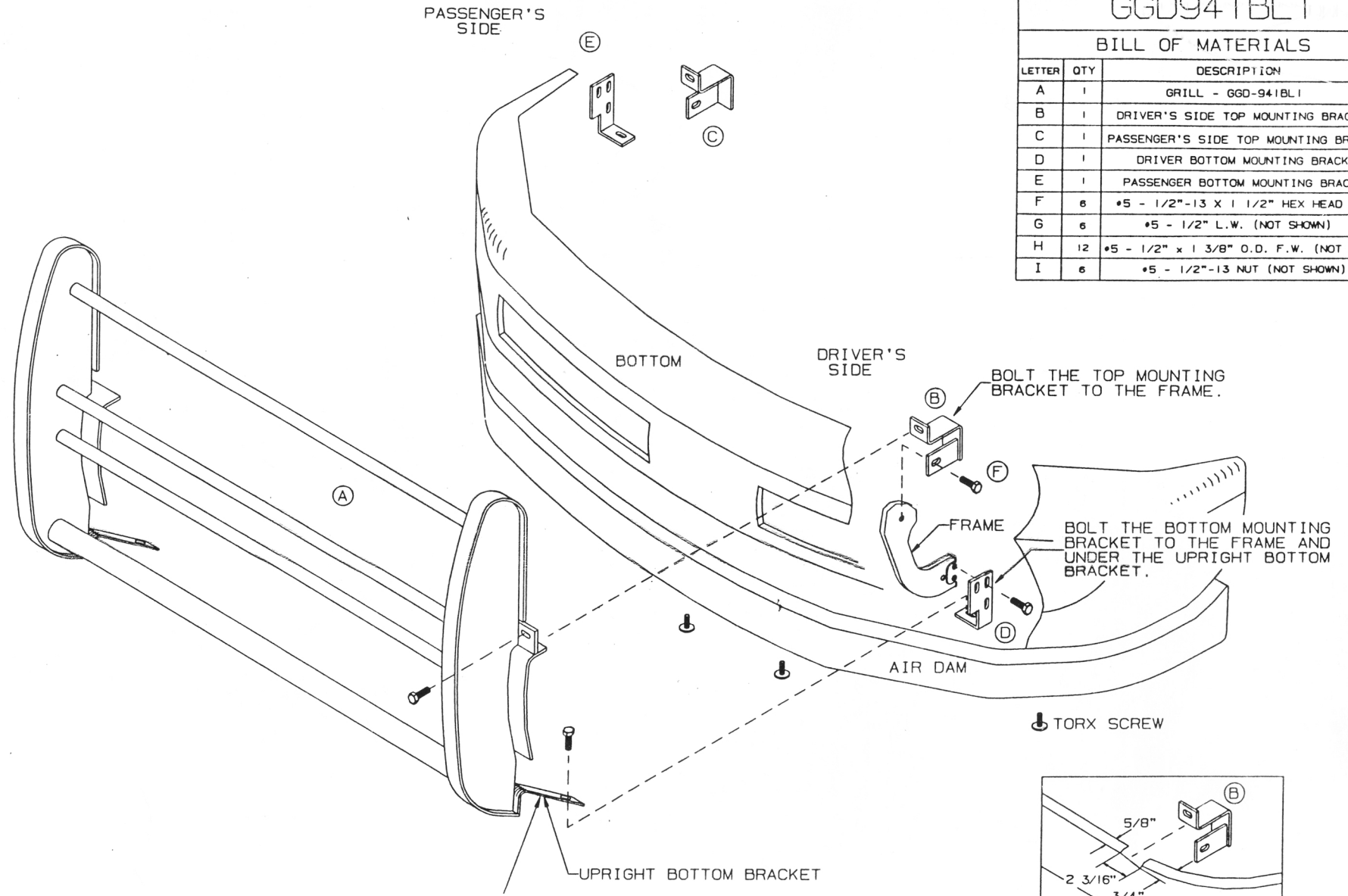

THE UPRIGHT BOTTOM BRACKET FITS BETWEEN THE BUMPER & THE AIR DAM.

TORX SCREW

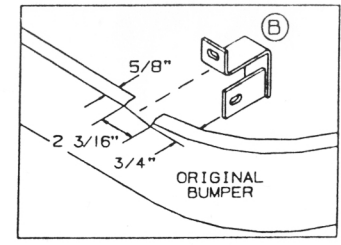

DO NOT SCALE PRINT

F						DR. TRP 8-15-00	KASPAR WIRE WORKS, INC.	
E						C-KD.		
D						SCALE: NTS		
C						APPROVED		
B	ADDED FACTORY BUMPER AND AIR DAM	CAB	3-1-01	KRH			NAME: 94 DODGE GRILL GUARD	
A	LICENSE PLATE HOLDER DELETED	TRP	10-24-00	GGD94BL1			MOUNTING INSTRUCTIONS	
LET.	REVISIONS		DATE	USED ON	REQ.	SUPERSEDES:	MATL:	
							DIMENSIONAL TOLERANCES : FRACTION ±.010; DECIMAL ±.005 UNLESS OTHERWISE SPECIFIED	