

Installation Instructions

2018+ Jeep Wrangler JL



I-TC-05
Part Number
741035 & 741135

Pre-Installation Requirements

NOTE: Actual application may vary slightly from illustrations.



- For correct installation, mounting surface of part should be between 70-95° F (21-35° C) prior to installation
- Remove existing hard or soft top. For OEM (original/factory) soft tops, also remove: Windshield header channel, Tube hardware, side door surrounds, tailgate bar and tailgate clips will be re-used with this tonneau cover.

Installation Steps

Lay the Tonneau cover loosely over the rear of the vehicle tub. If you also have the optional Wind Breaker then zip the tonneau cover to the wind breaker. If not then proceed to Step 2.

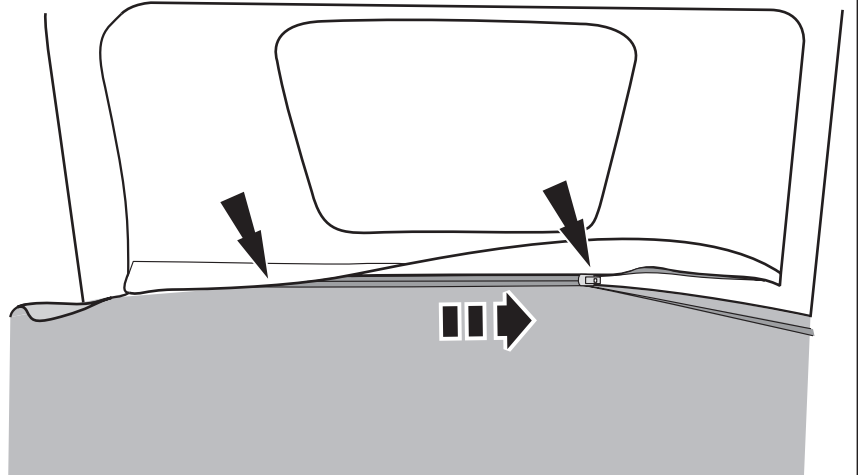

1

Install the tailgate mounts on both rear corners of the tub.



2

Slide the tailgate bar onto the rear tonneau, using the built-in C-channel to guide it over the the flap and small tube.
Rotate tailgate bar down into both tailgate mounts.



3

Tuck plastic strip into belt rail of vehicle body. It works best to start from the front and work your way back towards the rear.

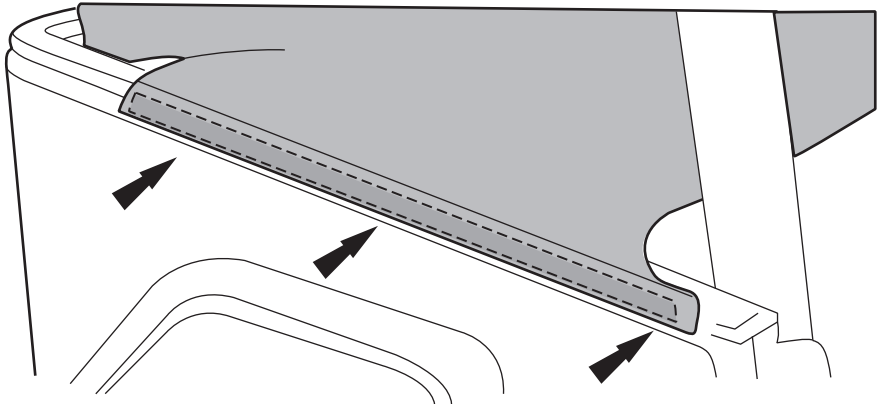

4

Tuck the plastic strip into the belt rail of the tub at the rear corners tailight area.

To tighten, go to the front of each side and pull the cover back toward the rear seats.

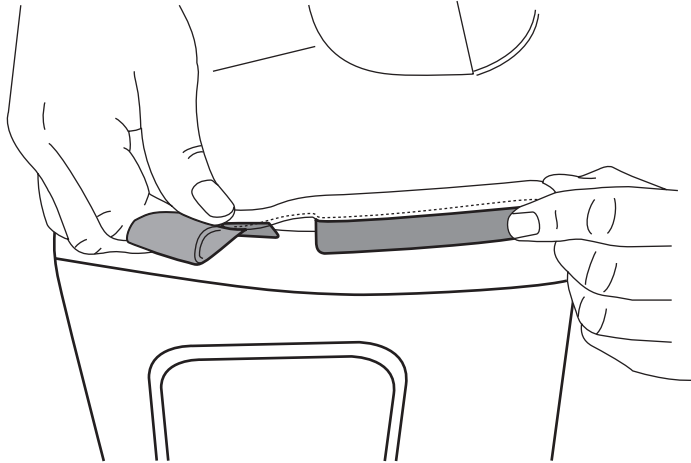

5

Connect the hook and loop collar flaps around the roll bar. Be sure to pull the seat belt inside here as well, but make sure the seat belt can still move freely.



6

Care and Cleaning

- Wash only with mild soap & dry with a clean cloth.
- Do not use cleaning solvents of any kind.

Congratulations!

Your new Tonneau Cover are installed! Now go enjoy the ride.

Thank you for purchasing one of the many quality Rampage® products offered by Lund International. We take the ultimate pride in our products and hope you receive years of satisfaction from your investment. We have made every effort to guarantee that your product is of the highest quality for fit, durability, finish, and ease of installation.

