



TOW HOOK COVER
SLOTTING GUIDE

TOOL LIST

- Electric Drill
- 5/16" Drill Bit
- Small Round and Flat Files
- Dremel Tool
- Small Dremel Cutting Wheel
- Center Punch
- Masking Tape
- Sharpie Marker

SLOTING GUIDE

1 Print out the **Tow Hook Cover Slot Guide**

** Make sure your printer is set to a 1:1 scale. The slot on the printout should measure 5/16" x 2 1/4". **

2 Cutout around the slot guide printout and place it on your tow hook cover. Make sure the black slot is level and placed in a position where it can be cut through the tow hook cover.

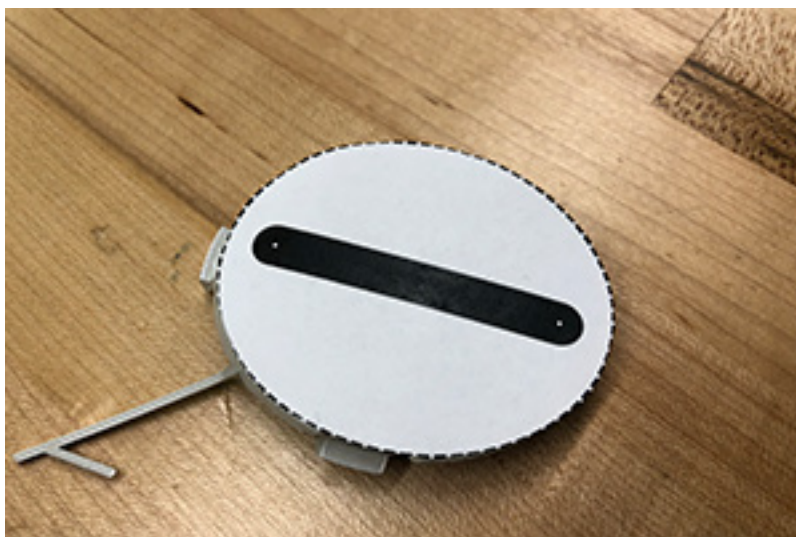

3 Place masking tape over the slot printout. The masking tape holds the printout in place and also protects the paint from chipping.



4 Use a center punch and punch the white dots on the outer ends of the slots.

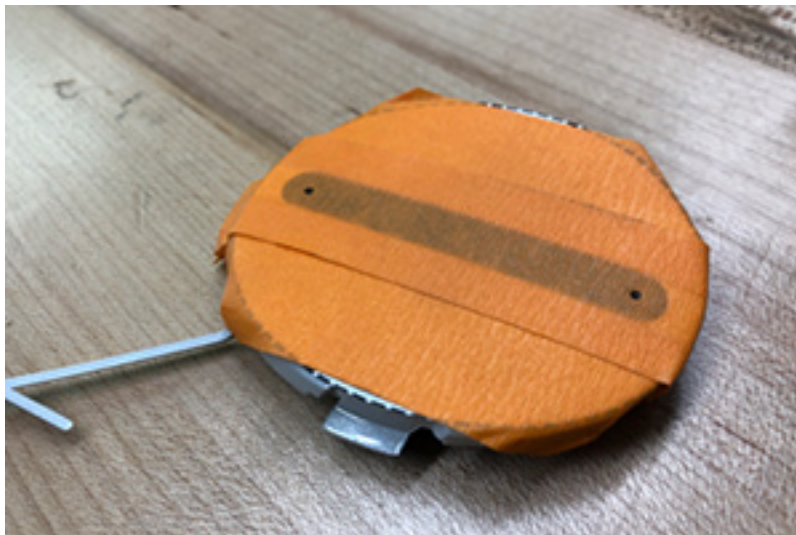

5 Use an electric drill and 5/16" drill bit to drill holes on the punched marks.



6 Use a sharpie marker to outline the edges of the slot.

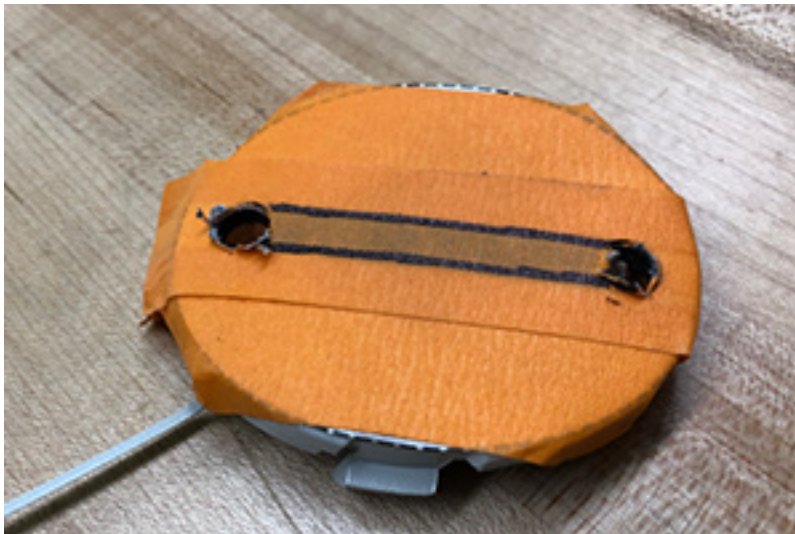

7 Use the Dremel tool to cut along the sharpie marks.



8 Fully cut the inner opening out.



9 Use small round and flat files to finish the edge of the cutout.



10 Remove the masking tape and install your cover.

