



KR Series Work Winches

Read, Understand, Follow and Save These Instructions

Read, understand and follow all of these instructions and warnings (Instructions) before installing and using this product. Install and use this product **only** as specified in these instructions. Improper installation or use of this product may result in property damage, serious injury, and/or death. Never allow installation or use of this product by anyone without providing them with these instructions. You must read, understand and follow all instructions and warnings for any product(s) to which this product is used in conjunction with or installed. Save these instructions with the product for use as a reference for any future installation and use of the product.

WARNING Failure to follow all warnings and instructions may result in product failure, property damage, serious bodily injury, and/or death.

- This product must be installed and used in strict accordance with these instructions. Purchaser/owner must not alter or modify the product.
- Operator and bystanders should never position any part of body under or on the path of any portion of this product or the load being supported, or moved.
- Do not allow children to play on or around this product or the load being supported, or moved.
- Do not use winch to move humans.
- Never exceed the maximum rated capacity. Refer to stamped markings on side of frame to obtain rated capacity.
- Always inspect the cable and its attachment before each use for damaged of any kind. Never use worn, kinked, or frayed cable or attachment.
- Never stand along side the winch cable, strap, or rope or guide the cable, strap, or rope with your hands.
- Never operate with slippery, wet, or oily hands and always maintain a firm grip on the winch handle. Do not attempt to stop a winch by grabbing the handle while in motion.
- Always maintain a minimum of three complete wraps of cable or rope on the drum, or three layers of strap on the drum.
- Assure there is adequate safety factor, of at least 3 times the maximum load capacity for all components used in conjunction with this product.
- A loud clicking sound from the ratchet must be heard when lifting the load. If a loud clicking sound is not heard, do not use.
- Never release the crank handle unless the ratchet pawl is fully engaged and the load is supported.
- Never leave a weight supported from the winch while the winch is unattended, as another person may attempt to operate the winch, thereby creating an unsafe condition.
- This winch is designed for manual operation only and the maximum load rating is based on an intermittent use cycle.
- Excessive force in turning winch handle may indicate overload. Pro Series brand winches require 25-45 lbs of handle force to pull their rated load.
- If you cannot crank the winch with one hand you are potentially overloading the winch.
- Winches are not designed to secure boats to trailers while towing. Boat tie downs should be used for this purpose.
- Periodically check mounting hardware for proper torque and tighten if necessary.
- Always replace bent, broken, or worn parts before using this product.

Installation Instructions

Warning: Failure to follow all warnings and instructions may result in product failure, property damage, serious bodily injury, and/or death.

HANDLE ATTACHMENT AND WINCH MOUNTING

- 1) Insert handle onto input shaft hexagon end. Align screw holes and drive shaft indents (Fig. 1). Tighten the set screws with the wrench provided. **Note:** Do not remove or adjust any hardware on the input shaft except the handle. This is critical to the braking system and must be left intact.
- 2) Mount the winch to a structure capable of supporting at least 3 times the load the winch will be pulling. (Mounting hardware not supplied.) The mounting surface must be equal to or greater than the footprint of the winch frame. Mounting bolts will vary in length for each application. **Note:** When bolting the winch down, use three grade 5, 3/8" diameter bolts, flat washers and locknuts and torque to 30 ft-lbs. Always use outer most slots at the end opposite the direction of line pull. Use large flat washer if using center slot at opposite end.

Fig. 1

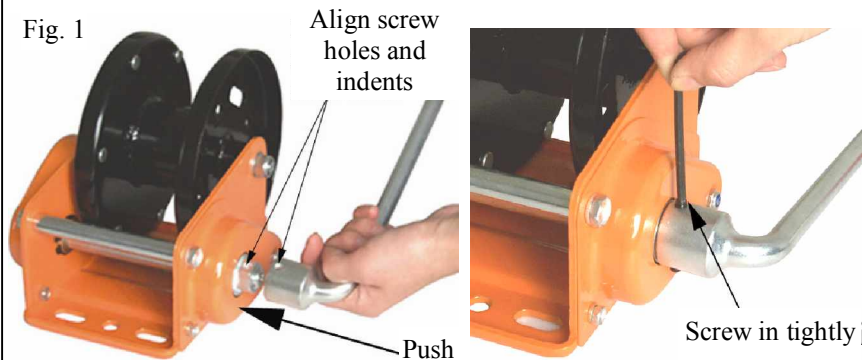

CABLE ATTACHMENT TO DRUM

- 1) Feed the cable over the top of drum and through the drum side slot. Insert cable end through one side of cable clamp and loop back into the other side as shown in Fig. 2. Tighten clamp nut slightly and reduce loop by pulling cable (see Fig. 3).
- 2) Tighten cable clamp nut until cable is adequately clamped (approximately 20-30 in-lbs.) Replace cable clamp each time cable is replaced.
- 3) Always be sure the cable is pulling straight off the winch, not at an angle. This will prevent the cable from rubbing against the sides of the drum, which can damage the cable. Neatly wrapping the cable is necessary to reduce the chance of kinking, fraying or any other damage to the cable.

Fig. 2

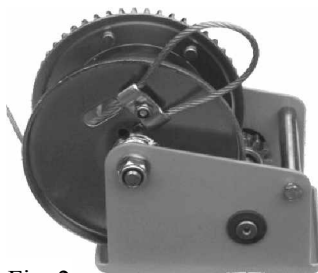
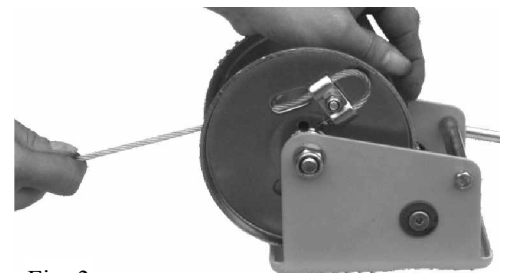

Fig. 3



Winch Information Chart

Fulton Part No.	Capacity(1)		Gear Ratio	Handle Length	Drum Storage
	First Layer	Full Drum			
KR1000	1000	500	3.5:1	8"	7/32" x 50 FT
KR1500	1500	700	5.1:1	8"	7/32" x 50 FT

(1) Capacity is based on direct line pull on first layer of the line on the drum. Capacity is reduced as line builds up on the drum.

(2) Maximum Mechanical Advantage is based on first layer of recommended line on the drum. For maximum efficiency use only the amount of line required.

Operation

The brake system is designed to hold up to the rated load whenever the handle is released.

Turning the handle counter-clockwise actuates the brake.

The cable must be securely fastened to the object being lifted and to the winch drum.

Always be sure that the cable and cable attachments are not damaged and are strong enough for the load.

TO PULL CABLE IN OR RAISE LOAD

Referring to the "Cable In/Cable Out" decal on the winch, turn the handle clockwise to lift. The ratchet MUST make a loud clicking sound.

TO LET CABLE OUT OR LOWER LOAD

Again referring to the "Cable In/Cable Out" decal on the winch, turn the handle counter-clockwise to lower. No clicking will be heard because the brake system is activated.

Maintenance

Do not get oil or grease on the friction disks. This could allow the load to slip or fall.

- 1) Maintain a film of automotive type grease on all gear teeth and to the outer diameter of drum bearing at all times.
- 2) Keep ratchet pawl pivot, bushings and pinion threads lubricated with automotive engine oil at all times.
- 3) Check brake friction disks for wear. If less than 1/16" thick, cracked, or broken, they must be replaced.
- 4) During each usage, check for proper ratchet operation. When cranking cable in, a loud clicking sound must be heard from the ratchet. If a loud clicking sound is not heard, do not use and replace damaged components immediately. When cranking cable out, there is no clicking and the ratchet pawl must be fully engaged into the ratchet gear teeth.
- 5) Before each usage, inspect fasteners for proper tightness.

Crank Handle Assembly

