



PRO COMP SUSPENSION

Suspension Systems that Work!

Part # 79090B
Traction bar kit
2004 Nissan Titan
4WD (Crew Cab)

This document contains very important information that includes warranty information and instructions for resolving problems you may encounter. Please keep it in the vehicle as a permanent record.

Part #	Description	Qty	Illus.	Page
72300B	TRACTION BAR KIT			
91-2350	LATERAL TRACK BAR DRIVER	1	2	5
91-2353	LATERAL TRACK BAR PASSENGER	1	-	-
79090B	TRACTION BAR MOUNTING KIT			
91-3147	REAR TRACTION BAR MOUNT DRIVERS	1	1,2	4,5
91-3148	REAR TRACTION BAR MOUNT PASS	1	-	-
91-1956	FRONT TRACTION BAR MOUNT DRIVERS	1	3	6
91-1958	FRONT TRACTION BAR MOUNT PASS	1	4	7
90-6122	HARDWARE PACK: Bushings and Sleeves	1	-	-
90-2152	SLEEVE 7/8" X .188 WALL X 3.9375"	2	2	5
90-2153	SLEEVE 7/8" X .180 WALL X 2.9375"	2	2	5
15-10953	BUSHING - TRAC BAR	8	2	5
90-6366	HARDWARE PACK: Mounts	1	-	-
70-0505501800	1/2" X 5 1/2" GR 8 HEX BOLT	2	2	5
70-0504501800	1/2" X 4 1/2" GR 8 HEX BOLT	2	2	5
73-05000032	1/2" USS GR 8 FLAT WASHER	8	2	5
72-050100816	1/2" GR 8 STOVER NUT	4	2	5
70-0431251800	7/16" X 1 1/4" GR 8 HEX BOLT	5	3,4	6,7
73-04300032	7/16" USS GR 8 WASHER	5	3,4	6,7
71-080301251000	8MM. X 1.25 X 30MM. 10.9 HEX BOLT	1	3	6
73-00810950	8MM. FLAT WASHER 10.9	1	3	6
90-6367	HARDWARE PACK: Nut Plate/Spacer	1	-	-
90-3152	LOAD WASHER	1	3	6
90-3151	TRACTION BAR NUT PLATE	5	3,4	6,7

Equipment Available from your Pro Comp Distributor!

Coil Over Add On Kit:
Rear MX-6 Shocks:

59002BMX
MX6060

Also, Check out our outstanding selection of Pro Comp tires to compliment your new installation!

Introduction:

- ◆ This installation requires a professional mechanic!
- ◆ We recommend that you have access to a factory service manual for your vehicle to assist in the disassembly and reassembly of your vehicle. It contains a wealth of detailed information.
- ◆ Ensure that your work space is of adequate size and the work surface is level. Place the vehicle in neutral. Place your floor jack under the front cross member and raise vehicle. Place jack stands under the frame rails behind the front wheel wells and lower the frame onto the stands. Remove the jack and place the vehicle back in gear, set the emergency brake, and place blocks both in front and behind the rear wheels.
- ◆ Prior to installation, carefully inspect the vehicle's steering and driveline systems paying close attention to the tie rod ends, ball joints, wheel bearing preload, pitman and idler arm. Additionally, check steering-to-frame and suspension-to-frame attaching points for stress cracks. The overall vehicle must be in excellent working condition. Repair or replace all worn or damaged parts!
- ◆ Read the instructions carefully and study the illustrations before attempting installation! You may save yourself a lot of extra work.
- ◆ Check the parts and hardware against the parts list to assure that your kit is complete. Separating parts according to the areas where they will be used and placing the hardware with the brackets before you begin will save installation time.
- ◆ Check the special equipment list and ensure the availability of these tools.
- ◆ Secure and properly block vehicle prior to beginning installation.
- ◆ ALWAYS wear safety glasses when using power tools or working under the vehicle!
- ◆ Use caution when cutting is required under the vehicle. The factory undercoating is flammable. Take appropriate precautions. Have a fire extinguisher close at hand.
- ◆ Foot pound torque readings are listed on the Torque Specifications chart at the end of the instructions. These are to be used unless specifically directed otherwise. Apply thread lock retaining compound where specified.
- ◆ *Please note that while every effort is made to ensure that the installation of your Pro Comp lift kit is a positive experience, variations in construction and assembly in the vehicle manufacturing process will virtually ensure that some parts may seem difficult to install. Additionally, the current trend in manufacturing of vehicles results in a frame that is highly flexible and may shift slightly on disassembly prior to installation. The use of pry bars and tapered punches for alignment is considered normal and usually does not indicate a faulty product. However, if you are uncertain about some aspect of the installation process, please feel free to call our tech support department at the number listed on the cover page. We do not recommend that you modify the Pro Comp parts in any way as this will void any warranty expressed or implied by the Pro Comp Suspension company.*
- ◆ Check the parts and hardware against the parts list to assure that your kit is complete.
- ◆ Always use new cotter pins (these items are not supplied) when replacing them.

INSTALLATION INSTRUCTIONS:

- 1) Place floor jack under rear axle and raise vehicle. Place jack stands under frame to support vehicle. Set emergency brake and block front wheels, in front and behind tires. Remove rear wheels and shocks.
- 2) Remove the fuel tank skid plate bolt on the driver side frame rail.
- 3) Work on one side of the vehicle at a time.
- 4) Support the rear axle, unbolt the U-bolts, remove the factory lower mount and install the lateral traction bar rear mount (**91-3147 drivers side and 91-3148 passenger side**) under the axle housing as shown in ILLUSTRATION 1. Be sure when tightening keep mount parallel with the leaf spring.
- 5) Reinstall the U-bolts and torque. Repeat on the other side.
- 6) Place floor jack under rear axle and raise vehicle. Move the jack stands under the rear axle to support vehicle and lower.
- 7) Install the bushings (**15-10593**) and sleeves (**90-2153 front and 90-2152 rear**) into the lateral traction bar tubes as shown in ILLUSTRATION 2. Use lubricant as necessary.
- 8) Install lateral traction bars (**91-2350 drivers side and 91-2353 passenger side**) into rear mounts using the supplied **1/2" X 5 1/2"** bolts and hardware. See ILLUSTRATION 2. Do not tighten at this time.

NOTE: The right rear shock may have to be removed from the lower mount to

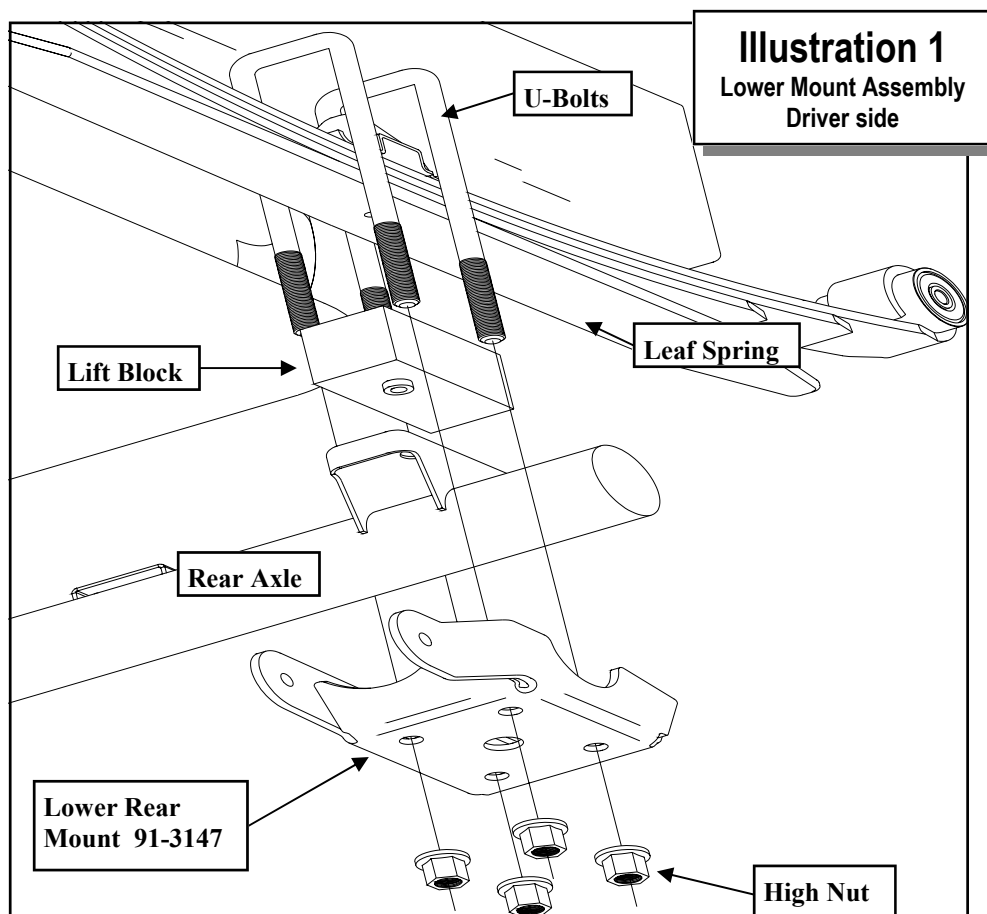

insert the 1/2" bolt.

- 9) At the start of the rear fender well, find the small hole in the lower wall of the frame.
- 10) **ON DRIVER SIDE ONLY** fasten the front mount (91-1956) to the frame using the supplied 8mm X 30mm Bolt in the existing hole. Use the front mount as a template and center punch the holes for drilling. Drill out the necessary holes using a 15/32" drill bit. Refer back to ILLUSTRATION 3.
- 11) One at a time slide the (2) nut plates (90-3151) into the hole in the frame. Line the nut plates up with the newly drilled holes in the frame and secure with the supplied 7/16" X 1 1/4" bolts and washers. See ILLUSTRATION 3.
- 12) Raise the traction bar and install to the front mount with the supplied 1/2" X 4 1/2" bolt and hardware.
- 13) Remove the previously installed 8mm X 30mm bolt and washer.
- 14) Reinstall the fuel tank skid plate using the previously removed 8mm X 30mm bolt, washer and load washer (90-3152). See ILLUSTRATION 3.
- 15) **ON PASSENGER SIDE ONLY** with the supplied 1/2" X 4 1/2" bolt and hardware attach the lateral traction bar to the front mount (91-1958 passenger side). Do not tighten at this time.
- 16) Raise the traction bar to the frame. Use the front mount as a template and center punch the holes for drilling. Lower the traction bar and drill the necessary holes using a 15/32"

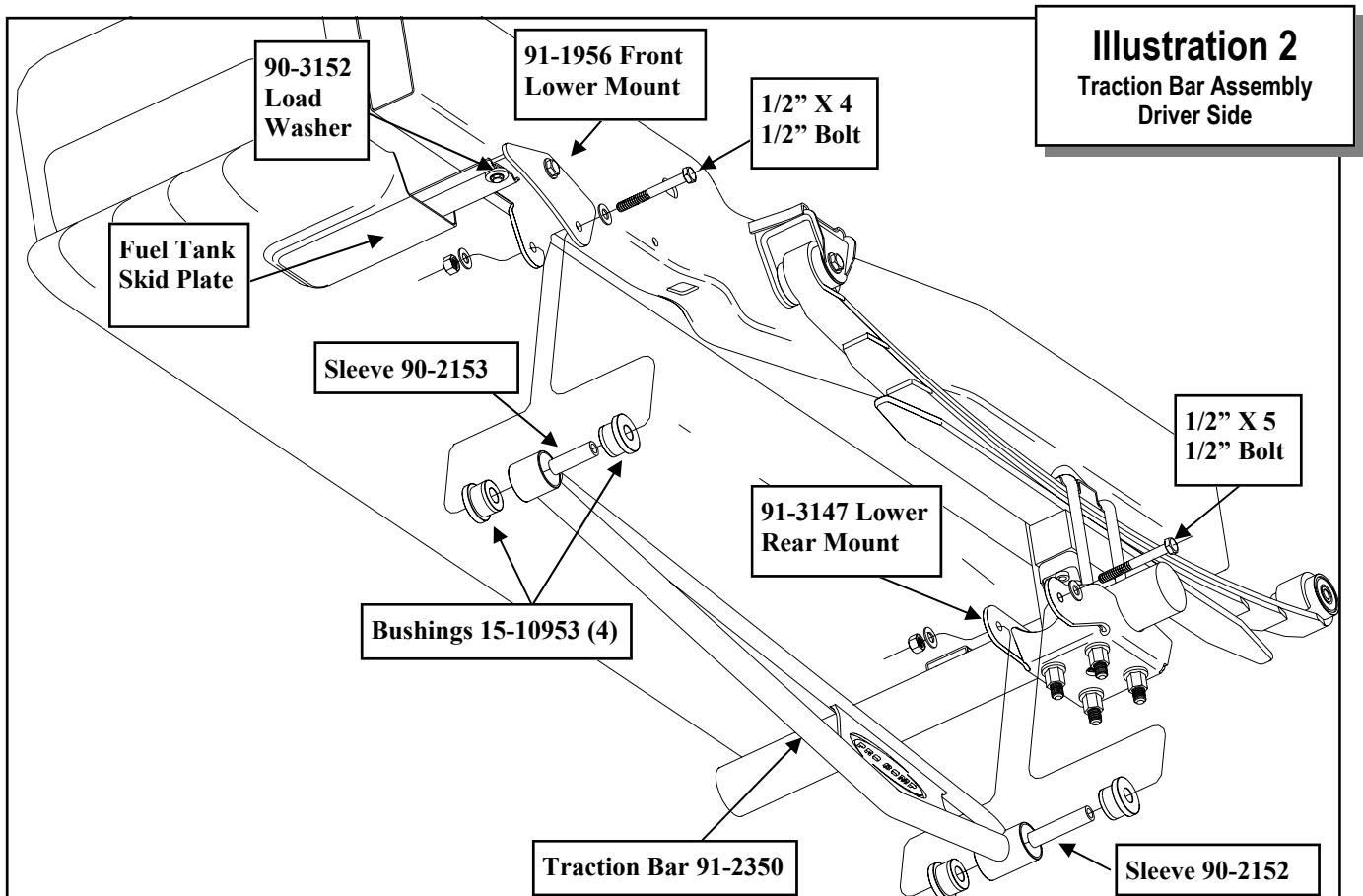

drill bit as shown in ILLUSTRATION 4.

- 17) Remove the front mount from traction bar. Install the front mount to the frame (91-1956) and one at a time slide the (3) nut plates (90-3151) into the hole in the frame. Line the nut plates up with the newly drilled holes in the frame and secure with the supplied 7/16" X 1 1/4" bolts and washers. See ILLUSTRATION 4.
- 18) Raise the traction bar and install to the front mount as previously instructed.
- 19) Clip off excess wire when finished. Be sure to leave enough wire for future access. Bundle wires with a zip tie to keep from rattling.
- 20) Raise rear axle until it clears the jack stands and remove them. Lower the vehicle to the ground.
- 21) After installation is complete, retighten and torque all bolts as specified in the torque chart.

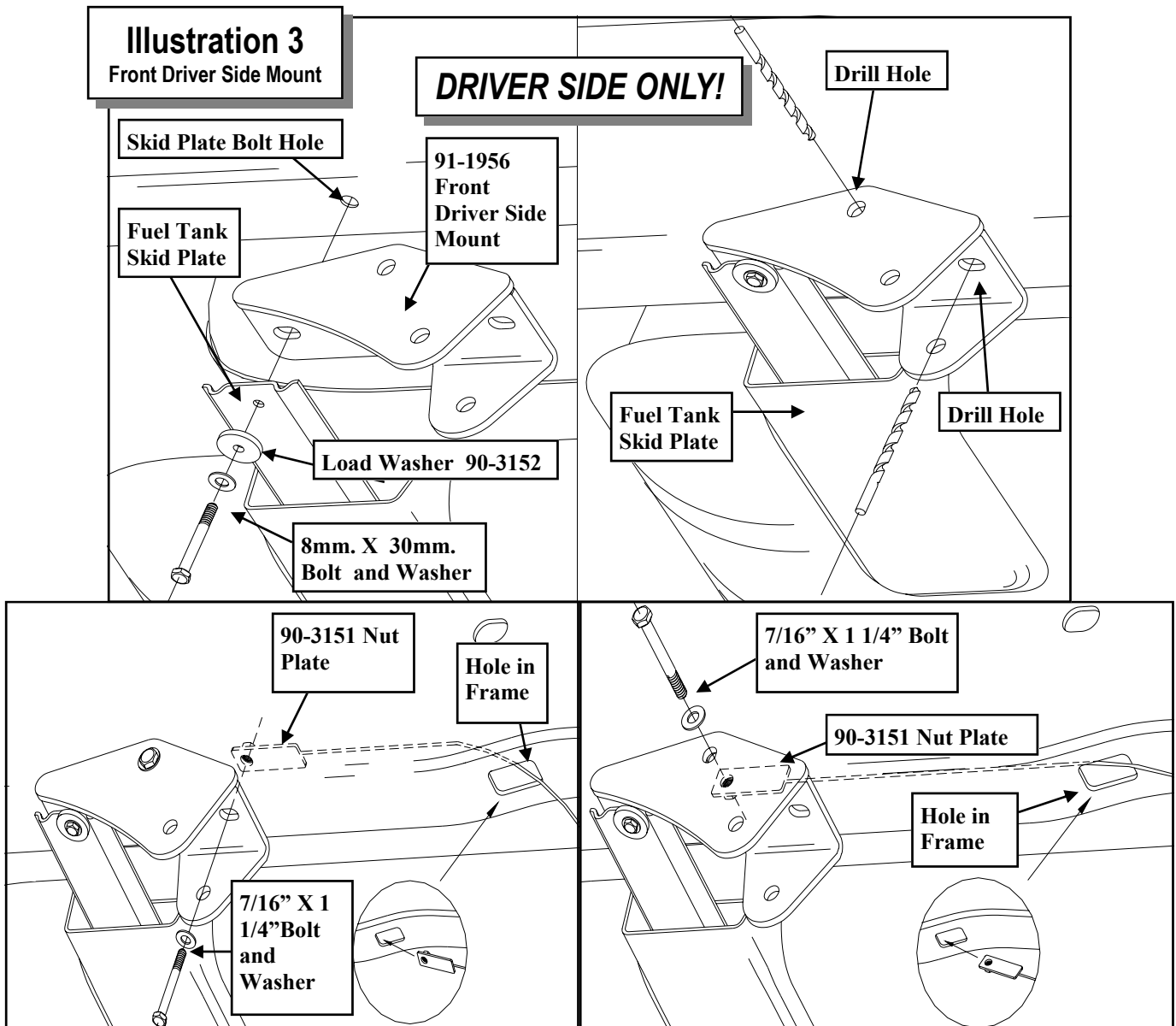

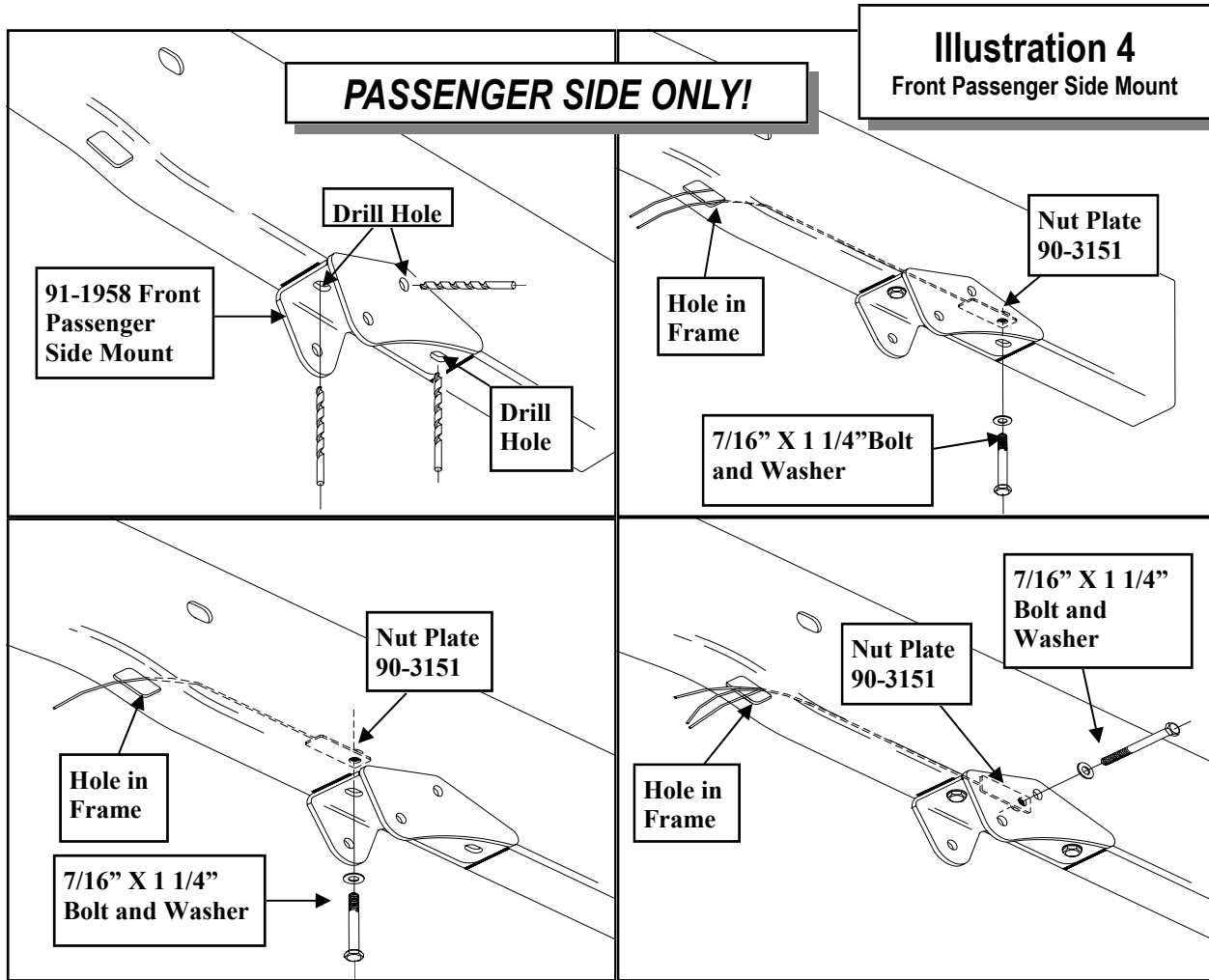

Use this only as a guide for hardware without a called out torque specification in the instruction manual.

Decimal System				Metric System			
All Torques in Ft. Lbs. Maximums							
Bolt Size	Grade 5	Grade 8	Bolt Size	Class 9.8	Class 10.9	Class 12.9	
5/16	15	20	M6	5	9	12	
3/8	30	45	M8	18	23	27	
7/16	45	60	M10	32	45	50	
1/2	65	90	M12	55	75	90	
9/16	95	130	M14	85	120	145	
5/8	135	175	M16	130	165	210	
3/4	185	260	M18	170	240	290	

<p>1/2-13x1.75 HHCS</p> <p>D T L X</p>	<p>Grade 5 Grade 8 (No. of Marks + 2)</p> <p>D T L X</p>	<p>M12-1.25x50 HHCS</p> <p>D T L X</p>
--	---	--

G = Grade (Bolt Strength)
 D = Nominal Diameter (Inches)
 T = Thread Count (Threads per Inch)
 L = Length (Inches)
 X = Description (Hex Head Cap Screw)

P = Property Class (Bolt Strength)
 D = Nominal Diameter (Millimeters)
 T = Thread Pitch (Thread Width, mm)
 L = Length (Millimeters)
 X = Description (Hex Head Cap Screw)

Notice to Owner operator, Dealer and Installer:

Vehicles that have been enhanced for off-road performance often have unique handling characteristics due to the higher center of gravity and larger tires. This vehicle may handle, react and stop differently than many passenger cars or unmodified vehicles, both on and off-road. You must drive your vehicle safely! Extreme care should always be taken to prevent vehicle rollover or loss of control, which can result in serious injury or even death. Always avoid sudden sharp turns or abrupt maneuvers and allow more time and distance for braking! Pro Comp reminds you to fasten your seat belts at all times and reduce speed! We will gladly answer any questions concerning the design, function, maintenance and correct use of our products.

Please make sure your Dealer/Installer explains and delivers all warning notices, warranty forms and instruction sheets included with Pro Comp product.

Application listings in this catalog have been carefully fit checked for each model and year denoted. However, Pro Comp reserves the right to update as necessary, without notice, and will not be held responsible for misprints, changes or variations made by vehicle manufacturers. Please call when in question regarding new model year, vehicles not listed by specific body or chassis styles or vehicles not originally distributed in the USA.

Please note that certain mechanical aspects of any suspension lift product may accelerate ordinary wear of original equipment components. Further, installation of certain Pro Comp products may void the vehicle's factory warranty as it pertains to certain covered parts; it is the consumer's responsibility to check with their local dealer for warranty coverage before installation of the lift.