



LML
Dual Fueler
Installation Guide

DISCLAIMER OF LIABILITY

This is a performance product which increases horsepower above and beyond factory specifications. As a result, more horsepower creates more stress on the drivetrain components, which could result in drivetrain failure. This product is intended for off-road use only. Use at your own risk.

This agreement sets forth the terms and conditions for the use of this product. The installation of this product indicates that the Buyer has read and understands this agreement and accepts the terms and conditions. Pacific Performance Engineering Inc., its distributors, employees, and dealers (the "Seller") shall not be responsible for the product's proper use and service. The buyer hereby waives all liability claims. The Buyer hereby acknowledges no reliance on the Sellers skill or judgment to select or furnish goods suitable for any particular purpose and that there are no liabilities which extend beyond the description on the face hereof, and the Buyer hereby waives all remedies or liabilities expressed or implied, arising by law or otherwise (including without any obligation of the Seller with respect to fitness, merchantability and consequential damages), or whether or not occasioned by the Seller's negligence. The Seller disclaims any warranty and expressly disclaims any liability for personal injury or damages. The Buyer acknowledges and agrees that the disclaimer of any liability for personal injury is a material term for this agreement and the Buyer agrees to indemnify the Seller and to hold the Seller harmless from any claim related to the item of equipment purchased. Under no circumstances will the Seller be liable for any damages or expenses by reason of use or sale of any such equipment. The Seller assumes no liability regarding the improper installation or misapplication of its products. It is the installer's responsibility to check for proper installation and if in doubt contact the manufacturer. The Buyer is solely responsible for all warranty issues from the manufacturer.

LIMITATION OF WARRANTY

The Seller gives Limited Warranty as to description, quality, merchantability, and fitness for a particular purpose, productiveness, or any other matter of Seller's product sold herewith. The Seller shall not be responsible for the products proper use and service and the Buyer hereby waives all rights other than those expressly written herein. This warranty shall not be extended, altered or varied except by a written instrument signed by Seller and Buyer. The Warranty is limited to two (2) years from the date of sale and limited solely to the parts contained within the products kit. All products that are in question of Warranty must be returned prepaid to the Seller and must be accompanied by a dated proof of purchase receipt. All Warranty claims are subject to approval by Seller. Under no circumstances will the Seller be liable for any labor charged or travel time incurred in diagnosis for defects, removal, or reinstallation of this product or any other contingent expenses. Under no circumstances will the Seller be liable for any damage or expenses incurred by reason of the use or sale of any such equipment. In the event that the buyer does not agree with this agreement: the buyer may promptly return this product, in a new and unused condition in its original packaging, with a dated proof of purchase to the place of purchase within ten (10) days from date of purchase for a full refund. The installation of this product indicates that the buyer has read and understands this agreement and accepts its terms and conditions.

BOX 1 CONTENTS

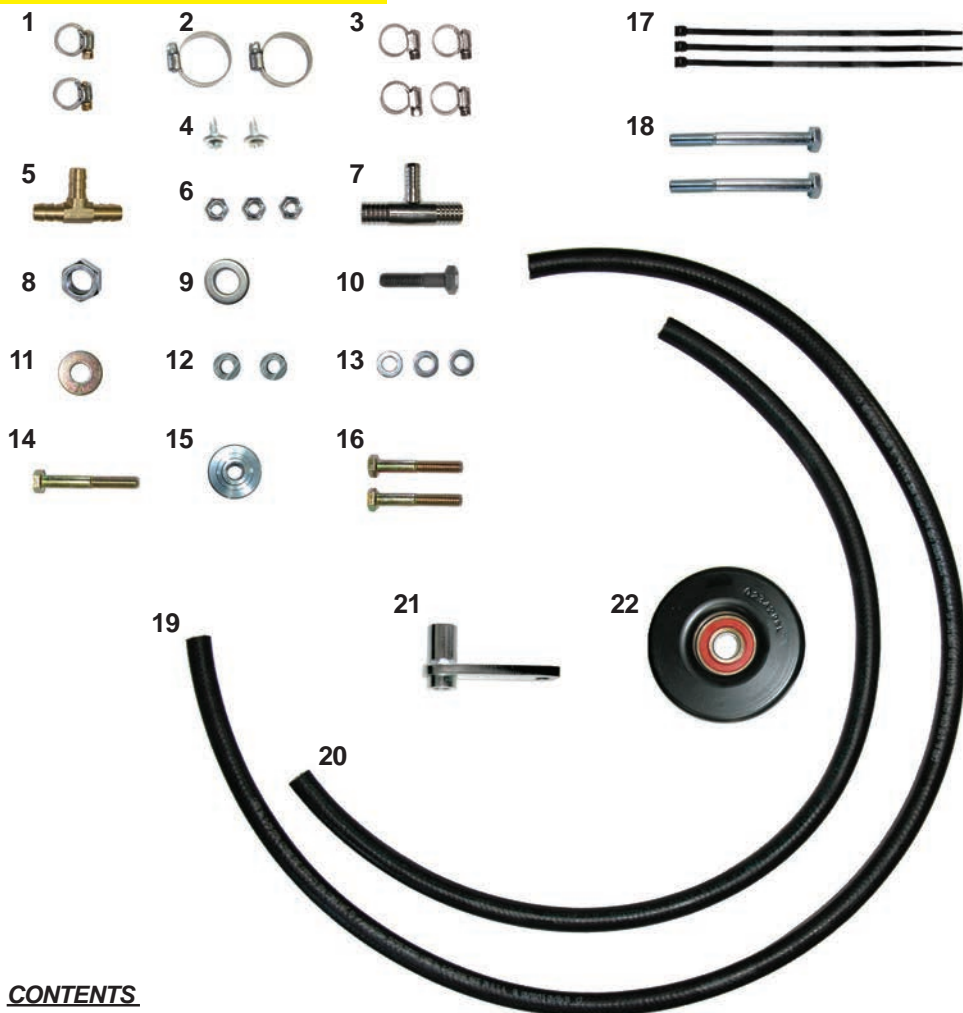

CONTENTS

- | | |
|--------------------------------------|------------------------------------------|
| 1 (2) 3/8" Hose Clamps | 12 (2) 10mm Washer |
| 2 (2) 7/8" Hose Clamps | 13 (3) 5/16" Washer |
| 3 (4) 5/16" Hose Clamps | 14 (1) 5/16 x 18 - 2.25 Bolt |
| 4 (2) 8 x 0.5 Self-Tapping Screws | 15 (1) Idler Pulley Spacer |
| 5 (1) 5/16" Brass Fuel T | 16 (2) 5/16" x 18 - 2" Bolts |
| 6 (3) 5/16" x 18 Nut | 17 (3) 8" Zip Ties |
| 7 (1) 1/2" x 1/2" x 3/8" S.S. Fuel T | 18 (2) 10 x 1.5 - 100 Bolt |
| 8 (1) 18 x 1.5 Pulley Nut | 19 (1) 34" x 3/8" Hose w/33" Split Loom |
| 9 (1) 18mm Washer | 20 (1) 20" x 5/16" Hose w/19" Split Loom |
| 10 (1) 10 x 1.5 - 45 Bolt | 21 (1) Fuel Pump Bracket (113061065) |
| 11 (1) 10mm Idler Pulley Washer | 22 (1) GM Idler Pulley |

BOX 2 CONTENTS



CONTENTS

- | | | | |
|---|------------------------------|-----|-----------------------------------|
| 1 | (1) Dual Fueler Controller | 10 | (1) 6MM nut and (1) bolt |
| 2 | (1) GM Idler Pulley | 11 | (1) Small P.S. Reservoir Bracket |
| 3 | (1) H.P. Line 515-006-2160 | 12 | (1) Barbed Fitting |
| 4 | (2) 1.5" Hose Clamps (X) | 13 | (2) 3/8" CP3 Pump Inlet Fittings |
| 5 | (8) 3/8" Hose Clamps | 14 | (1) Fuel Pressure Reg Block |
| 6 | (1) Idler Pulley Spacer | 15 | (1) Fuel Block Bracket (X) |
| 7 | (1) Ported Fuel Rail Fitting | 16 | (1) 10mm Idler Pulley Flat Washer |
| 8 | (4) 6 x 1.0 - 10 Bolts | 17* | (1) CP3 Bracket Spacer |
| 9 | (1) 10 x 1.5 - 45 Bolt | | |

* .750 O.D., .430" I.D., 2.750" L

BOX 3 CONTENTS



CONTENTS

- | | | | |
|---|---------------------------------------------|----|-----------------------------------|
| 1 | (1) P.S. Reservoir Hose (26" L, 5/8" I.D.) | 7 | (1) P.S. Bracket Bolts and Nuts |
| 2 | (1) Braided Line (21" L, 3/8" I.D.) | 8 | (1) P.S. Reservoir |
| 3 | (1) Fuel Feed Line (CP3) (31" L, 3/8" I.D.) | 9 | (1) H.P. Fuel Line (113063671) |
| 4 | (1) PPE GM Dual Fueler Pulley | 10 | (1) Updated P.S. Reservoir |
| 5 | (1) CP3 Pump Bracket | 11 | (1) Updated P.S. Reservoir O-Ring |
| 6 | (1) Large P. S. Reservoir Bracket | 12 | (2) Updated P.S. Reservoir Clips |
| | | 13 | (1) Green Serpentine Belt |

Preparation

- Step 1:** *Disconnect both batteries.*
- Step 2:** *Remove engine bay cover.*
- Step 3:** *Remove skid plates for easy access.*
- Step 4:** *Remove factory air box and intake tube. Disconnect electrical connectors.*
- Step 5:** *Remove the upper plastic fan shroud.*
- Step 6:** *Remove the fan blade and fan clutch.*
- Step 7:** *After removing the fan, remove the belt from all of the pulleys.*
- Step 8:** *If vehicle was equipped with dual alternators you will need to remove the second alternator if it will not be reused. Wrap wires in electrical tape.*
- Step 9:** *Remove the bottom idler pulley.*
- Step 10:** *Disconnect the power steering hoses.*
- Step 11:** *Remove the three power steering bolts.*
- Step 12:** *Remove the power steering pump assembly from the vehicle.*
- Step 13:** *Remove the power steering fluid reservoir.*
- Step 14:** *Remove driver-side intercooler pipe.*
- Step 15:** *Disconnect and remove the fuel pressure sensor from the back of the driver-side fuel rail.*
- Step 16:** *Remove the heat shield on top of the fuel lines.*
- Step 17:** *Remove the fuel return line.*

Installation



Step 1: *Install the new PPE updated Power Steering Reservoir from the kit on your OEM steering pump using clips and O-Ring. (Box 3, item 10, 11, 12)*

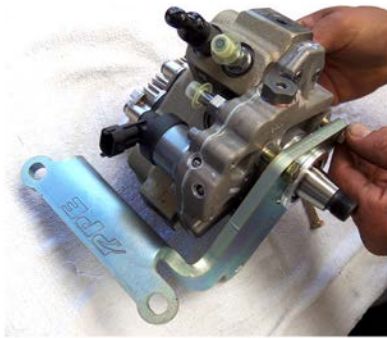

Step 2: *Install CP3 Fuel Pump to CP3 Pump Bracket. (Box 1, items 6, 13, 16)*

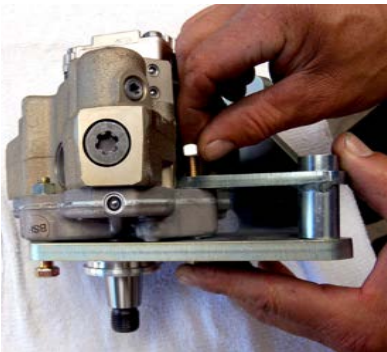

Step 3: *Install CP3 Fuel Pump and CP3 Pump Bracket to Fuel Pump Support Bracket. (Box 1, items 6, 13, 14)*



Step 4: *Install CP3 Bracket Spacer to the A/C compressor mount. (Box 2, item 16)*

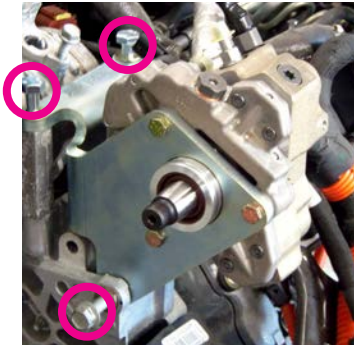

Step 5: *Install the mounted CP3 Fuel Pump and Support Bracket to the top of the Air Compressor mount using bolts and washers and tighten to secure. (Box 1, item 18)*

Thread OEM bolt through the bottom side and tighten to secure.



Step 6: *Install new belt pulleys. (Box 1, item 10, 11, 15, 22) (Box 2, items 2, 6, 9, 16)*



Step 7: *Install the Dual Fueler Pulley
(Box 1, items 8, 9)
(Box 3, item 4)*

(Torque nut to 48 ft lbs).

Step 8: *Install the new Serpentine Belt as
shown.
(Box 3, item 13)*

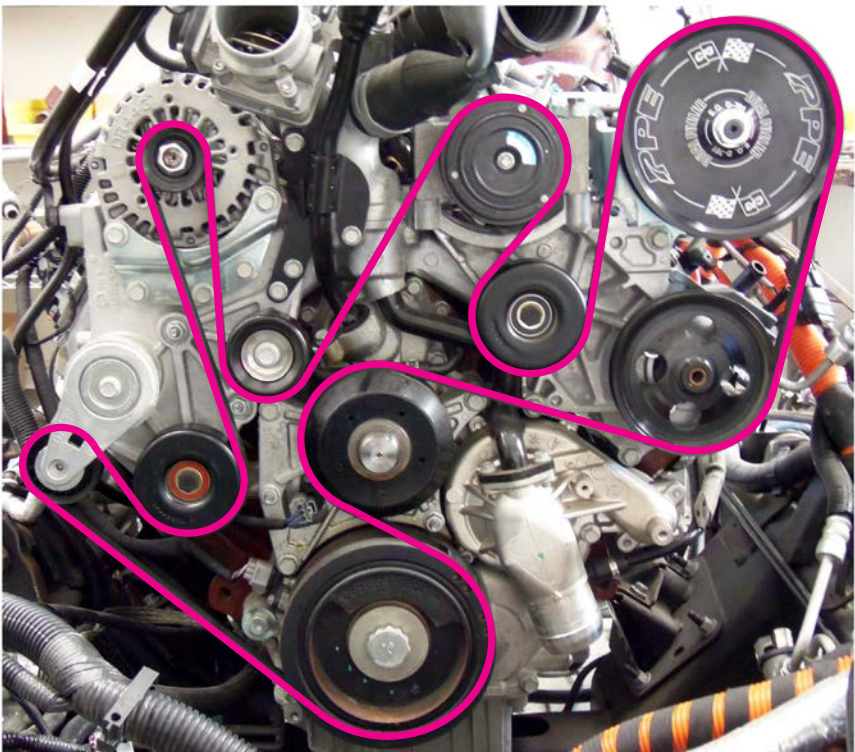



Step 9: *Replace CP4 and CP3 inlet fittings with the PPE 3/8" fittings (Box 2, item 13).*



Step 10: *Cut the supply fuel line after the fuel filter and install the new PPE 1/2" to 3/8" "T" fitting to the fuel line. (Box 1, item 7)*



Step 11: *Install and route the CP3 feed line under the throttle valve, on top of alternator and connect it to the "T" fitting.*



Step 12: *Install the new Fuel Hoses to the fuel return as shown.*



Step 13: *Install the Fuel Line Junction Block to the Bracket using 6 x 1.0 - 10 Bolts to the engine (only finger-tight for now). (Box2, items 8, 14, 15)*



Step 14: *Install the fuel sensor to the Fuel Junction Block.*



Step 15: *Install the Hard Fuel Line from the back of the fuel rail to the Fuel Junction Block (only finger-tight for now) (Box 3, item 9)*



Step 16: *Install the Hard fuel line from the CP3 to the Junction Block.*

Step 17: *Tighten both hard lines and Fuel Junction Block bracket.*



Step 16: Reinstall the driver side intercooler tube.

Step 17: Reconnect the OEM power steering reservoir.

Step 18: Replace factory power steering reservoir line with PPE 3/8" fitting and hose.

Step 19: Install PPE 5/8" hose from power steering reservoir to second power steering reservoir.



Step 20: Strip some of the paint on large Power Steering Reservoir Bracket for the ground wire. (Box 3, item 6)

Step 21: Mount large Power Steering Bracket (item call out #6, Box 3) using existing fasteners on the firewall.



Step 22: Mount Power Steering Reservoir to Power Steering Reservoir Bracket mounted on firewall.

Small Power Steering Reservoir Bracket mounts to back of Power Steering Reservoir and secures reservoir to firewall. (Box 2, item 11)

Step 23: *Mount Dual Fueler Controller inside engine bay.
(Box 2, item 1)*

Step 24: *Route Controller wiring*



Step 25: *Connect Dual Fueler Controller to Dual Fueler power and ground.*

Step 26: *Reinstall factory fan blade and shroud.*

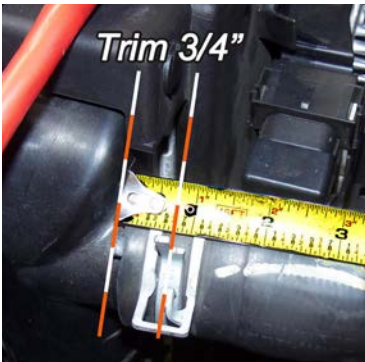

Step 27: *Remove upper radiator hose and trim off 3/4\" from the driver side where it mounts to the radiator to make clearance for the Dual Fueler pulley.*

Step 28: *Reinstall factory upper radiator hose clamp.*

Step 29: *Top off coolant.*

Step 30: *Add power steering fluid.*

Step 31: *Start vehicle and check for leaks.*