

POWER TAILGATE LOCK INSTRUCTIONS

Package Contents: Power Lock Assembly
Long and Short Wire Harness
2 Wire Taps, 8 Cable Ties
Instructions

Tools Required: 10mm Wrench

Step 1: Remove the screws that hold the access panel on the inside of the tailgate and remove the access panel.

Step 2: Remove the two handle mounting nuts. Install the power lock bracket. Start by installing through the opening next to the handle opening. Slide it in away from the handle enough to get the other side to drop into the tailgate. Position the power lock over the two handle mounting studs. Make sure the locking bar aligns with the OEM toggle as shown in the pictures below. Reinstall mounting nuts.

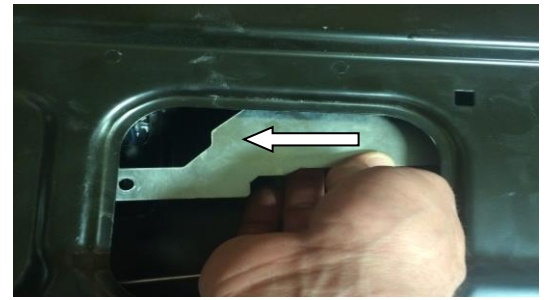
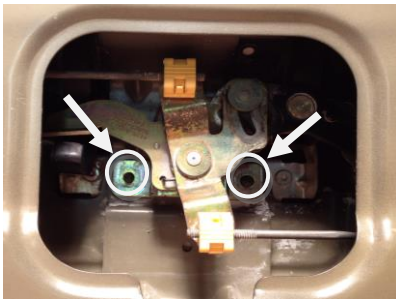

Step 3: Wiring

(There are multiple ways to run the wiring this is one suggestion)

Route the bullet connector side of the short wiring harness through one of the drain holes at the bottom of the tailgate up to the power lock assembly. Connect it to the bullet connectors of the power unit. Secure the wire with cable ties to prevent the wire from getting pinched or in the way of the latch rods. Connect the other end to the long wire harness. Locate this connector under the truck so that it is accessible for tailgate removal. Run the long wiring cable along the factory wire harness to the engine compartment securing it with cable ties. Route wire harness into the driver's compartment and to the driver side kick panel (the plastic panel on side where your feet go). Use one of the factory's rubber grommets in either the firewall or along the floor pan. Cut a small slit in the grommet or run the wire next to the grommet to allow the wire to pass through. *It is recommended to seal around wire to prevent moisture from entering the cab.* Run the wire out of view and to the kick panel. Locate the **purple wire and the green wire**. Use the supplied wire taps to connect to these two wires. At this point it doesn't matter which wire is tapped to the OEM wires. Test the operation of the lock (if the tailgate lock works opposite of the door locks, disconnect the two bullet connectors back by the power lock assembly, switch the leads of the wires, and reconnect the bullet connectors. This will make the lock the same as the doors). Secure all the wiring and replace the removed trim pieces.

Step 4: Shut the tailgate. Test the function of the key lock and power lock. If everything works, reinstall the access panel.