

# THIRD BRAKE LIGHT ANTENNA ADAPTER

2015+ F150 Truck Body | 2017+ Super Duty  
2017 Raptor W / Aluminum Body



## Introduction

Thank you for your purchase of our vehicle specific Third Brake Light Antenna Adapter! We hope that you find the installation simple and straightforward. As our customer, your satisfaction is important to us, and for that reason we take pride in all of the products that we design and manufacture to ensure a reliable solution for years to come!

## Pre-caution

Upon completing the installation of the Third Brake Light Antenna Adapter the overall height clearance of the vehicle will have changed. Beware of your surroundings and heed all height restriction warnings as they pertain to your vehicle to avoid damage to the antenna, adapter or even vehicle.

## Warranty

At Neal Technologies, Inc we know that if we don't take care of the customer, someone else will. That is why we strive to make each and every customer experience as wonderful as possible.

With regards to our Third Brake Light Antenna Adapters, we offer a 1-Year Parts-Only Warranty.

The limitations include:

- Parts-only, exchange-only warranty.
- Warranty is limited to defects in workmanship and materials.
- Shipping is NOT included with warranty returns.

In the very rare event that you might actually have a warranty claim, we will be more than happy to assist you.

## Tools Needed for Installation

- Phillips Screwdriver
- Allen Wrench; 5/32" & 1/8"
- Drill
- Nut Driver; 9/32" (7mm)
- 3/16" Drill Bit



©2017 Neal Technologies, Inc. All rights reserved. Specifications subject to change without notice.

## Parts List - 90201129

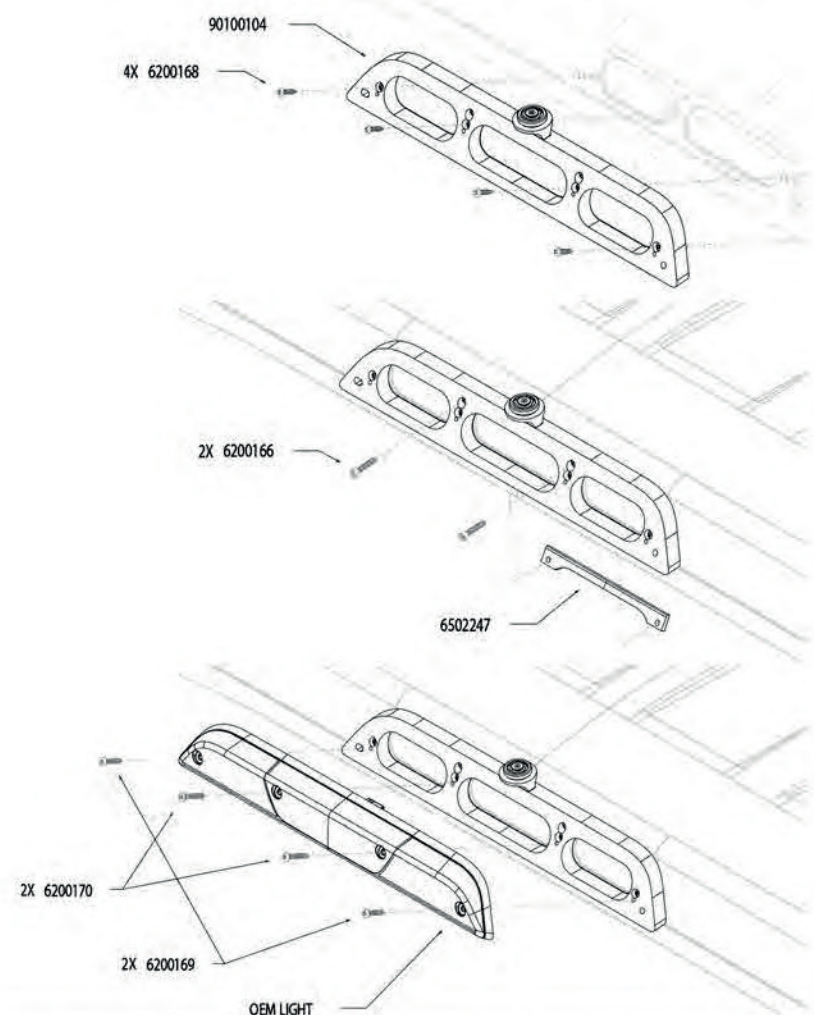

Part #	Description	Qty.
90100104	2015+ F150, 2017+ Super Duty Antenna Mount Assembly	1
6502247	2015+ F150, 2017+ Super Duty Antenna Mount Support Bracket	1
6200166	#10-24 x 1" Socket Head Cap Screw, 18-8 SS	2
6200168	#8 x 7/8" Pan Head Sheet Metal Screw, 18-8 SS	4
6200169	#10-24 x 1" Button Head Cap Screw, 18-8 SS	2
6200170	#10-24 x 1 1/4" Button Head Cap Screw, 18-8 SS	2

REMOVE LIGHT

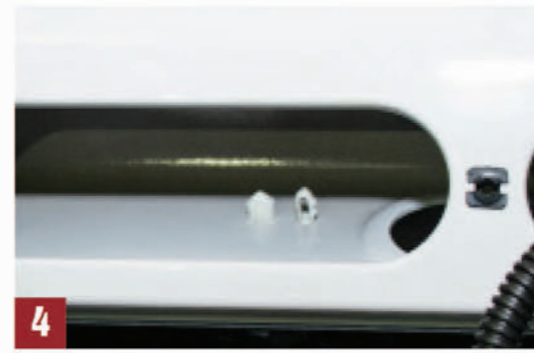
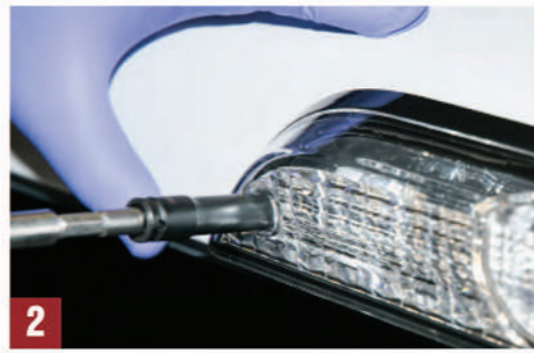

**Fig. 2-3** Using a 9/32"(7mm) nut driver, remove the four (4) screws holding the housing in place and pull away from the cab.  
**Fig. 4-7** Disconnect the light housing at the pigtail connector - not at the light. Access the connector by pushing down on the clips and pulling through the opening on the right. Disconnect by pressing down on the retaining clip, then slide away from each other. Place the removed housing in a safe location to be re-installed later.

INSTALL ADAPTER

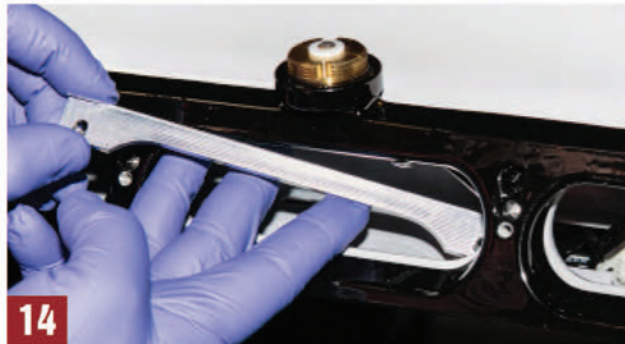
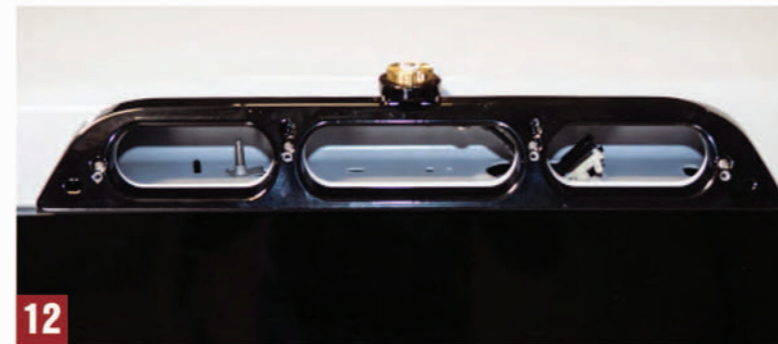

**Fig. 8** Route the antenna cable into the cab - follow the brake light harness. From inside the cab, access the cable and route to final desired location.  
**Fig. 9-12** To attach the antenna adapter, align and attach the adapter utilizing the four (4) factory mounting holes and the provided phillips pan head screws.  
**Fig. 13-15** Keep the adapter secured in place. Using the adapter's two (2) top center holes as a guide, drill through the truck body with a 3/16" bit. Next, feed the support bracket through the middle hole of the adapter. Slide the support bracket behind the adapter and the truck body then, match up the support bracket's holes with the ones you just drilled. Use the provided socket head cap screws to secure the support bracket in place.

RE-INSTALL LIGHT

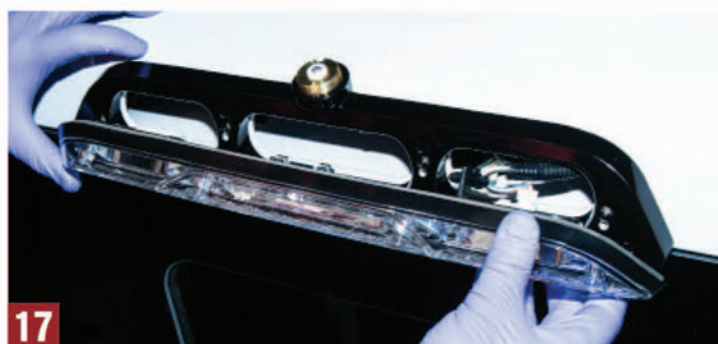

**Fig. 16** Re-connect the light housing in the reverse manner as removal. With the power harness attached, route back through the opening and with the clips aligned with the small openings push up to attach back in place.  
**Fig. 17-19** Re-install the light housing utilizing the provided longer button head cap screws for the middle two (2) holes and the shorter button head cap screws for the outer two (2) holes. With the 3rd Brake Light Antenna Adapter installed, attach desired compatible antenna with NMO standard threaded antenna connector and fasten the PL-259 male UHF connector to preferred 2-way radio.

# THIRD BRAKE LIGHT ANTENNA ADAPTER

2009-2014 F-150 Truck Body  
2010-2014 Raptor

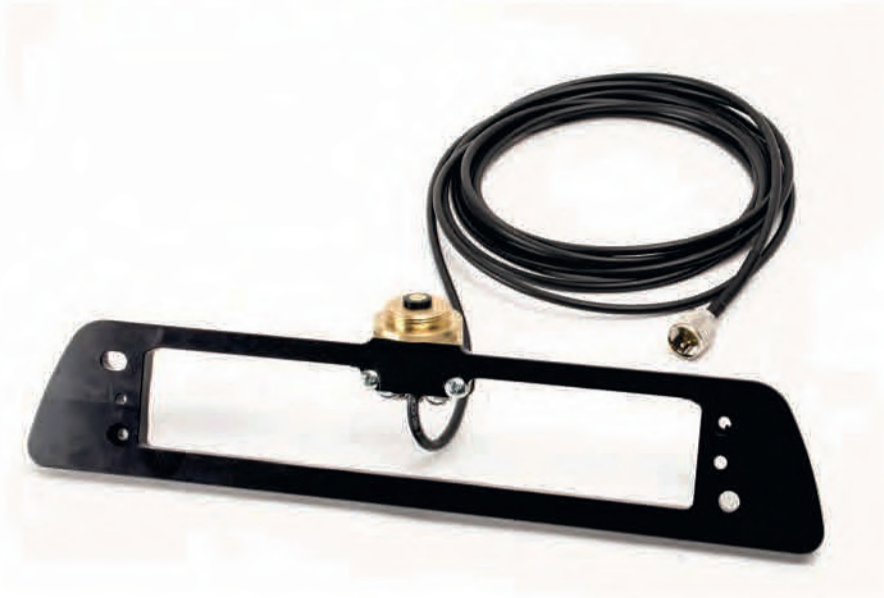

## Introduction

Thank you for your purchase of our vehicle specific Third Brake Light Antenna Adapter! We hope that you find the installation simple and straightforward. As our customer, your satisfaction is important to us, and for that reason we take pride in all of the products that we design and manufacture to ensure a reliable solution for years to come!

## Pre-caution

Upon completing the installation of the Third Brake Light Antenna Adapter the overall height clearance of the vehicle will have changed. Beware of your surroundings and heed all height restriction warnings as they pertain to your vehicle to avoid damage to the antenna, adapter or even vehicle.

## Warranty

At Neal Technologies, Inc we know that if we don't take care of the customer, someone else will. That is why we strive to make each and every customer experience as wonderful as possible.

With regards to our Third Brake Light Antenna Adapters, we offer a 1-Year Parts-Only Warranty.

The limitations include:

- Parts-only, exchange-only warranty.
- Warranty is limited to defects in workmanship and materials.
- Shipping is NOT included with warranty returns.

## Tools Needed for Installation

- Phillips Screwdriver
- Nut Driver 9/32"(7mm) and 1/4"



## Parts List - 90201128

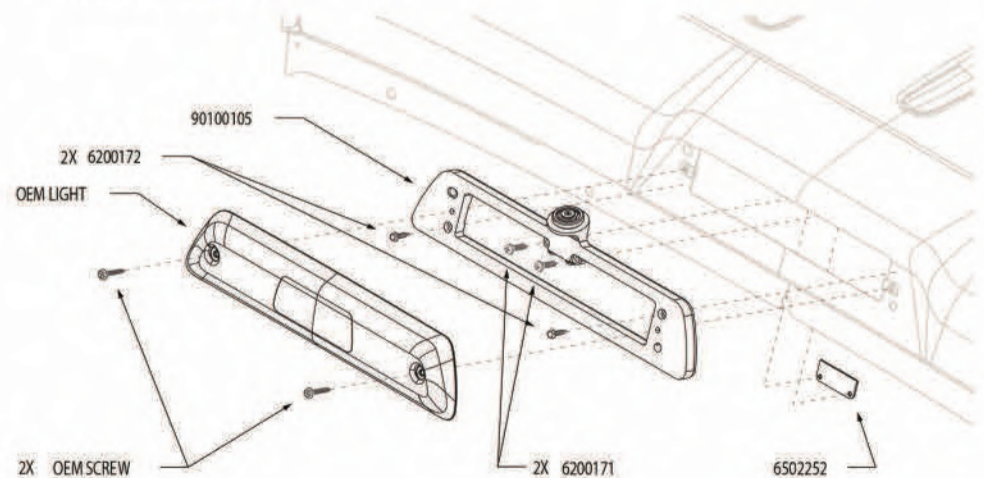

Part #	Description	Qty.
90100105	2009-2014 F150 Antenna Mount Assembly	1
6502252	2009-2014 F150 Antenna Mount Support Bracket	1
6200171	#10-24 x 3/4" Pan Head Screw, 18-8 SS	2
6200172	#8 x 3/4" Self-drilling Screw, 18-8 SS	2

**REMOVE LIGHT**

**Fig. 2-3** Using a 9/32" (7mm) nut driver remove the two (2) screws holding the housing in place and pull away from the cab. **Fig. 4-6** Disconnect the harness from the housing by rotating the bulbs counter-clockwise, then pull straight out to remove from the housing. Disconnect the power harness by pressing down on the retaining clip, then slide away from the housing.

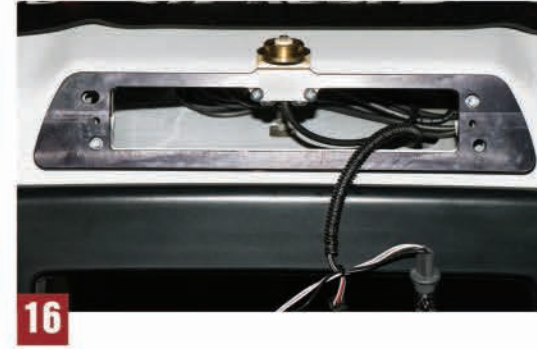
**INSTALL ADAPTER**

**Fig. 7** Route the antenna cable into the cab following the brake light harness. From inside the cab, access the cable and route to final desired location. **Fig. 8** Route the bulbs and harness through the middle of the antenna adapter. **Fig. 9-12** To attach the antenna adapter, position it just below the top of the opening on the cab to allow the support tab to clear the sheet metal. With the tab through the opening, slide up to align with the factory mounting holes. **Fig. 13-14** Using the factory installation screws, temporarily attach the adapter utilizing the factory mounting holes and hardware. Tighten the two (2) support tab screws to sandwich the cab between the tab and the adapter to finish adapter install. **Fig. 15** With the adapter in place, secure with the provided self-tapping screws and 1/4" nut driver. **NOTE:** Use of power tools can make hardware installation easier, but use **CAUTION** since you are working near a painted surface. **Fig. 16** Remove the factory installation screws.

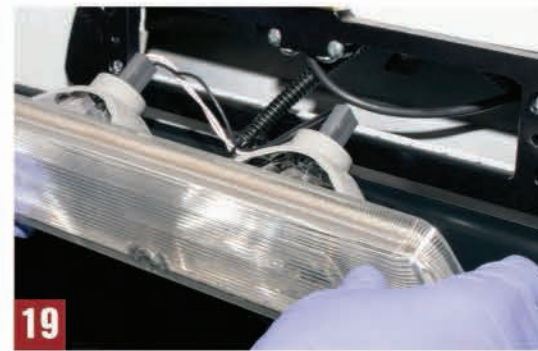
**RE-INSTALL LIGHT**

**Fig. 17-18** Attach the bulbs and power connector in the reverse manner as removal. **Fig. 19** Route the harness and back of the light housing to avoid interference with the antenna cable, as it is positioned back in place. **Fig. 20** Re-install the light housing utilizing the factory hardware. With the 3rd Brake Light Antenna Adapter installed, attach desired compatible antenna with NMO standard threaded antenna connector and fasten the PL-259 male UHF connector to preferred 2-way radio.