

ROCKER ARM SCREW

ESC-8348



Description: ROCKER ARM SCREW
SKU: ESC-8348
OEM: 417GC315M
Product Group: ENGINE PARTS
Product Class: VALVES & VALVE TRAIN, ROCKER COVER PARTS
UPC Code: 193807258573
Sell Pack: 3 EA
 (Available to buy in increments of 3)
Weight: 0.24 LBS
Warranty: 2 Years



Details:
 Rocker Arm Screw
 E-Tech
 without Brake

E-Catalog Pages:

Catalog Page	Description
	<p>PAI Mack & Volvo Applications 2018 Rocker Arm Assembly E7, E-Tech, ASET - E7 Series</p>

Copyright © 2020 PAI Industries, Inc.
 All rights reserved. All content is property of PAI Industries, Inc. and may not be reproduced or redistributed in any form.

Any reference to OEM names or OEM product identification numbers/descriptions/model numbers is for identification only and does not indicate that it is an OEM part. PAI is not affiliated with Mack Truck, Inc.®, Volvo®, Fuller®, Cummins®, Eaton®, Rockwell®, Caterpillar®, Freightliner®, Hendrickson®, Kenworth®, Detroit Diesel®, International®, Peterbilt®, or Dana®. All Manufacturer's names, numbers, symbols and descriptions are used for reference only. It is not implied that any part listed is the product of these manufacturers.

ROCKER ARM SCREW

ESC-8348

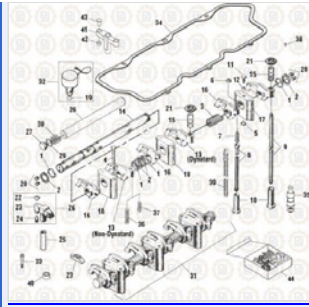

Volvo / Renault Engine Components 2015
Rocker Arm Assembly - Renault / E-Tech

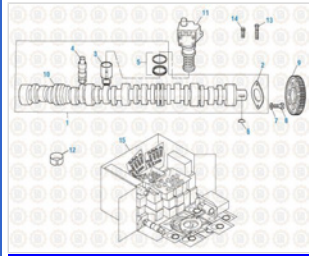

PAI Mack & Volvo Applications 2018
E-Tech E-Tech, ASET - E7 Series

Volvo / Renault Engine Components 2015
Camshaft - E-Tech - Renault / E-Tech

Component Of:

SKU	Image	Description
ECK-9059-100		CAMSHAFT INTALLATION KIT

Cross Reference:

Manufacturer	OEM Number
MACK	20706559
MACK	417GC31M
MACK	25105721
MACK	417GC315M

Copyright © 2020 PAI Industries, Inc.
All rights reserved. All content is property of PAI Industries, Inc. and may not be reproduced or redistributed in any form.

Any reference to OEM names or OEM product identification numbers/descriptions/model numbers is for identification only and does not indicate that it is an OEM part. PAI is not affiliated with Mack Truck, Inc.®, Volvo®, Fuller®, Cummins®, Eaton®, Rockwell®, Caterpillar®, Freightliner®, Hendrickson®, Kenworth®, Detroit Diesel®, International®, Peterbilt®, or Dana®. All Manufacturer's names, numbers, symbols and descriptions are used for reference only. It is not implied that any part listed is the product of these manufacturers.