

# GEAR SET

# 808156



<b>Description:</b>	GEAR SET
<b>SKU:</b>	808156
<b>OEM:</b>	24KH21
<b>Product Group:</b>	DIFFERENTIAL
<b>Product Class:</b>	GEAR SETS
<b>UPC Code:</b>	193807243708
<b>Sell Pack:</b>	1 EA
<b>Weight:</b>	34.20 LBS
<b>Package Dimensions (LxWxH):</b>	9 x 9 x 15 inches
<b>Warranty:</b>	2 Years



Details:
Gear Set 19/23 T 3.56, 3.79, 3.98 Ratio Mack CRD 150 / 151 Series application

E-Catalog Pages:	
Catalog Page	Description
	<b>Drive Train 2016</b> CRD 150

Copyright © 2020 PAI Industries, Inc.  
 All rights reserved. All content is property of PAI Industries, Inc. and may not be reproduced or redistributed in any form.

Any reference to OEM names or OEM product identification numbers/descriptions/model numbers is for identification only and does not indicate that it is an OEM part. PAI is not affiliated with Mack Truck, Inc.®, Volvo®, Fuller®, Cummins®, Eaton®, Rockwell®, Caterpillar®, Freightliner®, Hendrickson®, Kenworth®, Detroit Diesel®, International®, Peterbilt®, or Dana®. All Manufacturer's names, numbers, symbols and descriptions are used for reference only. It is not implied that any part listed is the product of these manufacturers.

# GEAR SET

# 808156

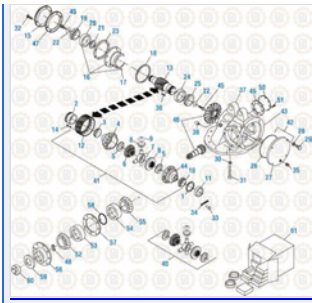

**PAI Mack & Volvo Applications 2018**  
Components - CRD 151



**Drive Train 2016**  
Gear Ratio Application Chart - CRD 150, CRD 151

**Cross Reference:**

Manufacturer	OEM Number
MACK	21130772
MACK	24KH21
VOLVO	21130772

**Copyright © 2020 PAI Industries, Inc.**  
All rights reserved. All content is property of PAI Industries, Inc, and may not be reproduced or redistributed in any form.

Any reference to OEM names or OEM product identification numbers/descriptions/model numbers is for identification only and does not indicate that it is an OEM part. PAI is not affiliated with Mack Truck, Inc.®, Volvo®, Fuller®, Cummins®, Eaton®, Rockwell®, Caterpillar®, Freightliner®, Hendrickson®, Kenworth®, Detroit Diesel®, International®, Peterbilt®, or Dana®. All Manufacturer's names, numbers, symbols and descriptions are used for reference only. It is not implied that any part listed is the product of these manufacturers.