

# WASHER

# BWA-3050



**Description:** WASHER  
**SKU:** BWA-3050  
**OEM:** 37KH27A  
**Product Group:** TRANSMISSION  
**Product Class:** GEARS, SHAFTS, CLUTCHES  
**UPC Code:** 193807201197  
**Sell Pack:** 4 EA  
 (Available to buy in increments of 4)  
**Weight:** 0.47 LBS  
**Warranty:** 2 Years



**Details:**

Differential Pinion Thrust Washer  
 3.025in O.D.  
 Mack CRDPC 92 / 93 / 112 Differential application  
 Mack CRD 93/A / 113 Differential application

**E-Catalog Pages:**

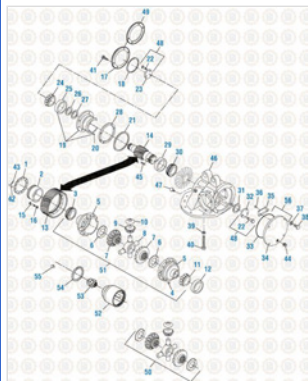
Catalog Page	Description
	<p><b>Drive Train 2016</b>                  CRDPC 92/112</p>

**Copyright © 2020 PAI Industries, Inc.**  
 All rights reserved. All content is property of PAI Industries, Inc. and may not be reproduced or redistributed in any form.

Any reference to OEM names or OEM product identification numbers/descriptions/model numbers is for identification only and does not indicate that it is an OEM part. PAI is not affiliated with Mack Truck, Inc.®, Volvo®, Fuller®, Cummins®, Eaton®, Rockwell®, Caterpillar®, Freightliner®, Hendrickson®, Kenworth®, Detroit Diesel®, International®, Peterbilt®, or Dana®. All Manufacturer's names, numbers, symbols and descriptions are used for reference only. It is not implied that any part listed is the product of these manufacturers.

# WASHER

# BWA-3050

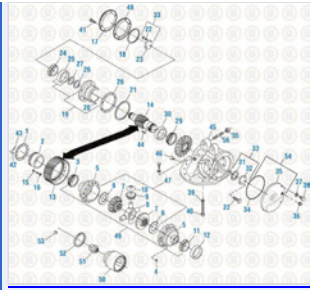

**Drive Train 2016**  
CRD 93/113

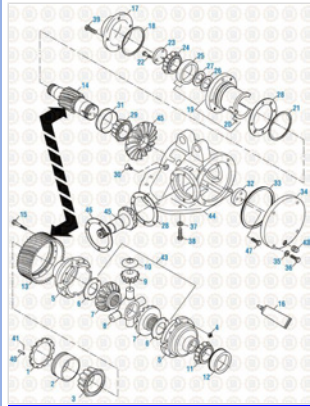

**Drive Train 2016**  
CRD 93A

**Component Of:**

SKU	Image	Description
<a href="#">EM21550</a>	.	DIFFERENTIAL NEST KIT
<a href="#">EM21560</a>	.	DIFFERENTIAL NEST KIT
<a href="#">BNK-2155</a>	.	DIFFERENTIAL NEST KIT
<a href="#">BNK-2156</a>	.	DIFFERENTIAL NEST KIT
<a href="#">808130</a>	.	NEST KIT
<a href="#">808130HP</a>	.	HP NEST KIT

**Cross Reference:**

Manufacturer	OEM Number
MACK	25499008
MACK	37KH128A
MACK	37KH24
MACK	37KH27
MACK	37KH27A

Copyright © 2020 PAI Industries, Inc.  
All rights reserved. All content is property of PAI Industries, Inc. and may not be reproduced or redistributed in any form.

Any reference to OEM names or OEM product identification numbers/descriptions/model numbers is for identification only and does not indicate that it is an OEM part. PAI is not affiliated with Mack Truck, Inc.®, Volvo®, Fuller®, Cummins®, Eaton®, Rockwell®, Caterpillar®, Freightliner®, Hendrickson®, Kenworth®, Detroit Diesel®, International®, Peterbilt®, or Dana®. All Manufacturer's names, numbers, symbols and descriptions are used for reference only. It is not implied that any part listed is the product of these manufacturers.