

RETAINING RING

GRI-2734



Description: RETAINING RING
SKU: GRI-2734
OEM: 97AX151
Product Group: TRANSMISSION
Product Class: SYNCHRONIZERS & RELATED PARTS
UPC Code: 193807196134
Sell Pack: 10 EA
 (Available to buy in increments of 10)
Weight: 0.29 LBS
Warranty: 2 Years



Details:
 External Retaining Ring
 2.197in Free O.D. x 0.078in Thick
 55.8mm Free O.D. x 1.98mm Thick

E-Catalog Pages:

Catalog Page	Description
	Web Electronic Main Case Components - Mack Transmission

Copyright © 2020 PAI Industries, Inc.
 All rights reserved. All content is property of PAI Industries, Inc. and may not be reproduced or redistributed in any form.

Any reference to OEM names or OEM product identification numbers/descriptions/model numbers is for identification only and does not indicate that it is an OEM part. PAI is not affiliated with Mack Truck, Inc.®, Volvo®, Fuller®, Cummins®, Eaton®, Rockwell®, Caterpillar®, Freightliner®, Hendrickson®, Kenworth®, Detroit Diesel®, International®, Peterbilt®, or Dana®. All Manufacturer's names, numbers, symbols and descriptions are used for reference only. It is not implied that any part listed is the product of these manufacturers.

RETAINING RING

GRI-2734

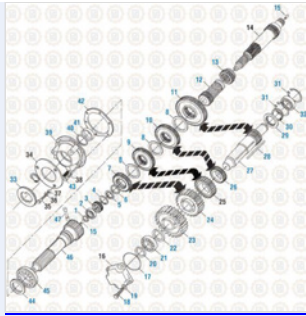

Web Electronic
Main Case Components - Mack Transmission

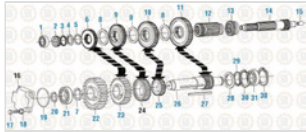

Web Electronic
Main Case Components - Mack Transmission

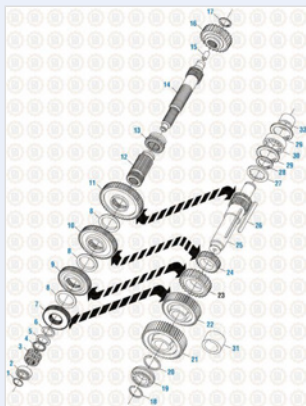

Drive Train 2016
Main Case Components - TRTXL-107/1070

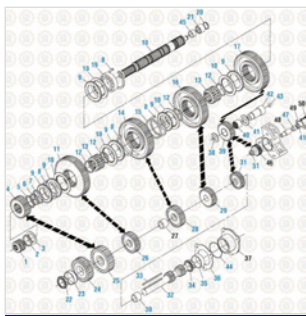

Drive Train 2016
Main Case Components - T2080B

Copyright © 2020 PAI Industries, Inc.
All rights reserved. All content is property of PAI Industries, Inc. and may not be reproduced or redistributed in any form.

Any reference to OEM names or OEM product identification numbers/descriptions/model numbers is for identification only and does not indicate that it is an OEM part. PAI is not affiliated with Mack Truck, Inc.®, Volvo®, Fuller®, Cummins®, Eaton®, Rockwell®, Caterpillar®, Freightliner®, Hendrickson®, Kenworth®, Detroit Diesel®, International®, Peterbilt®, or Dana®. All Manufacturer's names, numbers, symbols and descriptions are used for reference only. It is not implied that any part listed is the product of these manufacturers.

RETAINING RING

GRI-2734

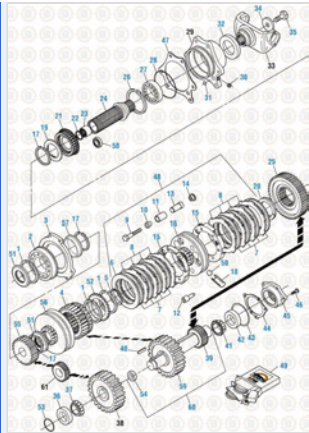

Drive Train 2016
Rear Case Components - T2080B

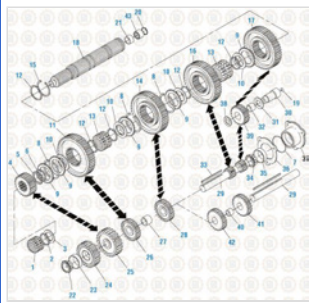

Drive Train 2016
Main Case Components - T2080, T2090 and T2100

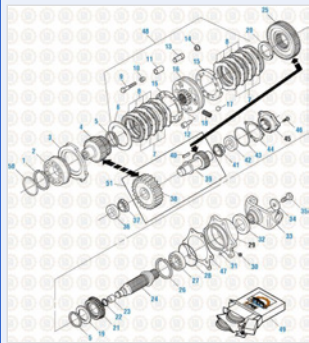

Drive Train 2016
Rear Case Components - Original Design Synchronizer - T2080, T2090 and T2100

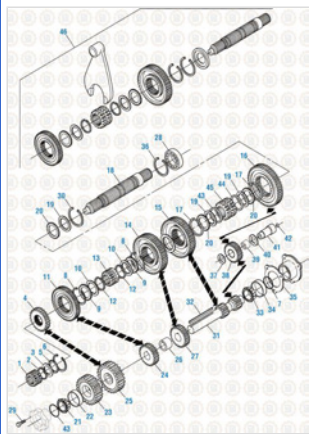

Drive Train 2016
Main Case Components - Original Mainshaft Design - T2050

Copyright © 2020 PAI Industries, Inc.
All rights reserved. All content is property of PAI Industries, Inc. and may not be reproduced or redistributed in any form.

Any reference to OEM names or OEM product identification numbers/descriptions/model numbers is for identification only and does not indicate that it is an OEM part. PAI is not affiliated with Mack Truck, Inc.®, Volvo®, Fuller®, Cummins®, Eaton®, Rockwell®, Caterpillar®, Freightliner®, Hendrickson®, Kenworth®, Detroit Diesel®, International®, Peterbilt®, or Dana®. All Manufacturer's names, numbers, symbols and descriptions are used for reference only. It is not implied that any part listed is the product of these manufacturers.

RETAINING RING

GRI-2734

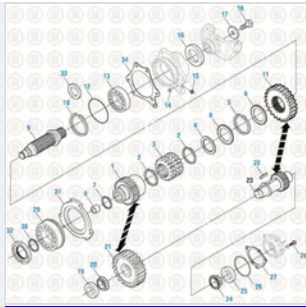

Drive Train 2016
Rear Case Components - T2060 & T2070

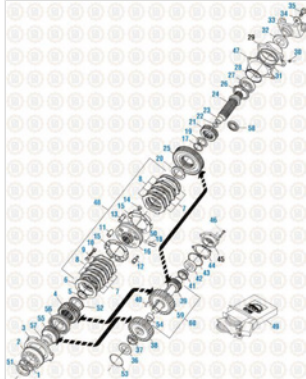

Drive Train 2016
Rear Case Components - T2130 and T2180

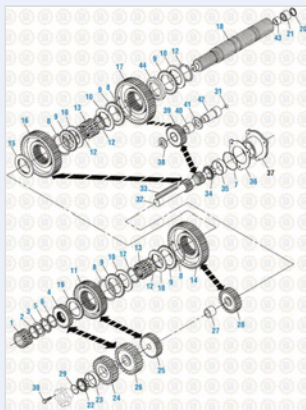

Drive Train 2016
Main Case Components - T2060 & T2070

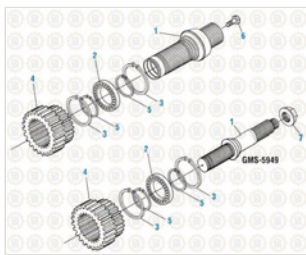

Drive Train 2016
Auxiliary Mainshaft Update - T2130 and T2180

Copyright © 2020 PAI Industries, Inc.
All rights reserved. All content is property of PAI Industries, Inc. and may not be reproduced or redistributed in any form.

Any reference to OEM names or OEM product identification numbers/descriptions/model numbers is for identification only and does not indicate that it is an OEM part. PAI is not affiliated with Mack Truck, Inc.®, Volvo®, Fuller®, Cummins®, Eaton®, Rockwell®, Caterpillar®, Freightliner®, Hendrickson®, Kenworth®, Detroit Diesel®, International®, Peterbilt®, or Dana®. All Manufacturer's names, numbers, symbols and descriptions are used for reference only. It is not implied that any part listed is the product of these manufacturers.

RETAINING RING

GRI-2734

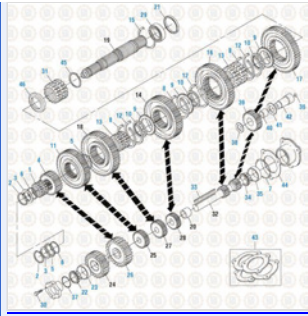

Drive Train 2016
Main Case Components - T2060A

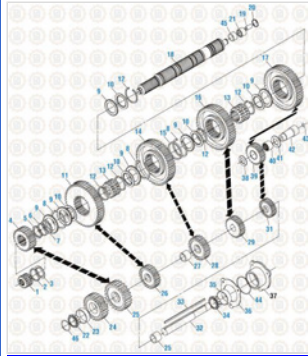

Drive Train 2016
Main Case Components - T2130 and T2180

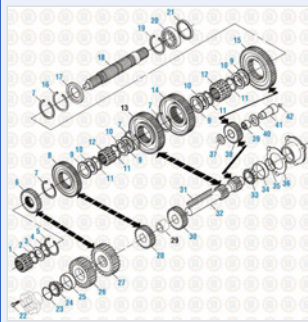

Drive Train 2016
Main Case Components - Current Mainshaft Design - T2050

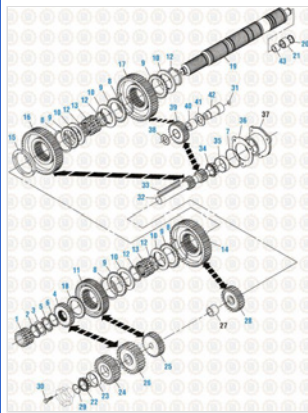

Drive Train 2016
Main Case Components - T2070 A & C

Copyright © 2020 PAI Industries, Inc.
All rights reserved. All content is property of PAI Industries, Inc. and may not be reproduced or redistributed in any form.

Any reference to OEM names or OEM product identification numbers/descriptions/model numbers is for identification only and does not indicate that it is an OEM part. PAI is not affiliated with Mack Truck, Inc.®, Volvo®, Fuller®, Cummins®, Eaton®, Rockwell®, Caterpillar®, Freightliner®, Hendrickson®, Kenworth®, Detroit Diesel®, International®, Peterbilt®, or Dana®. All Manufacturer's names, numbers, symbols and descriptions are used for reference only. It is not implied that any part listed is the product of these manufacturers.

RETAINING RING

GRI-2734

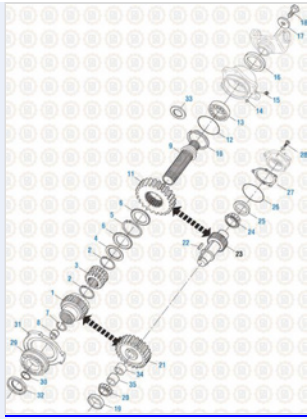

Drive Train 2016
Rear Case Components - T2070 A & C

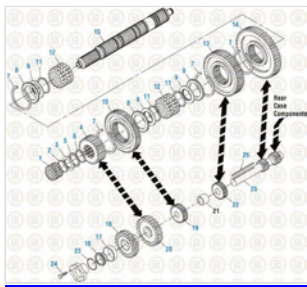

Drive Train 2016
Main Case Components - Long Rear Case, Multi-Speed Reverse, Rear Mounted Main Shifter - T2070 B & D

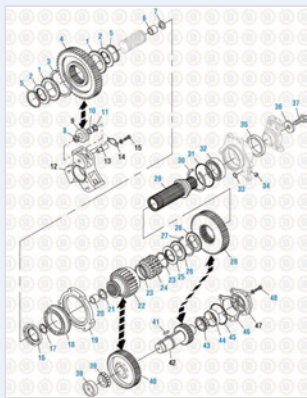

Drive Train 2016
Rear Case Components - T2070 B & D

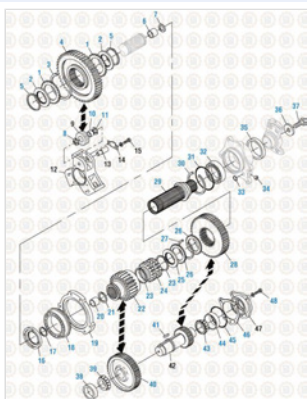

Drive Train 2016
Rear Case Components - T2070 B & D

Copyright © 2020 PAI Industries, Inc.
All rights reserved. All content is property of PAI Industries, Inc. and may not be reproduced or redistributed in any form.

Any reference to OEM names or OEM product identification numbers/descriptions/model numbers is for identification only and does not indicate that it is an OEM part. PAI is not affiliated with Mack Truck, Inc.®, Volvo®, Fuller®, Cummins®, Eaton®, Rockwell®, Caterpillar®, Freightliner®, Hendrickson®, Kenworth®, Detroit Diesel®, International®, Peterbilt®, or Dana®. All Manufacturer's names, numbers, symbols and descriptions are used for reference only. It is not implied that any part listed is the product of these manufacturers.

RETAINING RING

GRI-2734

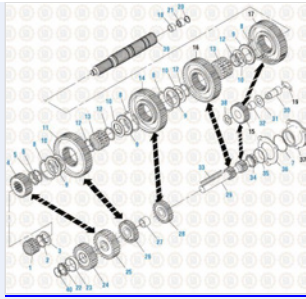

Drive Train 2016
Main Case Components - T309L and T310

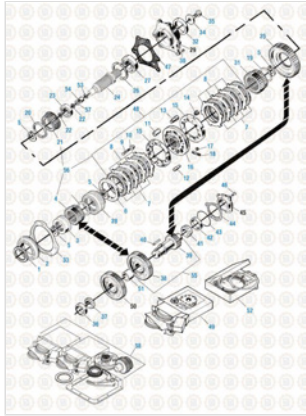

Drive Train 2016
Rear Case Components - T309L and T310

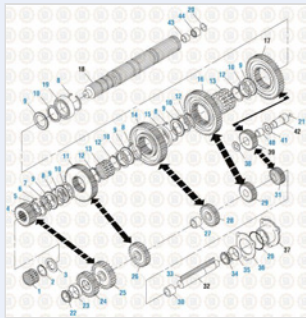

Drive Train 2016
Main Case Components - T2110 B and D

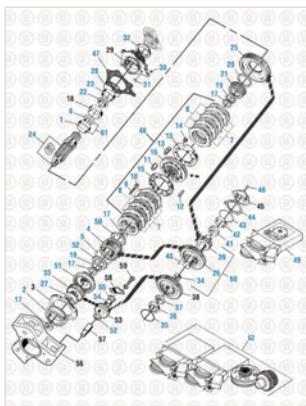

Drive Train 2016
Rear Case Components - T2110 B and D

Copyright © 2020 PAI Industries, Inc.
All rights reserved. All content is property of PAI Industries, Inc. and may not be reproduced or redistributed in any form.

Any reference to OEM names or OEM product identification numbers/descriptions/model numbers is for identification only and does not indicate that it is an OEM part. PAI is not affiliated with Mack Truck, Inc.®, Volvo®, Fuller®, Cummins®, Eaton®, Rockwell®, Caterpillar®, Freightliner®, Hendrickson®, Kenworth®, Detroit Diesel®, International®, Peterbilt®, or Dana®. All Manufacturer's names, numbers, symbols and descriptions are used for reference only. It is not implied that any part listed is the product of these manufacturers.

RETAINING RING

GRI-2734

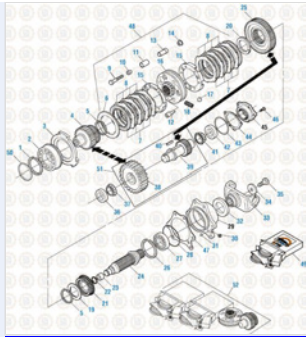
**Drive Train 2016**

Rear Case Components - Updated Design Synchronizer - T2080, T2090 and T2100

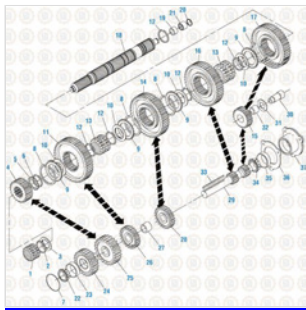
**Drive Train 2016**

Main Case Components - T313L and T318L

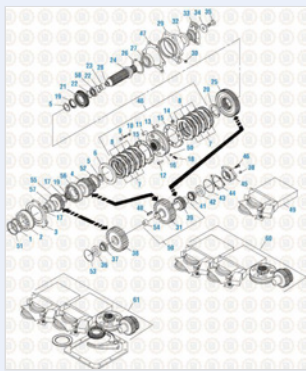
**Drive Train 2016**

Rear Case Components - T313L and T318L

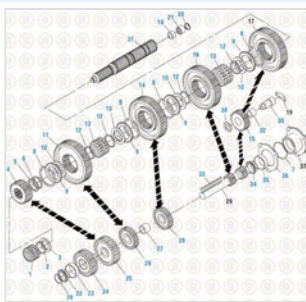
**Drive Train 2016**

Main Case Components - T310M

Copyright © 2020 PAI Industries, Inc.

All rights reserved. All content is property of PAI Industries, Inc. and may not be reproduced or redistributed in any form.

Any reference to OEM names or OEM product identification numbers/descriptions/model numbers is for identification only and does not indicate that it is an OEM part. PAI is not affiliated with Mack Truck, Inc.®, Volvo®, Fuller®, Cummins®, Eaton®, Rockwell®, Caterpillar®, Freightliner®, Hendrickson®, Kenworth®, Detroit Diesel®, International®, Peterbilt®, or Dana®. All Manufacturer's names, numbers, symbols and descriptions are used for reference only. It is not implied that any part listed is the product of these manufacturers.

RETAINING RING

GRI-2734

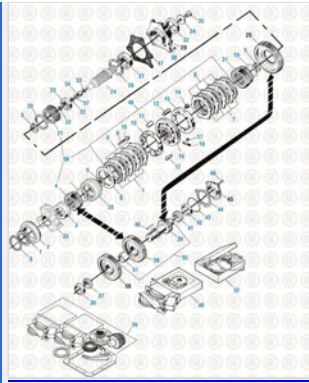

Drive Train 2016
Rear Case Components - T310M

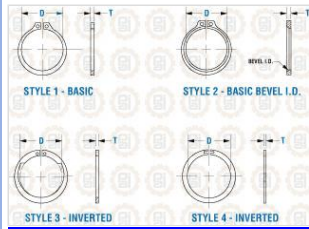

Hardware
External - Basic and Inverted

Component Of:

SKU	Image	Description
GKT-2502	.	MAINSHAFT KIT
GRK-2771		RING KIT
GRK-2774		RETAINING RING KIT
GRK-3973-100	.	O-RING KIT
GBK-6562-100	.	RETAINING RING KIT
GBK-6563-100	.	O-RING KIT
GBK-6572-100	.	RING KIT
GBK-6573-100	.	RETAINING RING KIT
GBK-8955-100	.	RETAINING RING KIT
GBK-8956-100	.	RETAINING RING KIT

Copyright © 2020 PAI Industries, Inc.
All rights reserved. All content is property of PAI Industries, Inc. and may not be reproduced or redistributed in any form.

Any reference to OEM names or OEM product identification numbers/descriptions/model numbers is for identification only and does not indicate that it is an OEM part. PAI is not affiliated with Mack Truck, Inc.®, Volvo®, Fuller®, Cummins®, Eaton®, Rockwell®, Caterpillar®, Freightliner®, Hendrickson®, Kenworth®, Detroit Diesel®, International®, Peterbilt®, or Dana®. All Manufacturer's names, numbers, symbols and descriptions are used for reference only. It is not implied that any part listed is the product of these manufacturers.

RETAINING RING

GRI-2734

[ERK-8997](#)



RING KIT

[806804](#)



SYNCHRONIZER REPAIR KIT

Cross Reference:

Manufacturer	OEM Number
MACK	25501488
MACK	97AX151
MACK	97AX289

Copyright © 2020 PAI Industries, Inc.
 All rights reserved. All content is property of PAI Industries, Inc. and may not be reproduced or redistributed in any form.

Any reference to OEM names or OEM product identification numbers/descriptions/model numbers is for identification only and does not indicate that it is an OEM part. PAI is not affiliated with Mack Truck, Inc.®, Volvo®, Fuller®, Cummins®, Eaton®, Rockwell®, Caterpillar®, Freightliner®, Hendrickson®, Kenworth®, Detroit Diesel®, International®, Peterbilt®, or Dana®. All Manufacturer's names, numbers, symbols and descriptions are used for reference only. It is not implied that any part listed is the product of these manufacturers.