

RETAINING RING

GRI-2701

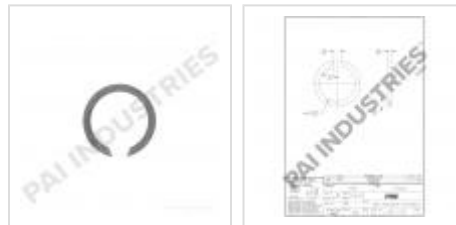

Description: RETAINING RING
SKU: GRI-2701
OEM: 97AX54
Product Group: TRANSMISSION
Product Class: GEARS, SHAFTS, CLUTCHES
UPC Code: 193807195564
Sell Pack: 10 EA
 (Available to buy in increments of 10)
Weight: 0.07 LBS
Warranty: 2 Years



Details:

External Retaining Ring, 0.91in Free I.D. x 0.109in Wide x 0.062in Thick
 23.11mm Free I.D. x 2.76mm Wide x 1.57mm Thick

E-Catalog Pages:

Catalog Page	Description
	<p>Web Electronic Main Case Components - Mack Transmission</p>

Copyright © 2020 PAI Industries, Inc.
 All rights reserved. All content is property of PAI Industries, Inc. and may not be reproduced or redistributed in any form.

Any reference to OEM names or OEM product identification numbers/descriptions/model numbers is for identification only and does not indicate that it is an OEM part. PAI is not affiliated with Mack Truck, Inc.®, Volvo®, Fuller®, Cummins®, Eaton®, Rockwell®, Caterpillar®, Freightliner®, Hendrickson®, Kenworth®, Detroit Diesel®, International®, Peterbilt®, or Dana®. All Manufacturer's names, numbers, symbols and descriptions are used for reference only. It is not implied that any part listed is the product of these manufacturers.

RETAINING RING

GRI-2701

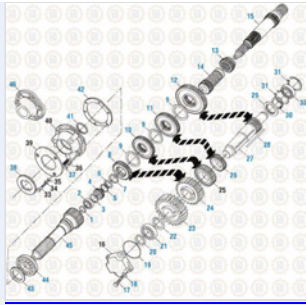

Web Electronic
Main Case Components - Mack Transmission

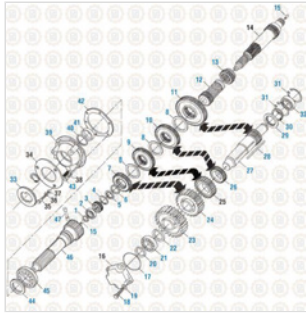

Web Electronic
Main Case Components - Mack Transmission

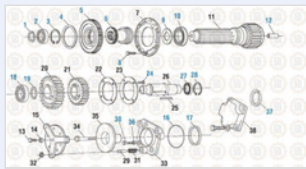

Web Electronic
Compound Case Components - Mack Transmission

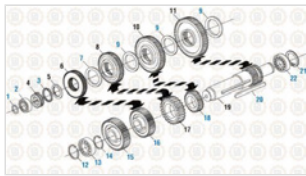

Web Electronic
Main Case Components - Mack Transmission

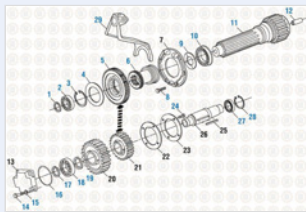

Drive Train 2016
Compound Case Components - TRTXL-107/1070

Copyright © 2020 PAI Industries, Inc.
All rights reserved. All content is property of PAI Industries, Inc, and may not be reproduced or redistributed in any form.

Any reference to OEM names or OEM product identification numbers/descriptions/model numbers is for identification only and does not indicate that it is an OEM part. PAI is not affiliated with Mack Truck, Inc.®, Volvo®, Fuller®, Cummins®, Eaton®, Rockwell®, Caterpillar®, Freightliner®, Hendrickson®, Kenworth®, Detroit Diesel®, International®, Peterbilt®, or Dana®. All Manufacturer's names, numbers, symbols and descriptions are used for reference only. It is not implied that any part listed is the product of these manufacturers.

RETAINING RING

GRI-2701

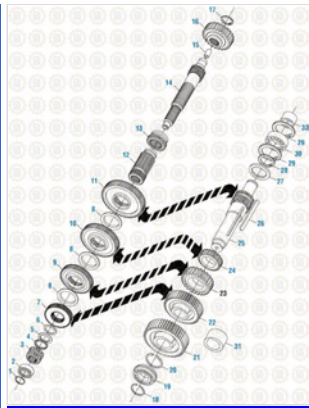

Drive Train 2016
Main Case Components - TRTXL-107/1070

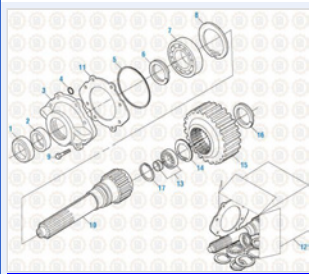

Drive Train 2016
Input Shaft Components - T2080B

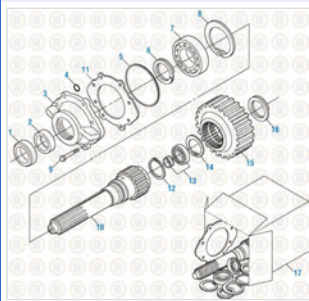

Drive Train 2016
Input Shaft - T2080, T2090 and T2100

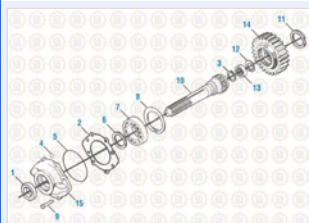

Drive Train 2016
Input Shaft Components - T2060A

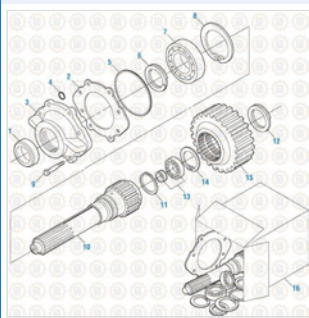

Drive Train 2016
Input Shaft Components - T2110 B and D

Copyright © 2020 PAI Industries, Inc.
All rights reserved. All content is property of PAI Industries, Inc. and may not be reproduced or redistributed in any form.

Any reference to OEM names or OEM product identification numbers/descriptions/model numbers is for identification only and does not indicate that it is an OEM part. PAI is not affiliated with Mack Truck, Inc.®, Volvo®, Fuller®, Cummins®, Eaton®, Rockwell®, Caterpillar®, Freightliner®, Hendrickson®, Kenworth®, Detroit Diesel®, International®, Peterbilt®, or Dana®. All Manufacturer's names, numbers, symbols and descriptions are used for reference only. It is not implied that any part listed is the product of these manufacturers.

RETAINING RING

GRI-2701

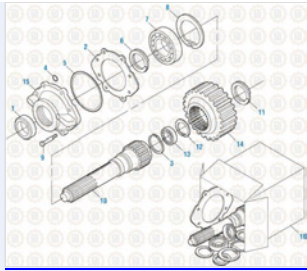

Drive Train 2016
Input Shaft Components - T2050

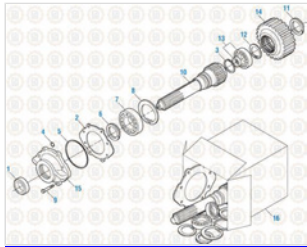

Drive Train 2016
Input Shaft Components - T2060 & T2070

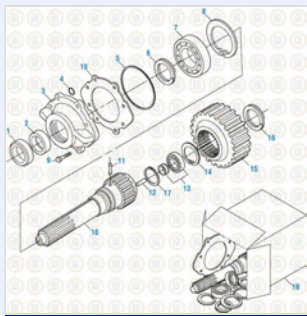

Drive Train 2016
Input Shaft Components - T2130 and T2180

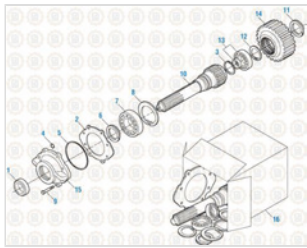

Drive Train 2016
Input Shaft Components - T2070 A & C

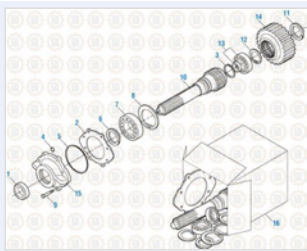

Drive Train 2016
Input Shaft Components - T2070 B & D

Copyright © 2020 PAI Industries, Inc.

All rights reserved. All content is property of PAI Industries, Inc. and may not be reproduced or redistributed in any form.

Any reference to OEM names or OEM product identification numbers/descriptions/model numbers is for identification only and does not indicate that it is an OEM part. PAI is not affiliated with Mack Truck, Inc.®, Volvo®, Fuller®, Cummins®, Eaton®, Rockwell®, Caterpillar®, Freightliner®, Hendrickson®, Kenworth®, Detroit Diesel®, International®, Peterbilt®, or Dana®. All Manufacturer's names, numbers, symbols and descriptions are used for reference only. It is not implied that any part listed is the product of these manufacturers.

RETAINING RING

GRI-2701

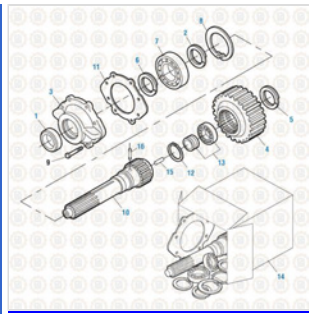

Drive Train 2016
T309L and T310 - Input Shaft - T309L and T310

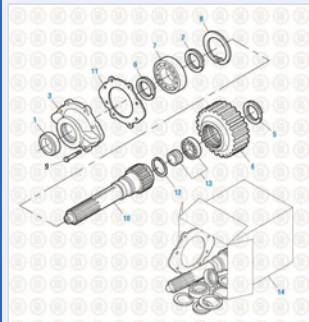

Drive Train 2016
Input Shaft - T313L and T318L

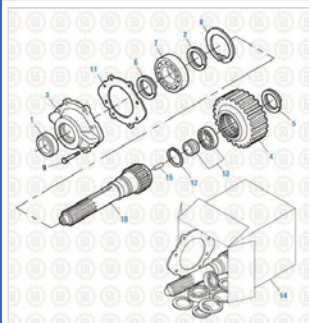

Drive Train 2016
Input Shaft - T310M

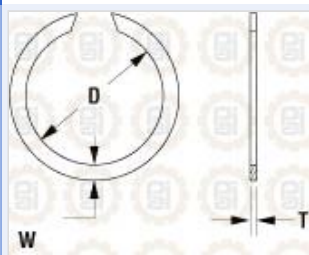

Hardware
External - Rectangular Section

Component Of:





SKU	Image	Description

Copyright © 2020 PAI Industries, Inc.
All rights reserved. All content is property of PAI Industries, Inc, and may not be reproduced or redistributed in any form.

Any reference to OEM names or OEM product identification numbers/descriptions/model numbers is for identification only and does not indicate that it is an OEM part. PAI is not affiliated with Mack Truck, Inc.®, Volvo®, Fuller®, Cummins®, Eaton®, Rockwell®, Caterpillar®, Freightliner®, Hendrickson®, Kenworth®, Detroit Diesel®, International®, Peterbilt®, or Dana®. All Manufacturer's names, numbers, symbols and descriptions are used for reference only. It is not implied that any part listed is the product of these manufacturers.

RETAINING RING

GRI-2701

GRK-2771		RING KIT
GRK-2774		RETAINING RING KIT
GRK-3973	.	O-RING/RETAINING RING TRANSMISSION KIT
GBK-6562-100	.	RETAINING RING KIT
GBK-6563-100	.	O-RING KIT
GBK-8955-100	.	RETAINING RING KIT
GBK-8956-100	.	RETAINING RING KIT
GBK-8957	.	BEARING AND SEAL KIT
GBK-8958-100	.	RETAINING RING KIT
ERK-8997		RING KIT
806850		INPUT SHAFT KIT

Cross Reference:	
Manufacturer	OEM Number
MACK	97AX54

Copyright © 2020 PAI Industries, Inc.
 All rights reserved. All content is property of PAI Industries, Inc. and may not be reproduced or redistributed in any form.

Any reference to OEM names or OEM product identification numbers/descriptions/model numbers is for identification only and does not indicate that it is an OEM part. PAI is not affiliated with Mack Truck, Inc.®, Volvo®, Fuller®, Cummins®, Eaton®, Rockwell®, Caterpillar®, Freightliner®, Hendrickson®, Kenworth®, Detroit Diesel®, International®, Peterbilt®, or Dana®. All Manufacturer's names, numbers, symbols and descriptions are used for reference only. It is not implied that any part listed is the product of these manufacturers.