

NUT

BNU-2318



Description: NUT
SKU: BNU-2318
OEM: 21AX907
Product Group: DIFFERENTIAL
Product Class: INTERNAL GEARS AND PARTS
UPC Code: 193807188672
Sell Pack: 1 EA
Weight: 0.50 LBS
Warranty: 2 Years



Details:

Nut
 Locking
 Nylon
 Flanged
 Thru Shaft
 1-1/2-18 Thread
 2-3/16in Flats x 3/4in Height

E-Catalog Pages:

| Catalog Page | Description |
|--------------|--|
| | <p>Drive Train 2016 CRDP 200/202</p> |

Copyright © 2020 PAI Industries, Inc.
 All rights reserved. All content is property of PAI Industries, Inc. and may not be reproduced or redistributed in any form.

Any reference to OEM names or OEM product identification numbers/descriptions/model numbers is for identification only and does not indicate that it is an OEM part. PAI is not affiliated with Mack Truck, Inc.®, Volvo®, Fuller®, Cummins®, Eaton®, Rockwell®, Caterpillar®, Freightliner®, Hendrickson®, Kenworth®, Detroit Diesel®, International®, Peterbilt®, or Dana®. All Manufacturer's names, numbers, symbols and descriptions are used for reference only. It is not implied that any part listed is the product of these manufacturers.

NUT

BNU-2318

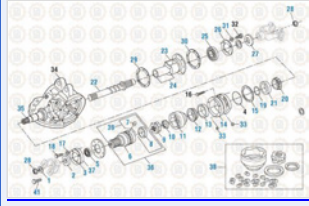

Drive Train 2016
CRD 150

Hardware
Nuts - Progressive Size Index (Inch)

Cross Reference:

| Manufacturer | OEM Number |
|--------------|------------|
| MACK | 21AX907 |
| MACK | 25110388 |

Copyright © 2020 PAI Industries, Inc.
All rights reserved. All content is property of PAI Industries, Inc, and may not be reproduced or redistributed in any form.

Any reference to OEM names or OEM product identification numbers/descriptions/model numbers is for identification only and does not indicate that it is an OEM part. PAI is not affiliated with Mack Truck, Inc.®, Volvo®, Fuller®, Cummins®, Eaton®, Rockwell®, Caterpillar®, Freightliner®, Hendrickson®, Kenworth®, Detroit Diesel®, International®, Peterbilt®, or Dana®. All Manufacturer's names, numbers, symbols and descriptions are used for reference only. It is not implied that any part listed is the product of these manufacturers.