

SPACER

EF10790



Description: SPACER
SKU: EF10790
OEM: 19203
Product Group: TRANSMISSION
Product Class: GEARS, SHAFTS, CLUTCHES
UPC Code: 193807100544
Sell Pack: 1 EA
Weight: 0.50 LBS
Warranty: 1 Year

Details:
 Spacer
 18 External Spline Teeth
 Fuller RT 14609 / 14610 Transmission Application

E-Catalog Pages:	
Catalog Page	Description
	<p>Drive Train 2016 Auxiliary Components - Current Style - RT/RTO/RTOO/RTLO 14613 and 14813</p>

Copyright © 2020 PAI Industries, Inc.
 All rights reserved. All content is property of PAI Industries, Inc. and may not be reproduced or redistributed in any form.

Any reference to OEM names or OEM product identification numbers/descriptions/model numbers is for identification only and does not indicate that it is an OEM part. PAI is not affiliated with Mack Truck, Inc.®, Volvo®, Fuller®, Cummins®, Eaton®, Rockwell®, Caterpillar®, Freightliner®, Hendrickson®, Kenworth®, Detroit Diesel®, International®, Peterbilt®, or Dana®. All Manufacturer's names, numbers, symbols and descriptions are used for reference only. It is not implied that any part listed is the product of these manufacturers.

SPACER

EF10790

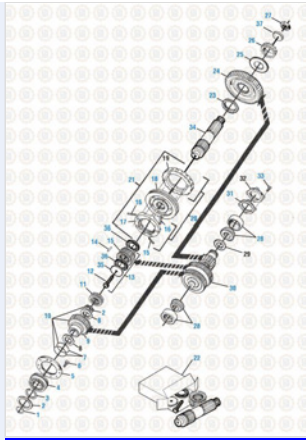

Drive Train 2016
 Auxiliary Components - RTLO 16618

Drive Train 2016
 Models RT 6609, 8609, 9509, 11509, 11709, 12509, 12709, 14609, 14909, 16709, 16909

Drive Train 2016
 Models RT/RTO/RTLO 11610, 14610, 14710, 15610, 16710/RTF 1110

Component Of:

SKU	Image	Description
EF26730		SMALL PARTS KIT

Cross Reference:

Manufacturer	OEM Number
FULLER	19203
NAVISTAR	588783C1

Copyright © 2020 PAI Industries, Inc.
 All rights reserved. All content is property of PAI Industries, Inc. and may not be reproduced or redistributed in any form.

Any reference to OEM names or OEM product identification numbers/descriptions/model numbers is for identification only and does not indicate that it is an OEM part. PAI is not affiliated with Mack Truck, Inc.®, Volvo®, Fuller®, Cummins®, Eaton®, Rockwell®, Caterpillar®, Freightliner®, Hendrickson®, Kenworth®, Detroit Diesel®, International®, Peterbilt®, or Dana®. All Manufacturer's names, numbers, symbols and descriptions are used for reference only. It is not implied that any part listed is the product of these manufacturers.