

Ford Truck Ball Joint Adapter Kit

See Legend next page.

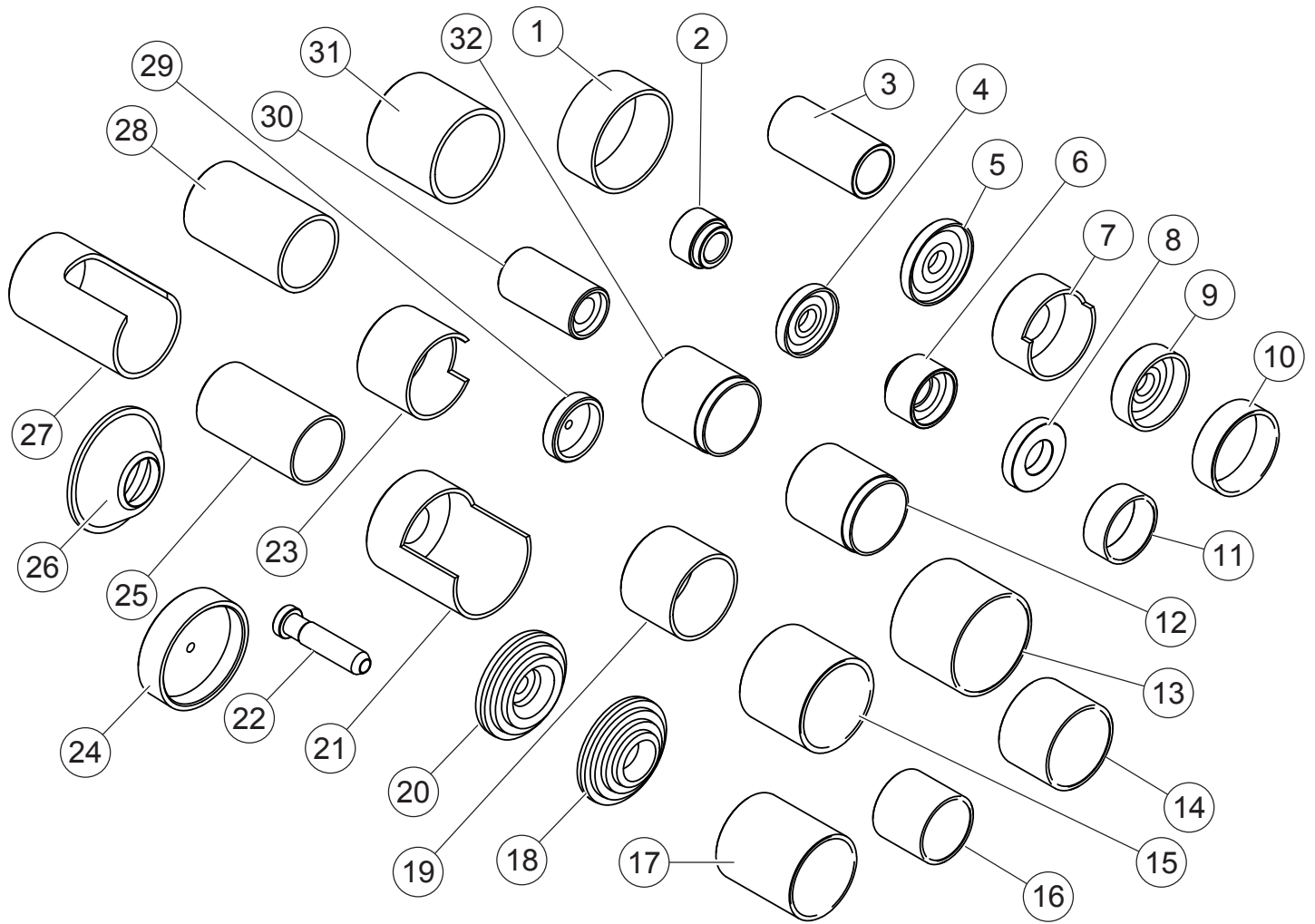

Ford Truck Ball Joint Adapter Kit Legend

Item No.	Part No.	Description	Item No.	Part No.	Description	Item No.	Part No.	Description
1	555532	Adapter	12	38354	Adapter	23	531739	Adapter
2	313968	Adapter	13	29503	Adapter	24	557010	Adapter
3	554419	Adapter	14	29504	Adapter	25	38355A	Adapter
4	554415	Adapter	15	222307	Adapter	26	556930	Adapter
5	555380	Adapter	16	29505	Adapter	27	554592	Adapter
6	554415	Adapter	17	222305	Adapter	28	555379	Adapter
7	555377	Adapter	18	305227	Adapter	29	554403	Adapter
8	555378	Adapter	19	39976	Adapter	30	538590	Adapter
9	204508A	Adapter	20	305228	Adapter	31	554478	Adapter
10	222304	Adapter	21	313444	Adapter	32	554413	Adapter
11	554422	Adapter	22	314392	Adapter			

TABLE OF CONTENTS

Ball Joint Adapter Kit	1
Table of Contents	3
Ball Joint Application Guide	6

Removal and Installation Instructions

Ford	Aerostar 2WD	1986-1997	Lower-Front	13
	Aerostar 4WD	1986-1997	Lower-Front	14
	Bronco Full Size	1980-1996	Lower-Front	15
	Bronco Full Size	1980-1996	Upper-Front	16
	Bronco II 4WD With Dana 28 axle	1984-1990	Lower-Front	17
	Bronco II 4WD With Dana 28 axle	1984-1990	Upper-Front	18
	Bronco II 4WD With Dana 35 axle	1990	Lower-Front	17
	Bronco II 4WD With Dana 35 axle	1990	Upper-Front	18
	E-150	1992-2004	Lower-Front	19
	E-150	1996-2002	Upper-Front	20
	E-150	2003-2008	Lower-Front	21
	E-150	2003-2008	Upper-Front	22
	E-250	2005-2008	Lower-Front	24
	E-250	2005-2008	Upper-Front	22
	E-250, E-350, E-450	1996-2004	Lower-Front	23
	E-250, E-350, E-450	1996-2004	Upper-Front	20
	E-350	2005-2008	Lower-Front	24
	E-350	2005-2008	Upper-Front	22
	E-450	2005-2008	Lower-Front	24
	E-450	2005-2008	Upper-Front	22
	Escape 2WD/4WD	2001-2008	Lower-Front	25
	Excursion 2WD	2000-2005	Lower-Front	26
	Excursion 2WD	2000-2005	Upper-Front	27
	Excursion 4WD	2000-2005	Lower-Front	28
	Excursion 4WD With Monobeam axle	2000-2005	Upper-Front	29
	Expedition 2WD/4WD	1997-2002	Lower-Front	30
	Expedition 2WD/4WD	1997-2002	Upper-Front	31
	Expedition 2WD/4WD	2003-2008	Lower-Front	32
	Explorer 2WD/4WD	1995-2000	Upper-Front	33
	Explorer 2WD/4WD	1996-2005	Lower-Front	30
	Explorer 2WD/4WD	2002-2005	Upper-Front	34
	Explorer 2WD/4WD	2006-2008	Upper-Front	35
	Explorer 4WD With Dana 28 axle	1991-1994	Lower-Front	17
	Explorer 4WD With Dana 28 axle	1991-1994	Upper-Front	18
	Explorer 4WD With Dana 35 axle	1991-1994	Lower-Front	17
	Explorer 4WD With Dana 35 axle	1991-1994	Upper-Front	18
	Explorer Sport Trac	2007-2008	Upper-Front	35
	Explorer/Sport/Sport Trac 2WD/4WD	2001-2005	Lower-Front	30
	Explorer/Sport/Sport Trac 2WD/4WD	2001-2005	Upper-Front	33
	F-150 2WD	1987-1996	Lower-Front	36
	F-150 2WD/4WD	1997-2003	Lower-Front	30
	F-150 2WD/4WD	1997-2003	Upper-Front	31
	F-150 2WD/4WD	2004-2008	Lower-Front	32
	F-150 4WD	1980-1996	Lower-Front	15
	F-150 4WD	1980-1996	Upper-Front	16
	F-150 Heritage and Lightning	2004	Lower-Front	30
	F-150 Heritage and Lightning	2004	Upper-Front	31
	F-150-350 2WD	1987-1997	Upper-Front	37
	F-250 2WD	1987-1996	Lower-Front	38
	F-250 2WD HD With Twin I-Beam axle	1997	Lower-Front	38
	F-250 2WD HD With Twin I-Beam axle	1997	Upper-Front	37

TABLE OF CONTENTS

Ford	F-250 4WD (Under 8500 lb. GVW)	1997-1999	Lower-Front	30	
	F-250 4WD (Under 8500 lb. GVW)	1997-1999	Upper-Front	31	
	F-250 4WD With 3850 lb. axle except 4.10 ratio	1980-1996	Lower-Front	15	
	F-250 4WD With Twin I-Beam axle	1980-1996	Upper-Front	16	
	F-250 HD 4WD With 4600 lb. axle and Twin I-Beam axle	1997	Lower-Front	39	
	F-250 HD 4WD With 4600 lb. axle and Twin I-Beam axle	1997	Upper-Front	16	
	F-250 4WD With 4600 lb. axle	1980-1996	Lower-Front	39	
	F-250 Superduty 2WD w/Twin I-Beam axle	1999-2008	Lower-Front	26	
	F-250 Superduty 2WD w/Twin I-Beam axle	1999-2008	Upper-Front	27	
	F-250, F-350 Superduty 2WD/4WD w/Monobeam axle	1999-2008	Lower-Front	28	
	F-250, F-350, F-450, F-550 Superduty 2WD/4WD With Monobeam axle	1999-2008	Upper-Front	29	
	F-350 2WD	1987-1997	Lower-Front	38	
	F-350 4WD With Monobeam axle	1992-1997	Lower-Front	28	
	F-350 4WD With Monobeam axle	1992-1997	Upper-Front	29	
	F-350 Superduty 2WD w/Twin I-Beam axle	1999-2008	Lower-Front	26	
	F-350 Superduty 2WD w/Twin I-Beam axle	1999-2008	Upper-Front	27	
	F-450, F-550 Superduty 2WD/4WD	2005-2008	Lower-Front	40	
	F-450, F-550 Superduty 2WD/4WD	2005-2008	Upper-Front	41	
	F-450, F-550 Superduty 2WD/4WD w/Monobeam axle	1999-2004	Lower-Front	28	
	Ranger 2WD	1989-1997	Lower-Front	36	
	Ranger 2WD	1989-1997	Upper-Front	42	
	Ranger 2WD/4WD With torsion bar suspension	1998-2008	Lower-Front	30	
	Ranger 2WD/4WD With torsion bar suspension	1998-2008	Upper-Front	33	
	Ranger 4WD With Dana 28 axle	1983-1997	Lower-Front	17	
	Ranger 4WD With Dana 28 axle	1983-1997	Upper-Front	18	
	Ranger 4WD With Dana 35 axle	1990-1997	Lower-Front	17	
Ranger 4WD With Dana 35 axle	1990-1997	Upper-Front	18		
Lincoln	Aviator 2WD/4WD	2003-2005	Upper-Front	34	
	Blackwood	2002	Lower-Front	30	
	Blackwood	2002	Upper-Front	31	
	Navigator 2WD/4WD	1998-2002	Lower-Front	30	
	Navigator 2WD/4WD	1998-2002	Upper-Front	31	
	Navigator 2WD/4WD	2003-2006	Lower-Front	32	
Mazda	B2300 2WD	1994-1997	Lower-Front	36	
	B2300 2WD	1994-1997	Upper-Front	42	
	B2300 2WD With torsion bar suspension	2001	Lower-Front	30	
	B2300 2WD/4WD With torsion bar suspension	2001-2004	Upper-Front	33	
	B2300 4WD	1995-1997	Lower-Front	17	
	B2300 4WD	1995-1997	Upper-Front	18	
	B2500 2WD With torsion bar suspension	1998-2001	Lower-Front	30	
	B2500 2WD/4WD With torsion bar suspension	1998-2001	Upper-Front	33	
	B3000 2WD	1994-1996	Lower-Front	36	
	B3000 2WD	1994-1996	Upper-Front	42	
	B3000 2WD With torsion bar suspension	1998-2001	Lower-Front	30	
	B3000 2WD/4WD With torsion bar suspension	1998-2004	Upper-Front	33	
	B3000 4WD	1994-1996	Lower-Front	17	
	B3000 4WD	1994-1996	Upper-Front	18	
	B4000 2WD	1994-1997	Lower-Front	36	
	B4000 2WD	1994-1997	Upper-Front	42	
	B4000 2WD With torsion bar suspension	1998-2001	Lower-Front	30	
	B4000 2WD/4WD With torsion bar suspension	1998-2004	Upper-Front	33	
	B4000 4WD	1994-1997	Lower-Front	17	
	B4000 4WD	1994-1997	Upper-Front	18	
	Navajo 2WD	1992-1994	Lower-Front	36	
	Navajo 2WD	1992-1994	Upper-Front	42	
	Navajo 4WD With Dana 35 axle	1991-1994	Lower-Front	17	
	Navajo 4WD With Dana 35 axle	1991-1994	Upper-Front	18	
	Tribute 2WD/4WD	2001-2006, 2008	Lower-Front	25	
	Mercury	Mariner 2WD/4WD	2005-2008	Lower-Front	25

TABLE OF CONTENTS

Mercury	Mountaineer 2WD/4WD	1997-2001	Upper-Front	33
	Mountaineer 2WD/4WD	1997-2005	Lower-Front	30
	Mountaineer 2WD/4WD	2002-2005	Upper-Front	34
	Mountaineer 2WD/4WD	2006-2008	Upper-Front	35
Brake Anchor Pin Removal				43
U-Joint Disassembly and Assembly				43
Ball Joint Quick Reference Sheet				44

6539-3 FORD/MERCURY/MAZDA TRUCK BALL JOINT ADAPTER APPLICATION CHART

Make	Model	Year	Vehicle Type	Position	Location	OTC Removal Tools	OTC Installation Tools
Ford	Aerostar 2WD	1986-1997	Van	Lower	Front	554415, 29503 & 305228	305227 & 29504 or 39976, 555380
	Aerostar 4WD	1986-1997	Van	Lower	Front	305227 & 29504 or 39976	204508A, 305227 & 29505
	Bronco	1980-1996	SUV	Lower	Front	38354	38355A, 204508A
	Bronco	1980-1996	SUV	Upper	Front	38354	38355A, or 305227 & 29505, 204508A
	Bronco II 4WD With Dana 28 Axle	1984-1990	SUV	Lower	Front	305227 & 29504	305227 & 29505, 204508A or 222304 & 305228
	Bronco II 4WD With Dana 28 Axle	1984-1990	SUV	Upper	Front	305227 & 29504	305227 & 29505, 204508A or 222304 & 305228
	Bronco II 4WD With Dana 35 Axle	1990	SUV	Lower	Front	305227 & 29504	305227 & 29505, 204508A or 222304 & 305228
	Bronco II 4WD With Dana 35 Axle	1990	SUV	Upper	Front	305227 & 29504	305227 & 29505, 204508A or 222304 & 305228
	E-150	1992-2004	Van	Lower	Front	39976 or 305227 & 29504	305227 & 29505, 204508A
	E-150	1996-2002	Van	Upper	Front	305227 & 222305	305227 & 29505, 204508A
	E-150	2003-2008	Van	Lower	Ford	305227 & 222307 or 554478	305227 & 29505, 204508A
	E-150	2003-2008	Van	Upper	Ford	305227 & 29504 or 39976 or 531739	305227 & 29505, 204508A
	E-250, E-350, E-450	1996-2004	Van	Lower	Front	313444	38354, 204508A or 222304 & 305228
	E-250, E-350, E-450	1996-2004	Van	Upper	Front	305227 & 222305	305227 & 29505, 204508A
	E-250, E-350, E-450	2005-2008	Van	Upper	Front	305227 & 29504 or 39976 or 531739	305227 & 29505, 204508A
	E-250, E-350, E-450	2008-2008	Van	Lower	Front	305227 & 29503 or 313444	38354, 204508A or 222304 & 305228
	Escape 2WD/4WD	2001-2008	SUV	Lower	Front	313968, 554413	38354, 204508A & 555378
	Excursion 2WD	2000-2005	SUV	Lower	Front	222305 & 305227	38354, 204508A
	Excursion 2WD	2000-2005	SUV	Upper	Front	38354	38355A or 305227 & 29505, 204508A
	Excursion 4WD	2000-2005	SUV	Lower	Front	305227 & 222305	38354, 204508A
	Excursion 4WD	2000-2005	SUV	Upper	Front	38354 or 39976	38355A, 204508A
	Expedition 2WD/4WD	1997-2002	SUV	Lower	Front	313444 or 29503 & 305227	204508A, 29504 & 305227 or 531739
	Expedition 2WD/4WD	1997-2002	SUV	Upper	Front	555377, 554419, 314392	555380, 555379, 314392

6539-3 FORD/MERCURY/MAZDA TRUCK BALL JOINT ADAPTER APPLICATION CHART

Make	Model	Year	Vehicle Type	Position	Location	OTC Removal Tools	OTC Installation Tools
Ford	Expedition 2WD/4WD	2003-2008	SUV	Lower	Front	313444	204508A, 29504 & 305227 or 39976 or 531739
	Explorer 2WD/4WD	1995-2000	SUV	Upper	Front	555377, 554419, 314392	555380, 555379, 314392
	Explorer 2WD/4WD	1996-2005	SUV	Lower	Front	313444 or 29503 & 305227	204508A, 29504 & 305227 or 531739
	Explorer 2WD/4WD	2002-2005	SUV	Upper	Front	555377, 313968 & 554419, 314392	554403, 38355A & 554413, 314392
	Explorer 2WD/4WD	2006-2008	SUV	Upper	Front	555377, 554415 & 554419, 314392	305227 & 554422 or 554414, 554592, 314392
	Explorer 4WD With Dana 28 Axle	1991-1994	SUV	Lower	Front	305227 & 29504	305227 & 29505, 204508A or 222304 & 305228
	Explorer 4WD With Dana 28 Axle	1991-1994	SUV	Upper	Front	305227 & 29504	305227 & 29505, 204508A or 222304 & 305228
	Explorer 4WD With Dana 35 Axle	1991-1993	SUV	Lower	Front	305227 & 29504	305227 & 29505, 204508A or 222304 & 305228
	Explorer 4WD With Dana 35 Axle	1991-1993	SUV	Upper	Front	305227 & 29504	305227 & 29505, 204508A or 222304 & 305228
	Explorer 4WD With Dana 35 Axle	1993-1994	SUV	Lower	Front	305227 & 29504	305227 & 29505, 204508A or 222304 & 305228
	Explorer 4WD With Dana 35 Axle	1993-1994	SUV	Upper	Front	305227 & 29504	305227 & 29505, 204508A or 222304 & 305228
	Explorer Sport Trac 2WD/4WD	2004-2005	Truck	Lower	Front	313444 or 29503 & 305227	204508A, 29504 & 305227 or 531739
	Explorer Sport Trac 2WD/4WD	2004-2005	Truck	Upper	Front	555377, 554419, 314392	555380, 555379, 314392
	Explorer Sport Trac 2WD/4WD	2007-2008	Truck	Upper	Front	555377, 554415 & 554419, 314392	305227 & 554422 or 554414, 554592, 314392
	Explorer Sport/Sport Trac 2WD/4WD	2001-2003	SUV	Lower	Front	313444 or 29503 & 305227	204508A, 29504 & 305227 or 531739
	Explorer Sport/Sport Trac 2WD/4WD	2001-2003	SUV	Upper	Front	555377, 554419, 314392	555380, 555379, 314392
	F-150 2WD	1987-1996	Truck	Lower	Front	305227 & 29504	305227 & 29505, 204508A
	F-150 2WD	1987-1996	Truck	Upper	Front	38354	305227 & 29505, 204508A
	F-150 2WD/4WD	1997-2003	Truck	Lower	Front	313444 or 29503 & 305227	204508A, 29504 & 305227 or 531739
	F-150 2WD/4WD	1997-2003	Truck	Upper	Front	555377, 554419, 314392	555380, 555379, 314392
	F-150 2WD/4WD	2004-2008	Truck	Lower	Front	313444	204508A, 29504 & 305227 or 39976 or 531739
	F-150 4WD	1980-1996	Truck	Lower	Front	38354	38355A, 204508A
	F-150 4WD	1980-1996	Truck	Upper	Front	38354	38355A, or 305227 & 29505, 204508A
	F-150 Heritage & Lightning	2004	Truck	Lower	Front	313444 or 29503 & 305227	204508A, 29504 & 305227 or 531739

6539-3 FORD/MERCURY/MAZDA TRUCK BALL JOINT ADAPTER APPLICATION CHART

Make	Model	Year	Vehicle Type	Position	Location	OTC Removal Tools	OTC Installation Tools
Ford	F-150 Heritage & Lightning	2004	Truck	Upper	Front	555377, 554419, 314392	555380, 555379, 314392
	F-250 2WD	1987-1996	Truck	Lower	Front	305227 & 29504	38354, 204508A or 222304 & 305228
	F-250 2WD	1987-1996	Truck	Upper	Front	38354	305227 & 29505, 204508A
	F-250 2WD HD With Twin I-Beam	1997	Truck	Lower	Front	305227 & 29504	38354, 204508A or 222304 & 305228
	F-250 2WD HD With Twin I-Beam	1997	Truck	Upper	Front	38354, Forcing Screw	305227 & 29505, 204508A
	F-250 4WD (Under 8500 lb. GVW)	1997-1999	Truck	Lower	Front	313444 or 29503 & 305227	204508A, 29504 & 305227 or 531739
	F-250 4WD (Under 8500 lb. GVW)	1997-1999	Truck	Upper	Front	555377, 554419, 314392	555380, 555379, 314392
	F-250 4WD With 3850 lb. Axle	1980-1996	Truck	Lower	Front	38354	38355A, 204508A
	F-250 4WD With 4600 lb. Axle	1980-1996	Truck	Lower	Front	305227 & 222305 or 39976	38354, 204508A
	F-250 HD 4WD With 4600 lb. Axle and With Twin I-Beam Axle	1997	Truck	Lower	Front	305227 & 222305 or 39976	38354, 204508A
	F-250 HD 4WD With 4600 lb. Axle and With Twin I-Beam Axle	1997	Truck	Upper	Front	38354	38355A, or 305227 & 29505, 204508A
	F-250 Super Duty 2WD/4WD	1999-2008	Truck	Lower	Front	222305 & 305227	38354, 204508A
	F-250 Super Duty 2WD/4WD	1999-2008	Truck	Upper	Front	38354 or 39976	38355A, 204508A
	F-350 2WD	1987-1997	Truck	Lower	Front	305227 & 29504	38354, 204508A or 222304 & 305228
	F-350 2WD	1987-1997	Truck	Upper	Front	38354	305227 & 29505, 204508A
	F-350 4WD	1992-1997	Truck	Lower	Front	305227 & 222305	38354, 204508A
	F-350 4WD	1992-1997	Truck	Upper	Front	38354 or 39976	38355A, 204508A
	F-350 Super Duty 2WD With Twin I-Beam Axle	1999-2008	Truck	Upper	Front	38354	38355A or 305227 & 29505, 204508A
	F-350 Super Duty 2WD/4WD With Monobeam Axle	1999-2008	Truck	Lower	Front	305227 & 222305	38354, 204508A
	F-350 Super Duty 2WD/4WD With Monobeam Axle	1999-2008	Truck	Upper	Front	38354 or 39976	38355A, 204508A
	F-450 Super Duty 2WD/4WD	2005-2008	Truck	Lower	Front	556930, 222306, 314392	556930, 222307, 557010, 314392

6539-3 FORD/MERCURY/MAZDA TRUCK BALL JOINT ADAPTER APPLICATION CHART

Make	Model	Year	Vehicle Type	Position	Location	OTC Removal Tools	OTC Installation Tools
Ford	F-450 Super Duty 2WD/4WD	2005-2008	Truck	Upper	Front	305227, 222307, 314392	38354, 222304, 305228, 314392
	F-450 Super Duty 2WD/4WD With Monobeam Axle	1999-2004	Truck	Lower	Front	305227 & 222305	38354, 204508A
	F-450 Super Duty 2WD/4WD With Monobeam Axle	1999-2004	Truck	Upper	Front	38354 or 39976	38355A, 204508A
	F-550 Super Duty 2WD/4WD	2005-2008	Truck	Lower	Front	556930, 222306, 314392	556930, 222307, 557010, 314392
	F-550 Super Duty 2WD/4WD	2005-2008	Truck	Upper	Front	305227, 222307, 314392	38354, 222304, 305228, 314392
	F-550 Super Duty 2WD/4WD With Monobeam Axle	1999-2004	Truck	Lower	Front	305227 & 222305	38354, 204508A
	F-550 Super Duty 2WD/4WD With Monobeam Axle	1999-2004	Truck	Upper	Front	38354 or 39976	38355A, 204508A
	Ranger 2WD	1989-1997	Truck	Lower	Front	305227 & 29504	305227 & 29505, 204508A
	Ranger 2WD	1989-1997	Truck	Upper	Front	305227 & 29504	38355A, 204508A
	Ranger 2WD With Coil Spring Suspension	1998-2008	Truck	Lower	Front	313444	204508A, 29504 & 305227 or 39976 or 531739
	Ranger 2WD With Coil Spring Suspension	1998-2007	Truck	Upper	Front	38354, 538590, 314392	204508A & 555378, 38355A, 314392
	Ranger 2WD/4WD With Torsion Bar Suspension	1998-2008	Truck	Lower	Front	313444 or 29503 & 305227	204508A, 29504 & 305227 or 531739
	Ranger 2WD/4WD With Torsion Bar Suspension	1998-2008	Truck	Upper	Front	555377, 554419, 314392	555380, 555379, 314392
	Ranger 4WD With Dana 28 Axle	1983-1997	Truck	Lower	Front	305227 & 29504	305227 & 29505, 204508A or 222304 & 305228
	Ranger 4WD With Dana 28 Axle	1983-1997	Truck	Upper	Front	305227 & 29504	29505 & 305227, 204508A
	Ranger 4WD With Dana 35 Axle	1990-1997	Truck	Lower	Front	305227 & 29504	305227 & 29505, 204508A or 222304 & 305228
Ranger 4WD With Dana 35 Axle	1990-1997	Truck	Upper	Front	305227 & 29504	305227 & 29505, 204508A or 222304 & 305228	
Lincoln	Aviator 2WD/4WD	2003-2005	SUV	Upper	Front	555377, 313968 & 554419, 314392	554403, 38355A & 554413, 314392
	Blackwood	2002	Truck	Lower	Front	313444 or 29503 & 305227	204508A, 29504 & 305227 or 531739
	Blackwood	2002	Truck	Upper	Front	555377, 554419, 314392	555380, 555379, 314392

6539-3 FORD/MERCURY/MAZDA TRUCK BALL JOINT ADAPTER APPLICATION CHART

Make	Model	Year	Vehicle Type	Position	Location	OTC Removal Tools	OTC Installation Tools
Lincoln	Navigator 2WD/4WD	1998-2002	SUV	Lower	Front	313444 or 29503 & 305227	204508A, 29504 & 305227 or 531739
	Navigator 2WD/4WD	1998-2002	SUV	Upper	Front	555377, 554419, 314392	555380, 555379, 314392
	Navigator 2WD/4WD	2003-2006	SUV	Lower	Front	313444	204508A, 29504 & 305227 or 39976 or 531739
	Navigator 2WD/4WD	2007-2008	SUV	Lower	Front	313444	204508A, 29504 & 305227 or 39976 or 531739
	Navigator 2WD/4WD	2007-2008	SUV	Lower	Rear	313444	204508A, 29504 & 305227 or 39976 or 531739
Mazda	B-2300 2WD	1994-1997	Truck	Lower	Front	305227 & 29504	305227 & 29505, 204508A
	B-2300 2WD	1994-1997	Truck	Upper	Front	305227 & 29504	38355A, 204508A
	B-2300 2WD With Coil Spring Suspension	2001-2004	Truck	Lower	Front	313444	204508A, 29504 & 305227 or 39976 or 531739
	B-2300 2WD With Coil Spring Suspension	2001-2002	Truck	Upper	Front	38354, 538590, 314392	204508A & 555378, 38355A, 314392
	B-2300 2WD With Torsion Bar Suspension	2001	Truck	Lower	Front	313444 or 29503 & 305227	204508A, 29504 & 305227 or 531739
	B-2300 2WD/4WD	2005-2008	Truck	Lower	Front	313444	204508A, 29504 & 305227 or 39976 or 531739
	B-2300 2WD/4WD With Torsion Bar Suspension	2001-2004	Truck	Lower	Front	313444	204508A, 29504 & 305227 or 39976 or 531739
	B-2300 2WD/4WD With Torsion Bar Suspension	2001-2004	Truck	Upper	Front	555377, 554419, 314392	555380, 555379, 314392
	B-2300 4WD	1995-1997	Truck	Lower	Front	305227 & 29504	305227 & 29505, 204508A or 222304 & 305228
	B-2300 4WD	1995-1997	Truck	Upper	Front	305227 & 29504	305227 & 29505, 204508A or 222304 & 305228
	B-2500 2WD With Coil Spring Suspension	1998-2001	Truck	Lower	Front	313444	204508A, 29504 & 305227 or 39976 or 531739
	B-2500 2WD With Coil Spring Suspension	1998-2001	Truck	Upper	Front	38354, 538590, 314392	204508A & 555378, 38355A, 314392
	B-2500 2WD With Torsion Bar Suspension	1998-2001	Truck	Lower	Front	313444 or 29503 & 305227	204508A, 29504 & 305227 or 531739
	B-2500 2WD/4WD With Torsion Bar Suspension	1998-2001	Truck	Upper	Front	555377, 554419, 314392	555380, 555379, 314392

6539-3 FORD/MERCURY/MAZDA TRUCK BALL JOINT ADAPTER APPLICATION CHART

Make	Model	Year	Vehicle Type	Position	Location	OTC Removal Tools	OTC Installation Tools
Mazda	B-2500 4WD With Torsion Bar Suspension	1998-2001	Truck	Lower	Front	313444	204508A, 29504 & 305227 or 39976 or 531739
	B-3000 2WD	1994-1996	Truck	Lower	Front	305227 & 29504	305227 & 29505, 204508A
	B-3000 2WD	1994-1996	Truck	Upper	Front	305227 & 29504	38355A, 204508A
	B-3000 2WD With Coil Spring Suspension	1998-2004	Truck	Lower	Front	313444	204508A, 29504 & 305227 or 39976 or 531739
	B-3000 2WD With Coil Spring Suspension	1998-2002	Truck	Upper	Front	38354, 538590, 314392	204508A & 555378, 38355A, 314392
	B-3000 2WD With Torsion Bar Suspension	1998-2001	Truck	Lower	Front	313444 or 29503 & 305227	204508A, 29504 & 305227 or 531739
	B-3000 2WD/4WD	2005-2007	Truck	Lower	Front	313444	204508A, 29504 & 305227 or 39976 or 531739
	B-3000 2WD/4WD With Torsion Bar Suspension	1998-2004	Truck	Upper	Front	555377, 554419, 314392	555380, 555379, 314392
	B-3000 2WD/4WD With Torsion Bar Suspension	2002-2004	Truck	Lower	Front	313444	204508A, 29504 & 305227 or 39976 or 531739
	B-3000 4WD	1994-1996	Truck	Lower	Front	305227 & 29504	305227 & 29505, 204508A or 222304 & 305228
	B-3000 4WD	1994-1996	Truck	Upper	Front	305227 & 29504	305227 & 29505, 204508A or 222304 & 305228
	B-3000 4WD With Torsion Bar Suspension	1998-2001	Truck	Lower	Front	313444	204508A, 29504 & 305227 or 39976 or 531739
	B-4000 2WD	1994-1997	Truck	Lower	Front	305227 & 29504	305227 & 29505, 204508A
	B-4000 2WD	1994-1997	Truck	Upper	Front	305227 & 29504	38355A, 204508A
	B-4000 2WD With Coil Spring Suspension	1998-2004	Truck	Lower	Front	313444	204508A, 29504 & 305227 or 39976 or 531739
	B-4000 2WD With Coil Spring Suspension	1998-2002	Truck	Upper	Front	38354, 538590, 314392	204508A & 555378, 38355A, 314392
	B-4000 2WD With Torsion Bar Suspension	1998-2001	Truck	Lower	Front	313444 or 29503 & 305227	204508A, 29504 & 305227 or 531739
	B-4000 2WD/4WD	2005-2008	Truck	Lower	Front	313444	204508A, 29504 & 305227 or 39976 or 531739
	B-4000 2WD/4WD	2005-2008	Truck	Upper	Front	3313444	204508A, 29504 & 305227 or 39976 or 531739

6539-3 FORD/MERCURY/MAZDA TRUCK BALL JOINT ADAPTER APPLICATION CHART

Make	Model	Year	Vehicle Type	Position	Location	OTC Removal Tools	OTC Installation Tools
Mazda	B-4000 2WD/4WD With Torsion Bar Suspension	1998-2004	Truck	Upper	Front	555377, 554419, 314392	555380, 555379, 314392
	B-4000 2WD/4WD With Torsion Bar Suspension	2002-2004	Truck	Lower	Front	313444	204508A, 29504 & 305227 or 39976 or 531739
	B-4000 4WD	1994-1997	Truck	Lower	Front	305227 & 29504	305227 & 29505, 204508A or 222304 & 305228
	B-4000 4WD	1994-1997	Truck	Upper	Front	305227 & 29504	305227 & 29505, 204508A or 222304 & 305228
	B-4000 4WD With Torsion Bar Suspension	1998-2001	Truck	Lower	Front	313444	204508A, 29504 & 305227 or 39976 or 531739
	Navajo 2WD	1992-1994	SUV	Lower	Front	305227 & 29504	305227 & 29505, 204508A
	Navajo 2WD	1992-1994	SUV	Upper	Front	305227 & 29504	38355A, 204508A
	Navajo 4WD With Dana 35 Axle	1991-1993	SUV	Lower	Front	305227 & 29504	305227 & 29505, 204508A or 222304 & 305228
	Navajo 4WD With Dana 35 Axle	1991-1993	SUV	Upper	Front	305227 & 29504	305227 & 29505, 204508A or 222304 & 305228
	Navajo 4WD With Dana 35 Axle	1993-1994	SUV	Lower	Front	305227 & 29504	305227 & 29505, 204508A or 222304 & 305228
	Navajo 4WD With Dana 35 Axle	1993-1994	SUV	Upper	Front	305227 & 29504	305227 & 29505, 204508A or 222304 & 305228
	Tribute 2WD/4WD	2001-2008	SUV	Lower	Front	313968, 554413	38354, 204508A & 555378
	Mercury	Mariner 2WD/4WD	2005-2008	SUV	Lower	Front	313968, 554413
Mountaineer		1997-2005	SUV	Lower	Front	313444 or 29503 & 305227	204508A, 29504 & 305227 or 531739
Mountaineer		1997-2001	SUV	Upper	Front	555377, 554419, 314392	555380, 555379, 314392
Mountaineer		2002-2005	SUV	Upper	Front	555377, 313968 & 554419, 314392	554403, 38355A & 554413, 314392
Mountaineer		2006-2008	SUV	Upper	Front	555377, 554415 & 554419, 314392	305227 & 554422 or 554414, 554592, 314392

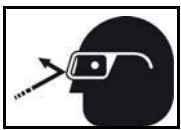

Safety Precautions

CAUTION: To prevent personal injury:

- **Wear protective eyewear that meets the requirements of ANSI Z87.1 and OSHA.**
- **Before performing any repairs on a vehicle, block all wheels to prevent movement.**
- **Check the final alignment of tooling and components before using the C-frame**



Component: Lower-Front

Application:

Ford Aerostar 2WD 1986-1997

REMOVAL:

1. Remove the dust boot.
2. Position 554415 on the ball joint.
3. Position 29503, 305228 and the C-Frame as shown in Figure 1.
4. Turn the forcing screw until it meets the ball joint. Check the alignment of all components.
5. Tighten the forcing screw until the ball joint is removed.

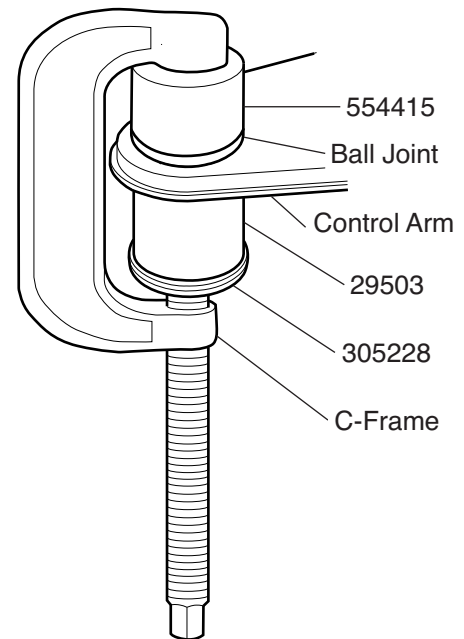

Figure 1. Ball Joint Removal

INSTALLATION:

1. Clean the control arm ball joint bore.
2. Insert the new ball joint as straight as possible into the control arm.
3. Position 29504 and 305227 (or 39976 alone) on the ball joint as shown in Figure 2.
4. Position the C-Frame and 555380 and tighten the forcing screw.
5. Check the alignment of all the components and continue tightening the forcing screw until the ball joint is firmly seated.
6. Install a new dust boot and grease fitting, if equipped.

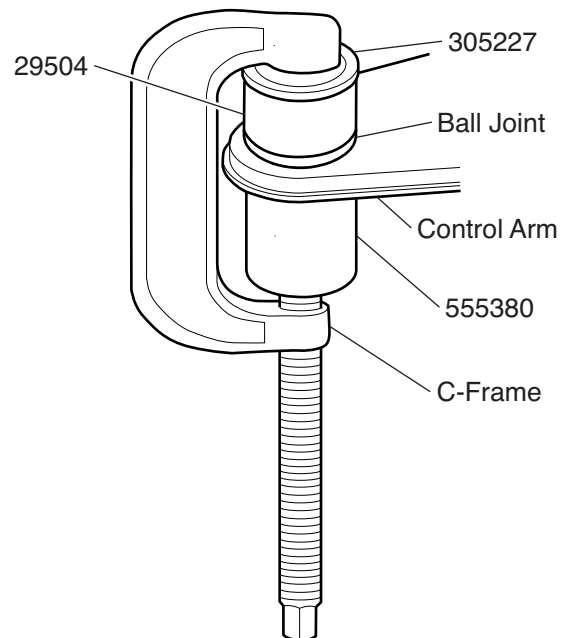

Figure 2. Ball Joint Installation

Component: Lower-Front

Application:

Ford Aerostar 4WD 1986-1997

REMOVAL:

1. Remove the snap ring and grease fitting, if equipped.
2. Position 29504, 305227 (or 39976 alone) and the C-Frame on the ball joint as shown in Figure 1.
3. Turn the forcing screw until it meets the ball joint. Check the alignment of all components.
4. Tighten the forcing screw until the ball joint is removed.

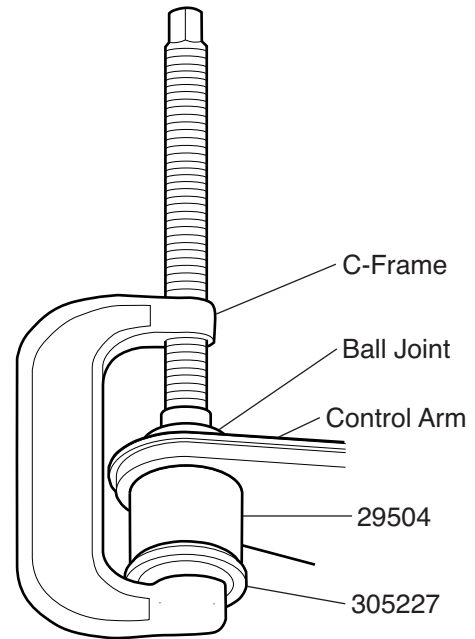

Figure 1. Ball Joint Removal

INSTALLATION:

1. Clean the control arm ball joint bore.
2. Insert the new ball joint as straight as possible into the control arm.
3. Position 29505 and 305227 on the ball joint as shown in Figure 2.
4. Position the C-Frame and 204508A and tighten the forcing screw.
5. Check the alignment of all the components and continue tightening the forcing screw until the ball joint is firmly seated.
6. Install a new dust boot, snap ring and grease fitting, if equipped.

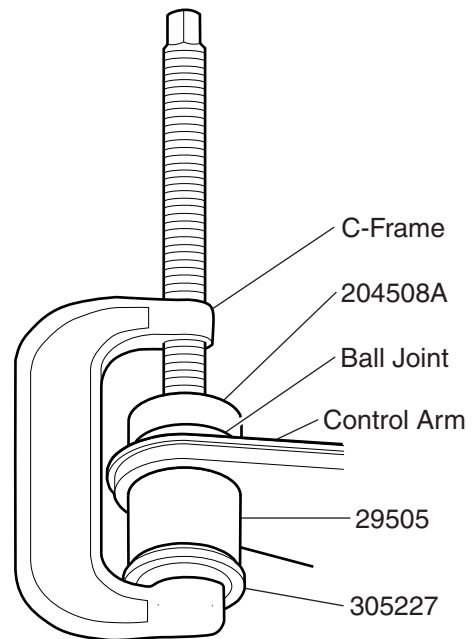

Figure 2. Ball Joint Installation

Component: Lower-Front

Application:

Ford Bronco 1980-1996

Ford F-150 4WD 1980-1996

Ford F-250 4WD With 3850 lb. axle except 4.10 ratio 1980-1996

REMOVAL:

1. Secure spindle assembly firmly in vise.
2. Remove the snap ring and grease fitting, if equipped.
3. Position 38354 over the stem of the ball joint.
4. Position the C-Frame as shown in Figure 1.
5. Turn the forcing screw until it meets the ball joint. Check the alignment of all components.
6. Tighten the forcing screw until the ball joint is removed.

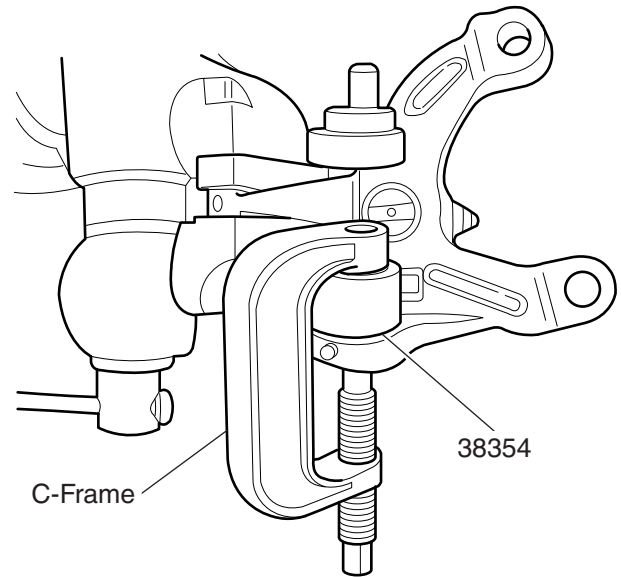

Figure 1. Ball Joint Removal

INSTALLATION:

Note: If replacing both upper and lower ball joint at the same time, remove and install the upper ball joint before installing the lower ball joint.

1. Clean the spindle ball joint bore.
2. Insert the new ball joint as straight as possible into the spindle.
3. Position 204508A and 38355A on the ball joint as shown in Figure 2.
4. Position the C-Frame and tighten the forcing screw.
5. Check the alignment of all the components and continue tightening the forcing screw until the ball joint is firmly seated.
6. Install a new snap ring and grease fitting, if equipped.

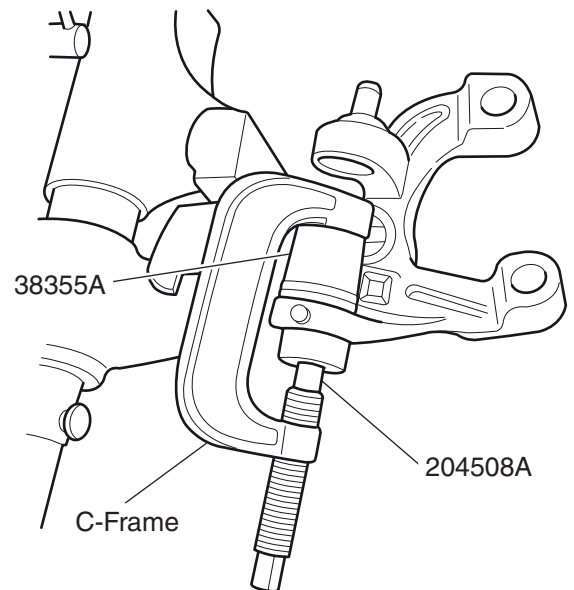

Figure 2. Ball Joint Installation

Component: Upper-Front

Application:

Ford Bronco 1980-1996

Ford F-150 4WD 1980-1996

Ford F-250 HD 4WD with 4600 lb. axle and with Twin I-Beam axle 1997

Ford F-250 4WD with Twin I-Beam axle 1980-1996

REMOVAL:

Note: The lower ball joint must be removed before the upper ball joint can be serviced.

1. Remove the grease fitting, if equipped.
2. Position 38354 over the stem of the ball joint.
3. Position the C-Frame as shown in Figure 1.
4. Turn the forcing screw until it meets the ball joint. Check the alignment of all components.
5. Tighten the forcing screw until the ball joint is removed.

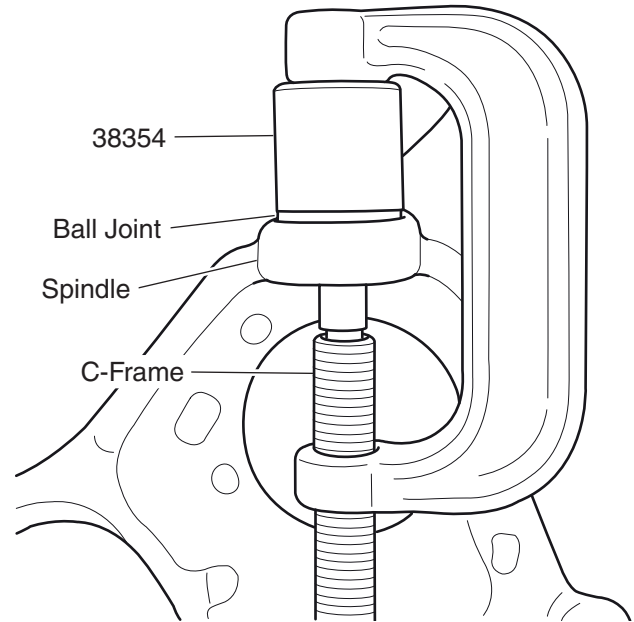

Figure 1. Ball Joint Removal

INSTALLATION:

Note: If replacing both upper and lower ball joint at the same time, remove and install the upper ball joint before installing the lower ball joint.

1. Clean the spindle ball joint bore.
2. Insert the new ball joint as straight as possible into the spindle.
3. Position 38355A (or 305227 and 29505) on the ball joint as shown in Figure 2.
4. Position 204508A and the C-Frame and tighten the forcing screw.
5. Check the alignment of all the components and continue tightening the forcing screw until the ball joint is firmly seated.
6. Install a new dust boot and grease fitting, if equipped.

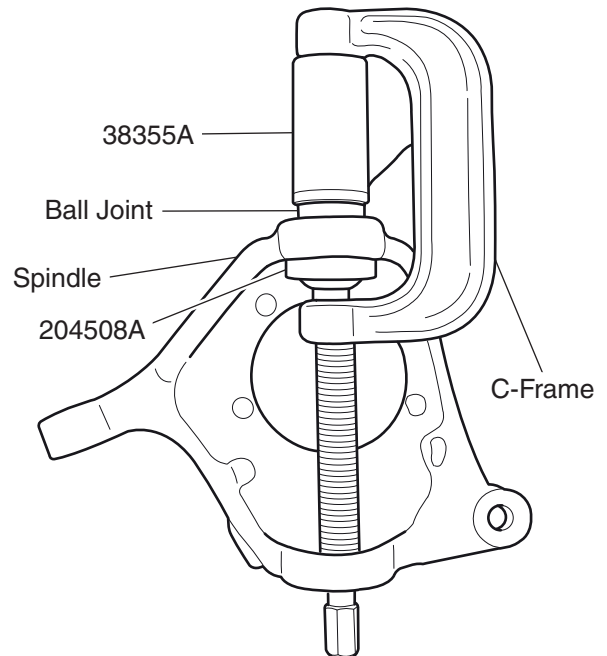

Figure 2. Ball Joint Installation

Component: Lower-Front

Application:

Ford Bronco II 4WD With Dana 28 axle 1984-1990
Ford Bronco II 4WD With Dana 35 axle 1990
Ford Explorer 4WD With Dana 28 axle 1991-1994
Ford Explorer 4WD With Dana 35 axle 1991-1994
Ford Ranger 4WD With Dana 28 axle 1983-1997

Ford Ranger 4WD With Dana 35 axle 1993-1997
Mazda B2300 4WD 1995-1997
Mazda B3000 4WD 1994-1996
Mazda B4000 4WD 1994-1997
Mazda Navajo 4WD With Dana 35 axle 1991-1994

REMOVAL:

1. Secure spindle assembly firmly in vise.
2. Remove snap ring and the grease fitting, if equipped.
3. Position 305227 and 29504 over the stem of the ball joint.
4. Position the C-Frame as shown in Figure 1.
5. Turn the forcing screw until it meets the ball joint. Check the alignment of all components.
6. Tighten the forcing screw until the ball joint is removed.

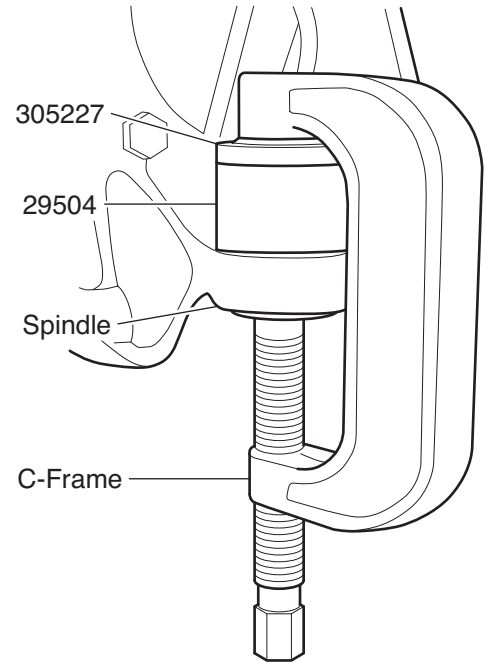

Figure 1. Ball Joint Removal

INSTALLATION:

Note: If replacing both upper and lower ball joint at the same time, remove and install the upper ball joint before installing the lower ball joint.

1. Clean the spindle ball joint bore.
2. Insert the new ball joint as straight as possible into the spindle.
3. Position 29505 and 305227 on the ball joint as shown in Figure 2.
4. Position the 204508A (or 222304 and 305228) and C-Frame, tighten the forcing screw.
5. Check the alignment of all the components and continue tightening the forcing screw until the ball joint is firmly seated.
6. Install a new dust boot, snap ring and grease fitting, if equipped.

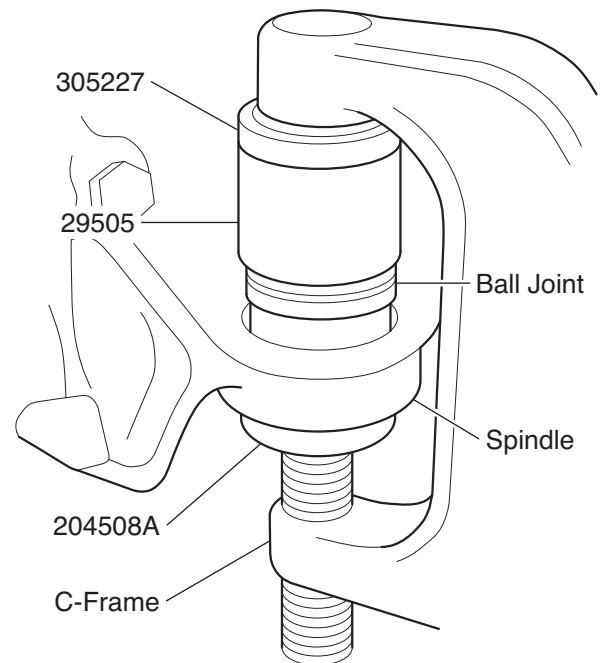

Figure 2. Ball Joint Installation

Component: Upper-Front

Application:

Ford Bronco II 4WD With Dana 28 axle 1984-1990
Ford Bronco II 4WD With Dana 35 axle 1990
Ford Explorer 4WD With Dana 28 axle 1991-1994
Ford Explorer 4WD With Dana 35 axle 1991-1994
Ford Ranger 4WD With Dana 28 axle 1983-1997

Ford Ranger 4WD With Dana 35 axle 1993-1997
Mazda B2300 4WD 1995-1997
Mazda B3000 4WD 1994-1996
Mazda B4000 4WD 1994-1997
Mazda Navajo 4WD With Dana 35 axle 1993-1994

REMOVAL:

Note: The lower ball joint must be removed before the upper ball joint can be serviced.

1. Secure spindle assembly firmly in vise.
2. Remove the snap ring.
3. Position 305227 and 29504 over the stem of the ball joint.
4. Position the C-Frame as shown in Figure 1.
5. Turn the forcing screw until it meets the ball joint. Check the alignment of all components.
6. Tighten the forcing screw until the ball joint is removed.

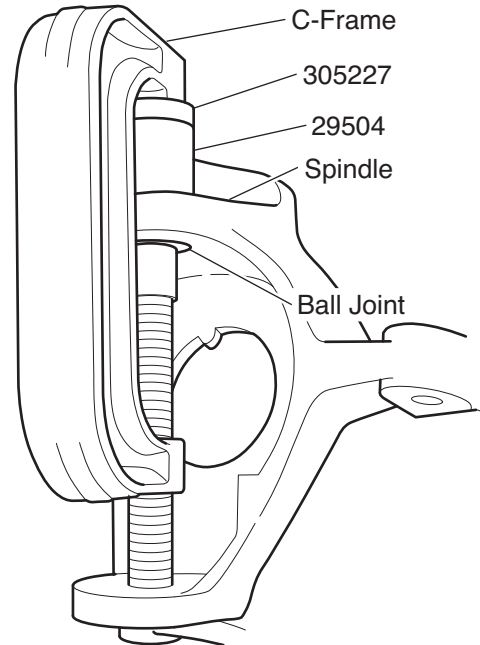

Figure 1. Ball Joint Removal

INSTALLATION:

Note: If replacing both upper and lower ball joint at the same time, remove and install the upper ball joint before installing the lower ball joint.

1. Clean the control arm ball joint bore.
2. Insert the new ball joint as straight as possible into the spindle.
3. Position 305227 and 29505 on the ball joint as shown in Figure 2.
4. Position 204508A and the C-Frame, tighten the forcing screw.
5. Check the alignment of all the components and continue tightening the forcing screw until the ball joint is firmly seated.
6. Install a new dust boot, snap ring and grease fitting if equipped.

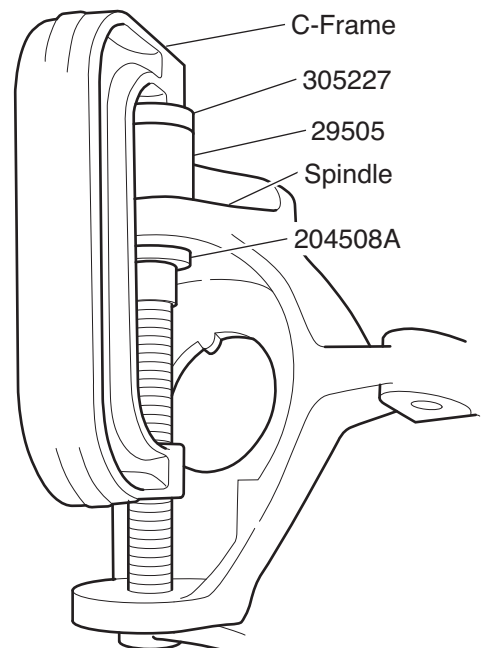

Figure 2. Ball Joint Installation

Component: Lower-Front

Application:

Ford E-150 1992-2004

REMOVAL:

Note: The lower ball joint must be removed before the upper ball joint can be serviced.

1. Secure spindle assembly firmly in vise.
2. Remove the snap ring.
3. Position 29504 and 305227 (or 39976 alone) over the stem of the ball joint.
4. Position the C-Frame as shown in Figure 1.
5. Turn the forcing screw until it meets the ball joint. Check the alignment of all components.
6. Tighten the forcing screw until the ball joint is removed.

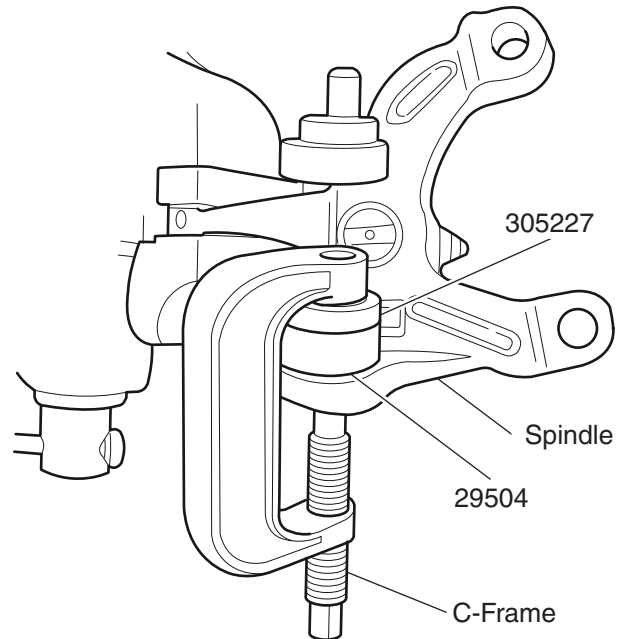

Figure 1. Ball Joint Removal

INSTALLATION:

Note: If replacing both upper and lower ball joint at the same time, remove and install the upper ball joint before installing the lower ball joint.

1. Clean the spindle ball joint bore.
2. Insert the new ball joint as straight as possible into the spindle.
3. Position 29505 and 305227 on the ball joint as shown in Figure 2.
4. Position 204508A and the C-Frame and tighten the forcing screw.
5. Check the alignment of all the components and continue tightening the forcing screw until the ball joint is firmly seated.
6. Install a new snap ring.

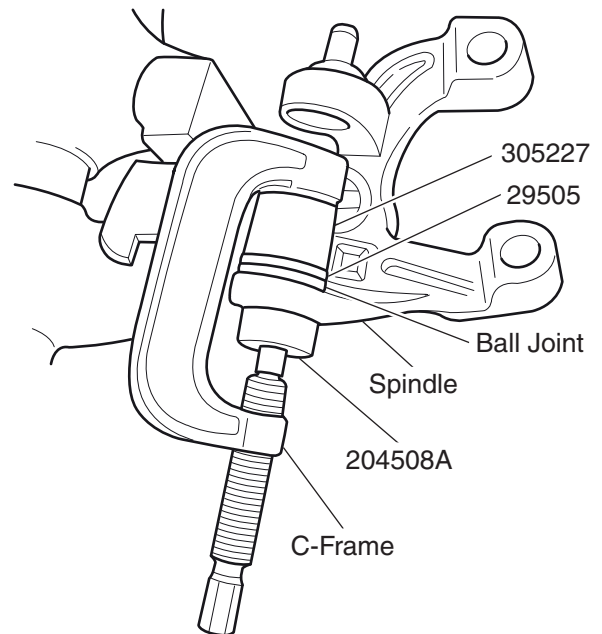

Figure 2. Ball Joint Installation

Component: Upper-Front

Application:

Ford E-150 1996-2002

Ford E-250, E-350, E-450 1996-2004

REMOVAL:

Note: The lower ball joint must be removed before the upper ball joint can be serviced.

1. Secure spindle assembly firmly in vise.
2. Position 222305 and 305227 over the stem of the ball joint.
3. Position the C-Frame as shown in Figure 1.
4. Turn the forcing screw until it meets the ball joint. Check the alignment of all components.
5. Tighten the forcing screw until the ball joint is removed.

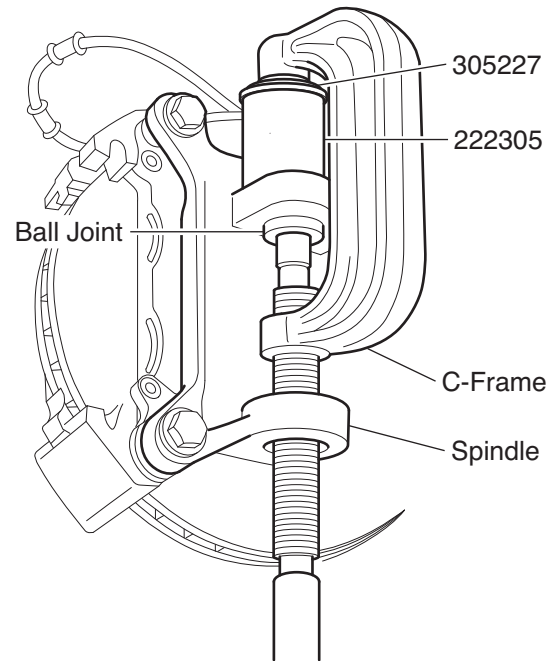

Figure 1. Ball Joint Removal

INSTALLATION:

Note: If replacing both upper and lower ball joint at the same time, remove and install the upper ball joint before installing the lower ball joint.

1. Clean the spindle ball joint bore.
2. Insert the new ball joint as straight as possible into the spindle.
3. Position 29505 and 305227 on the ball joint as shown in Figure 2.
4. Position 204508A and the C-Frame and tighten the forcing screw.
5. Check the alignment of all the components and continue tightening the forcing screw until the ball joint is firmly seated.
6. Install a new dust boot.

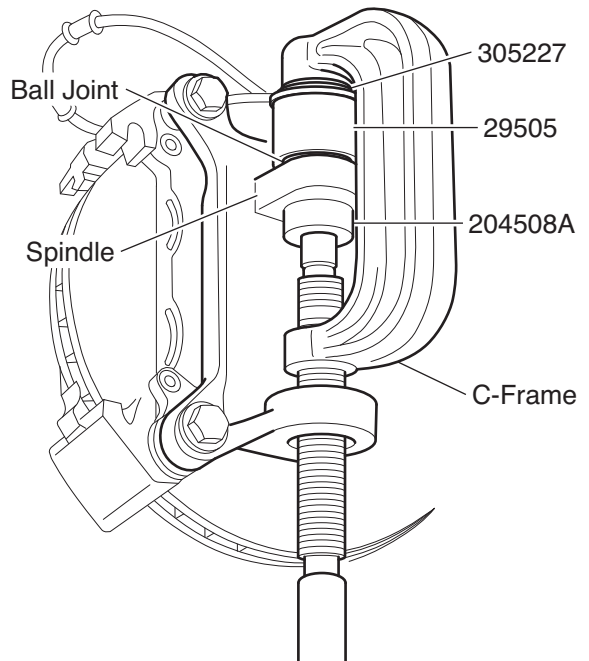

Figure 2. Ball Joint Installation

Component: Lower-Front

Application:

Ford E-150 2003-2008

REMOVAL:

1. Secure spindle assembly firmly in vise.
2. Remove the snap ring.
3. Position 222307 and 305227 (or 554478 alone) over the stem of the ball joint.
4. Position the C-Frame as shown in Figure 1.
5. Turn the forcing screw until it meets the ball joint. Check the alignment of all components.
6. Tighten the forcing screw until the ball joint is removed.

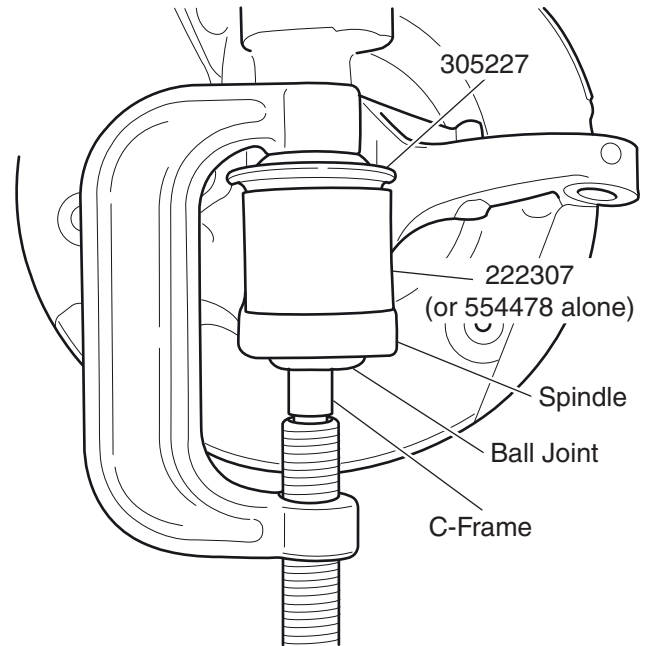

Figure 1. Ball Joint Removal

INSTALLATION:

Note: If replacing both upper and lower ball joint at the same time, remove and install the upper ball joint before installing the lower ball joint.

1. Clean the spindle ball joint bore.
2. Insert the new ball joint as straight as possible into the spindle.
3. Position 204508A, 29505 and 305227 on the ball joint as shown in Figure 2.
4. Position the C-Frame and tighten the forcing screw.
5. Check the alignment of all the components and continue tightening the forcing screw until the ball joint is firmly seated.
6. Install a new snap ring and grease fitting, if equipped.

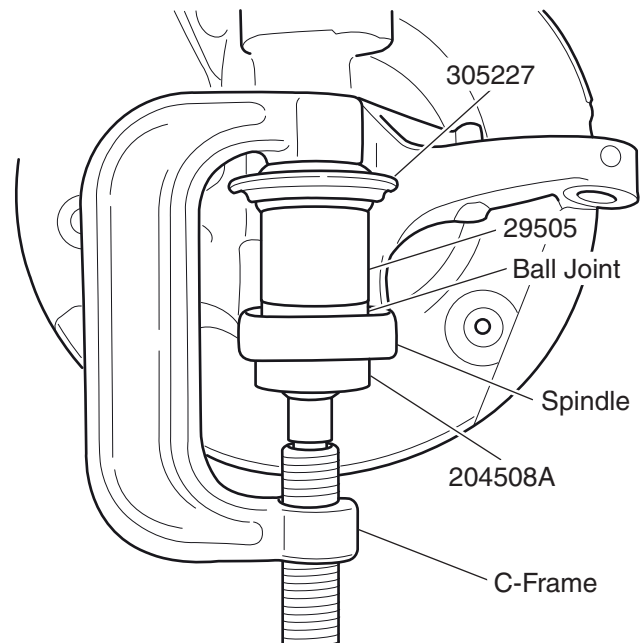

Figure 2. Ball Joint Installation

Component: Upper-Front

Application:

Ford E-150 2003-2008

Ford E-250 2005-2008

Ford E-350 2005-2008

Ford E-450 2005-2008

REMOVAL:

Note: The lower ball joint must be removed before the upper ball joint can be serviced.

1. Secure spindle assembly firmly in vise.
2. Remove the grease fitting, if equipped.
3. Position 29504 and 305227 (or 39976 or 531739) over the stem of the ball joint.
4. Position the C-Frame as shown in Figure 1.
5. Turn the forcing screw until it meets the ball joint. Check the alignment of all components.
6. Tighten the forcing screw until the ball joint is removed.

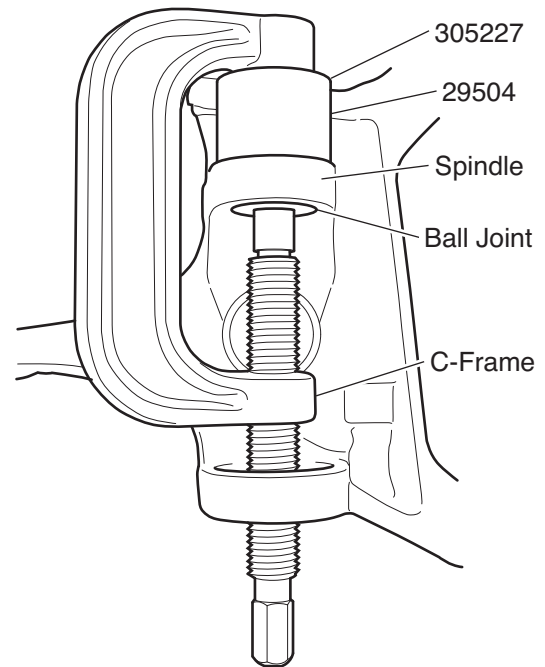

Figure 1. Ball Joint Removal

INSTALLATION:

Note: If replacing both upper and lower ball joint at the same time, remove and install the upper ball joint before installing the lower ball joint.

1. Clean the spindle ball joint bore.
2. Insert the new ball joint as straight as possible into the spindle.
3. Position 204508A, 29505 and 305227 on the ball joint as shown in Figure 2.
4. Position the C-Frame and tighten the forcing screw.
5. Check the alignment of all the components and continue tightening the forcing screw until the ball joint is firmly seated.
6. Install a new dust boot and grease fitting, if equipped.

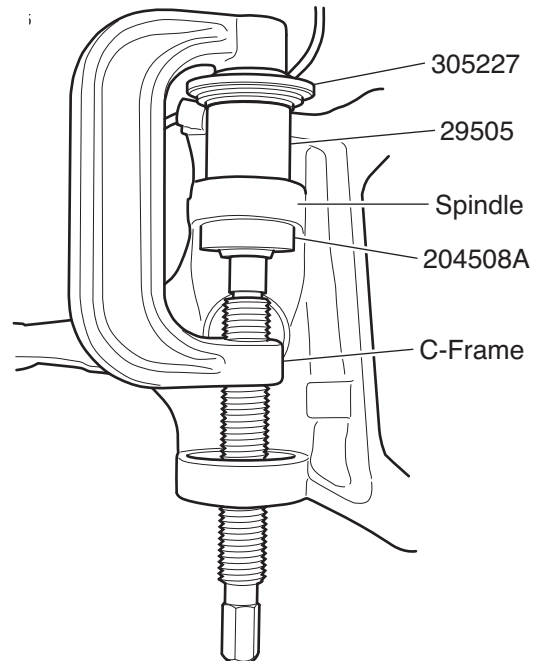

Figure 2. Ball Joint Installation

Component: Lower-Front

Application:

Ford E-250, E-350, E-450 1996-2004

REMOVAL:

1. Secure spindle assembly firmly in vise.
2. Remove the snap ring.
3. Position 313444 over the stem of the ball joint.
4. Position the C-Frame as shown in Figure 1.
5. Turn the forcing screw until it meets the ball joint. Check the alignment of all components.
6. Tighten the forcing screw until the ball joint is removed.

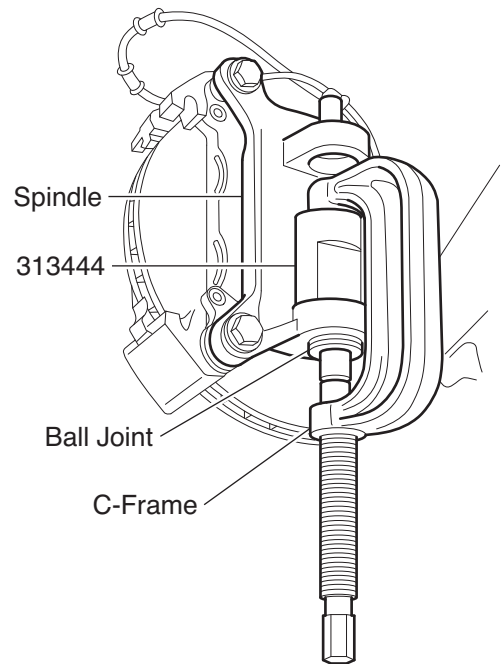

Figure 1. Ball Joint Removal

INSTALLATION:

Note: If replacing both upper and lower ball joint at the same time, remove and install the upper ball joint before installing the lower ball joint.

1. Clean the spindle ball joint bore.
2. Insert the new ball joint as straight as possible into the spindle.
3. Position 38354 on the ball joint as shown in Figure 2.
4. Position 204508A (or 305228 and 222304) and the C-Frame and tighten the forcing screw.
5. Check the alignment of all the components and continue tightening the forcing screw until the ball joint is firmly seated.
6. Install a new dust boot, snap ring and grease fitting if equipped.

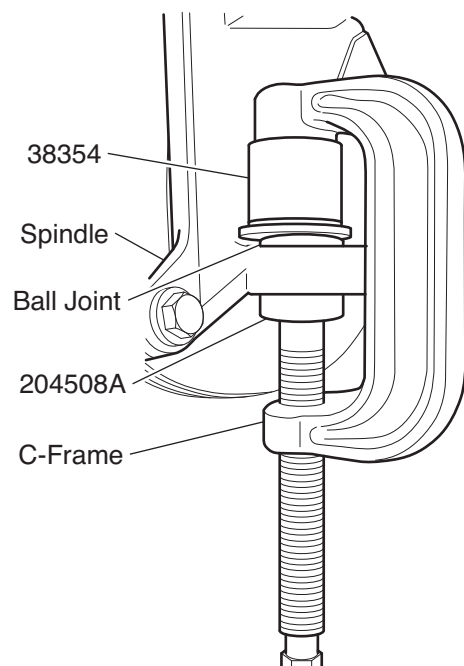

Figure 2. Ball Joint Installation

Component: Lower-Front

Application:

Ford E-250 2005-2008

Ford E-350 2005-2008

REMOVAL:

1. Secure spindle assembly firmly in vise.
2. Remove the snap ring and grease fitting, if equipped.
3. Position 313444 (or 29503 and 305227) over the stem of the ball joint.
4. Position the C-Frame as shown in Figure 1.
5. Turn the forcing screw until it meets the ball joint. Check the alignment of all components.
6. Tighten the forcing screw until the ball joint is removed.

INSTALLATION:

Note: If replacing both upper and lower ball joint at the same time, remove and install the upper ball joint before installing the lower ball joint.

1. Clean the spindle ball joint bore.
2. Insert the new ball joint as straight as possible into the spindle.
3. Position 204508A and 38354 (or 222304 and 305228) on the ball joint as shown in Figure 2.
4. Position the C-Frame and tighten the forcing screw.
5. Check the alignment of all the components and continue tightening the forcing screw until the ball joint is firmly seated.
6. Install a new snap ring and grease fitting, if equipped.

Ford E-450 2005-2008

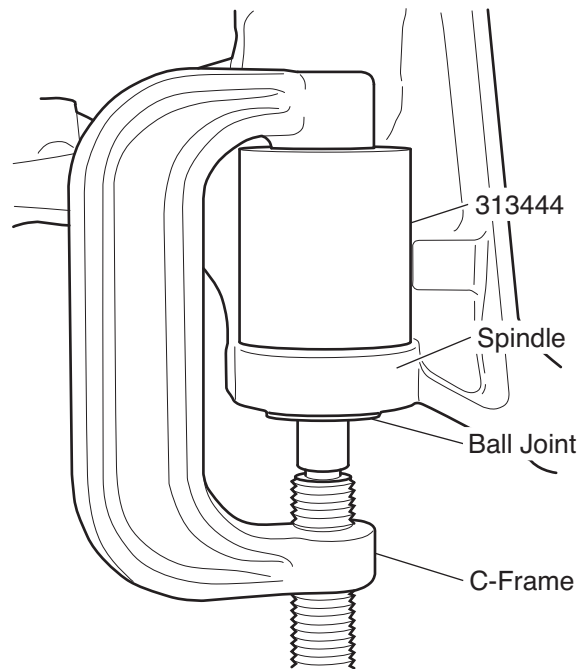

Figure 1. Ball Joint Removal

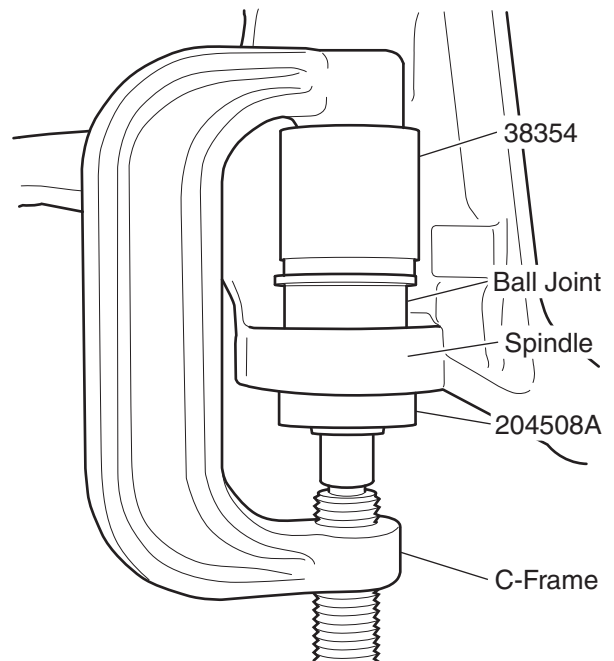

Figure 2. Ball Joint Installation

Component: Lower-Front

Application:

Ford Escape 2WD/4WD 2001-2008

Mazda Tribute 2WD/4WD 2001-2006 & 2008

REMOVAL:

1. Position 313968 on the ball joint.
2. Position the C-Frame and 554413 as shown in Figure 1.
3. Turn the forcing screw until it meets the ball joint. Check the alignment of all components.
4. Tighten the forcing screw until the ball joint is removed.

Mercury Mariner 2WD/4WD 2005-2008

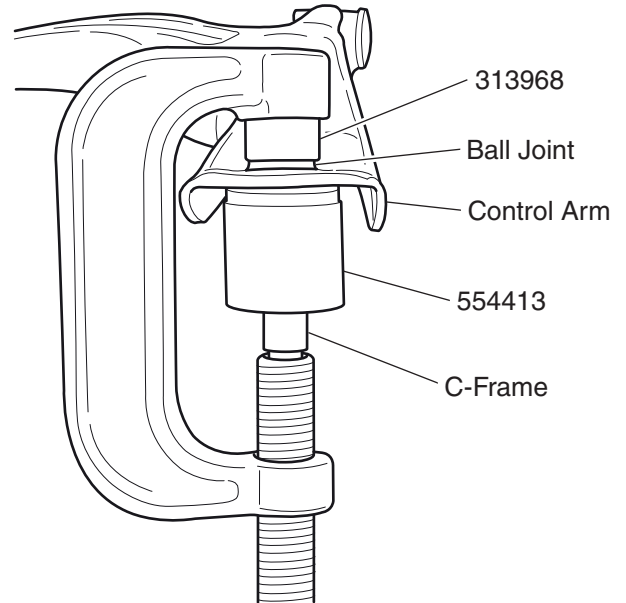

Figure 1. Ball Joint Removal

INSTALLATION:

1. Clean the control arm ball joint bore.
2. Insert the new ball joint as straight as possible into the control arm.
3. Place 555378 inside 204508A.
4. Position 204508A and 555378 on the ball joint as shown in Figure 2.
5. Position the C-Frame and 38354 and tighten the forcing screw.
6. Check the alignment of all the components and continue tightening the forcing screw until the ball joint is firmly seated.

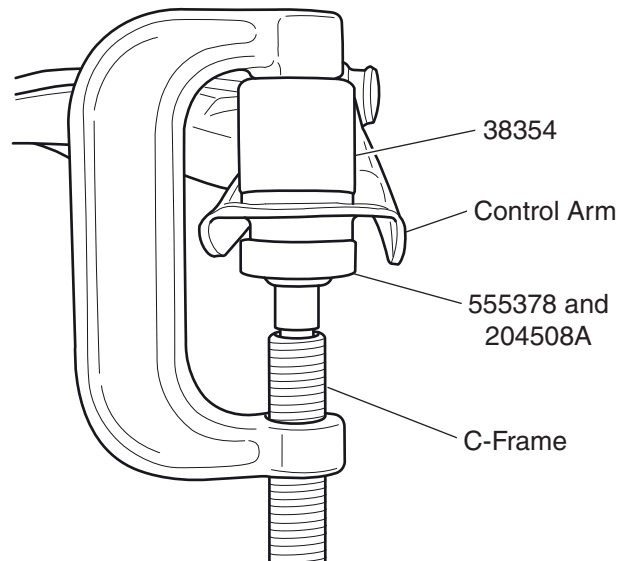

Figure 2. Ball Joint Installation

Component: Lower-Front

Application:

Ford Excursion 2WD 2000-2005

Ford F-250 Super Duty 2WD w/Twin I-Beam axle 1999-2008

Ford F-350 Super Duty 2WD w/Twin I-Beam axle 1999-2008

REMOVAL:

1. Secure spindle assembly firmly in vise.
2. Remove the snap ring.
3. Position 222305 and 305227 over the stem of the ball joint.
4. Position the C-Frame.
5. Turn the forcing screw until it meets the ball joint. Check the alignment of all components.
6. Tighten the forcing screw until the ball joint is removed.

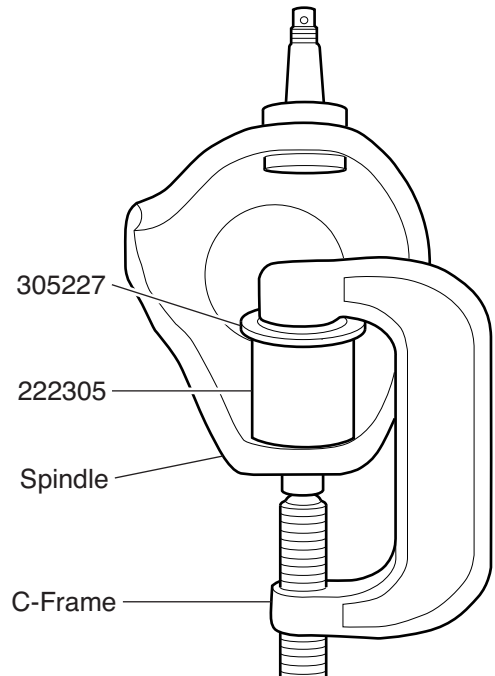

Figure 1. Ball Joint Removal

INSTALLATION:

Note: If replacing both upper and lower ball joint at the same time, remove and install the upper ball joint before installing the lower ball joint.

1. Clean the control arm ball joint bore.
2. Insert the new ball joint as straight as possible into the spindle.
3. Position 204508A and 38354 on the ball joint as shown in Figure 2.
4. Position the C-Frame and tighten the forcing screw.
5. Check the alignment of all the components and continue tightening the forcing screw until the ball joint is firmly seated.
6. Install a new snap ring.

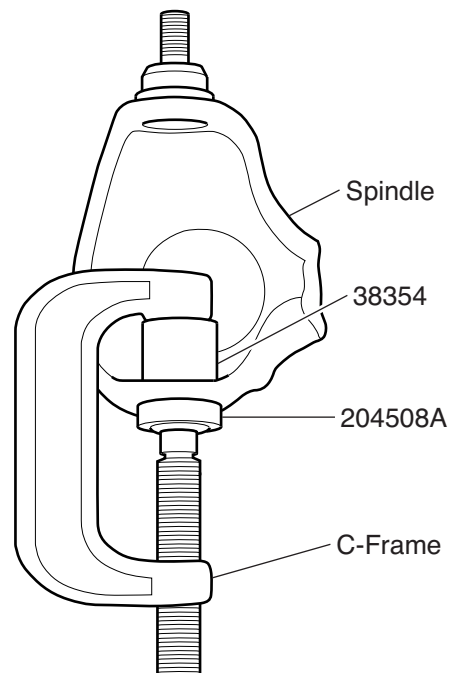

Figure 2. Ball Joint Installation

Component: Upper-Front

Application:

Ford Excursion 2WD 2000-2005

Ford F-250 Super Duty 2WD w/Twin I-Beam axle 1999-2008

Ford F-350 Super Duty 2WD w/Twin I-Beam axle 1999-2008

REMOVAL:

Note: The lower ball joint must be removed before the upper ball joint can be serviced.

1. Secure spindle assembly firmly in vise.
2. Remove the snap ring.
3. Position 38354 over the stem of the ball joint.
4. Position the C-Frame.
5. Turn the forcing screw until it meets the ball joint. Check the alignment of all components.
6. Tighten the forcing screw until the ball joint is removed.

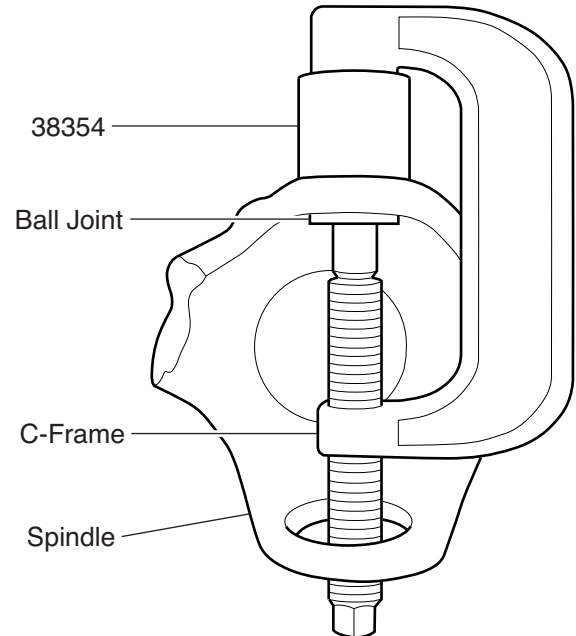

Figure 1. Ball Joint Removal

INSTALLATION:

Note: If replacing both upper and lower ball joint at the same time, remove and install the upper ball joint before installing the lower ball joint.

1. Clean the spindle ball joint bore.
2. Insert the new ball joint as straight as possible into the spindle.
3. Position 204508A and 38355A on the ball joint as shown in Figure 2.
4. Position the C-Frame and tighten the forcing screw.
5. Check the alignment of all the components and continue tightening the forcing screw until the ball joint is firmly seated.
6. Install a new snap ring.

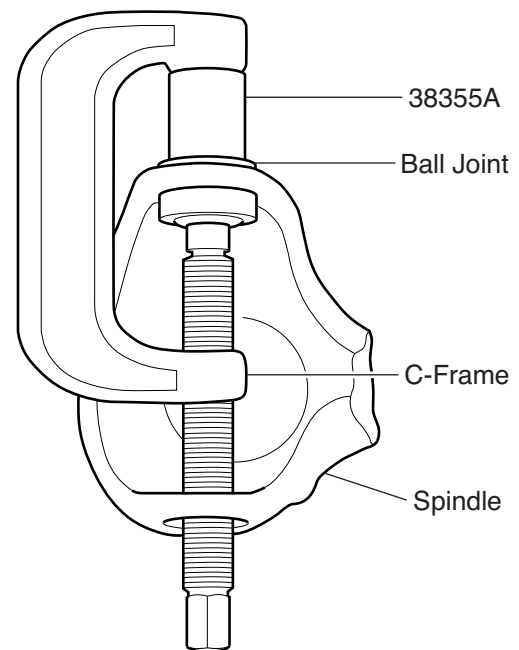

Figure 2. Ball Joint Installation

Component: Lower-Front

Application:

Ford Excursion 4WD 2000-2005

Ford F-250, F-350 Super Duty 2WD/4WD w/Monobeam axle 1999-2008

Ford F-350 4WD w/Monobeam axle 1992-1997

Ford F-450, F-550 Super Duty 2WD/4WD w/Monobeam axle 1999-2004

REMOVAL:

1. Secure spindle assembly firmly in vise.
2. Remove the snap ring and grease fitting, if equipped.
3. Position 222305 and 305227 over the stem of the ball joint.
4. Position the C-Frame.
5. Turn the forcing screw until it meets the ball joint. Check the alignment of all components.
6. Tighten the forcing screw until the ball joint is removed.

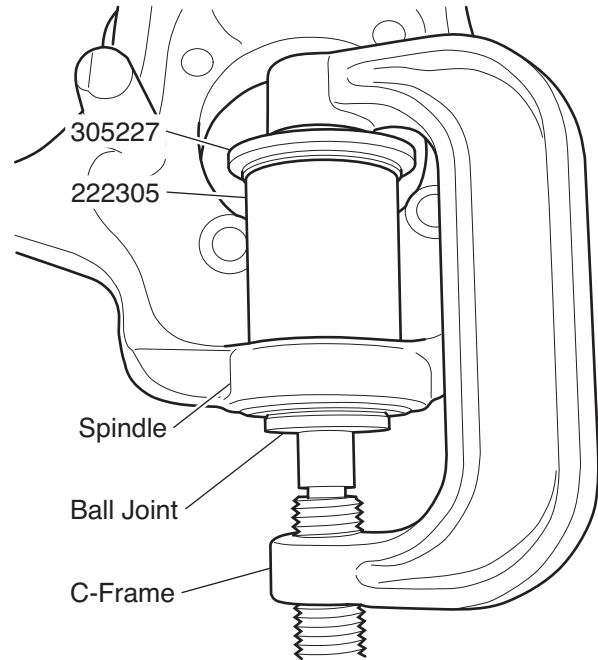

Figure 1. Ball Joint Removal

INSTALLATION:

Note: If replacing both upper and lower ball joint at the same time, remove and install the upper ball joint before installing the lower ball joint.

1. Clean the spindle ball joint bore.
2. Insert the new ball joint as straight as possible into the spindle.
3. Position 38354 on the ball joint as shown in Figure 2.
4. Position 204508A and the C-Frame and tighten the forcing screw.
5. Check the alignment of all the components and continue tightening the forcing screw until the ball joint is firmly seated.
6. Install a new dust boot, snap ring and grease fitting if equipped.

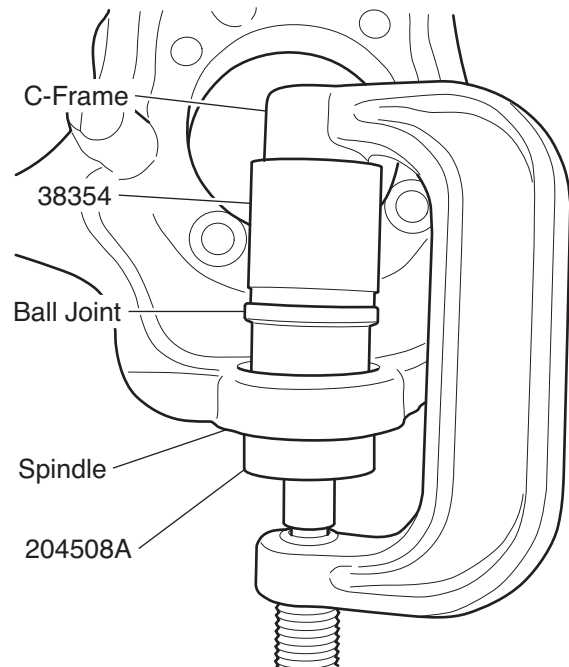

Figure 2. Ball Joint Installation

Component: Upper-Front

Application:

Ford Excursion 4WD With Monobeam axle 2000-2005

Ford F-250, F-350, F-450, F-550 Super Duty 2WD/4WD With Monobeam axle 1999-2008

Ford F-350 4WD With Monobeam axle 1992-1997

REMOVAL:

Note: The lower ball joint must be removed before the upper ball joint can be serviced.

1. Remove the grease fitting, if equipped.
2. Position 38354 (or 39976) over the stem of the ball joint.
3. Position the C-Frame as shown in Figure 1.
4. Turn the forcing screw until it meets the ball joint. Check the alignment of all components.
5. Tighten the forcing screw until the ball joint is removed.

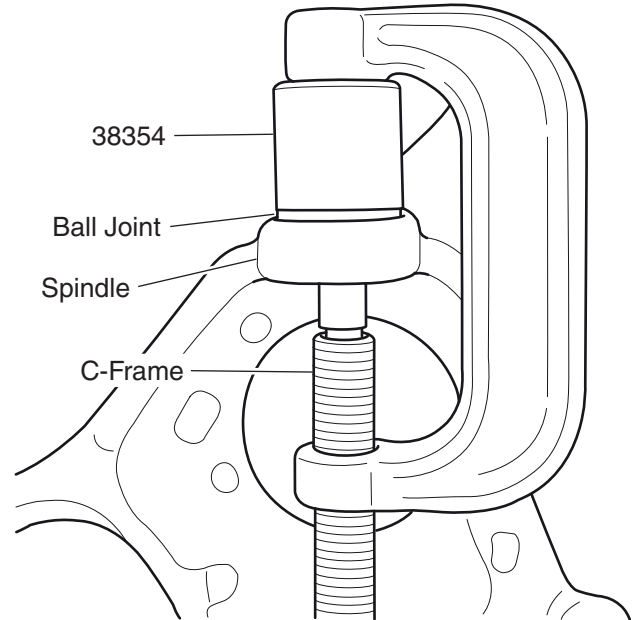

Figure 1. Ball Joint Removal

INSTALLATION:

Note: If replacing both upper and lower ball joint at the same time, remove and install the upper ball joint before installing the lower ball joint.

1. Clean the spindle ball joint bore.
2. Insert the new ball joint as straight as possible into the spindle.
3. Position 38355A on the ball joint as shown in Figure 2.
4. Position 204508A and the C-Frame and tighten the forcing screw.
5. Check the alignment of all the components and continue tightening the forcing screw until the ball joint is firmly seated.
6. Install a new dust boot and grease fitting, if equipped.

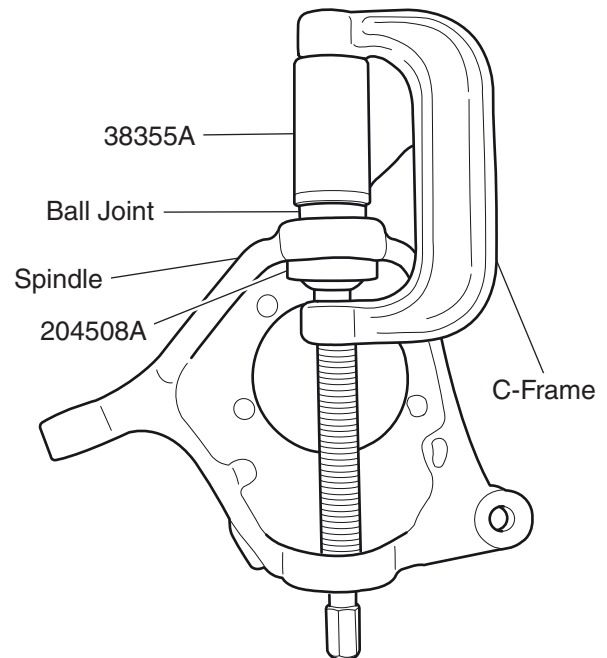

Figure 2. Ball Joint Installation

Component: Lower-Front

Application:

Ford Expedition 2WD/4WD 1997-2002

Ford Explorer 2WD/4WD 1996-2005

Ford Explorer/Sport/Sport Trac 2WD/4WD 2001-2005

Ford F-150 2WD/4WD 1997-2003

Ford F-150 Heritage and Lightning 2004

Ford F-250 4WD (Under 8500 lb. GVW) 1997-1999

Ford Ranger 2WD/4WD With torsion bar susp. 1998-2008

Lincoln Blackwood 2002

Lincoln Navigator 2WD/4WD 1998-2002

Mazda B2300 2WD With torsion bar susp. 2001

Mazda B2500 2WD With torsion bar susp. 1998-2001

Mazda B3000 2WD With torsion bar susp. 1998-2001

Mazda B4000 2WD With torsion bar susp. 1998-2001

Mercury Mountaineer 1997-2005

REMOVAL:

1. Remove the snap ring and grease fitting, if equipped.
2. Position 313444 (or 305227 and 29503) over the stem of the ball joint.
3. Position the C-Frame as shown in Figure 1.
4. Turn the forcing screw until it meets the ball joint. Check the alignment of all components.
5. Tighten the forcing screw until the ball joint is removed.

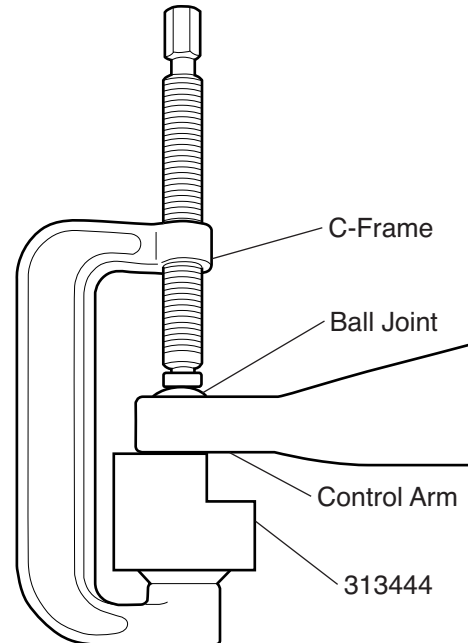

Figure 1. Ball Joint Removal

INSTALLATION:

1. Clean the control arm ball joint bore.
2. Insert the new ball joint as straight as possible into the control arm.
3. Position 204508A, 531739 (or 29504 and 305227) and the C-Frame on the ball joint as shown in Figure 2.
4. Tighten the forcing screw.
5. Check the alignment of all the components and continue tightening the forcing screw until the ball joint is firmly seated.
6. Install a new dust boot, snap ring and grease fitting if equipped.

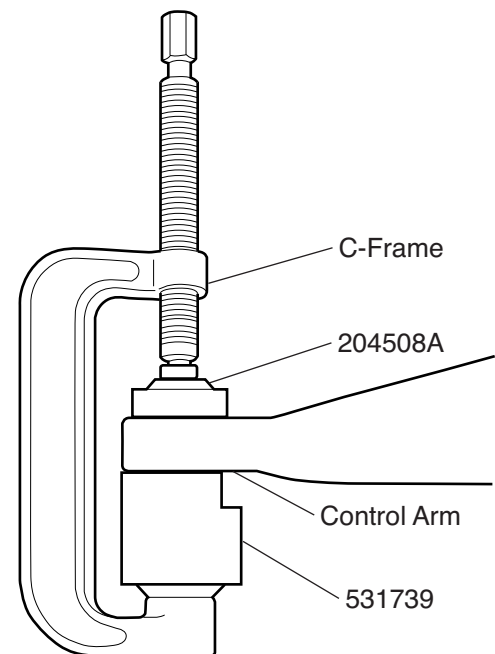

Figure 2. Ball Joint Installation

Component: Upper-Front

Application:

Ford Expedition 2WD/4WD 1997-2002

Ford F-150 2WD/4WD 1997-2003

Ford F-150 Heritage and Lightning 2004

F-250 4WD Under 8500 lb. GVW 1997-1999

Lincoln Blackwood 2002

Lincoln Navigator 2WD/4WD 1998-2002

REMOVAL:

Note: Only for aftermarket control arms with removable ball joints.

1. Remove the dust boot and snap ring.
2. Position 555377 on the ball joint.
3. Position 554419, 314392 and the C-Frame as shown in Figure 1.
4. Turn the forcing screw until it meets the ball joint. Check the alignment of all components.
5. Tighten the forcing screw until the ball joint is removed.

INSTALLATION:

1. Clean the control arm ball joint bore.
2. Insert the new ball joint as straight as possible into the control arm.
3. Position 555379 on the ball joint as shown in Figure 2.
4. Position 555380, 314392 and the C-Frame and tighten the forcing screw.
5. Check the alignment of all the components and continue tightening the forcing screw until the ball joint is firmly seated.
6. Install a new dust boot and snap ring.

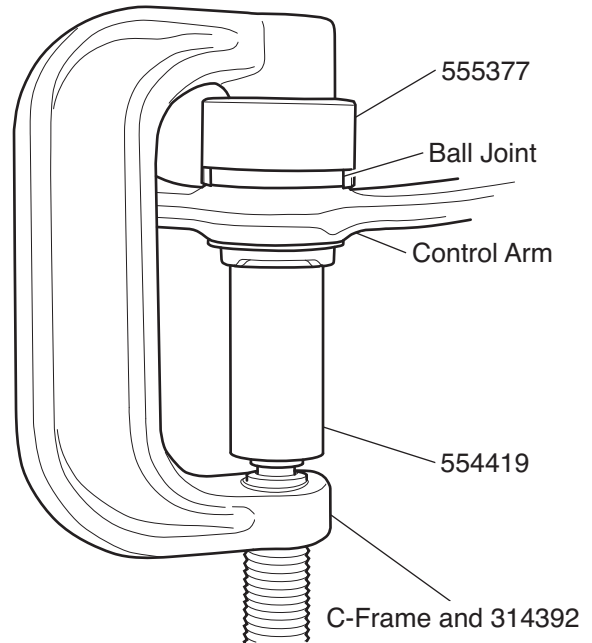

Figure 1. Ball Joint Removal

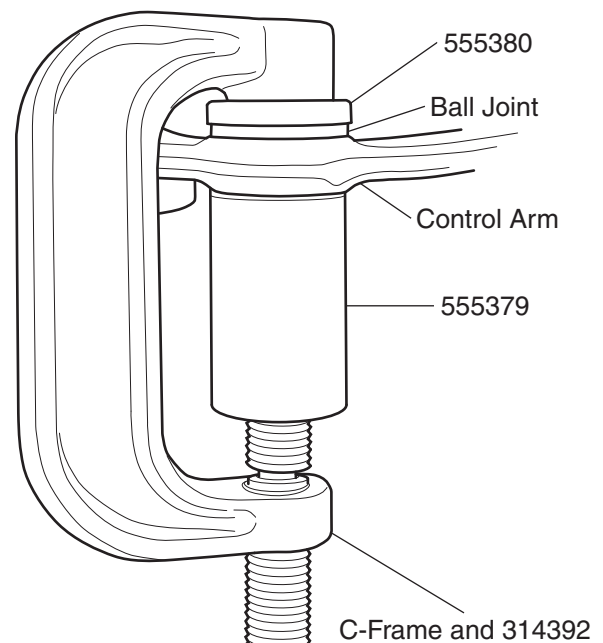

Figure 2. Ball Joint Installation

Component: Lower-Front

Application:

Ford Expedition 2WD/4WD 2003-2008
Ford F-150 2WD/4WD 2004-2008

Lincoln Navigator 2WD/4WD 2003-2006

REMOVAL:

1. Remove the snap ring.
2. Position 313444 over the stem of the ball joint.
3. Position the C-Frame as shown in Figure 1.
4. Turn the forcing screw until it meets the ball joint. Check the alignment of all components.
5. Tighten the forcing screw until the ball joint is removed.

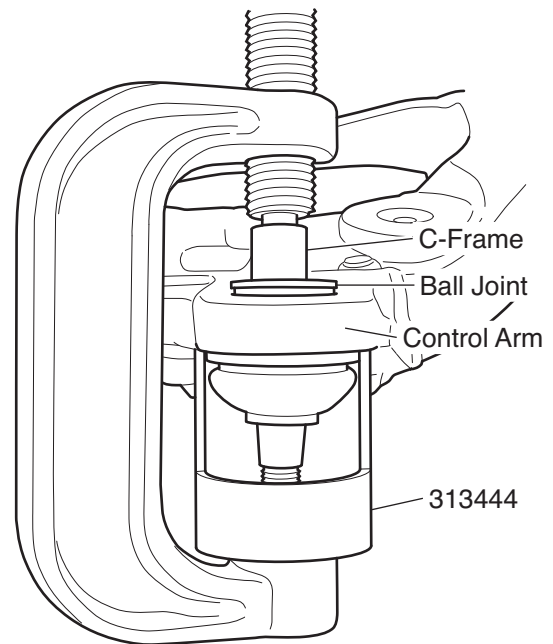

Figure 1. Ball Joint Removal

INSTALLATION:

1. Clean the control arm ball joint bore.
2. Insert the new ball joint as straight as possible into the control arm.
3. Position 29504 and 305227 (or 39976 or 531739 alone) on the ball joint as shown in Figure 2.
4. Position 204508A and the C-Frame and tighten the forcing screw.
5. Check the alignment of all the components and continue tightening the forcing screw until the ball joint is firmly seated.
6. Install a new snap ring.

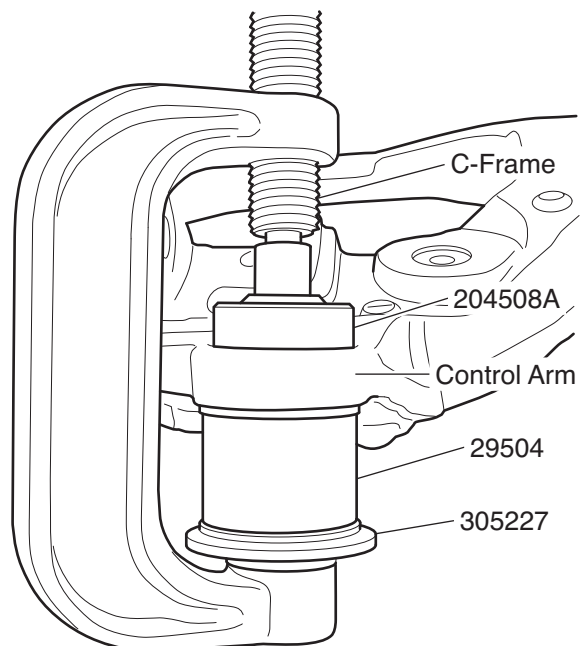

Figure 2. Ball Joint Installation

Component: Upper-Front

Application:

Ford Explorer 2WD/4WD 1995-2000

Ford Explorer/Sport/Sport Trac 2WD/4WD 2001-2005

Ford Ranger 2WD/4WD With torsion bar suspension 1998-2008

Mazda B2300 2WD/4WD With torsion bar suspension 2001-2004

Mazda B2500 2WD/4WD With torsion bar suspension 1998-2001

Mazda B3000 2WD/4WD With torsion bar suspension 1998-2004

Mazda B4000 2WD/4WD With torsion bar suspension 1998-2004

Mercury Mountaineer 1997-2001

REMOVAL:

Note: Only for aftermarket control arms with removable ball joints.

1. Remove the dust boot and snap ring.
2. Position 555377 on the ball joint.
3. Position 554419, 314392 and the C-Frame as shown in Figure 1.
4. Turn the forcing screw until it meets the ball joint. Check the alignment of all components.
5. Tighten the forcing screw until the ball joint is removed.

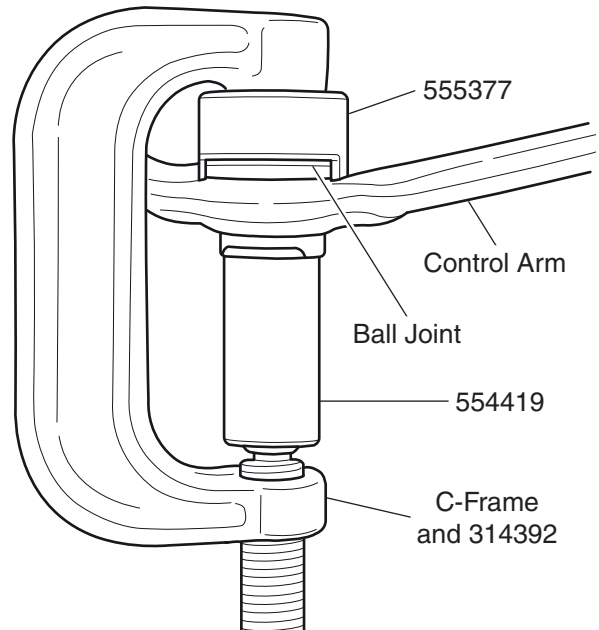

Figure 1. Ball Joint Removal

INSTALLATION:

1. Clean the control arm ball joint bore.
2. Insert the new ball joint as straight as possible into the control arm.
3. Position 555380 on the ball joint.
4. Position 555379, 314392 and the C-Frame on the ball joint as shown in Figure 2.
5. Tighten the forcing screw.
6. Check the alignment of all the components and continue tightening the forcing screw until the ball joint is firmly seated.
7. Install a new dust boot, snap ring.

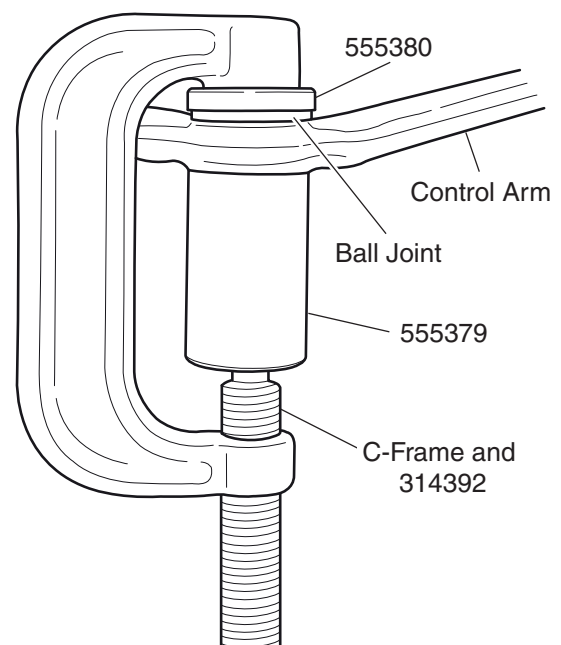

Figure 2. Ball Joint Installation

Component: Upper-Front

Application:

Ford Explorer 2WD/4WD 2002-2005

Lincoln Aviator 2WD/4WD 2003-2005

Mercury Mountaineer 2WD/4WD 2002-2005

REMOVAL:

1. Remove the dust boot.
2. Position 555377 on the ball joint.
3. Position 313968 and 554419 over the ball joint stem.
4. Position the C-Frame and 314392 as shown in Figure 1.
5. Turn the forcing screw until it meets the ball joint. Check the alignment of all components.
6. Tighten the forcing screw until the ball joint is removed.

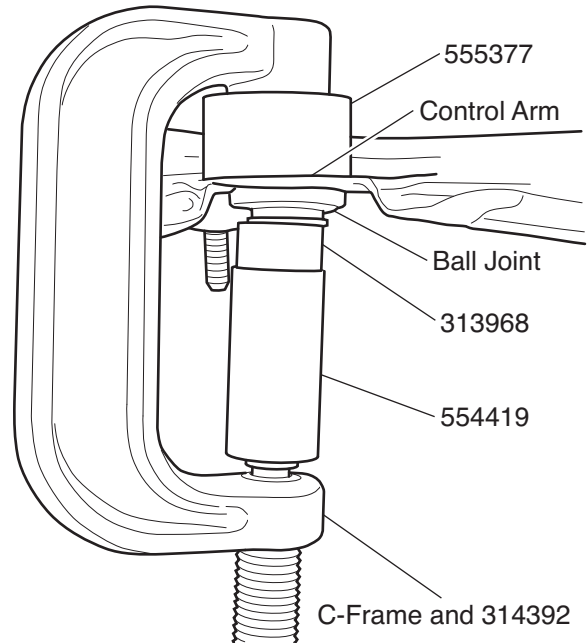

Figure 1. Ball Joint Removal

INSTALLATION:

1. Clean the control arm ball joint bore.
2. Insert the new ball joint as straight as possible into the control arm.
3. Position 38355A, slide 554413 over 38355A on the ball joint as shown in Figure 2.
4. Position the C-Frame, 314392 and 554403 and tighten the forcing screw.
5. Check the alignment of all the components and continue tightening the forcing screw until the ball joint is firmly seated.

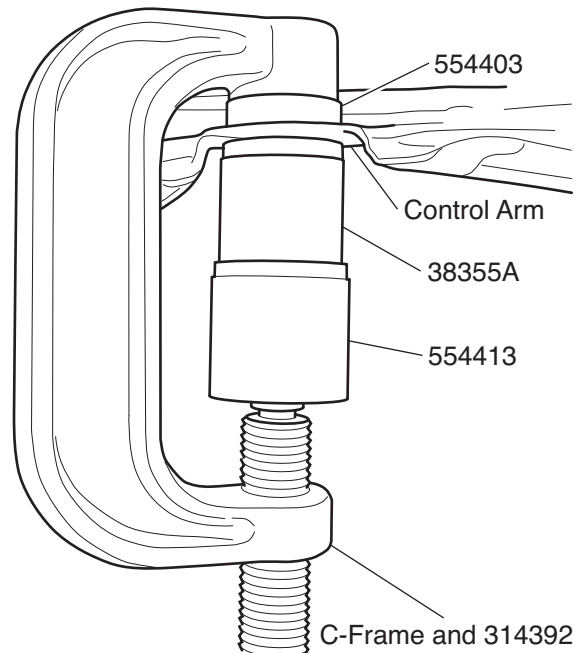

Figure 2. Ball Joint Installation

Component: Upper-Front

Application:

Ford Explorer 2WD/4WD 2006-2008

Ford Explorer Sport Trac 2007-2008

Mercury Mountaineer 2WD/4WD 2006-2008

REMOVAL:

1. Remove the dust boot.
2. Position 555377 on the ball joint.
3. Position 554415 and 554419 over the ball joint stem.
4. Position the C-Frame and 314392 as shown in Figure 1.
5. Turn the forcing screw until it meets the ball joint. Check the alignment of all components.
6. Tighten the forcing screw until the ball joint is removed.

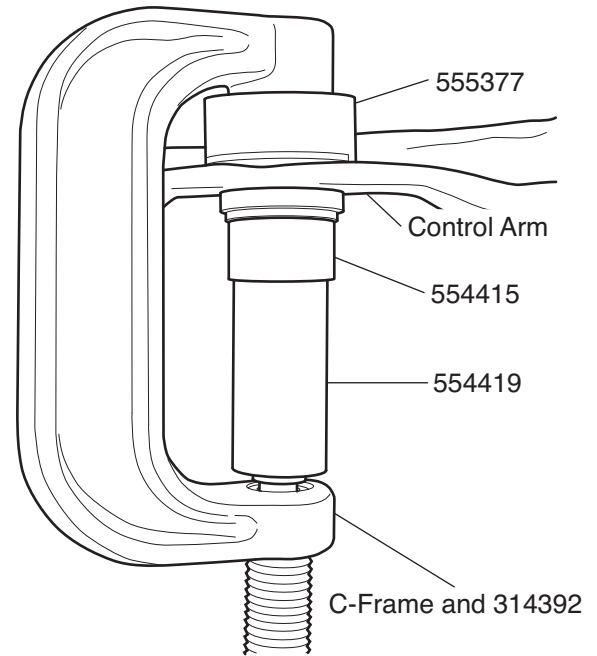

Figure 1. Ball Joint Removal

INSTALLATION:

CAUTION: Depending on ball joint type, make sure the shaft of the ball joint lines up with the hole in the back of the adapter during installation, or damage may occur to the ball joint. Check periodically during installation.

1. Clean the control arm ball joint bore.
2. Insert the new ball joint as straight as possible into the control arm.
3. Position 305227 and 554422 (or 554414) on the ball joint as shown in Figure 2.
4. Position the C-Frame, 314392 and 554592 and tighten the forcing screw.
5. Check the alignment of all the components and continue tightening the forcing screw until the ball joint is firmly seated.
6. Install new dust boot and snap ring.

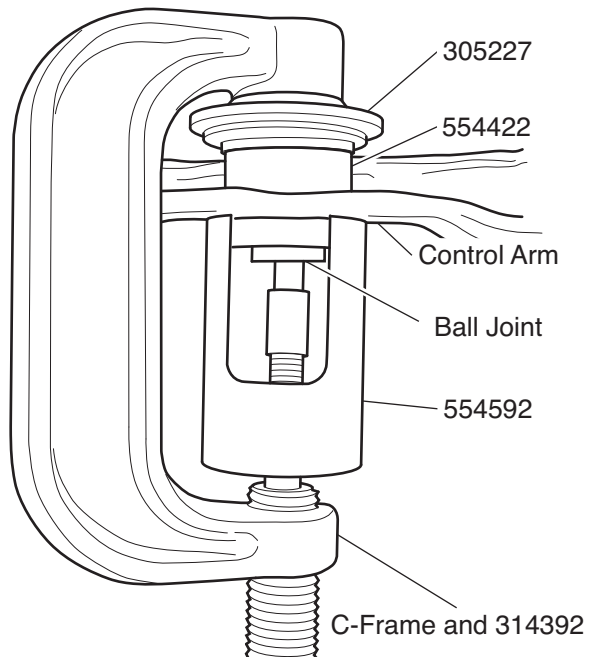

Figure 2. Ball Joint Installation

Component: Lower-Front

Application:

Ford F-150 2WD 1987-1996

Ford Ranger 2WD 1989-1997

Mazda B2300 2WD 1994-1997

Mazda B3000 2WD 1994-1996

Mazda B4000 2WD 1994-1997

Mazda Navajo 2WD 1992-1994

REMOVAL:

Note: The lower ball joint must be removed before the upper ball joint can be serviced.

1. Secure spindle assembly firmly in vise.
2. Remove the snap ring.
3. Position 29504 and 305227 over the stem of the ball joint.
4. Position the C-Frame as shown in Figure 1.
5. Turn the forcing screw until it meets the ball joint. Check the alignment of all components.
6. Tighten the forcing screw until the ball joint is removed.

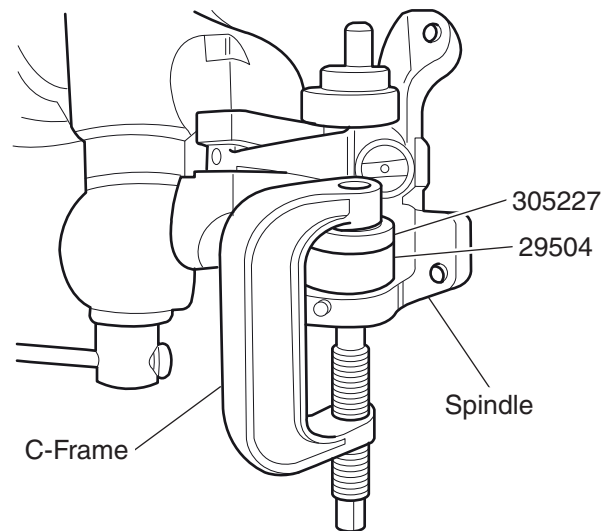

Figure 1. Ball Joint Removal

INSTALLATION:

Note: If replacing both upper and lower ball joint at the same time, remove and install the upper ball joint before installing the lower ball joint.

1. Clean the spindle ball joint bore.
2. Insert the new ball joint as straight as possible into the spindle.
3. Position 29505 and 305227 on the ball joint as shown in Figure 2.
4. Position 204508A and the C-Frame and tighten the forcing screw.
5. Check the alignment of all the components and continue tightening the forcing screw until the ball joint is firmly seated.
6. Install a new snap ring and grease fitting if equipped.

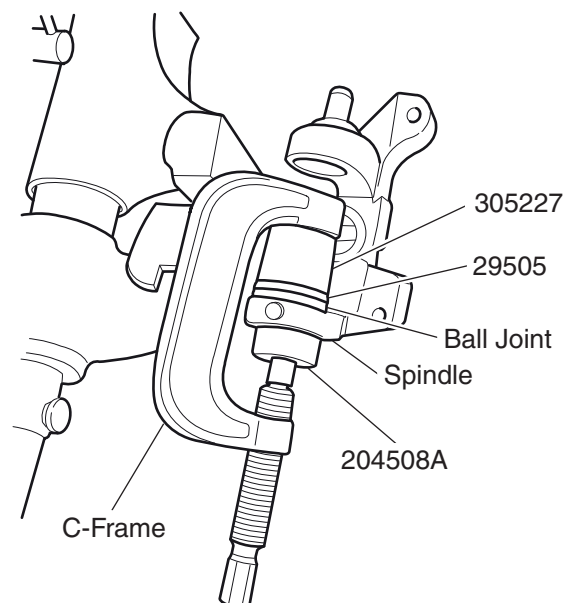

Figure 2. Ball Joint Installation

Component: Upper-Front

Application:

Ford F-150 2WD 1987-1997

Ford F-250 2WD 1987-1996

Ford F-250 2WD HD With Twin I-Beam axle 1997

Ford F-350 2WD 1987-1997

REMOVAL:

Note: The lower ball joint must be removed before the upper ball joint can be serviced.

1. Secure spindle assembly firmly in vise.
2. Remove the grease fitting, if equipped.
3. Position 38354 over the stem of the ball joint.
4. Position the C-Frame as shown in Figure 1.
5. Turn the forcing screw until it meets the ball joint. Check the alignment of all components.
6. Tighten the forcing screw until the ball joint is removed.

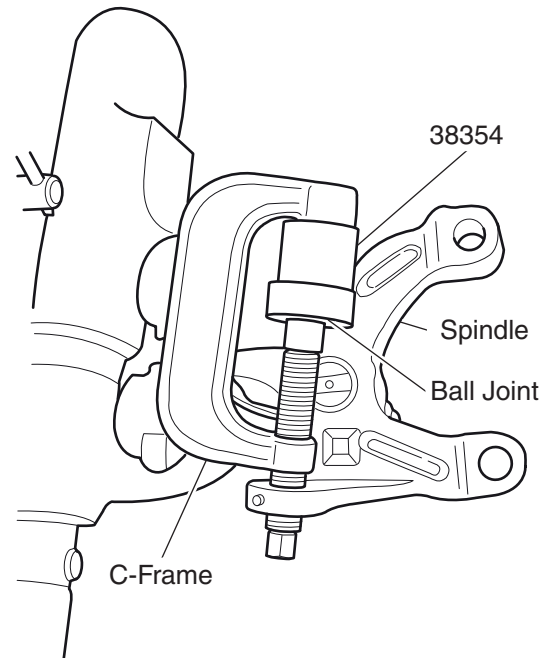

Figure 1. Ball Joint Removal

INSTALLATION:

Note: The upper ball joint must be installed before the lower ball joint.

1. Clean the spindle ball joint bore.
2. Insert the new ball joint as straight as possible into the spindle.
3. Position 29505 and 305227 on the ball joint as shown in Figure 2.
4. Position 204508A and the C-Frame and tighten the forcing screw.
5. Check the alignment of all the components and continue tightening the forcing screw until the ball joint is firmly seated.
6. Install a new dust boot and grease fitting if equipped.

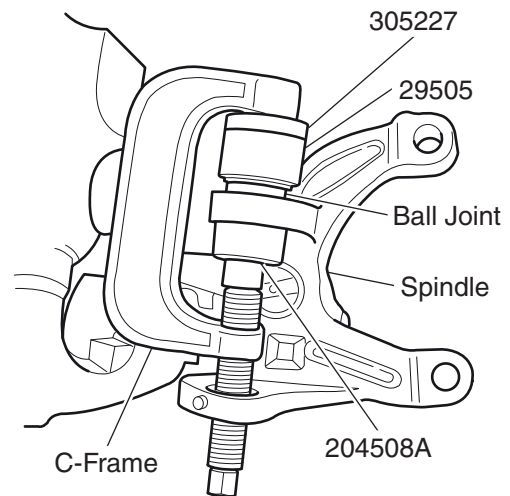

Figure 2. Ball Joint Installation

Component: Lower-Front

Application:

Ford F-250 2WD 1987-1996

Ford F-250 HD 2WD w/Twin I-Beam 1997

Ford F-350 2WD 1987-1997

REMOVAL:

Note: The lower ball joint must be removed before the upper ball joint can be serviced.

1. Secure spindle assembly firmly in vise.
2. Remove the snap ring and grease fitting, if equipped.
3. Position 29504 and 305227 over the stem of the ball joint.
4. Position the C-Frame.
5. Turn the forcing screw until it meets the ball joint. Check the alignment of all components.
6. Tighten the forcing screw until the ball joint is removed.

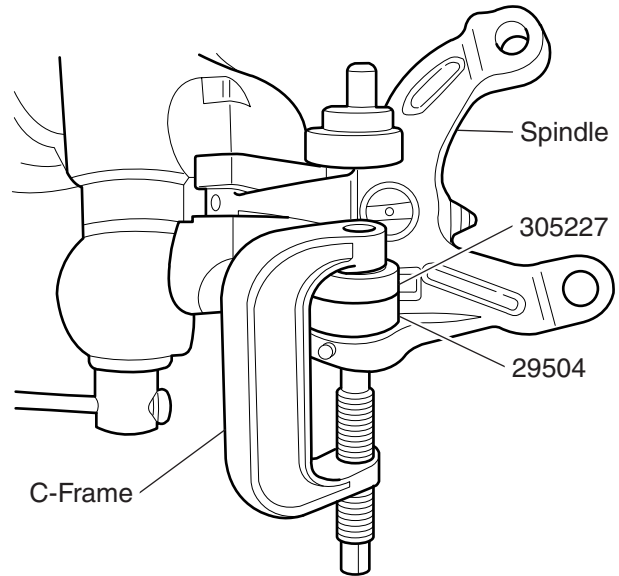

Figure 1. Ball Joint Removal

INSTALLATION:

Note: If replacing both upper and lower ball joint at the same time, remove and install the upper ball joint before installing the lower ball joint.

1. Clean the spindle ball joint bore.
2. Insert the new ball joint as straight as possible into the spindle.
3. Position 38354 on the ball joint as shown in Figure 2.
4. Position 204508A (or 222304 and 305228) and the C-Frame and tighten the forcing screw.
5. Check the alignment of all the components and continue tightening the forcing screw until the ball joint is firmly seated.
6. Install a new dust boot, snap ring and grease fitting, if equipped.

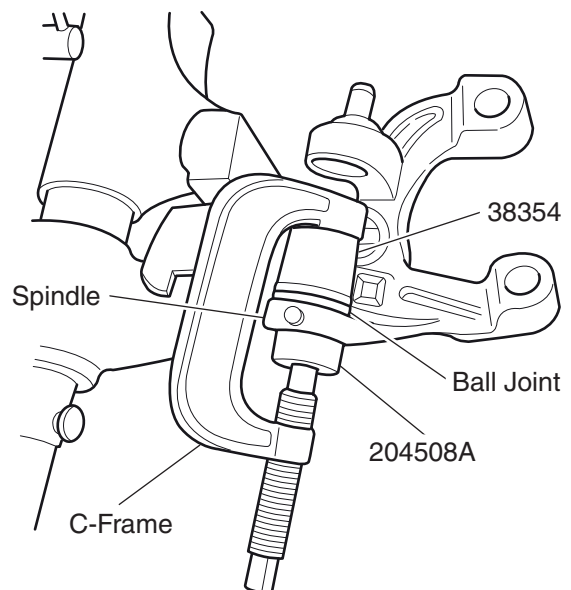

Figure 2. Ball Joint Installation

Component: Lower-Front

Application:

Ford F-250 4WD With 4600 lb. axle 1980-1996

Ford F-250 HD 4WD With 4600 lb. axle and With Twin I-Beam axle 1997

REMOVAL:

1. Remove the grease fitting, if equipped.
2. Position 305227 and 222305 (or 39976 alone) over the stem of the ball joint.
3. Position the C-Frame as shown in Figure 1.
4. Turn the forcing screw until it meets the ball joint. Check the alignment of all components.
5. Tighten the forcing screw until the ball joint is removed.

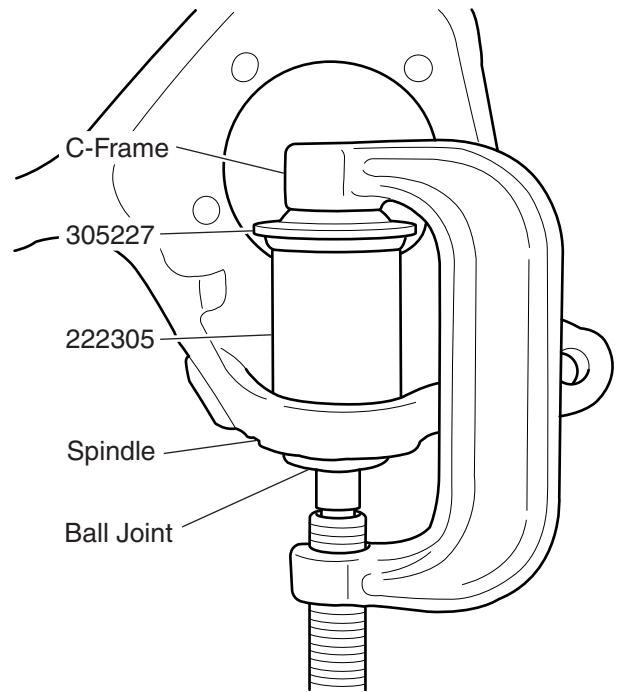

Figure 1. Ball Joint Removal

INSTALLATION:

Note: If replacing both upper and lower ball joint at the same time, remove and install the upper ball joint before installing the lower ball joint.

1. Clean the spindle ball joint bore.
2. Insert the new ball joint as straight as possible into the spindle.
3. Position 204508A and 38354 on the ball joint as shown in Figure 2.
4. Position the C-Frame and tighten the forcing screw.
5. Check the alignment of all the components and continue tightening the forcing screw until the ball joint is firmly seated.
6. Install a new snap ring, dust boot and grease fitting, if equipped.

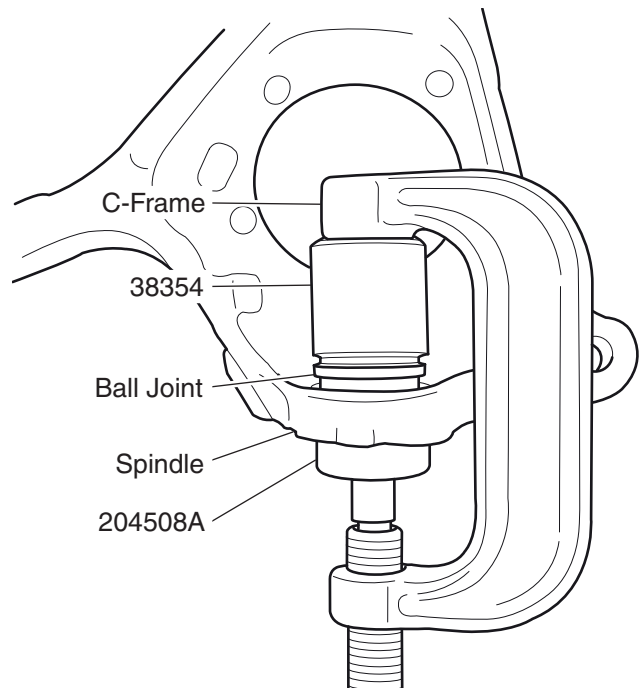

Figure 2. Ball Joint Installation

Component: Lower-Front

Application:

Ford F-450 Super Duty 2WD/4WD 2005-2008

Ford F-550 Super Duty 2WD/4WD 2005-2008

REMOVAL:

1. Secure spindle assembly firmly in vise.
2. Remove the snap ring and grease fitting, if equipped.
3. Position 222306 and 556930 over the stem of the ball joint.
4. Position the C-Frame and 314392 as shown in Figure 1.
5. Turn the forcing screw until it meets the ball joint. Check the alignment of all components.
6. Tighten the forcing screw until the ball joint is removed.

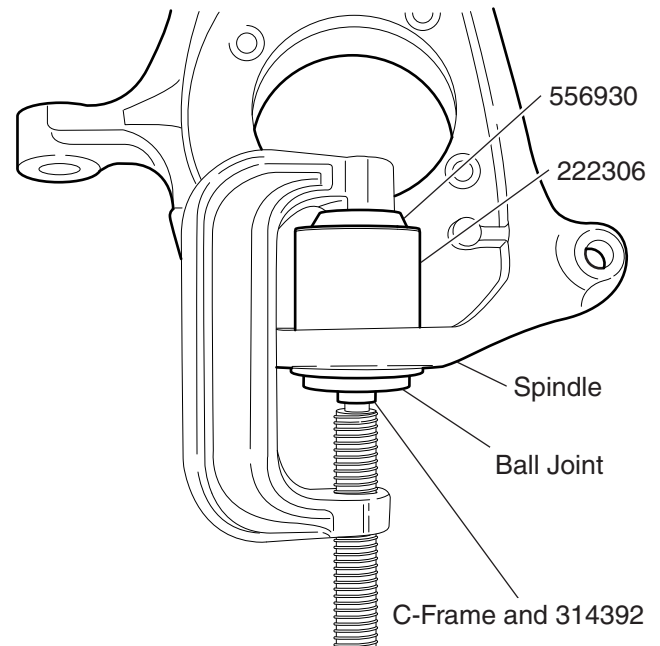

Figure 1. Ball Joint Removal

INSTALLATION:

Note: If replacing both upper and lower ball joint at the same time, remove and install the upper ball joint before installing the lower ball joint.

1. Clean the spindle ball joint bore.
2. Insert the new ball joint as straight as possible into the spindle.
3. Position 556930 and 222307 on the ball joint as shown in Figure 2.
4. Position 557010, the C-Frame and 314392 and tighten the forcing screw.
5. Check the alignment of all the components and continue tightening the forcing screw until the ball joint is firmly seated.
6. Install a new snap ring and grease fitting if equipped.

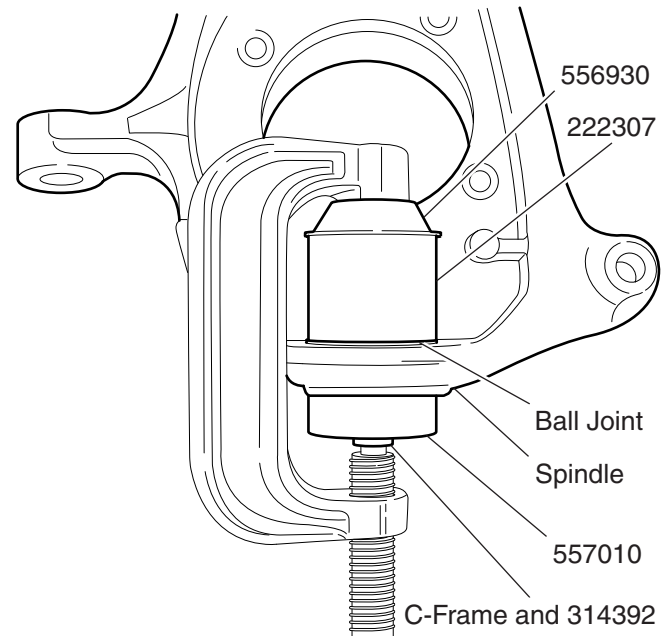

Figure 2. Ball Joint Installation

Component: Upper-Front

Application:

Ford F-450 Super Duty 2WD/4WD 2005-2008

Ford F-550 Super Duty 2WD/4WD 2005-2008

REMOVAL:

Note: The lower ball joint must be removed before the upper ball joint can be serviced.

1. Secure spindle assembly firmly in vise.
2. Remove the grease fitting, if equipped.
3. Position 222307 and 305227 over the stem of the ball joint.
4. Position the C-Frame and 314392 as shown in Figure 1.
5. Turn the forcing screw until it meets the ball joint. Check the alignment of all components.
6. Tighten the forcing screw until the ball joint is removed.

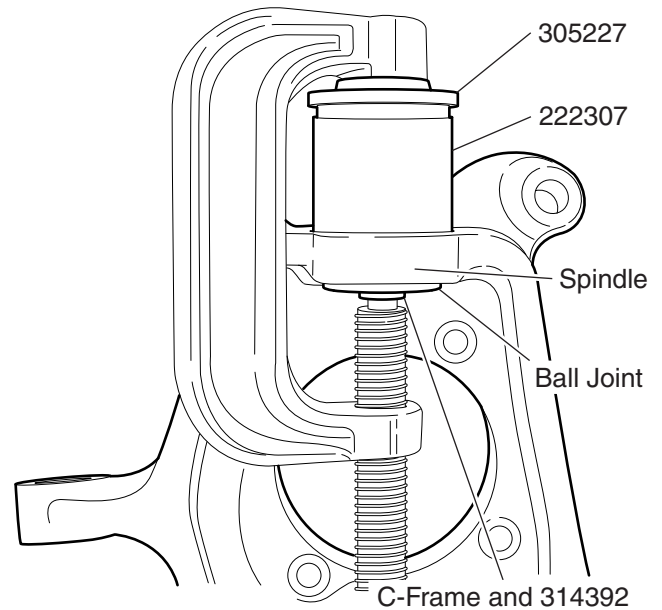

Figure 1. Ball Joint Removal

INSTALLATION:

Note: If replacing both upper and lower ball joint at the same time, remove and install the upper ball joint before installing the lower ball joint.

1. Clean the spindle ball joint bore.
2. Insert the new ball joint as straight as possible into the spindle.
3. Position 38354 on the ball joint as shown in Figure 2.
4. Position 222304, 305228, 314392 and the C-Frame and tighten the forcing screw.
5. Check the alignment of all the components and continue tightening the forcing screw until the ball joint is firmly seated.
6. Install a new grease fitting if equipped.

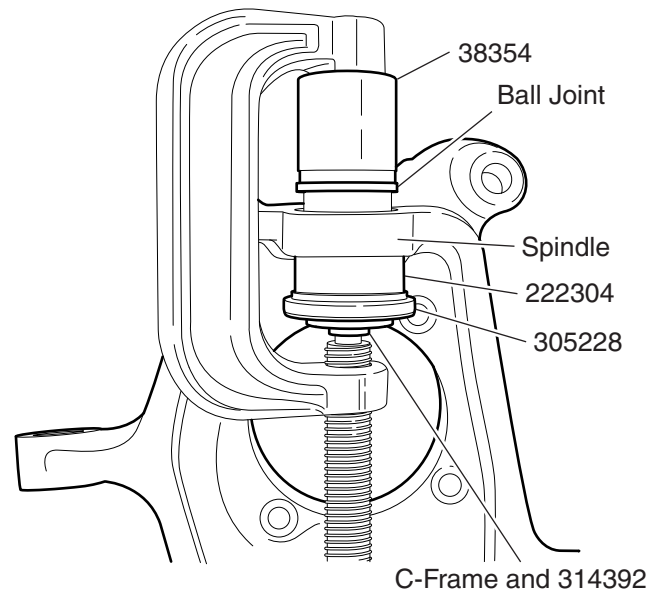

Figure 2. Ball Joint Installation

Component: Upper-Front

Application:

Ford Ranger 2WD 1989-1997

Mazda B2300 2WD 1994-1997

Mazda B3000 2WD 1994-1996

Mazda B4000 2WD 1994-1997

Mazda Navajo 2WD 1992-1994

REMOVAL:

Note: The lower ball joint must be removed before the upper ball joint can be serviced.

1. Secure spindle assembly firmly in vise.
2. Position 29504 and 305227 over the stem of the ball joint.
3. Position the C-Frame as shown in Figure 1.
4. Turn the forcing screw until it meets the ball joint. Check the alignment of all components.
5. Tighten the forcing screw until the ball joint is removed.

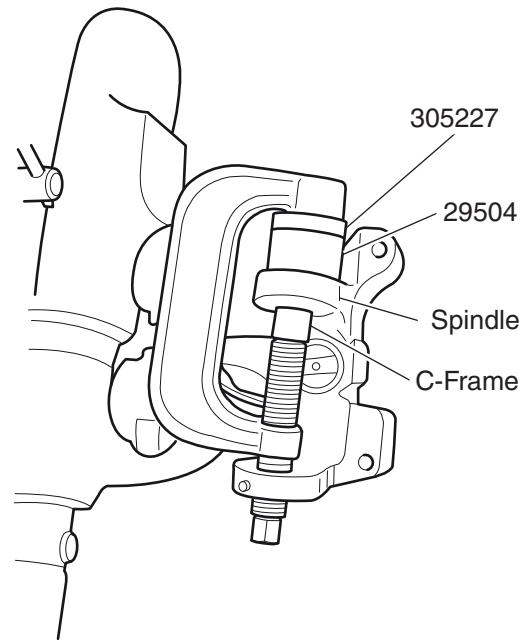

Figure 1. Ball Joint Removal

INSTALLATION:

Note: The upper ball joint must be installed before the lower ball joint.

1. Clean the spindle ball joint bore.
2. Insert the new ball joint as straight as possible into the spindle.
3. Position 38355A on the ball joint as shown in Figure 2.
4. Position 204508A and the C-Frame and tighten the forcing screw.
5. Check the alignment of all the components and continue tightening the forcing screw until the ball joint is firmly seated.
6. Install a new dust boot.

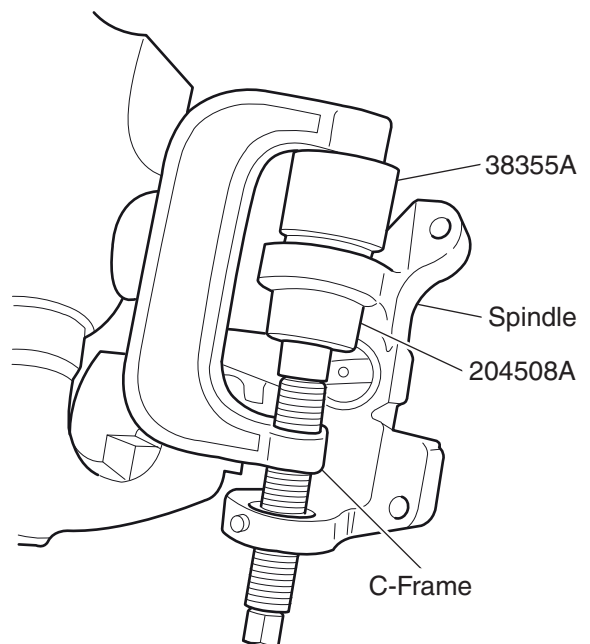

Figure 2. Ball Joint Installation

BRAKE ANCHOR PIN REMOVAL:

1. Remove all lock ring retainers from the brake anchor pins.
2. Position the C-Frame over the brake spider as shown in Figure 1.
3. Tighten the forcing screw until the anchor pin is removed.

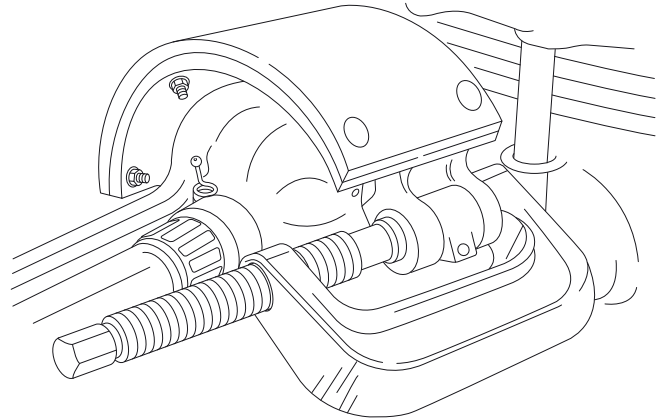

Figure 1. Brake Anchor Pin Removal

U-JOINT DISASSEMBLY AND ASSEMBLY:

The basic C-Frame is used to service the U-Joints on most cars and light trucks. The U-Joints can be serviced either on or off the vehicle.

Disassembly:

1. Remove any external/internal lock rings.
2. Position the C-Frame around the driveshaft yoke. Tighten the forcing screw until the first bearing is removed.
3. Position the C-Frame on the second bearing and tighten the forcing screw until the second bearing is removed.

Assembly:

1. Clean all dirt and oil from the yoke area.
2. Align the new bearing and C-Frame as straight as possible over the yoke. Press the new bearing into the yoke and install the new lock rings.
3. Position the C-Frame and second bearing as straight as possible over the yoke and press the bearing into the yoke and install the new lock rings.

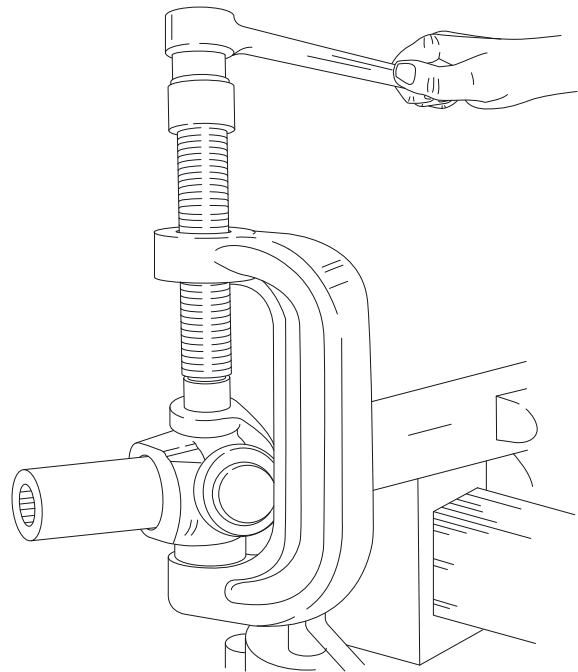

Figure 2. U-Joint Removal and Installation



BALL JOINT QUICK REFERENCE

Make	Model	Year	OEM Kit P/N	Make	Model	Year	OEM Kit P/N
Acura	CL 2.2L	1997	6529-5	Chevrolet	3500 4WD	1996-1999	6539-4
	CL 2.3L	1998-1999	6529-5		Astro 2WD	1985-2005	6539-4
	CL 3.0L	1997-1999	6529-5		Avalanche 1500 2WD/4WD	2002-2008	6539-4
	CL 3.2L	2001-2003	6529-5		Avalanche 2500 2WD/4WD	2002-2006	6539-4
	Integra	1994-2001	6529-5		Blazer 2WD	1982-2005	6539-4
	MDX	2001-2006	6539-1		Camaro	1993-2002	6529-4
	RL 3.5L	1996-2008	6529-5		Caprice	1991-1996	6529-4
	RSX	2002-2006	6529-5		Corvette	1984-2004	6529-4
	TL 2.5L	1996-1999	6529-5		Express 1500	1996-2008	6539-4
	TL 3.2L	1996-2008	6529-5		Express 2500	1996-2008	6539-4
	TSX	2004-2008	6529-5		Express 3500	2003-2008	6539-4
BMW	3 Series (318, 323, 328, M3)	1992-1999	6529-1	G10	1971-1995	6539-4	
Buick	LeSabre	1986-1999	6529-4	G20	1973-1995	6539-4	
	Park Avenue	1991-1997	6529-4	G30	1973-1996	6539-4	
	Rainier	2004-2007	6539-4	Impala	1994-1996	6529-4	
	Roadmaster	1991-1996	6529-4	S-10 2WD	1982-2005	6539-4	
Cadillac	CTS	2003-2008	6529-4	Silverado 1500 2WD/4WD	1999-2007	6539-4	
	DeVille	1996-1999	6529-4	Silverado 1500 HD 2WD/4WD	2001-2007	6539-4	
	Escalade	1999-2007	6539-4	Silverado 2500 & 2500 HD 4WD	1999	6539-4	
	Fleetwood	1991-1996	6529-4	Silverado 2500 2WD	1999-2000	6539-4	
Chevrolet	1500 2WD	1991-2000	6539-4	Silverado 2500 2WD/4WD	2001-2007	6539-4	
	1500 4WD	1996-1999	6539-4	Silverado 2500 4WD	2000	6539-4	
	2500 2WD	1991-2000	6539-4	Silverado 2500 HD 2WD/4WD	2001-2008	6539-4	
	2500 4WD	1996-1999	6539-4	Silverado 3500 2WD/4WD	2001-2008	6539-4	
	30 Motorhome With IFS	1973-1997	6539-4	SSR	2003-2006	6539-4	
	30 Step Van With IFS	1973-1997	6539-4	Suburban 1500 2WD	1992-1999	6539-4	
	3500 2WD With IFS	1991-2000	6539-4	Suburban 1500 2WD/4WD	2000-2008	6539-4	



BALL JOINT QUICK REFERENCE

Make	Model	Year	OEM Kit P/N	Make	Model	Year	OEM Kit P/N
Chevrolet	Suburban 1500 4WD	1996-1999	6539-4	Dodge	Dakota 2WD/4WD	2005-2009	6539-2
	Suburban 2500 2WD	1992-2000	6539-4		Dakota 4x4	1987-2004	6539-2
	Suburban 2500 2WD/4WD	2001-2008	6539-4		Durango 4x2/4x4	2004-2008	6539-2
	Suburban 2500 4WD	1996-2000	6539-4		Durango 4x4	1998-2003	6539-2
	Tahoe 2WD	1995-2000	6539-4		Grand Caravan	1988-2007	6539-2
	Tahoe 2WD/4WD	2001-2008	6539-4		Magnum RWD	2005-2008	6529-2
	Tahoe 4WD	1996-2000	6539-4		Neon	1995-2005	6529-2
	Trailblazer 2WD/4WD	2002-2008	6539-4		Nitro 4x2/4x4	2007-2009	6539-2
	Trailblazer EXT 2WD/4WD	2003-2007	6539-4		Ram 1500 4x2	1994-1999	6539-2
Chrysler	300C RWD	2005-2008	6529-2	Ram 1500 4x2/4x4	2000-2008	6539-2	
	Aspen 2WD/4WD	2007-2008	6539-2	Ram 2500 4x2	1994-2008	6539-2	
	Cirrus	1995-2000	6529-2	Ram 2500 4x4	1994-2008	6539-2	
	Grand Voyager	2000	6539-2	Ram 3500 4x2	1994-2008	6539-2	
	Pacifica FWD/AWD	2005-2008	6539-2	Ram 3500 4x4	1996-2008	6539-2	
	PT Cruiser	2001-2008	6529-2	Ram SRT-10	2004-2006	6539-2	
	Sebring Convertible	1996-2008	6529-2	Ram Van 1500	1995-2003	6539-2	
	Sebring Coupe	2001-2005	6529-2	Ram Van 2500	1995-2003	6539-2	
	Sebring Sedan	1996-2008	6529-2	Ram Van 3500	1995-2003	6539-2	
	Town & Country	1990-2008	6539-2	Ram Van B100	1971-1980	6539-2	
	Voyager	2000-2003	6539-2	Ram Van B150	1981-1994	6539-2	
	Dodge	Avenger	2008	6529-2	Ram Van B200	1971-1980	6539-2
Caliber		2007-2008	6529-2	Ram Van B250	1981-1994	6539-2	
Caravan		1984-2006	6539-2	Ram Van B300	1971-1980	6539-2	
Challenger		2008	6529-2	Ram Van B350	1981-1994	6539-2	
Charger RWD		2005-2008	6529-2	Sprinter 2500	2003-2008	6539-2	
Colt		1984-1994	6539-2	Sprinter 3500	2003-2008	6539-2	
Dakota 2WD		1987-1996	6539-2	Stratus	1995-2008	6529-2	



BALL JOINT QUICK REFERENCE

Make	Model	Year	OEM Kit P/N	Make	Model	Year	OEM Kit P/N
Eagle	2000 GTX (Canada only)	1991-1993	6529-2	Ford	F-350 2WD	1987-1997	6539-3
	Summit	1991-1996	6529-2		F-350 4WD	1992-1997	6539-3
	Talon	1990-1994	6529-2		Fusion	2006-2008	6529-3
Ford	Aerostar 2WD	1986-1997	6539-3		Mustang	1994-2008	6529-3
	Aerostar 4WD	1986-1997	6539-3		Probe	1989-1997	6529-3
	Bronco	1980-1996	6539-3		Ranger 2WD	1989-2008	6539-3
	Bronco II	1984-1990	6539-3		Ranger 2WD/4WD	1998-2008	6539-3
	Crown Victoria	1995-2008	6529-3		Ranger 4WD	1983-1997	6539-3
	E-150	1992-2008	6539-3		Taurus	1996-2007	6529-3
	E-250, E-350, E-450	1996-2008	6539-3		Thunderbird	1989-1997	6529-3
	Escape 2WD/4WD	2001-2008	6539-3	GMC	1500 2WD	1991-2000	6539-4
	Excursion 2WD	2000-2005	6539-3		1500 4WD	1996-1999	6539-4
	Excursion 4WD	2000-2005	6539-3		2500 2WD	1991-2000	6539-4
	Expedition 2WD/4WD	1997-2008	6539-3		2500 4WD	1996-2000	6539-4
	Explorer 2WD/4WD	1995-2008	6539-3		3500 2WD With IFS	1991-2000	6539-4
	Explorer 4WD	1991-1994	6539-3		3500 4WD	1996-2000	6539-4
	Explorer Sport Trac	2007-2008	6539-3		3500 Motorhome With IFS	1973-1997	6539-4
	Explorer/Sport/Sport Trac 2WD/4WD	2001-2005	6539-3		3500 Step Van With IFS	1973-1997	6539-4
	F-150 2WD	1987-1996	6539-3		Envoy 2WD/4WD	2002-2008	6539-4
	F-150 2WD/4WD	1997-2008	6539-3		G1500	1971-1995	6539-4
F-150 4WD	1980-1996	6539-3	G2500		1973-1995	6539-4	
F-150 Heritage and Lightning	2004	6539-3	G3500		1973-1996	6539-4	
F-250 2WD	1987-1997	6539-3	Jimmy 2WD		1982-2002	6539-4	
F-250 4WD	1980-1997	6539-3	S-15 Sonoma 2WD		1982-2004	6539-4	
F-250 4WD (Under 8500 lb. GVW)	1997-1999	6539-3	Safari 2WD		1985-2005	6539-4	
F-250 Super Duty 2WD With Twin I-Beam Axle	1999-2008	6539-3	Savana 1500		1996-2008	6539-4	
F-250, F-350, F-450, F-550 Super Duty 2WD/4WD	1999-2008	6539-3	Savana 2500		1996-2008	6539-4	



BALL JOINT QUICK REFERENCE

Make	Model	Year	OEM Kit P/N	Make	Model	Year	OEM Kit P/N	
GMC	Savana 3500	1996-2008	6539-4	Honda	Civic	1992-2000	6529-5	
	Sierra 1500 2WD/4WD	1999-2007	6539-4		Civic Del Sol	1993-1997	6529-5	
	Sierra 1500 4WD	1999-2007	6539-4		Civic Del Sol	1993-1997	6529-5	
	Sierra 1500 HD 2WD/4WD	2000-2007	6539-4		Civic Hatchback	2002-2005	6529-5	
	Sierra 2500 2WD/4WD	1999-2004	6539-4		Civic Hatchback Hybrid	2003-2005	6529-5	
	Sierra 2500 HD 2WD/4WD	2001-2008	6539-4		Civic Sedan & Coupe	2001-2005	6529-5	
	Sierra 3500 2WD/4WD	2001-2008	6539-4		Civic Sedan & Coupe Hybrid	2003-2005	6529-5	
	Sierra Denali	2002-2007	6539-4		CR-V	1997-2001	6539-1	
	Suburban 1500 2WD	1992-1999	6539-4		CR-V	1997-2001	6539-1	
	Suburban 1500 4WD	1996-1999	6539-4		CR-V	2002-2006	6539-1	
	Suburban 2500 2WD	1992-1999	6539-4		Element	2003-2008	6539-1	
	Suburban 2500 4WD	1996-1999	6539-4		Odyssey	1994-1998	6539-1	
	Yukon	2001-2007	6539-4		Odyssey	1995-1998	6539-1	
	Yukon 2WD	1995-2000	6539-4		Odyssey	1999-2006	6539-1	
	Yukon 4WD	1996-2000	6539-4		Pilot	2003-2006	6539-1	
	Yukon Denali	1999-2000	6539-4		Prelude	1992-1999	6529-5	
	Yukon Denali & Denali XL	2001-2005	6539-4		Hummer	H2	2003-2008	6539-4
	Yukon XL 1500	2000-2007	6539-4		Hyundai	Accent	1995-2005	6529-6
	Yukon XL 2500	2000-2008	6539-4			Elantra	1996-2006	6529-6
				SantaFe		2001-2008	6539-1	
Honda	Accord	1990-1997	6529-5		Sonata	1995-1998	6529-6	
	Accord	1994-1997	6529-5		Tiburon	1997-2008	6529-6	
	Accord Hybrid	2005-2006	6529-5	Infiniti	G20	1991-1996	6529-6	
	Accord Hybrid	2005-2006	6529-5		I30	1996-2001	6529-6	
	Accord Sedan & Coupe	1998-2002	6529-5		I35	2002-2004	6529-6	
	Accord Sedan & Coupe	1998-2008	6529-5		QX56	2004-2006	6539-1	
	Accord Sedan & Coupe	2003-2008	6529-5					
	Civic	1992-2000	6529-5	Isuzu	Ascender 2WD/4WD	2003-2008	6539-1	



BALL JOINT QUICK REFERENCE

Make	Model	Year	OEM Kit P/N	Make	Model	Year	OEM Kit P/N
Isuzu	Hombre 2WD	1996-2000	6539-1	Mazda	B-2300 4WD	1995-1997	6539-3
	Oasis	1996-1999	6539-1		B-2300 4WD With Torsion Bar Suspension	2001	6539-3
Jeep	Cherokee	1990-2001	6539-2		B-2500 2WD With Coil Spring Suspension	1998-2001	6539-3
	Cherokee (RHD)	1996-1998	6539-2		B-2500 2WD/4WD With Torsion Bar Suspension	1998-2001	6539-3
	Commander 2WD/4WD	2006-2009	6539-2		B-2500 4WD With Torsion Bar Suspension	1998-2001	6539-3
	Compass 2WD	2007-2008	6539-2		B-3000 2WD	1994-1996	6539-3
	Compass 4WD	2007-2008	6539-2		B-3000 2WD With Coil Spring Suspension	1998-2004	6539-3
	Grand Cherokee	1993-2004	6539-2		B-3000 2WD With Torsion Bar Suspension	1998-2001	6539-3
	Grand Cherokee 2WD/4WD	2005-2009	6539-2		B-3000 2WD/4WD With Torsion Bar Suspension	1998-2007	6539-3
	Grand Wagoneer	1993-1994	6539-2		B-3000 4WD	1994-1996	6539-3
	Liberty 2WD/4WD	2002-2009	6539-2	B-3000 4WD With Torsion Bar Suspension	1998-2001	6539-3	
	Wrangler	1987-2008	6539-2	B-4000 2WD	1994-1997	6539-3	
Kia	Spectra	2005-2008	6529-6	B-4000 2WD	1994-2004	6539-3	
	Spectra 5	2006-2008	6529-6	B-4000 2WD/4WD With Torsion Bar Suspension	1998-2008	6539-3	
Lincoln	Aviator 2WD/4WD	2003-2005	6539-3	B-4000 4WD	1994-2001	6539-3	
	Blackwood	2002	6539-3	MX-6	1988-1997	6529-3	
	Continental	1995-2002	6529-3	Navajo 2WD	1992-1994	6539-3	
	Mark VIII	1993-1998	6529-3	Navajo 4WD	1991-1994	6539-3	
	MKZ	2007-2008	6529-3	Mercury	Cougar	1989-1997	6529-3
	Navigator 2WD/4WD	1998-2006	6539-3		Grand Marquis	1995-2008	6529-3
	Town Car	1995-2008	6529-3		Marauder	2003-2004	6529-3
	Zephyr	2006	6529-3		Mariner 2WD/4WD	2005-2008	6539-3
Mazda	626	1983-1997	6529-3		Milan	2006-2008	6529-3
	B-2300 2WD	1994-1997	6539-3		Mountaineer	1997-2008	6539-3
	B-2300 2WD	2001-2004	6539-3		Sable	1996-2005	6529-3
	B-2300 2WD/4WD	2001-2004	6539-3		Tribute 2WD/4WD	2008	6539-3
	B-2300 2WD/4WD	2005-2008	6539-3	Tribute 2WD/4WD	2001-2006	6539-3	



BALL JOINT QUICK REFERENCE

Make	Model	Year	OEM Kit P/N	Make	Model	Year	OEM Kit P/N
Mitsubishi	Eclipse	1990-2005	6529-2	Pontiac	Bonneville	1987-1999	6529-4
	Galant	1985-2008	6529-2		Firebird	1993-2002	6529-4
	Mighty Max	1983-1996	6539-2	Saab	9-7x	2005-2008	6529-6
	Raider	2006-2009	6539-2	Toyota	4-Runner	1996-2002	6539-1
Nissan	200SX	1995-1998	6529-6		Echo	2000-2005	6529-6
	240SX	1994-1998	6529-6		Sequoia	2001-2008	6539-1
	300ZX	1990-1996	6529-6		Tacoma	2005-2008	6539-1
	Altima	1993-2001	6529-6		Tacoma 4WD	1995-2004	6539-1
	Armada	2005-2008	6539-1		Tacoma Prerunner 2WD	1995-2004	6539-1
	D21 Pickup 2WD	1991-1997	6539-1		Tundra	2000-2006	6539-1
	Frontier	1998-2008	6539-1				
	Maxima	1995-2003	6529-6				
	Pathfinder	2005-2008	6539-1				
	Sentra	1991-2006	6529-6				
	Titan	2004-2008	6539-1				
	Versa	2007-2008	6529-6				
	Xterra	2000-2008	6539-1				
Oldsmobile	88	1985-1999	6529-4				
	98	1985-1996	6529-4				
	Bravada 2WD/4WD	2002-2004	6539-4				
	LSS	1996-1999	6529-4				
	Regency	1997-1998	6529-4				
Plymouth	Breeze	1995-2000	6529-2				
	Grand Voyager	1988-2000	6539-2				
	Laser	1990-1994	6529-2				
	Neon	1995-2001	6529-2				
	Voyager	1984-2003	6539-2				