

## 4WD Front Hub Puller

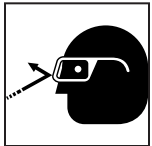

**CAUTION:** To prevent personal injury, wear eye protection that meets ANSI Z87.1 and OSHA standards.

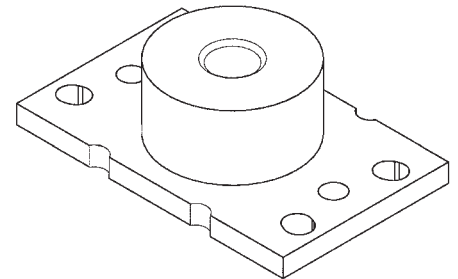
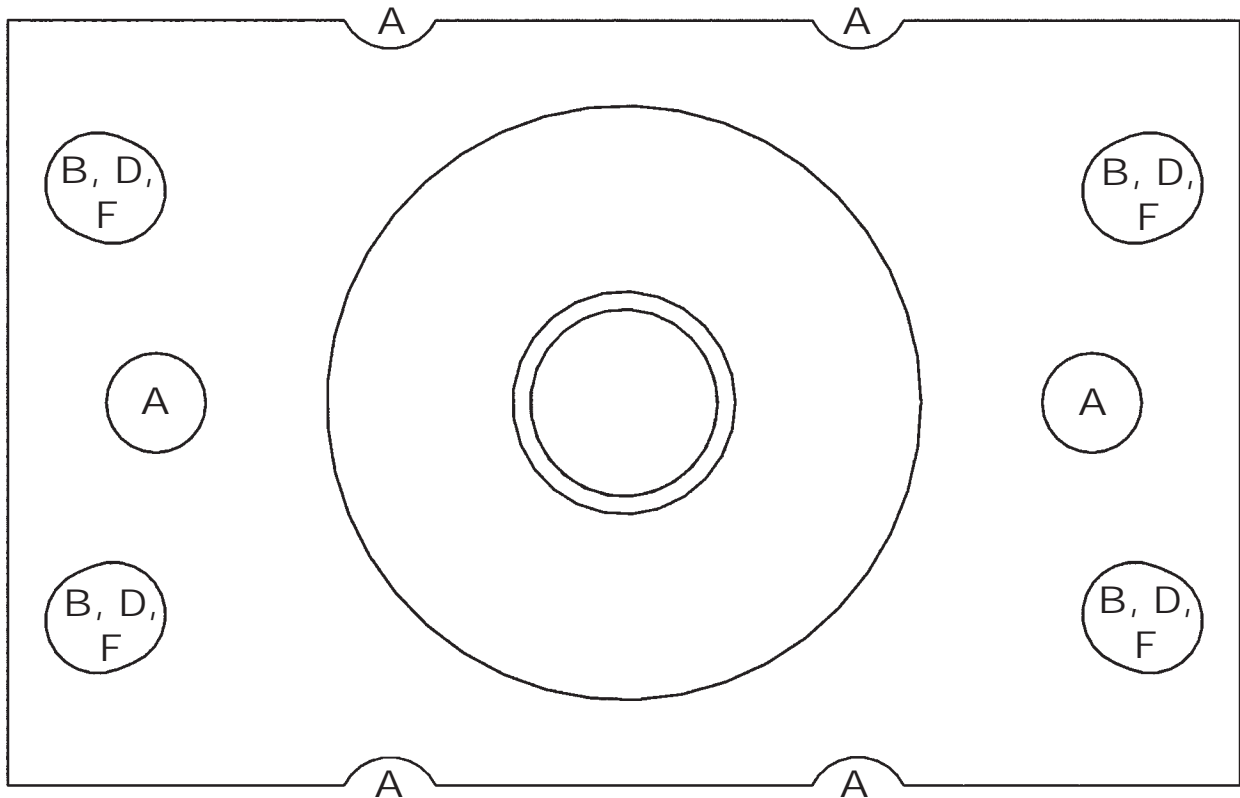

Location	Make	Year	Model	No. of Bolts	Bolt Circle Diameter	Bolt Size
A	GM	1988 – 2013	1/2-Ton Trucks, Yukon, Tahoe, Suburban	6	139.7 mm (5.50 in.)	14–1.5 mm
B	GM	1988 – 2013	3/4- and 1-Ton Trucks, Suburban	8	165.1 mm (6.50 in.)	14–1.5 mm
D	Ford	1998 – 2013	3/4- and 1-Ton Trucks, Excursion	8	170 mm (6.69 in.)	14–2.0 mm
F	Dodge	1994 – 2013	3/4- and 1-Ton Ram Trucks	8	165.1 mm (6.50 in.)	9/16 in. RH