

OTC 5693 SINGLE/DUAL WHEEL SEPARATOR

Dual Wheel Applications:

Semi tractors/trailers (19.5–24.5" dia. wheels)
1-Ton dual wheel pickup trucks (16" or 17" dia. wheels)

CAUTION: To prevent personal injury and/or equipment damage caused by a separated wheel falling unexpectedly, remove most lug nuts but leave a couple attached by a few threads on each side of the wheel.

1. Apply good grade lubricant to the tool drive screw before each use.
Use penetrating oil on wheel stud holes and between wheels, if needed.
2. Install adapter #575326 into screw assembly.
3. With screw fully retracted, hold tool handle and insert adapter through the wheel hole and thread the screw until the adapter end touches the adjacent wheel rim. Two slots on the adapter are marked for best fit on the application's wheel size. The appropriate adapter slot fits over the wheel rim lip, and the flat area of the adapter against the wheel edge (no part of the adapter should touch the tire itself).
4. Hand-thread screw inward until the tab on the tool handle contacts the edge of the outside wheel hole.
5. Use an impact wrench to tighten the screw to begin separation of the wheels.
6. If needed, remove the tool and repeat steps 3 thru 5 in a wheel hole 180° of the first hole.
7. Repeat locations until wheel is separated.
8. If the inside dual is also stuck, insert adapter 579100 or 575325 into screw, whichever fit's application best.

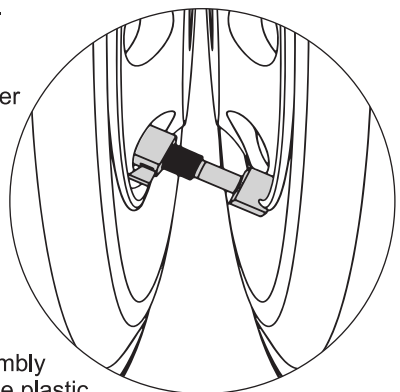
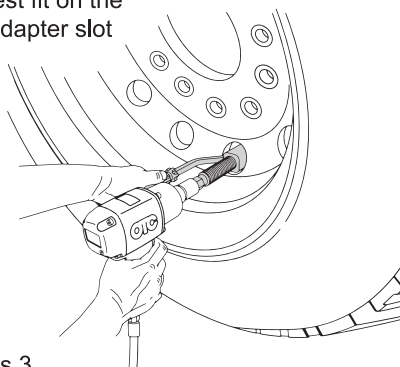

NOTE: Regardless of application type, do not over-stress the tool. If loosening wheel(s) is extra difficult, leave the tool in place and use an impact hammer to shock the wheel around the lugholes.

Tool Maintenance: Lubricate the screw assembly regularly. Always place tool and adapters in the plastic case and store case in a cool, dry location.

Single Wheel Applications:



Use adapter #579100 or #575325 for removal of a typical single wheel.

CAUTION: To prevent personal injury and/or equipment damage from a separated wheel falling unexpectedly, remove most lug nuts but leave a couple attached by a few threads on each side of the wheel.

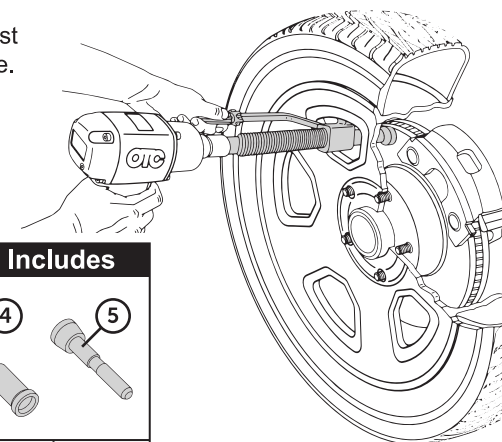
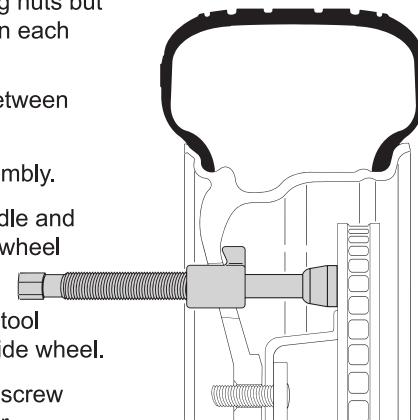
1. Apply penetrating oil to lug studs and between wheel and rotor.
2. Install adapter #579100 into screw assembly.
3. With screw fully retracted, hold tool handle and insert adapter through opening in outer wheel until adapter contacts the rotor.
4. Hand-thread screw inward until stop on tool handle contacts the opening of the outside wheel.
5. Use an air impact wrench to tighten the screw and begin separation of wheel from rotor.
6. If needed, remove tool and move to an opening 180° opposite of first opening and again apply pressure.
7. Move tool again as needed to separate wheels completely.

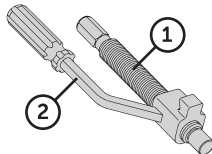
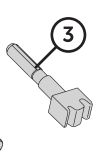
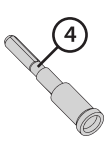

5693 Wheel Separator Tool Kit Includes

	1	222395
	2	575328
	3	575326
	4	579100
	5	575325



WARNING

To prevent personal injury, wear eye protection that meets ANSI Z87.1 and OSHA standards.