

**Parts List &  
Operating Instructions**  
for:

**5019A**

## Low Lift Transmission Jack

Maximum Capacity: 2,200 Lbs.

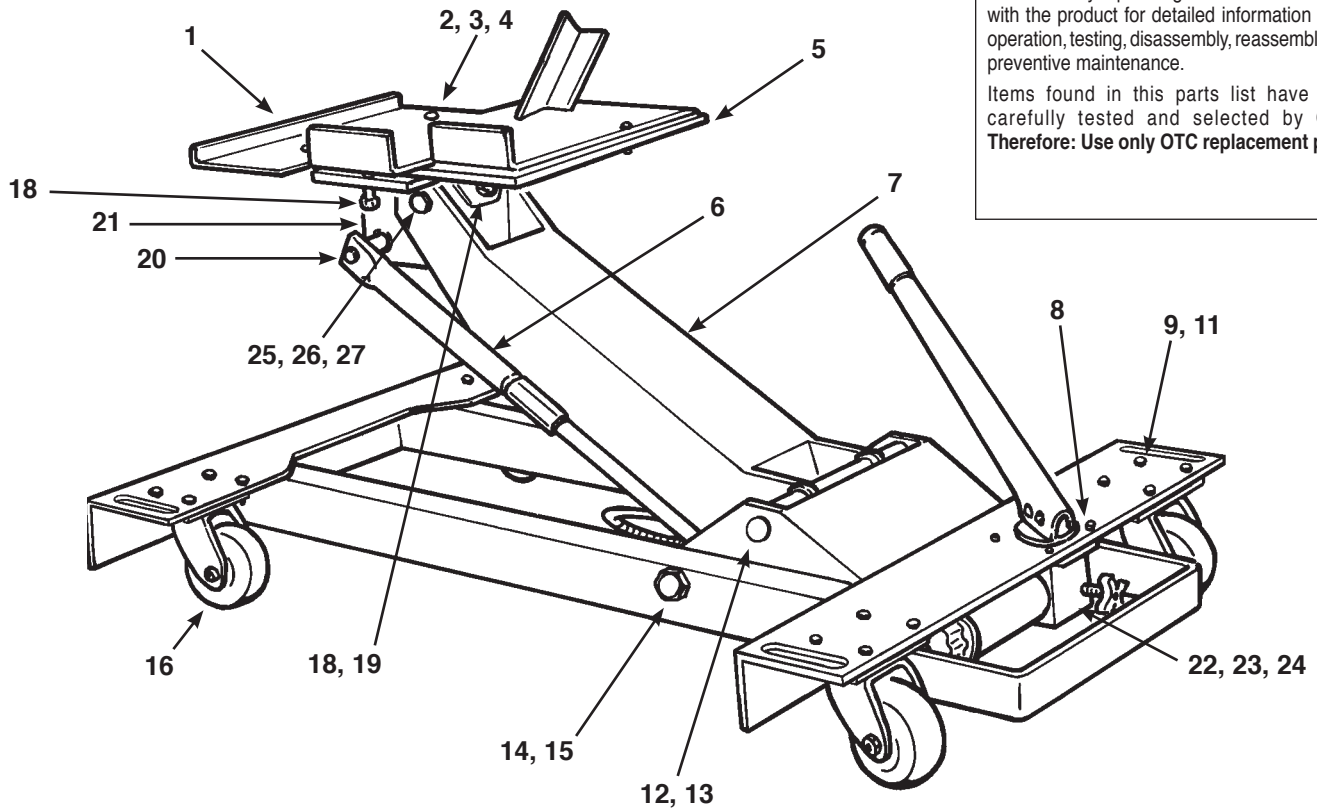

Refer to any operating instructions included with the product for detailed information about operation, testing, disassembly, reassembly, and preventive maintenance.

Items found in this parts list have been carefully tested and selected by OTC. Therefore: Use only OTC replacement parts!

Item No.	No. Req'd	Description
<b>The following items are contained in Hardware Kit No. 549851</b>		
2	3	Hex Nut
3	3	Washer
4	3	Bolt (M12 x 1.75 x 31MM)
8	4	Socket Hd. Screw
9	16	Hex Nut (5/16-18)
11	16	Hex Hd. Cap Screw
12	2	Retaining Ring
14	2	Hex Hd. Cap Screw
15	2	Washer
18	4	Hex Hd. Cap Screw
19	2	Lock Nut (.750-10)
20	1	Retaining Ring
23	5	Cap Screw
24	1	Retainer
25	2	Hex Hd. Cap Screw
26	2	Hex Lock Nut
27	2	Flanged Bearing

Item No.	Part No.	No. Req'd	Description
1	538316	1	Trans. Mounting Plate (for Rockwell & Eaton® RoadRanger® transmissions; includes Items 1-4)
5	538320	1	Mounting Plate
6	538311	1	Special Screw
7	538313	1	Lift Weldment
13	539019	1	Pin
16	541308	4	Caster
21	538328	1	Mounting Bracket
22	544346	1	Swivel Hand Pump (see Form No. 544717)

**Parts Included but Not Shown**

218083	2	Warning Decal
540402	1	Decal
312556	1	Warning Decal

# Parts List & Operating Instructions

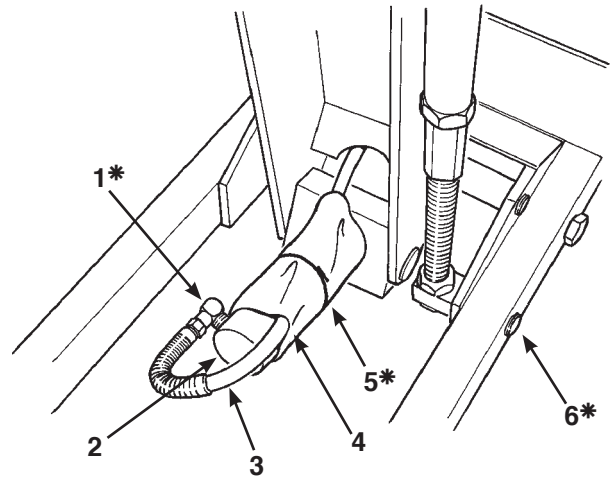
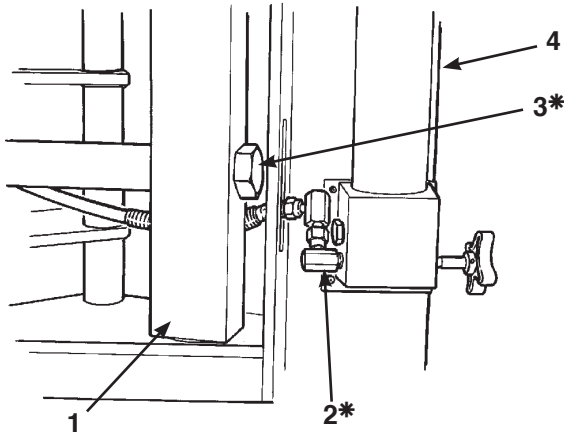

Item No.	Part No.	No. Req'd	Description
1	538314	1	Cylinder Mounting Plate
2	*	2	Elbow Fitting
3	*	1	Hex Screw (1-8 x 82.3 MM)
4	544346	1	Swivel Hand Pump (see Form No. 544717)

Item No.	Part No.	No. Req'd	Description
1	*	1	90° Elbow
2	544331	1	Hydraulic Cylinder (see Form No. 544718)
3	544345	1	Hydraulic Hose
4	544332	1	Protective Sleeve
5	*	1	Cable Tie
6	*	1	Retaining Ring

Items marked with an asterisk (\*) are contained in Hardware Kit No. 549851

## Safety Precautions

**WARNING:** Failure to follow these warnings could cause a loss of load, damage to equipment, and / or failure of equipment, which may result in personal injury or property damage:



- If the operator cannot read English, operating instructions and safety precautions must be read and discussed in the operator's native language.



- Wear eye protection that meets the requirements of ANSI Z87.1 and OSHA standards.

- Before each use, inspect the jack for leaks and damaged, loose, or missing parts. Immediately replace cut, frayed, or damaged hoses.

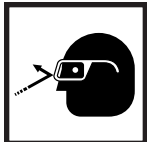

- Do not modify this transmission jack or use attachments unless supplied by OTC. If a modification is needed, please contact OTC Technical Services.

- This jack is designed to remove or install only automotive or truck transmissions. Using the jack in a manner for which it is not designed may result in injury or damage to equipment.



- The load must not exceed the maximum rated capacity of 2,200 lbs.

- Stay out from underneath the load at all times.

- Secure the load to the jack.

- Use the jack on hard, level surfaces only.

- Lower the load completely before moving the jack.

## Assembly Instructions

1. Assemble the handle to the pump by aligning the holes in the handle with the holes in the pump cap and piston. Slide a pin through each hole, and secure each pin with a retaining ring on each end. See Figure 1.
2. For use with a Rockwell or Eaton® RoadRanger® truck transmission: Place the transmission mounting plate (No. 538316) on top of the white mounting plate (No. 538320) as shown in the parts list drawing. Insert bolts through the three holes in the plates. Secure the bolts by attaching a washer and nut to each bolt from underneath the plates.

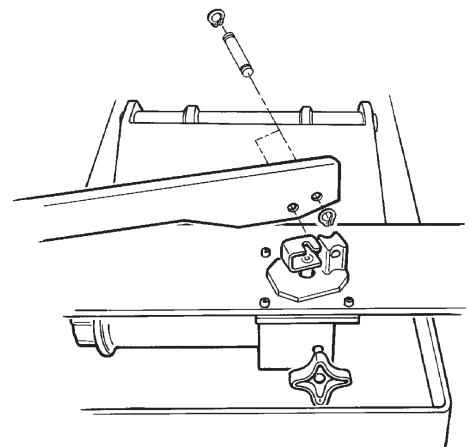
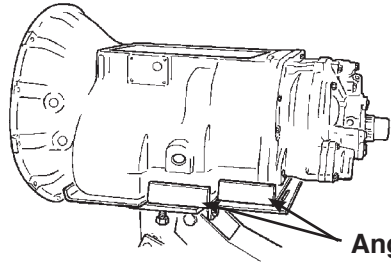
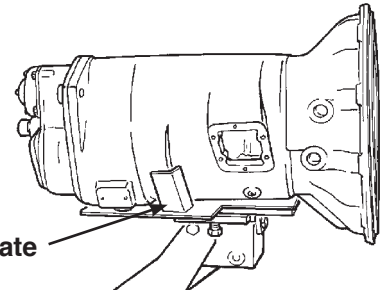

Figure 1

### Operating Instructions



**Figure 2**  
The transmission must rest against the angle plates as shown.



1. Position the jack under the transmission.
2. Close the control valve. Operate the pump handle to raise the boom and align the mounting plate with the transmission. See Figure 2.
3. Remove the transmission according to the instructions in the vehicle service manual.
4. Position the transmission on the mounting plate, resting against the angle plates as shown in Figure 2.
  - The transmission mounting plate may be tilted forward and backward by adjusting the linkage arm (No. 538311).
  - The transmission mounting plate may be tilted side-to-side by adjusting the hex hd. cap screws.
5. Secure the transmission to the mounting plate.
6. Lower the load by slowly opening the control valve. Use the control valve to regulate how fast the boom is lowered.

### Optional Equipment - OTC AdjustaGrip® Universal Mounting Arm (No. 538578)

OTC's universal mounting arms may be used to mount other large transmissions to the low lift transmission jack. (Order No. 305811 for one universal mounting arm; order each arm separately.)

1. Remove the transmission mounting plate (No. 538316), bolts, washers, and hex nuts.
2. Fasten the universal mounting arms to the top of the mounting plate (No. 538320) using the washers and nuts provided. See Figure 3.
  - a. Loosen all the joints in the adjust-a-grip arms.
  - b. Locate the right angle mounting ear of each arm over a slot in the mounting plate, and install a washer and nut.
  - c. Use cap screws to attach at least two of the arms to the transmission.

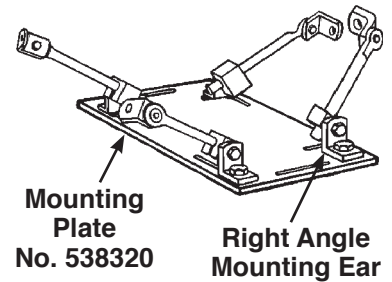

**Figure 3**

### Maintenance

1. Completely lower the jack any time it is not being used.
2. The hydraulic pump and ram assembly should be drained, flushed, and refilled with oil at least once each year. Use a high grade hydraulic oil such as OTC No. 9636 or an equivalent (215 SUS viscosity rating at 100° F).
3. Lubricate caster swivel plates and wheels every six months using pressure gun grease.
4. Lubricate lift arm pivot points as needed with SAE 30 motor oil.

## Light-Duty Transmission Adapters

Maximum Capacity: 454 kg (1000 lbs.)

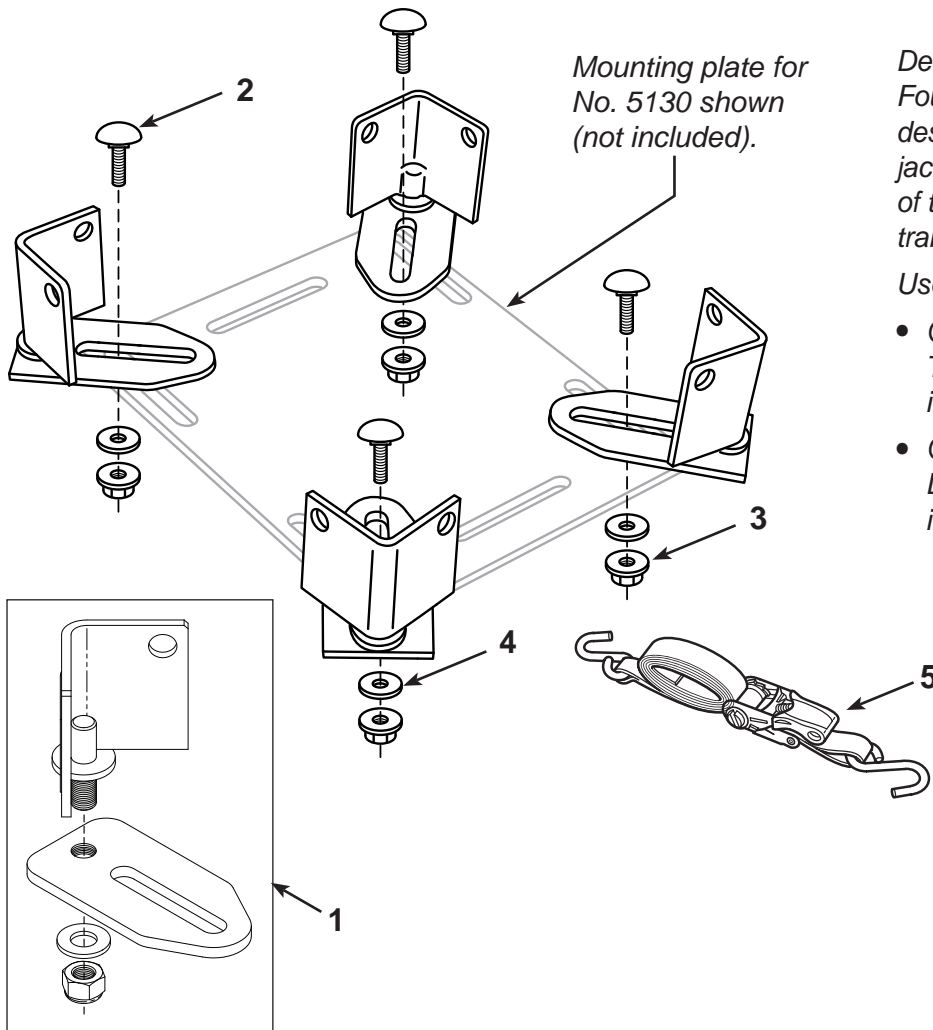

**Description:**

Four universal mounting adapters designed to be used on a transmission jack mounting plate for the purpose of transporting and repairing vehicle transmissions.

**Use with:**

- OTC No. 5019A, 5078, or 1522A Transmission Jack for removal and installation of differential assemblies.
- OTC No. 5130 DriveMaster™ Driveline Lift for removal and installation of driveline components.

### Parts List

Item No.	Part No.	No. Req'd	Description
1	<b>561947</b>	1	Transmission Adapter Assembly (consists of adapter, flat washer, hex nut)

### Repair Kit No. 569966

Item No.	Qty.	Description
2	4	Carriage Bolt — 1/2-13 x 30.48 mm (1.25 in.)
3	4	Flange Nut — 1/2-13 thread
4	4	Washer — plain, type "A"
5	1	Ratchet Strap — 4 ft. (122 cm)

# Parts List & Operating Instructions

---

## Explanation of Safety Signal Words

The safety signal word designates the degree or level of hazard seriousness.



**DANGER:** Indicates an imminently hazardous situation which, if not avoided, will result in death or serious injury.



**WARNING:** Indicates a potentially hazardous situation which, if not avoided, could result in death or serious injury.



**CAUTION:** Indicates a potentially hazardous situation which, if not avoided, may result in minor or moderate injury.

**CAUTION:** Used without the safety alert symbol indicates a potentially hazardous situation which, if not avoided, may result in property damage.

## Safety Precautions



**CAUTION:** To prevent personal injury and/ or property damage,



- Study, understand, and follow all safety precautions and operating instructions before using these transmission adapters. If the operator cannot read instructions, operating instructions and safety precautions must be read and discussed in the operator's native language.



- Only qualified operators may install, operate, adjust, maintain, clean, repair, inspect, or transport these transmission adapters.
- Wear eye protection that meets ANSI Z87.1 and OSHA standards.
- Do not exceed the rated capacity of these transmission adapters as stated in this document and on the warning decal.



- These adapters are designed to work together in a group of four. Using fewer than four adapters in a setup could result in personal injury caused by the load tipping or falling.
- Do not use these transmission adapters for anything other than their intended purpose.
- Use the ratchet strap included to secure the load to the transmission jack.
- No alteration shall be made to this product.
- Inspect the condition of the transmission adapters before each use; do not use if damaged, altered, or in poor condition.
- Use only those repair parts called out in the parts list in this document. Items found in the parts list have been carefully tested and selected by OTC.

## Operating Instructions

1. Install the transmission adapters on the transmission jack mounting plate using the carriage bolts, washers, and flange nuts provided. Hand tighten the flange nuts. See Figure 1.
2. Raise the arm of the jack up to the transmission.
3. Adjust the transmission adapters as needed to fit the transmission. Tighten the flange nuts.
4. Use ratchet strap to secure the transmission to the transmission jack as shown in Figure 2. Attach the hooks on the end of the ratchet strap to the slots provided in the mounting plate, the top holes in the transmission adapters, or other suitable locations.

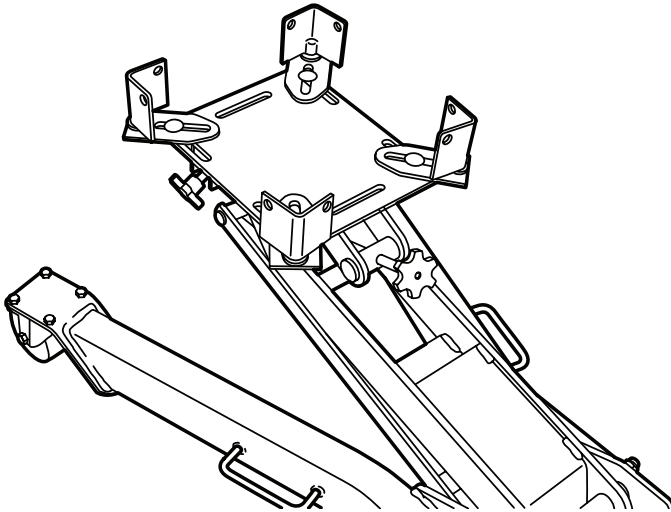

Figure 1

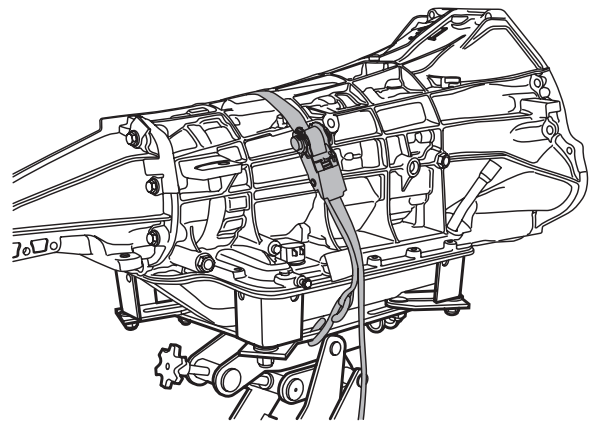

Figure 2

## Inspection and Maintenance



**CAUTION:** To prevent personal injury,

- Only qualified personnel shall perform inspections and repairs to these transmission adapters.
- Before each use, an approved inspector must inspect the transmission adapters for bends, cracks, dents, elongated holes, or missing hardware. If damage is found, discontinue use.
- Use only those repair parts called out in the parts list in this document. Items found in the parts list have been carefully tested and selected by OTC.

## Auxiliary Box Adapter

Maximum Capacity: 227 kg (500 lbs.)

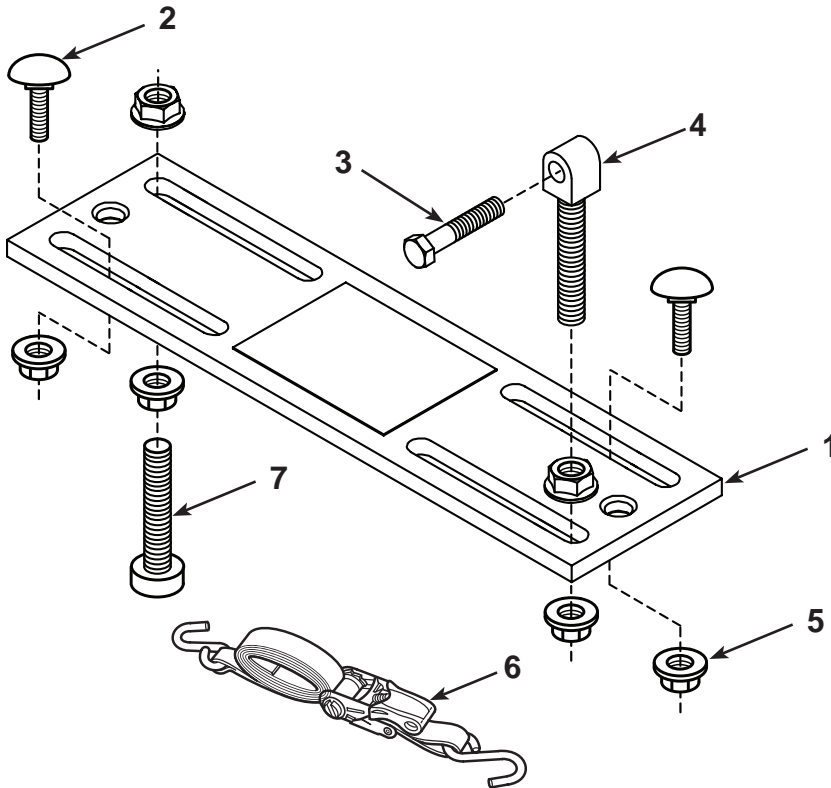

*Description:*

Mounting adapter designed to be used on a transmission jack mounting plate for the purpose of removing and installing the transmission housing auxiliary box.

*Use with:*

- OTC No. 5019A, 5078, or 1522A Transmission Jack for removal and installation of differential assemblies.
- OTC No. 5130 DriveMaster™ Driveline Lift for removal and installation of driveline components.

### Parts List

Item No.	Part No.	No. Req'd	Description
1	<b>569968</b>	1	Plate Assembly (consists of plate & decal)

### Repair Kit No. 569967

Item No.	Qty.	Description
2	2	Carriage Bolt — 1/2-13 x 30.48 mm (1.25 in.)
3	1	Hex Head Screw — 3/8-16 x 50.8 mm (2 in.)
4	1	Stud — .500-13 x 101.6 mm (4 in.)
5	6	Flange Nut — 1/2-13 thread
6	1	Ratchet Strap — 122 cm (4 ft.)
7	1	Support Screw — 95.25 mm (3.75 in.)

## Explanation of Safety Signal Words

The safety signal word designates the degree or level of hazard seriousness.



**DANGER:** Indicates an imminently hazardous situation which, if not avoided, will result in death or serious injury.



**WARNING:** Indicates a potentially hazardous situation which, if not avoided, could result in death or serious injury.



**CAUTION:** Indicates a potentially hazardous situation which, if not avoided, may result in minor or moderate injury.

**CAUTION:** Used without the safety alert symbol indicates a potentially hazardous situation which, if not avoided, may result in property damage.

## Safety Precautions



**CAUTION:** To prevent personal injury and/ or property damage,



- Study, understand, and follow all safety precautions and operating instructions before using the auxiliary box adapter. If the operator cannot read instructions, operating instructions and safety precautions must be read and discussed in the operator's native language.

- Only qualified operators may install, operate, adjust, maintain, clean, repair, inspect, or transport this auxiliary box adapter.



- Wear eye protection that meets ANSI Z87.1 and OSHA standards.
- Do not exceed the rated capacity of this auxiliary box adapter as stated in this document and on the warning decal.



- Do not use this auxiliary box adapter for anything other than their intended purpose.
- Use the ratchet strap included to secure the load to the transmission jack.
- No alteration shall be made to this product.
- Inspect the condition of the auxiliary box adapter before each use; do not use if damaged, altered, or in poor condition.
- Use only those repair parts called out in the parts list in this document. Items found in the parts list have been carefully tested and selected by OTC.



## Operating Instructions

1. Install the auxiliary box adapter on the transmission jack mounting plate using the carriage bolts and flange nuts provided. Tighten the flange nuts. See Figure 1.
2. Plan the placement of the support screw and stud to fit your application. Figure 1 shows the support screw and the stud assembled to the adapter plate in one of several possible arrangements.
3. Assemble both the support screw and the stud to the plate with one flange nut above the plate and one flange nut below the plate. The flat side of each flange nut must rest against the plate.
4. Thread the lower flange nut on the stud all the way to the bottom of the threads. This allows room for adjustment.
5. Remove a bolt from the front of the transmission auxiliary box.
6. Move the jack under the transmission, aligning the stud with the hole where the bolt was removed in the auxiliary box. Insert the bolt through the stud and into the auxiliary box. See Figure 2.

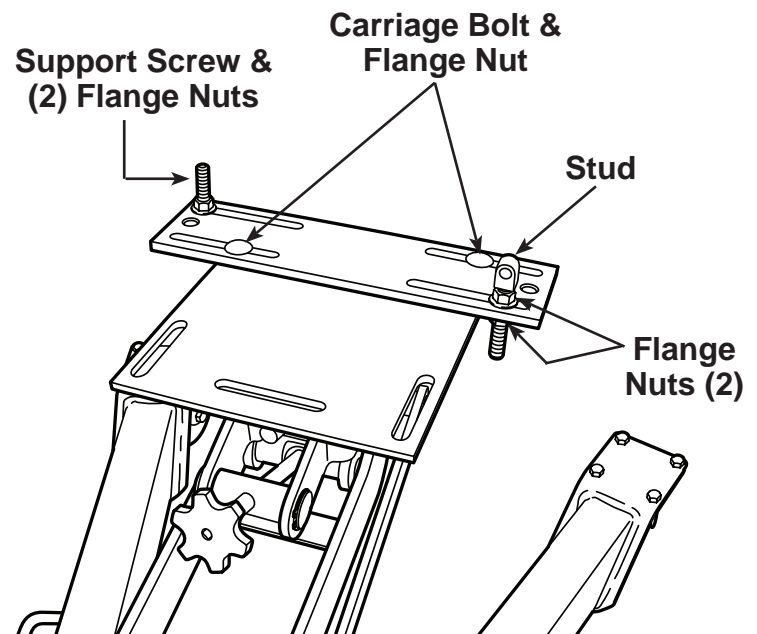

Figure 1

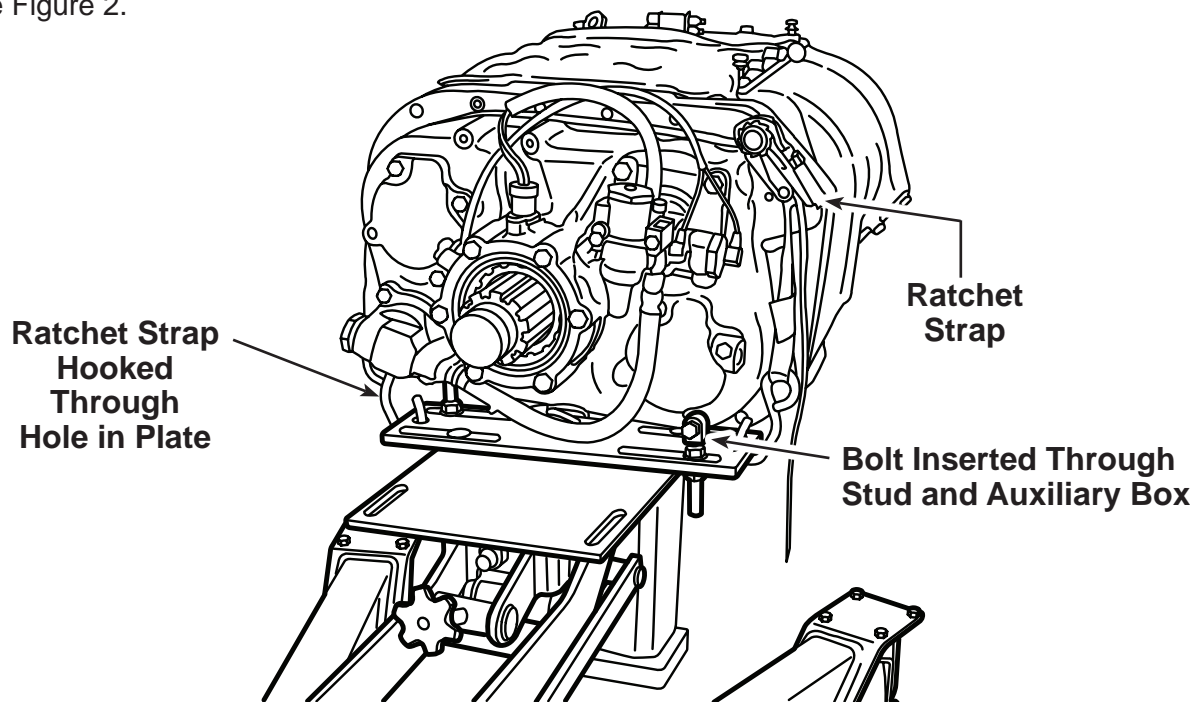

Figure 2

## Parts List & Operating Instructions

---

### Operating Instructions contd.

7. Thread the upper flange nut on the support screw to the bottom of the threads until the support screw touches the housing. See Figure 3.
8. Install the ratchet strap to secure the auxiliary box to the transmission jack. See Figure 2. Attach the hooks on the end of the ratchet strap to the slots provided in the mounting plate or other suitable locations.

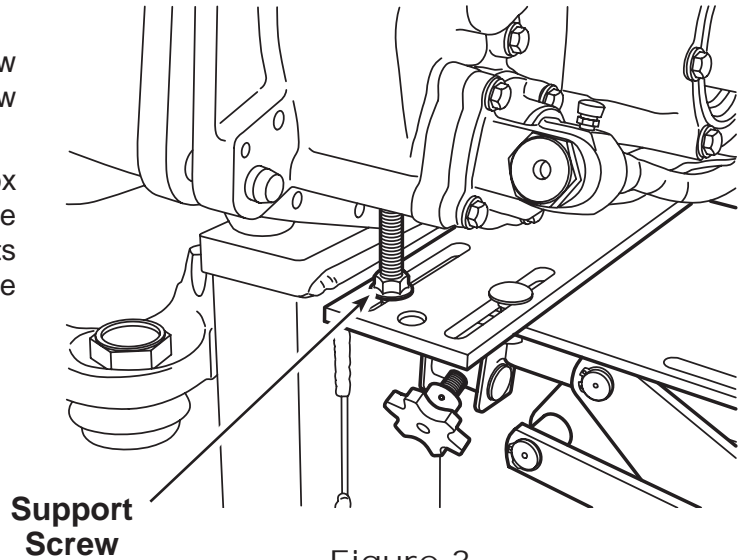

Figure 3

### Inspection and Maintenance

 **CAUTION:** To prevent personal injury,

- Only qualified personnel shall perform inspections and repairs to this auxiliary box adapter.
- Before each use, an approved inspector must inspect the auxiliary box adapter for bends, cracks, dents, elongated holes, or missing hardware. If damage is found, discontinue use.
- Use only those repair parts called out in the parts list in this document. Items found in the parts list have been carefully tested and selected by OTC.

**Parts List &  
Operating Instructions**  
for:

49611

## Auxiliary Housing Adapter

Application: Eaton® Roadranger® Transmissions

Max. Capacity: 300 Lbs.

### Parts List

Item No.	Part No.	No. Req'd	Description
1	12682	6	Retaining Ring
2	220784	3	Spacer
3	10231	3	Washer
4	221746	3	Bolt (3/8-16 x 2" lg.)
5	213886	3	Bolt (M10 x 1.5 x 50 mm)
	49611	1	Adapter (includes Items 1-4)

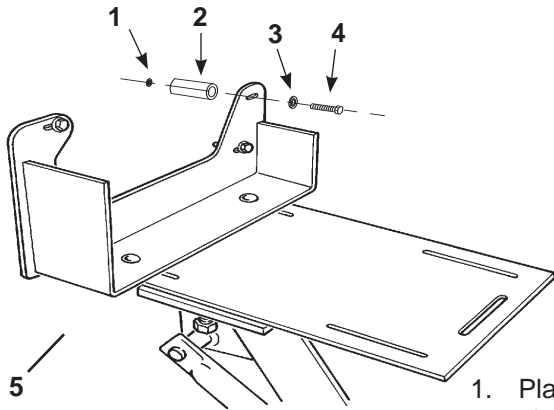

Figure 1

### Assembly Instructions

1. Place the auxiliary housing adapter (No. 49611) on top of the jack's mounting plate as shown in Figure 1 or 2. (Figure 2 shows the adapter attached to OTC No. 220492 transmission adapter plate.) Secure the adapter with the bolts that were supplied with the jack.
2. Attach the three adapter bolts to the countershaft bearing caps on the auxiliary housing as shown in Figure 3.

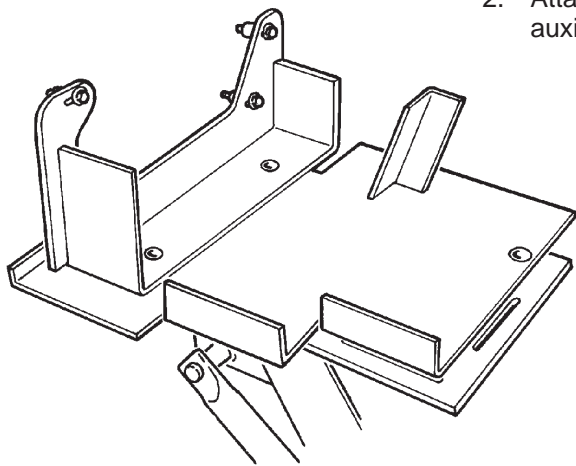

Figure 2

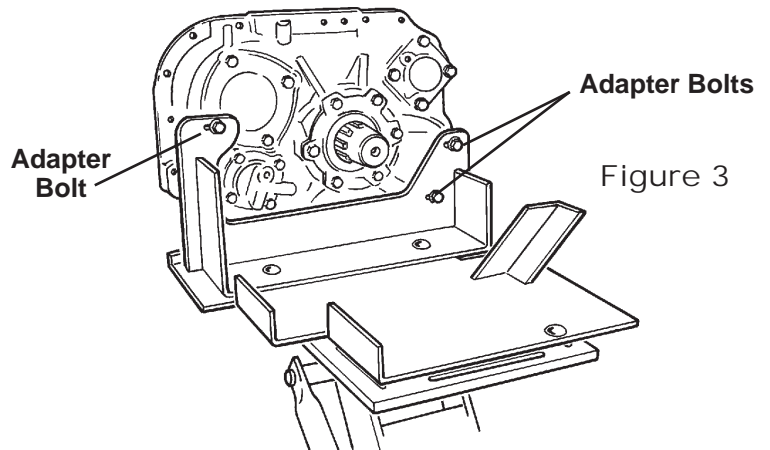

Figure 3

### Safety Precautions



**WARNING:** Failure to follow these warnings could cause a loss of load, damage to equipment, and / or failure of equipment, which could result in personal injury or property damage.

- Wear protective eyewear that meets the requirements of ANSI Z87.1 and OSHA.
- Do not modify this housing adapter or use attachments unless supplied by OTC. If a modification is needed, please contact OTC Technical Services.
- This auxiliary housing adapter is designed to remove or install Eaton Roadranger truck auxiliary housings only. Using the adapter in a manner for which it is not designed may result in injury or damage to equipment.
- The load must not exceed the maximum rated capacity of 300 pounds.
- Stay out from underneath the load at all times.
- Secure the load to the jack.