

ORACLE® 2014-15 CAMARO RS HEADLIGHT HALO INSTALLATION GUIDE

TOOLS:



OPENING THE HEADLIGHT:



USING THE HEATING METHOD:
IF USING A HEAT GUN BEGIN BY HEATING THE SEAL EVENLY WHILE CONSTANTLY MOVING THE HEAT GUN. IF USING AN OVEN: PREHEAT TO 225°F AND PLACE THE LIGHT IN THE OVEN FOR 10 MINUTES.

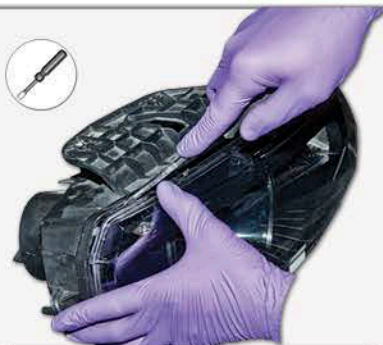

A) Start by using a flat-head screwdriver and apply pressure between the lens and housing. Caution, headlight will be hot.

B) Work your way around the housing with a screwdriver. Prying through the sealant until the lens and the housing separate.



C) Remove the (7) T-15 torx screws from the headlight. See reference picture for screw locations.



These two pieces will separate from the headlight.

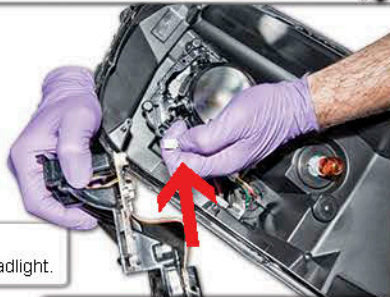

D) Disconnect this clip. The stock halo housing can now be separated.

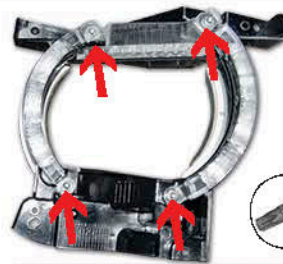

E) Remove the (4) T-15 torx screws. This will allow separation of the stock halo diffusers.



You will re-use these stock diffusers.

INSTALLING THE HALOS:



F) Remove the (6) T-15 torx screws. You can now separate the stock halo and its components from the housing.

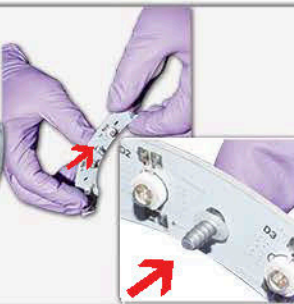

G) Place a single spacer on each of the torx screws before installing the ORACLE ColorSHIFT Halo.

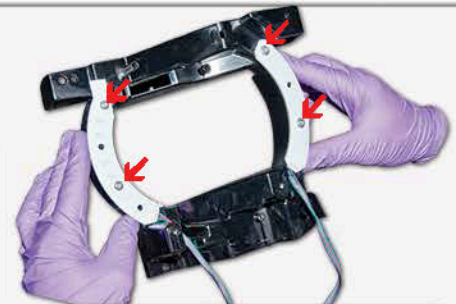

H) Now tighten the (4) torx screws. Use the picture to reference the correct side to install the ORACLE Halos.

**INSTALL GUIDE
CONTINUED....:**



I) Next, you will trim off each plastic extension. This piece will not fit unless each extension is trimmed down. Refer to the close up image.



J) Place a single spacer on each of the torx screws before re-installing the stock diffuser.

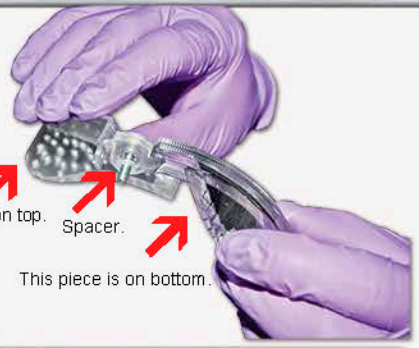

This piece is on top. Spacer. This piece is on bottom.



K) Use another spacer on the adjoining side of the stock diffusers.



L) Now tighten down all of the T-15 torx screws. We recommend hand tightening each screw to avoid stripping.

ALMOST DONE!



M) Drill a small hole on the underside of the headlight. This is where the wires will be routed out of the headlight.

*For best results use ORACLE Headlight Sealant

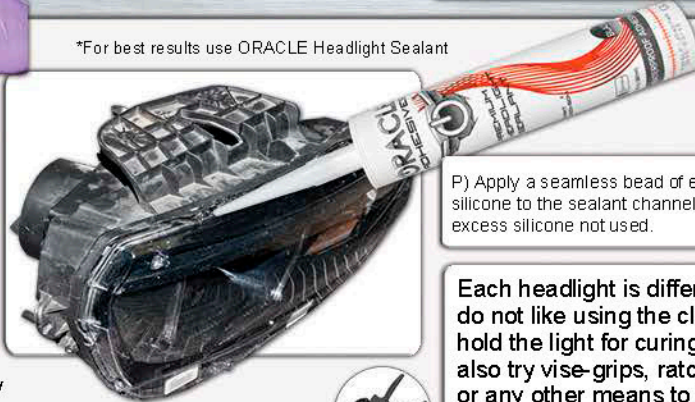

P) Apply a seamless bead of exterior grade silicone to the sealant channel. Wipe off any excess silicone not used.

RE-SEALING THE HEADLIGHT:

- Check that there is no dust or debris in the light.
- Use compressed air to blow out before reassembly
- Make sure every part of the headlight is re-installed correctly.
- You are now ready to re-install the lens back onto the housing.

Each headlight is different. If you do not like using the clamps to hold the light for curing you may also try vise-grips, ratchet straps, or any other means to hold the lens and the housing together.

WIRING THE HEADLIGHTS:

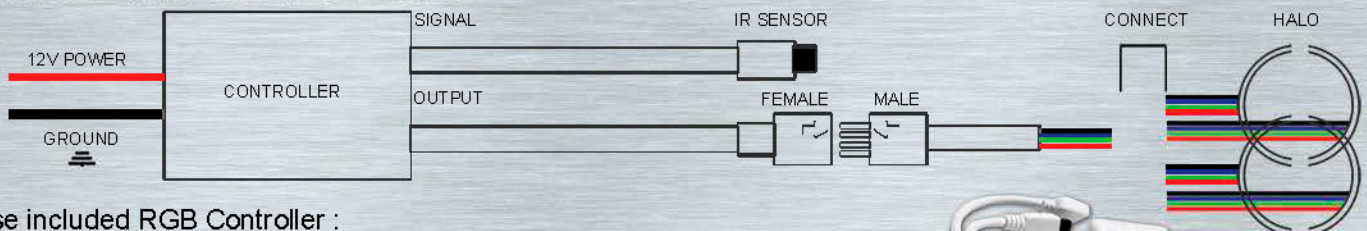

Use included RGB Controller :

- Connect RGB halo wires to matching color wires on the male plug. (Provided.)
- Connect male adapter to female adapter.
- Mount controller box to a safe location inside the engine bay.
- Connect controller wires Red (+) to 12V power source and Black (-) to ground.

