

REV.	E.C.R.	DESCRIPTION	BY	DATE

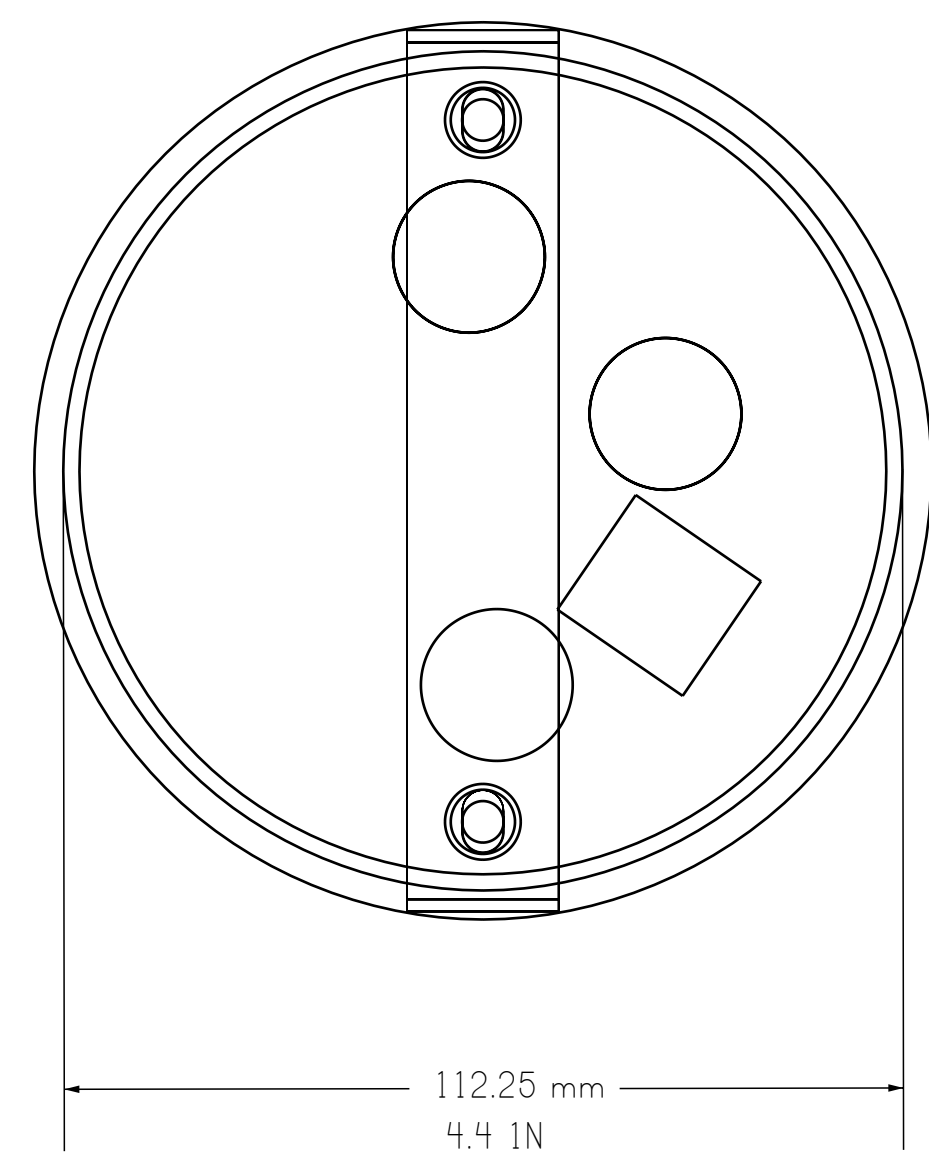

4-3/8" GAUGES
 4-3/8" MOUNTING HOLE (TIGHT)
 LOOSE MOUNTING HOLE 4-7/16"
 4-11/16" O.D.
 3-5/8" DEEP

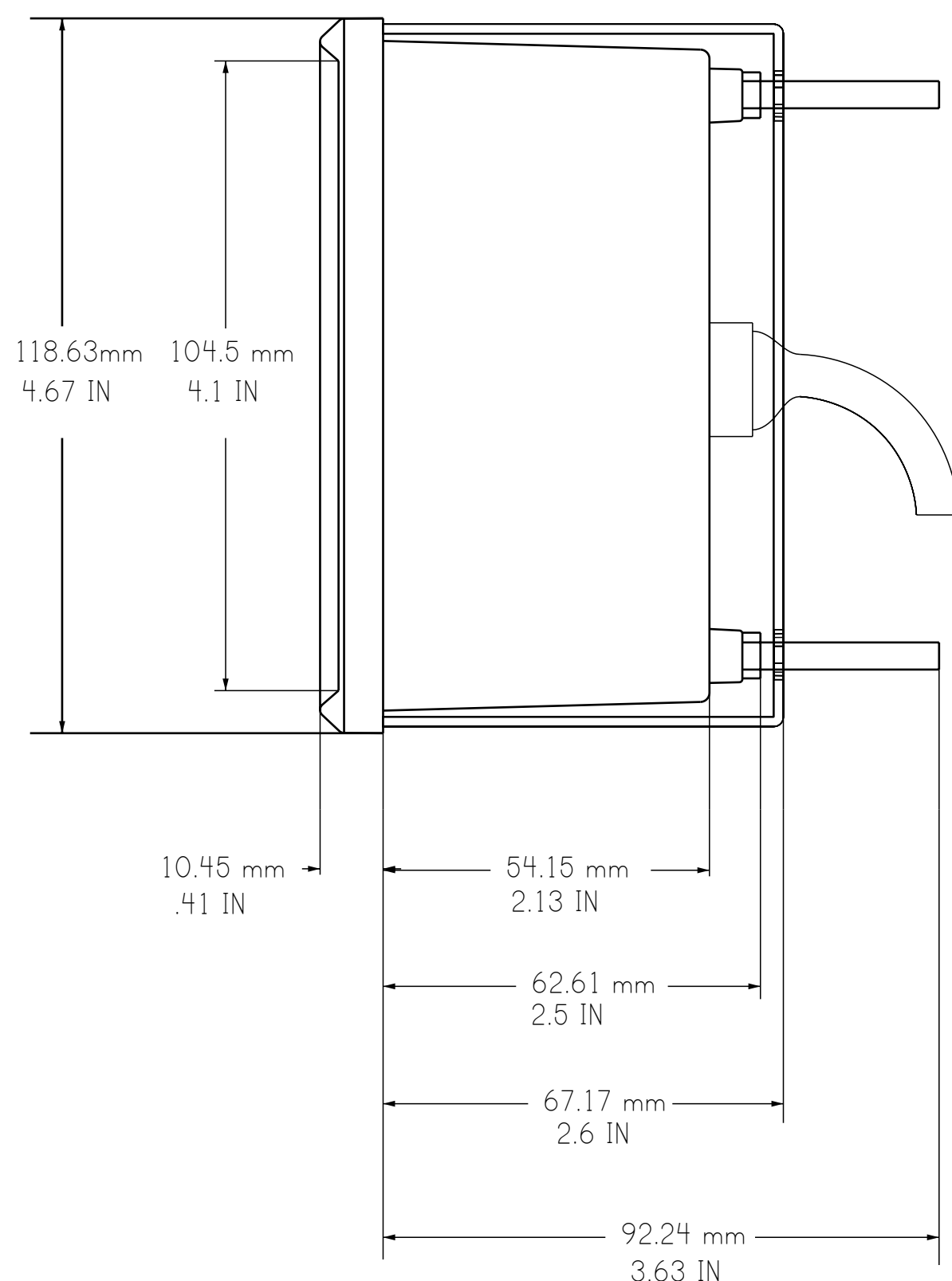
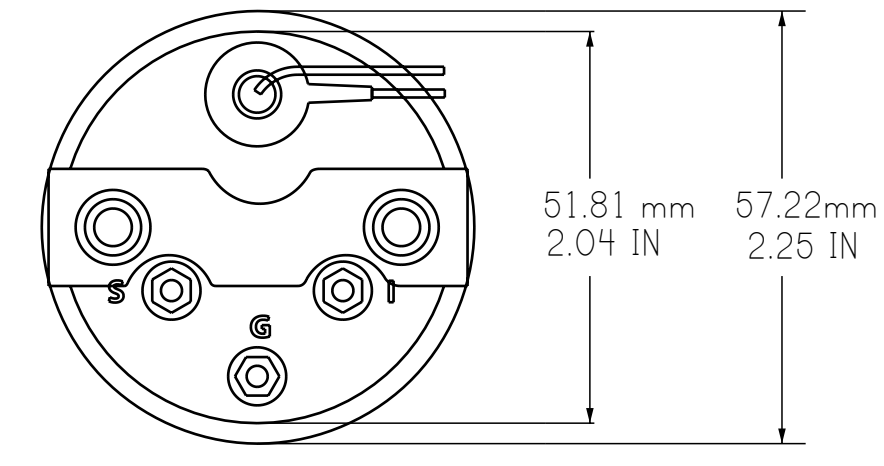
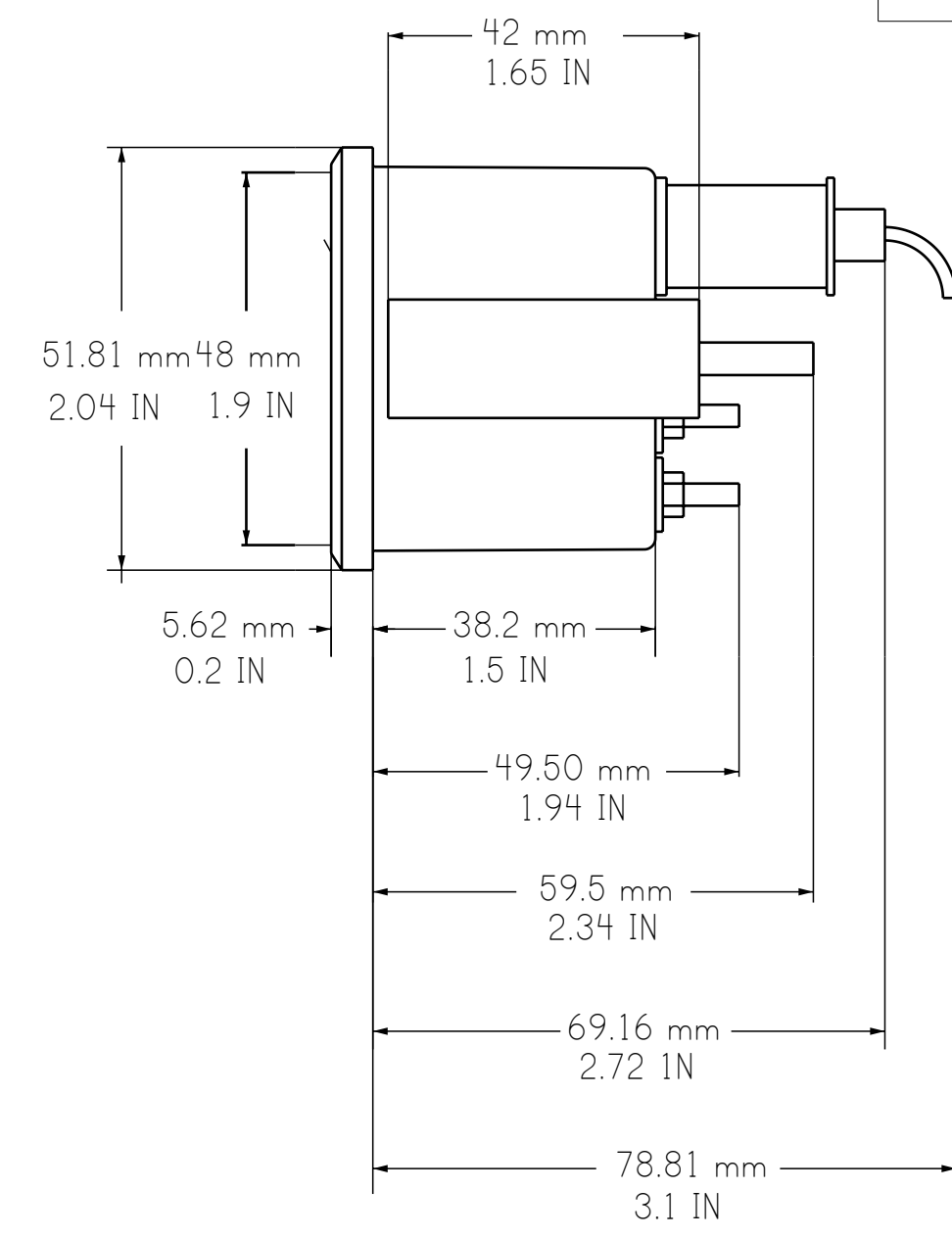

2" GAUGES
 (SHORT SWEEP)
 2-1/16" MOUNTING HOLE
 2-1/4" O.D.
 3-1/16" DEEP

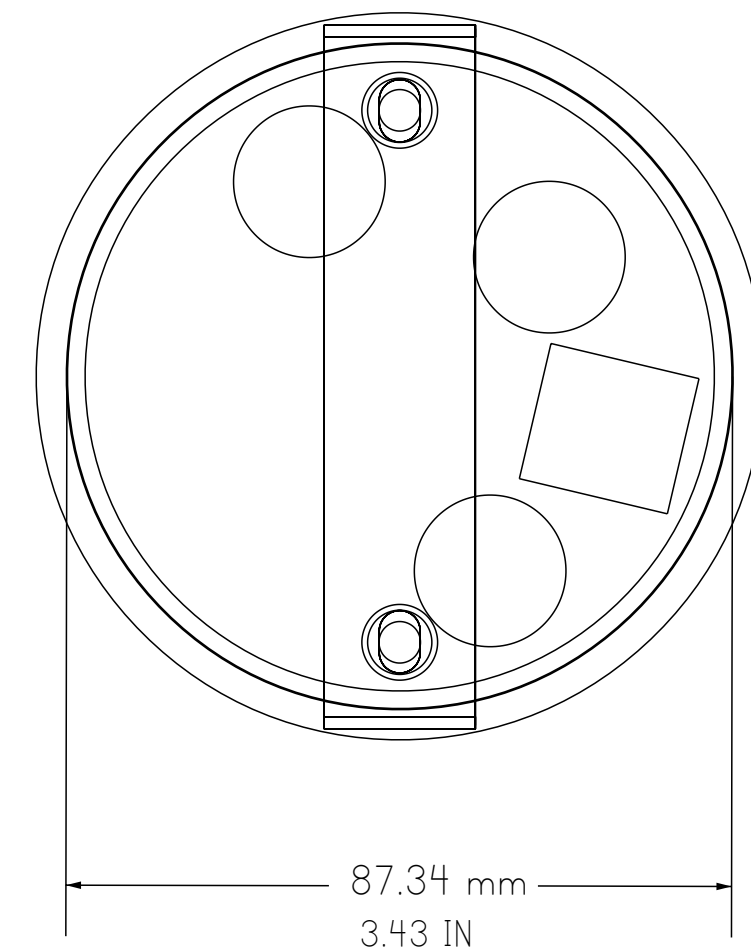
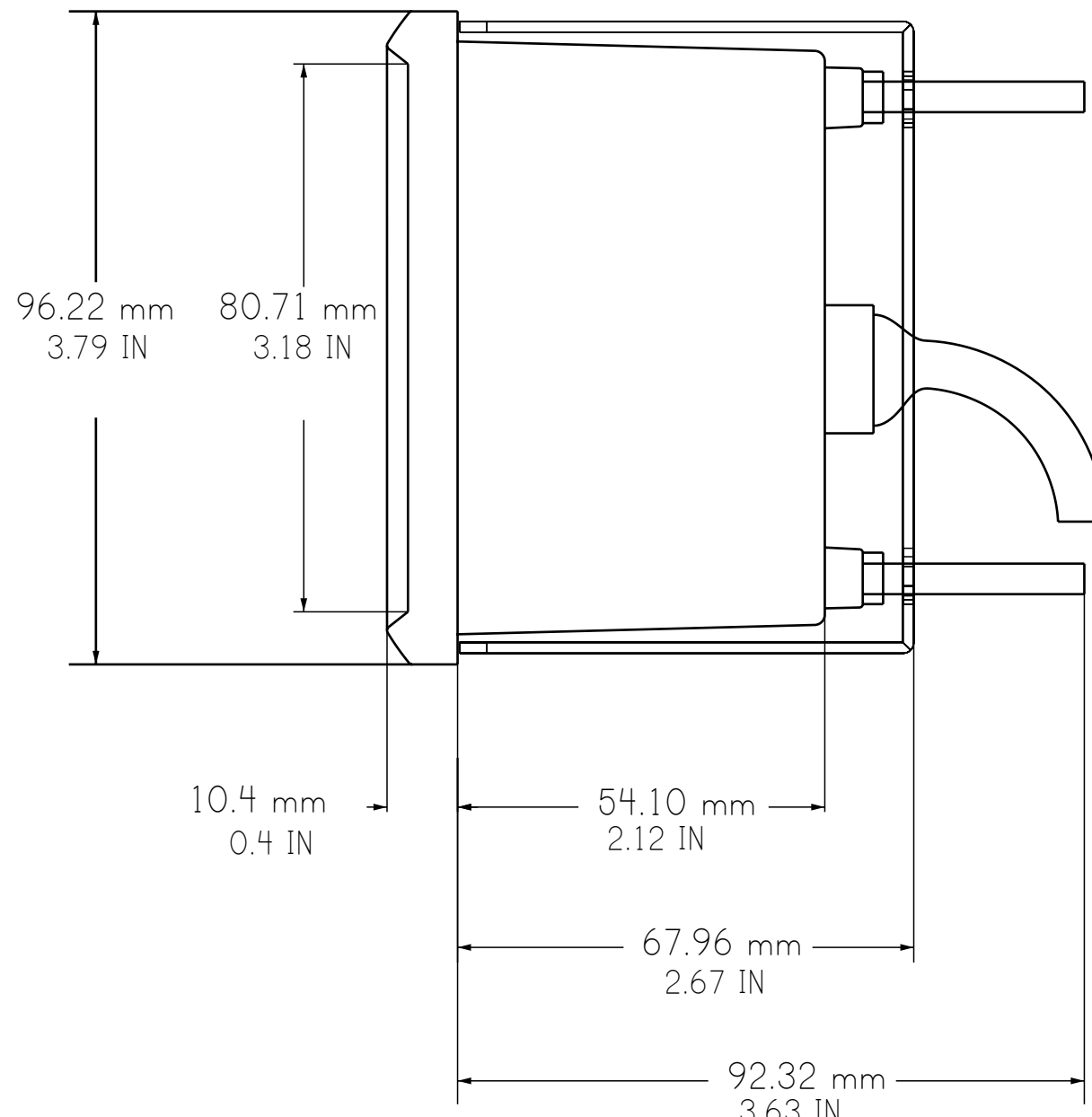

3-3/8" GAUGES
 3-7/16" MOUNTING HOLE
 3-3/4" O.D.
 3-5/8" DEEP

NOTES:
 STAINLESS POLISHED OR FLAT BLACK ALUMINUM BEZELS AVAIL.
 DOMED OR FLAT GLASS AVAILABLE
 CASE MATERIAL: NYLON/POLYCARBONATE
 BACK CLAMP MATERIAL: ALUMINUM
 SEE INSTRUCTION BOOKLET FOR PIN-OUTS AND LIGHTING

ITEM	QTY.	SEE BOM			SEE ROUTER		
		MATERIAL	APP'D	CH'D	DR'N.	DESCRIPTION	TOLERANCE (UNLESS NOTED)
THIS DRAWING IS THE PROPERTY			XX	XX	JC		
THE INFORMATION CONTAINED IN THIS DRAWING IS CONFIDENTIAL.							
THIS DRAWING AND THE INFORMATION CONTAINED IN THIS DRAWING MAY NOT BE COPIED OR USED, IN WHOLE OR IN PART, WITHOUT THE PRIOR WRITTEN PERMISSION OF NEW VINTAGE. COPYRIGHT ALL RIGHTS RESERVED							
PART NAME		PHOENIX PLATFORM HARD OUTER DIMS			1 PLACE ±.010 IN		
FILE NAME		PHOENIX-DIMS.PDF			2 PLACE ±.008 IN		
SCALE		DATE			3 PLACE ±.002 IN		
1:1 (100%)		03/22/2018			ANGULAR: GEOMETRY ±0.5° AND CHAMFER/COUNTERSINK ±1°		
HARDNESS		PAPER SIZE		REV.		SHEET NO.	
AS SUPPLIED		A		A		1 OF 1	

Looking for dependable gauges and dashboards? Rely on NVU for quality and long-lasting products.