

# Installation Guide

## Rear Trailing Arm - Front Bush

Suits: VW Golf MkV , Passat B6

(Always refer to the current catalogue for complete application listing)

- N.B.:** - This installation guide should be used in conjunction with the workshop manual.
- All fastener torque settings to be adhered to.
  - It is recommended that a wheel alignment is carried out after fitment.

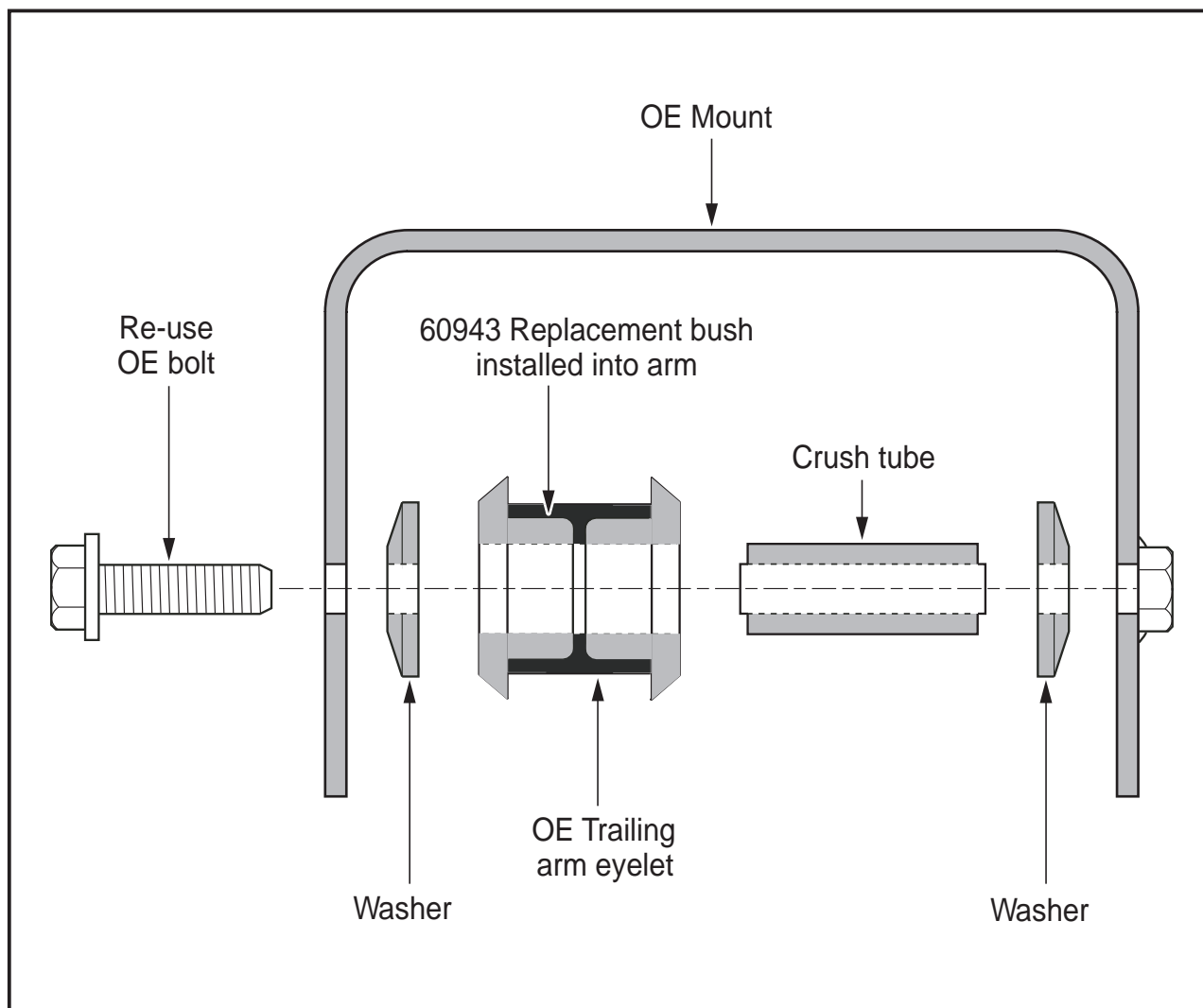

- N.B.:** - It is recommended that a licenced workshop or trades person carry out the above procedure and that workshop manual and relevant safety procedures are followed in addition to the above.