

Installation Guide Front Upper Innere

Z 5166

Suits: Mazda 6 (02-06)

(Always refer to the current catalogue for complete application listings)

N.B: This installation guide should be used in conjunction with the workshop manual.

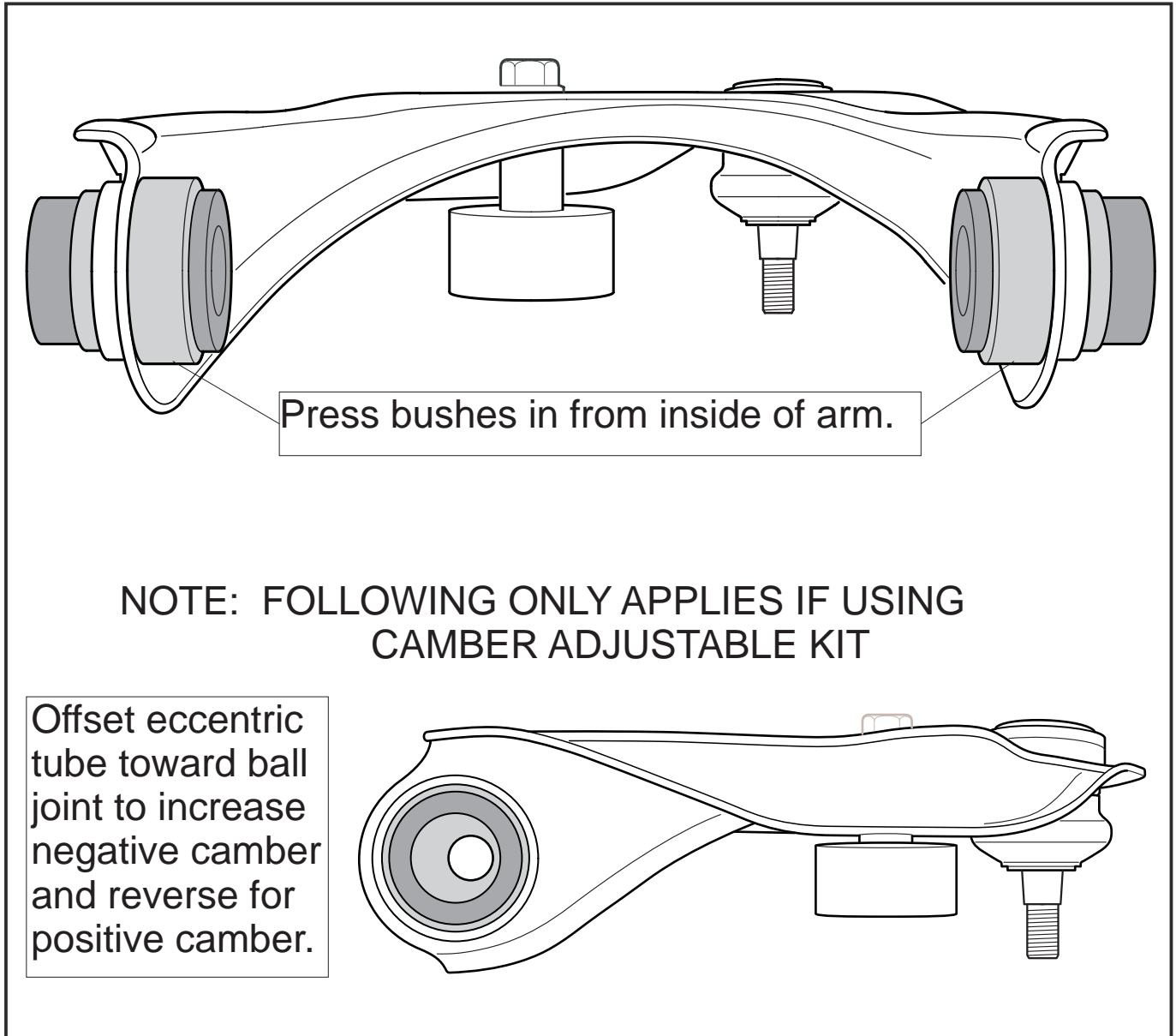

- Remove OE bushes from arm using hydraulic press
- Press replacement bushes in to shoulder from inside of arm
- Grease I.D. and flanges of bush, insert crushtube
- CAMBER OFFSET, Position of
for max neg camber and away from balljoint for max pos camber.

N.B: It is recommended that a licenced workshop or trades person carry out the above procedure and that workshop manual and relevant safety procedures are followed in addition to the above.