



I-SHEET NUMBER: INST-00041  
 PART NUMBER: C07-RCTX, C14-RCTX  
 PRODUCT: **Growler Running Board**  
 APPLICATION: **2007-2018 CHEVY/GM  
 REGULAR CAB**

HARDWARE DESCRIPTION		QTY.
<b>HWKT-00216X</b>		
CLIP-00643	M8-1.25 X 20MM BARREL U-NUT CLIP	4
HHCS-00647	M8-1.25 X 25MM CLASS 8.8 HEX CAP SCREW	8
FLHB-00688	3/8"-16 X 1" GRADE 5 HEX SERRATED FLANGE BOLT	10
HXNT-00708	M8-1.25 CLASS 8 FINISHED HEX NUT	4
FDRW-00736	M8 FENDER WASHER	12



PARTS INCLUDED	QTY
Running Boards	2
Rocker Panel mounting Brackets	4
Threaded clamp plates	4

# **GROWLER**

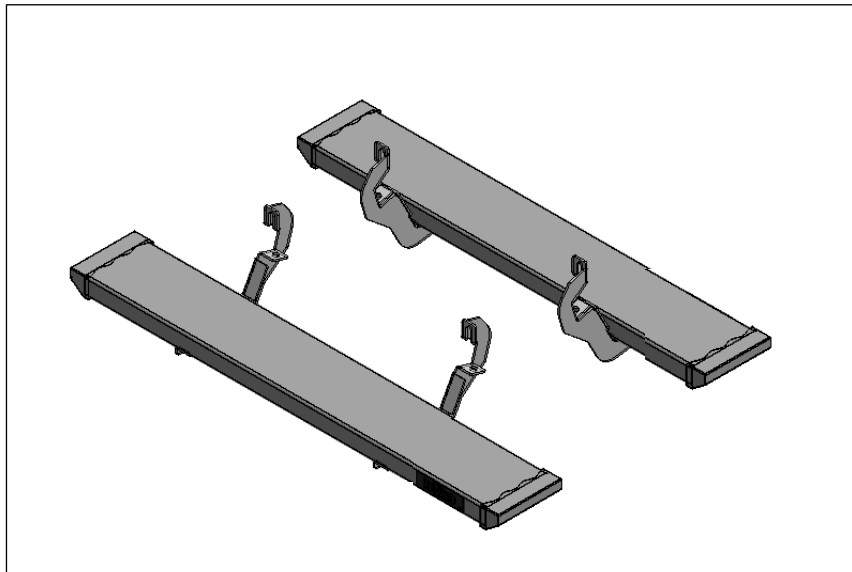

**Step 1:** Look on the underside of the body and locate the factory supplied mounting positions. **NOTE:** Some vehicles require the use of speed clips and nuts, which are supplied with the hardware kit.

**Step 2:** If your vehicle requires the use of the speed clips, install at this time. This requires the removal of a plastic body plug. Using a flat head screwdriver remove the plug and install one of the supplied speed clips.



**Step 3:** Install the brackets to the mounting locations in the body of the vehicle and install hardware. Do not tighten all the way.

**NOTE:** Some vehicles may require the use of additional nuts and washers for the lower portion of the mounting bracket which are supplied in the hardware kit

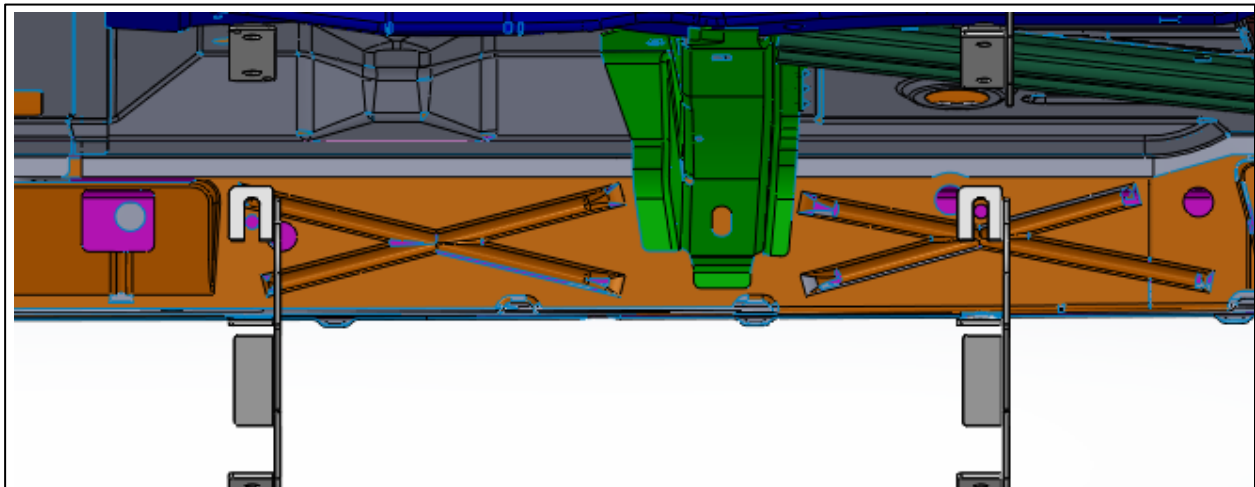



I-SHEET NUMBER: INST-00041  
PART NUMBER: C07-RCTX, C14-RCTX  
PRODUCT: **Growler Running Board**  
APPLICATION: **2007-2018 CHEVY/GM  
REGULAR CAB**

**Step 4:** Set running board along the top of both brackets and center along the cab.

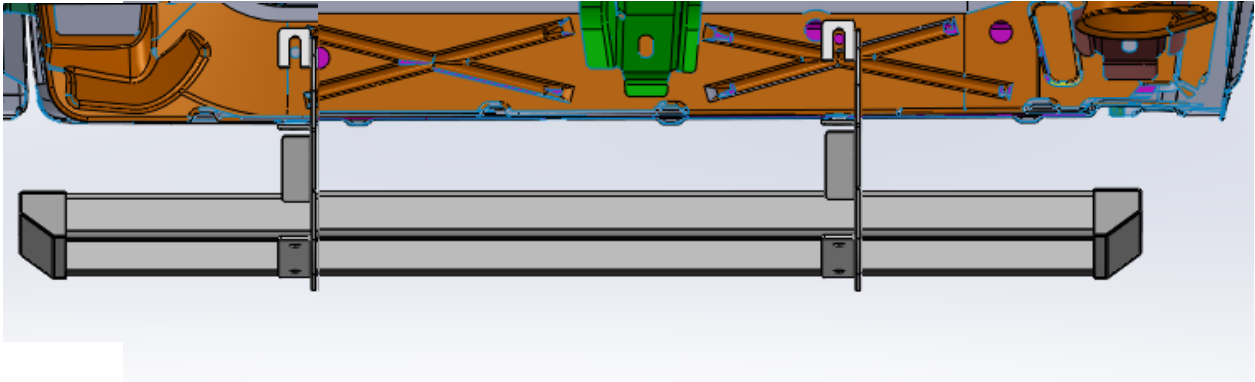

**Step 5:** Insert the supplied threaded brackets (x2) inside the running board lip over the top of each bracket.

**Step 6:** With the supplied 3/8" x 1" hex bolts, secure each mounting location and leave loose.

**Step 7:** After final adjustment, tighten all running board threaded mounts.

**Step 8:** Next, adjust frame brackets so the running board is level with body of the vehicle and tighten all factory-mounting locations.

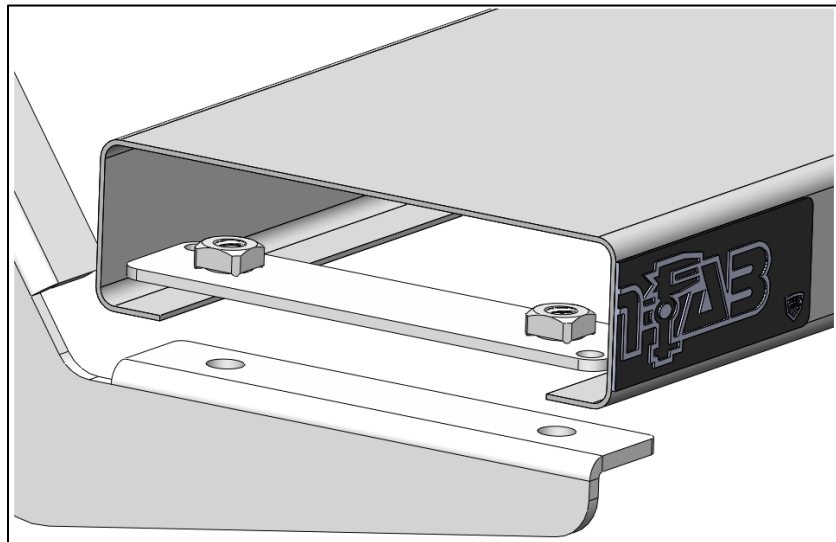

**Step 9:** Re-peat steps 2-8 for passenger side.