

MSS INSTALL GUIDE

Supplied for the BMW X6 (F16)



MSS Ltd.
MSS House
A3 Albion Daedalus Park
Daedalus Drive
Lee-on-the-solent
Gosport
Hampshire
PO13 9FX, UK



MSS Ltd.
MSS House
A3 Albion Daedalus Park
Daedalus Drive
Lee-on-the-solent
Gosport
Hampshire
PO13 9FX, UK

FRONT PARTS LIST

FRONT AXLE INSTALL PARTS LIST

Find these parts in the sections of the box numbered below.
Before you start installing your new MSS Kit, check if all parts listed below have been supplied:

BOX SECTION 2/3/4/5

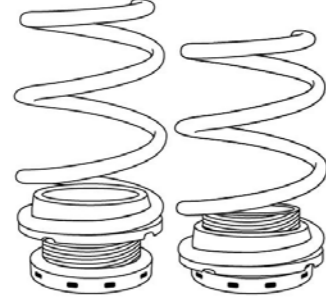

2X LARGE DIAMETER MSS ORANGE SPRINGS
- These fit the large adjusters

BOX SECTION 1

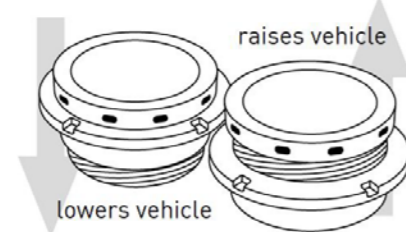

2X LARGE ADJUSTERS
- these are the larger of the two sets

BOX SECTION 2/3/4/5



2X MSS SUPPLIED LARGE FLAT RUBBER SLIP MATS
- to eliminate resonant road noise travelling through the system

BOX SECTION 1



2X OPTIONAL: SMALL PROTECTIVE SLEEVES
- these fit around the combined adjusters

BOX SECTION 5

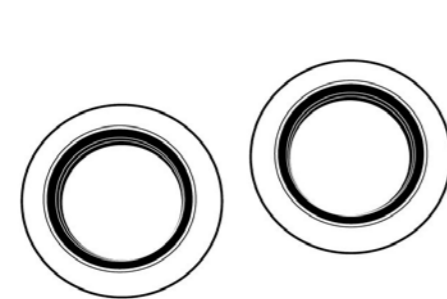

2X OE BEARING PARTS
- these must replace the ones removed

ASSEMBLED VIEW



FRONT AXLE INSTALL PROCEDURE

MSS 2x Orange Spring

MSS 2x Large Adjusters

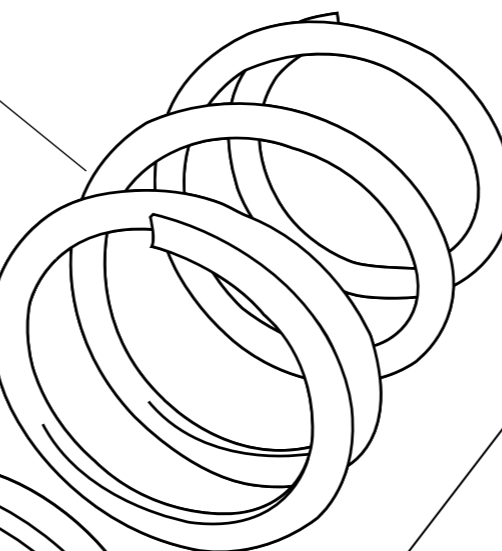

TOP

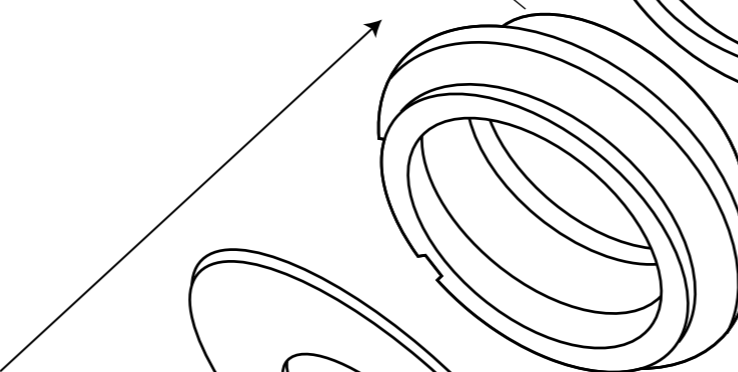

MSS 2x Supplied Large Flat Rubber Slip Mats

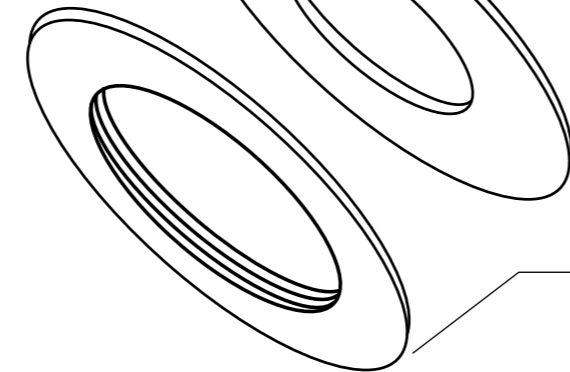

MSS 2x OE Bearing Parts

BOTTOM

FRONT INSTALLATION STEPS

DIFFICULTY LEVEL: Medium

ESTIMATED TIME: 30 to 45 minutes per side, assuming the bolts are not seized.
INSTALLING YOUR NEW MSS KIT IS BEST UNDERTAKEN BY AN EXPERIENCED BMW WORKSHOP/ENGINEER.

1. Remove the O.E. springs. These will be replaced by the MSS system supplied.
2. Remove and Retain the O.E. rubber dust boots these will be re-used.
3. Remove and Retain the O.E. bump stop. These will be re-used.
4. Remove but Retain the plastic O.E. dust cap.
5. Remove the lower O.E. spring mount and replace with MSS bearing.
(These are a tight fit in the base)
6. Then fit the MSS large flat slip mat on the bearing plate.
7. Place the MSS large Single Thread adjuster on top of the slip mat.
8. Refit the O.E. Plastic Dust cap in the centre of the Adjuster.
9. Refit O.E. dust boot & bump stop.
10. Next fit large orange spring on to adjuster seat.
11. Make Necessary changes to adjuster for desired ride height (See Below)
12. Fit the MSS protective sleeves over the adjuster and for dust protection.
13. Use a spring compressor to reduce spring height and help secure the arrangement.
14. Tighten to the correct torque with appropriate tools used to remove the camber plate.

POST-INSTALL STEPS

Complete a 1-mile journey before setting the ride height and 4-wheel alignment. Refer to pages 3 and 4 of the latest versions of the 'MSS INFO for Installer' guide for assistance on how to measure ride height. This is a **KEY** step.

NOTE: The rear axle ride height should be set to at least 5mm higher than the front axle ride height when measured as per page 3 of the latest version of the 'MSS INFO for Installer' guide. This is a **KEY** step.

BMW X6 (F16) TORQUE SETTINGS - FRONT

Droplink Nut 100 Nm / Camber plate bolts 28 Nm
Damper rod nut 165 Nm + 90° / Pinch bolt 42 Nm + 90°
Top wishbone nut 56 Nm

OEM WHEEL BOLT 140 NM