

MSD **IGNITION** **INSTALLATION INSTRUCTIONS**

MSD Distributor Reluctor with Advance for EFI **PN 8627**

Parts Included:

- 1 - Reluctor
- 1 - Roll Pin
- 1 - Snap Ring

Note: The installation of this Reluctor requires a press. Care must be taken when disassembling the distributor and upon the assembly.

The EFI Reluctor is designed to provide an advanced ignition trigger signal to an ECU. This enables the ECU to control the ignition timing, and positions the rotor so its tip is leading into the distributor cap terminal.

There are three positions that the reluctor can be installed in. Standard, or 10° advanced for clockwise or counterclockwise rotation engines. Figure 1 shows the roll pin locations.

1. Disassemble the distributor by removing the gear and the shaft and pull the shaft from the housing.
2. Slide the reluctor/advance assembly off the shaft.
3. Remove the snap ring from below the reluctor (Figure 2).
4. Using a piece of round stock or a punch (.625"), carefully press the advance assembly from the reluctor.
5. Position the new reluctor in the desired advanced location. Support the advance assembly in the center to prevent damaging the weight pins. Carefully press the new reluctor onto the advance assembly. Be sure to keep the pin slot aligned!
6. Press, or gently tap the new dowel pin into the pin slot.
7. Install the snap ring making sure it snaps into the groove on the housing.
8. Reinstall the assembly to the shaft and assemble the distributor.

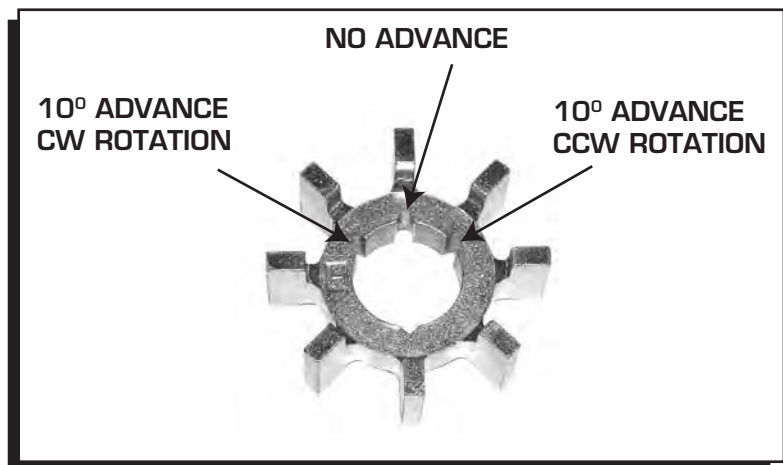

Figure 1 Reluctor Assembly Locations.

A PRESS MUST BE USED WHEN INSTALLING THE RELUCTOR. USING A HAMMER COULD RESULT IN DAMAGE TO THE RELUCTOR OR SHAFT BUSHING.

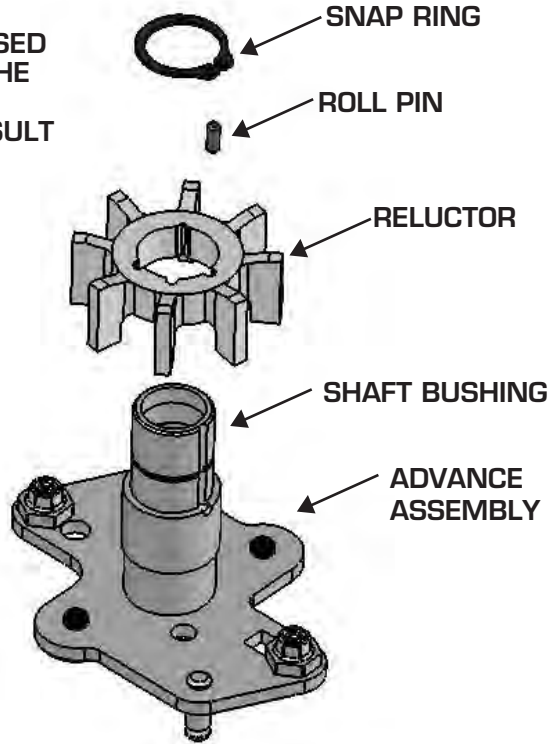

Figure 2 Reluctor Assembly.