

MSD IGNITION INSTALLATION INSTRUCTIONS

MSD Launch Control PN 8735

IMPORTANT: Read these instructions completely before attempting the installation.

Parts Included:

- 1 - Launch Control
- 4 - Mounting Screws

WARNING: During installation, disconnect the battery cables. When disconnecting the battery, always remove the Negative cable first and install it last.

The MSD Launch Control allows you to select three different rpm limits. Two limits, the race and burnout, are adjusted with plug-in modules. The launch (or holeshoot) limit is adjusted with the two rotary switches (Figure 1).

The launch and burnout limits are activated when 12 volts are supplied to their corresponding activation wires. When neither limit is activated, the overrev limit is active.

It is recommended to mount the Launch Control within easy reach of the driver so last minute adjustments can be made to the launch rpm setting. Also, make sure the wiring reaches the MSD Ignition. Mark the location of the mounting holes, then drill the holes using an 1/8" bit. Use the supplied mounting screws to secure the Control.

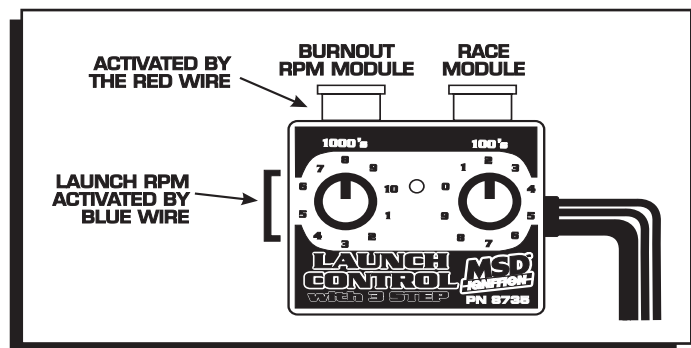

Figure 1 Module Controls and Adjustments.

WIRE FUNCTIONS

ACTIVATION WIRES	
BLUE	Launch Module Activation Wire. When 12 volts are applied, the launch circuit is activated. Note: This circuit overrides the other modules.
RED	Burnout Activation Wire. When 12 volts are applied, this module (Burnout) is activated.
2-PIN MODULE HARNESS	
BARE WIRE	Connect to Ground on the MSD Ignition.
RED	Connects to Switched 12 volts, such as the IGN terminal on MSD 7 Series.
2-PIN	This connector plugs into the rpm module socket of an MSD Ignition or Rev Control. Note: The Control will only operate when this is installed one way. It is correct when the LED on the Control lights when the ignition is turned On. If the LED does not come on, turn the 2-Pin connector around and try again.

MSD IGNITION INSTALLATION INSTRUCTIONS

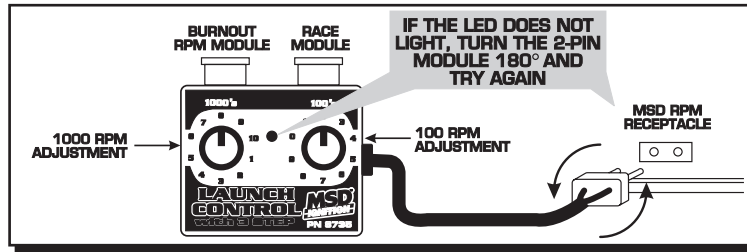

Figure 2 Connecting the 2-Pin Connector.

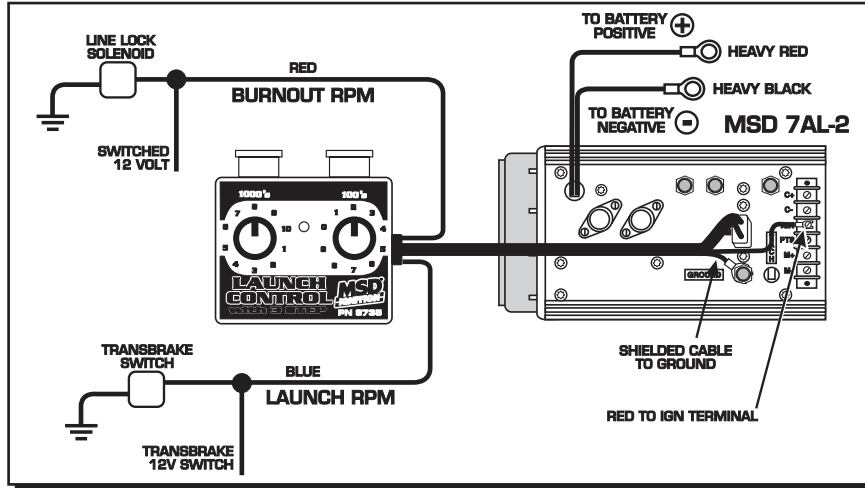

Figure 3 Wiring with an MSD 7 Series Ignition.