

MSD INSTALLATION INSTRUCTIONS

Flying Magnet Crank Trigger Kit Chevrolet Small Block Engine with 6¼" Damper PN 8600/86003

Important: Read the instructions before attempting the installation.

Parts Included:

1 - Bracket	1 - Locknut
1 - Trigger Wheel	2 - Bolts, 3/8" - 16 x 1.5"
1 - Pickup Mount	2 - Bolts, 5/16" - 18 x 1.25"
1 - Centering Ring	3 - Bolts, 3/8" - 24 x 1"
1 - Non Magnetic Pickup Assembly	2 - 5/16" Washers
1 - Mount Retainer	

Note: On some vehicles the MSD Crank Trigger Kit may require slight modifications to accommodate special engine plates, pulley systems, etc.

INSTALLING THE PICKUP AND BRACKET

1. Install the pickup mount onto the bracket using the two 5/16" bolts (Figure 1). The mount retainer will only install one way, do not try to force the bolts in. Hand tighten the bolts.
2. Install the bracket onto the engine. The bracket can only be mounted on the passenger side of the engine. Be sure to use the correct length bolts in the proper location.
3. Install the pickup into the holder followed by the locknut. Do not tighten the locknut at this time.

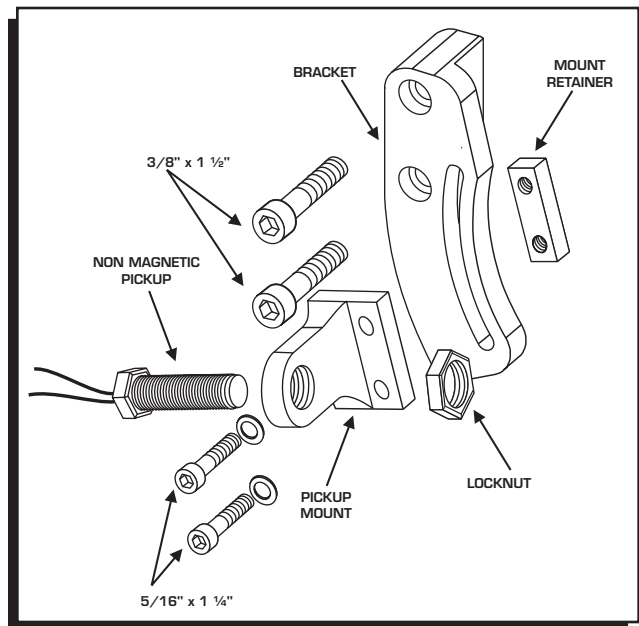

Figure 1 Pickup Bracket Assembly.

INSTALLING THE TRIGGER WHEEL

The trigger wheel is designed so it can be used on engines with a dry sump oiling system as well as stock dampers. Two centering rings are included; one for use on stock or most aftermarket dampers and one for use with a dry sump pump drive mandrel (Figure 2).

MSD INSTALLATION INSTRUCTIONS

Note: A centering ring must be used in all applications. Do not rely on the bolts to center the trigger wheel accurately.

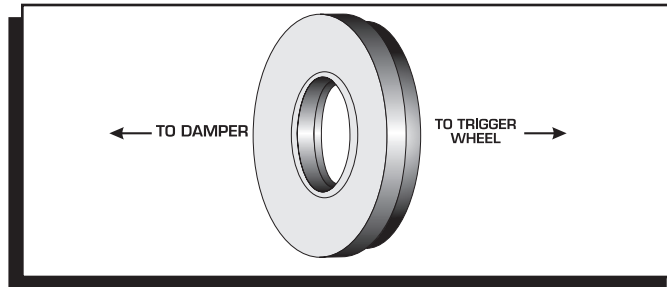

Figure 2 Centering Ring Installation.

1. Position the number one cylinder under compression at the desired total timing.
2. Install the trigger wheel centering ring onto the trigger wheel (Figure 2).
3. Position the trigger wheel onto the harmonic balancer and centering ring so one of the four magnets lines up with the center of the non-magnetic pickup. Make sure the wheel is mounted so it rotates in the direction of the arrow on the wheel. If necessary, slide the pickup in its mount until it properly lines up with the trigger wheel magnet.
4. Check and make sure the wheel is positioned correctly with the pickup and torque the trigger wheel bolts to 25 - 30 lb-ft. The pickup should be centered to the center line of the trigger wheel (Figure 3). If not, it may be necessary to add or delete shims to the pickup bracket to achieve the proper position.

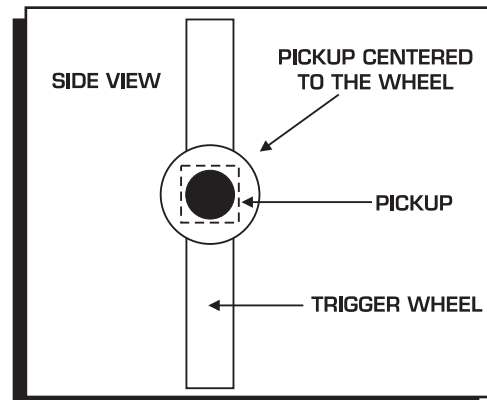

Figure 3 Pickup Centered on the Trigger Wheel.