



LS-1 [OIL PUMP](#)

Part 1 Relief Valve Spring Instructions

This pump is supplied with a High Pressure Relief Spring. If a lower pressure is desired, remove the red relief spring and replace it with enclosed blue spring.

Torque Valve Plug to 12Nm (106 inch lbs) min.

Note: Changing the relief spring will not change the idle pressure.

Part 2 O-Ring Instructions

This oil pump uses two different o-rings depending on the design of the pickup tube that installs to the pump. If the tube looks like (Fig 1) use the green O-ring. If the tube looks like (Fig 2) use the black O-ring.

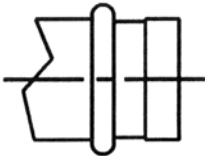

FIG 1

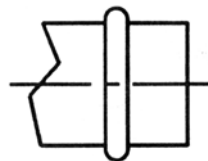

FIG 2