

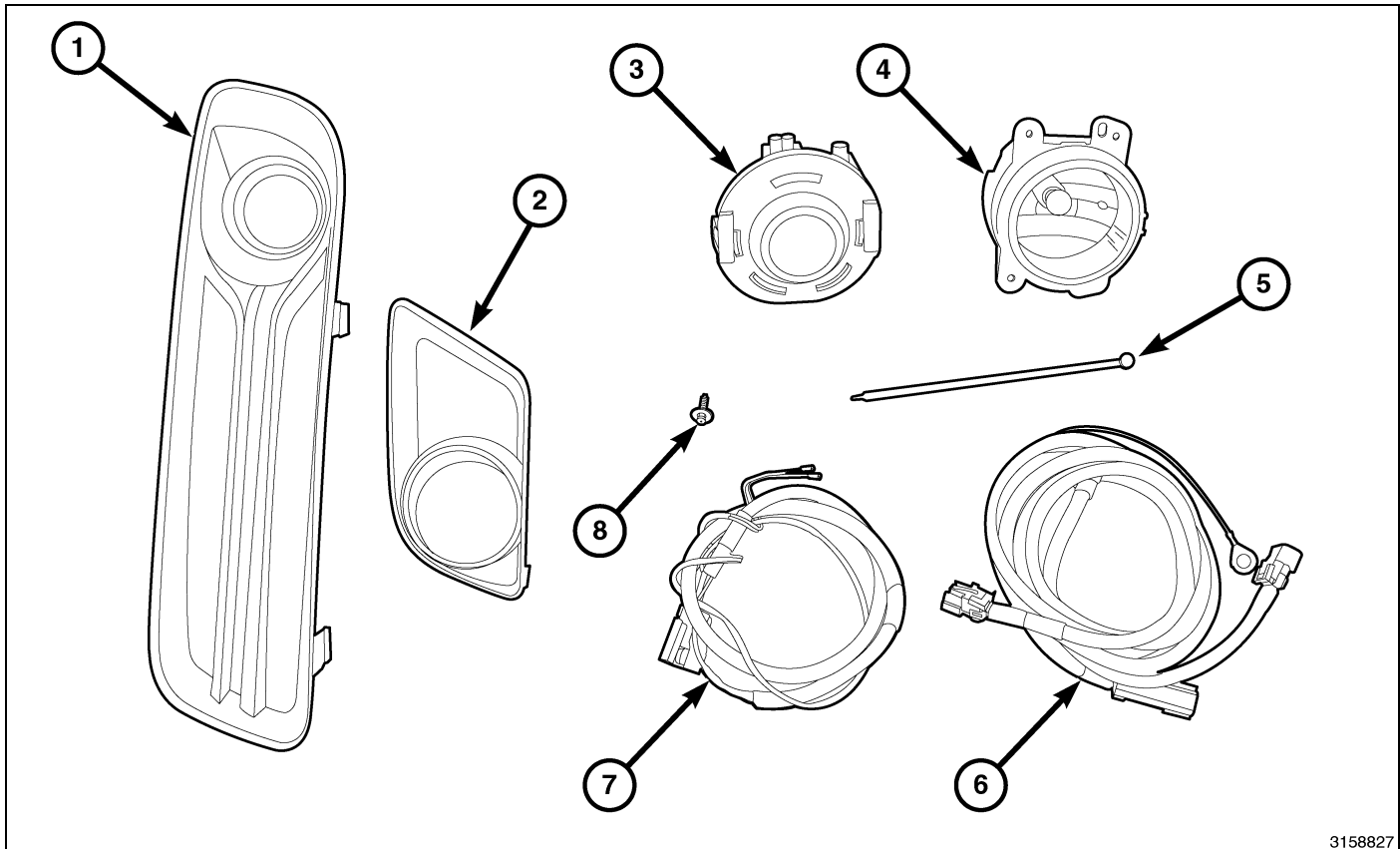

FOG LAMPS

DODGE/CHRYSLER



3158827

CALL OUT	DESCRIPTION	QUANTITY
1	Fog lamp bezel (Chrysler Kit Only)	2
2	Fog lamp bezel (Dodge Kit Only)	2
3	Fog Lamp Assembly (Chrysler Kit Only)	2
4	Fog Lamp Assembly (Dodge Kit Only)	2
5	Tie straps	12
6	Fog Lamp Harness	1
7	Fog Lamp to BCM Harness	1
8	Fog Lamp Retaining Bolts (Dodge Kit Only)	4

PROCEDURE STEPS:

NOTE: All views are Chrysler unless noted different, Dodge similar.

1. Disconnect the battery negative cable.
2. Remove the right side instrument panel end cap.
3. Remove the right side instrument panel silencer push in fasteners.
4. Disconnect the LED harness (1) and remove the right side instrument panel silencer (2).

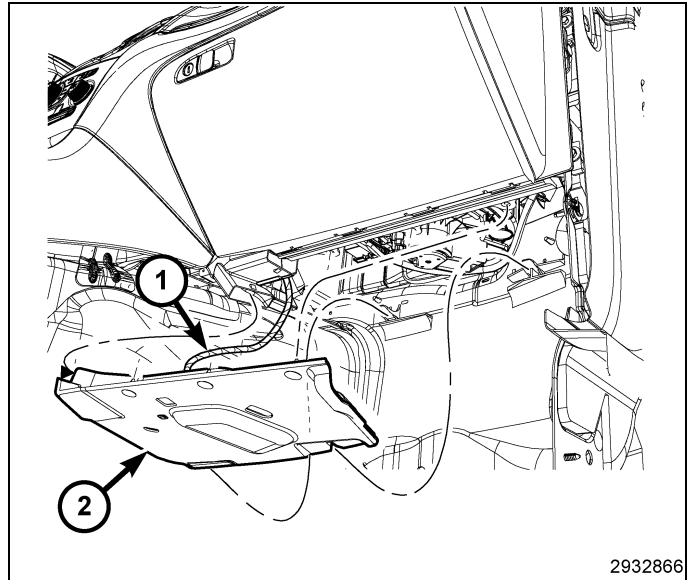

5. Open the glove box door (3).
6. Remove the two side screws (2) from the glove box compartment (1).
7. Remove the six screws from the front of the glove box compartment (1).
8. Using trim stick C-4755 or equivalent, pry out on the glove compartment (1) to disengage the retainer clips from the Instrument Panel (I/P).
9. Disconnect the wiring harness connector and junction block from the back of the glove box compartment (1) and remove from the vehicle.

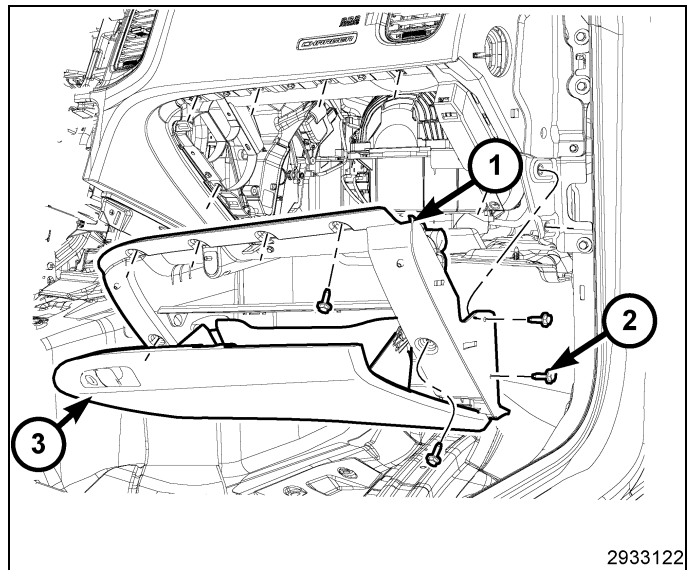

10. Place the headlamp switch (1) rotary knob (4) in the OFF (O) position.
11. Push in on the rotary knob (4) and rotate clockwise to retract the retainers (2) behind the I/P trim. The retainers (2) will be fully retracted before the switch points to the park lamps ON position.
12. Pull the switch out of I/P trim to access and disconnect the headlamp switch connector, and remove the headlamp switch.
13. Connect the headlamp switch connector to the new headlamp switch.
14. Position the new switch and press firmly and evenly into the I/P trim until it is fully seated. Two light audible clicks will indicate that the two retainers (2) have seated.

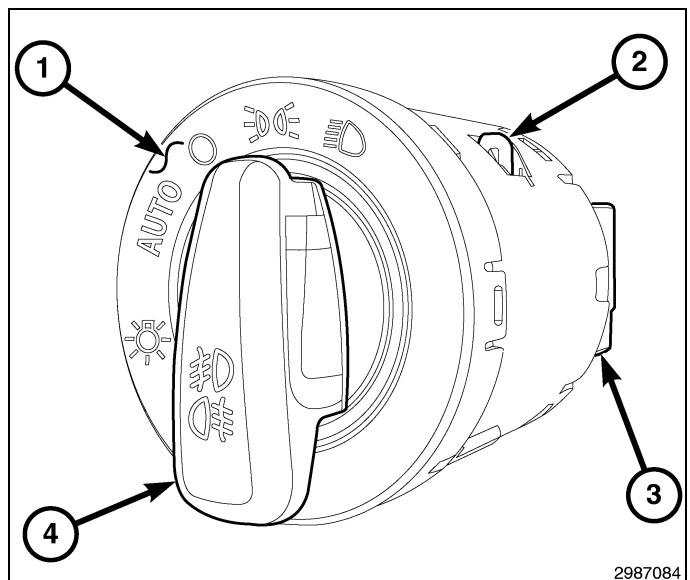

NOTE: The grommet is a double sided grommet with rubber inside the vehicle side and outside the vehicle. Be sure to pierce all the way through both sides. Be careful not to compromise the engine wiring harness while piercing the grommet.

15. From under the hood on the RH side of the cowl, carefully pierce the second rib (2) of the engine harness pass through grommet (1) and route the fog lamp to BCM harness (3) (loose wire end) into the passenger compartment.

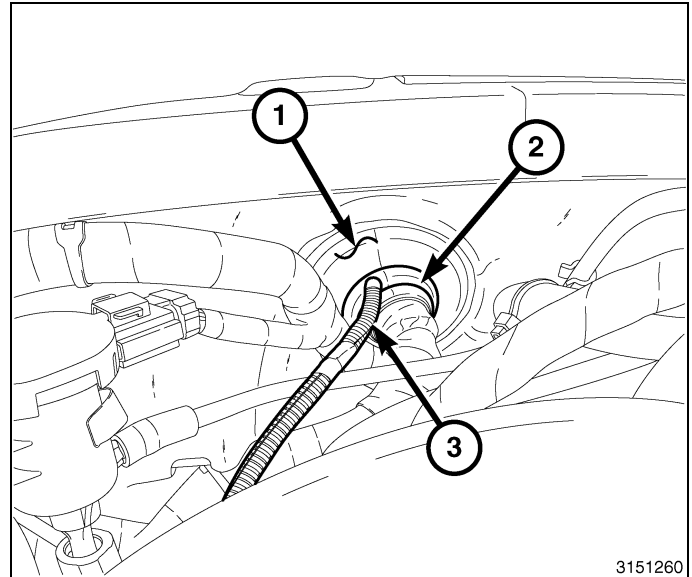

NOTE: Just prior to pulling the fog lamp to BCM harness (1) through the grommet, apply RTV sealant to the wiring harness $\frac{1}{4}$ inch before the conduit (in the engine compartment) to seal it.

16. From inside the passenger compartment, locate the fog lamp to BCM harness (1) and pull through to seat the harness conduit against the grommet in the engine compartment.
17. Route the fog lamp to BCM harness (1) toward the RH kick panel and secure with tie straps (3) as necessary.

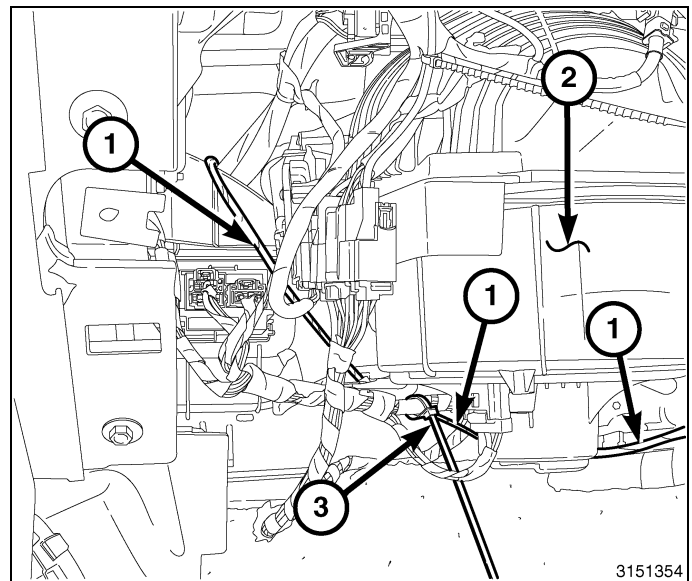

NOTE: The Body Control Module (BCM) (5) is located on the RH kick panel.

18. Disconnect BCM connectors A (1) and D (3) by pressing on the release lever lock tab (2), then swivel the release lever (4) and pull the connectors (1, 3) from the BCM (5).

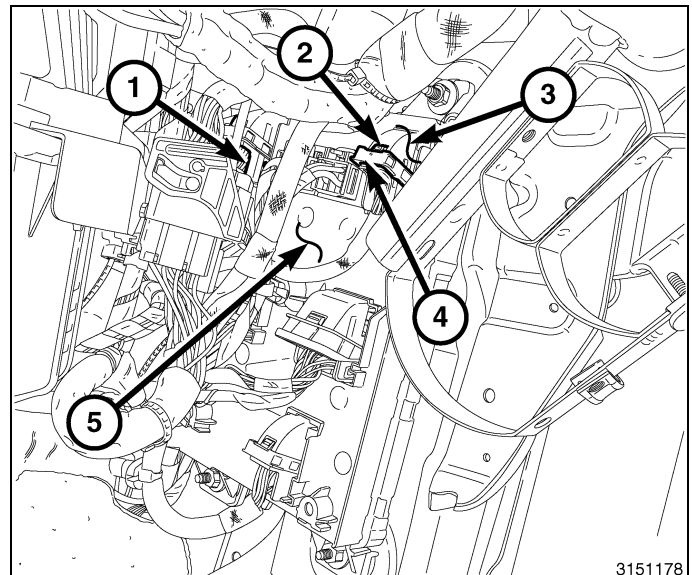

19. For both connectors A and D, using trim stick C-4755 or equivalent, carefully insert between connector cover latch (2) and the lock tab (3) to release, and slide the connector housing (1) off the connector.

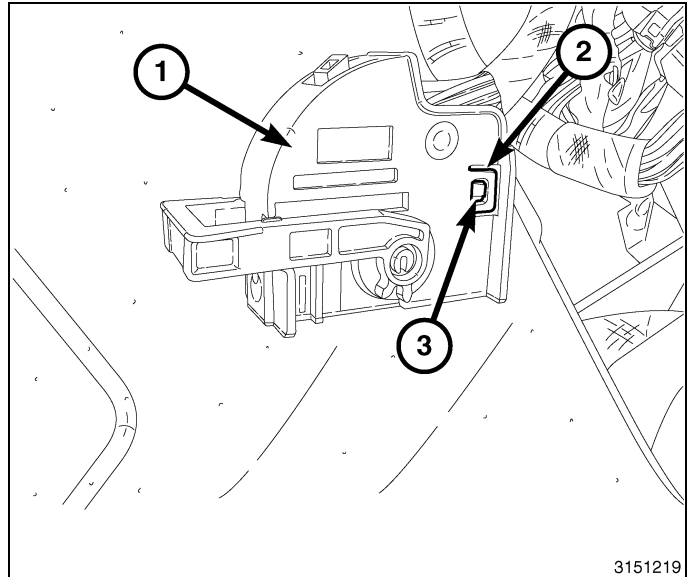

NOTE: The cavities in the BCM specified for the RH and LH fog lamp wires may be populated. If so, the existing wires must be removed to install the fog lamp kit wires.

20. Route the wires to the BCM connectors and insert the LH fog lamp power circuit WT/YE into connector A (1), cavity 1 (2). Install the connector cover and connect BCM connector A (1).

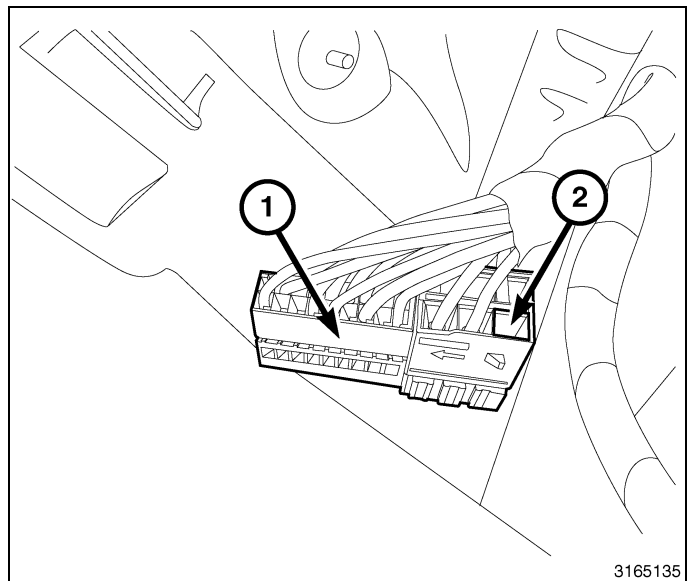

21. Insert the RH fog lamp power circuit WT/DB into connector D (2), cavity 13 (1). Install the connector cover and connect BCM connector D (2).

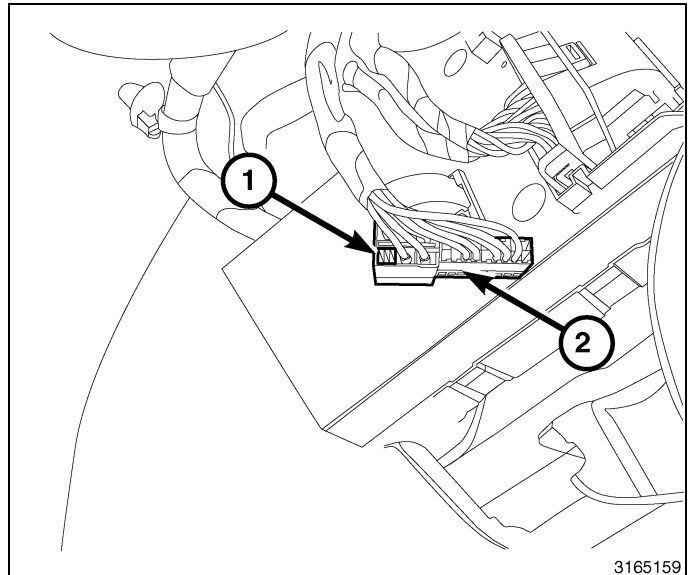

22. Raise and support the vehicle.
23. Remove the four push pin fasteners (1) that secure the LH side of the front belly pan (2). Repeat for the three push pin fasteners on the RH side.

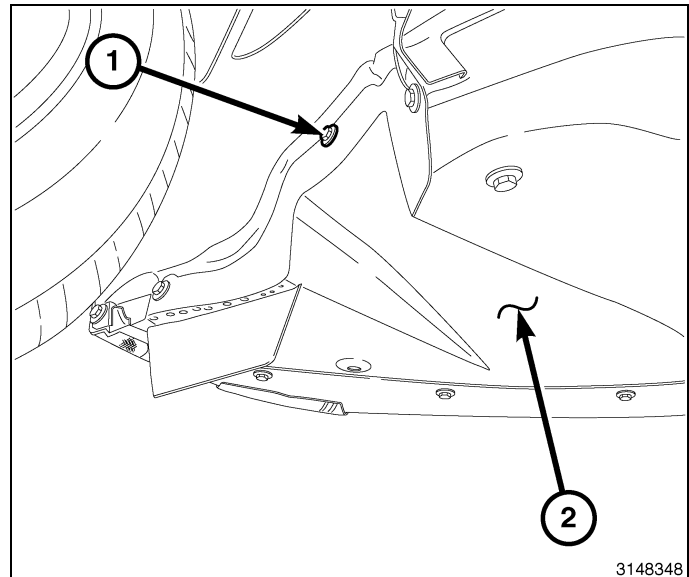

24. Remove the eight screws (2) that secure the front belly pan (1) to the fascia.
25. Remove the 2 bolts (4) that secure the front belly pan (1) (and rear belly pan) to the crossmember.
26. Remove the three push pin fasteners (3) and remove the front belly pan.

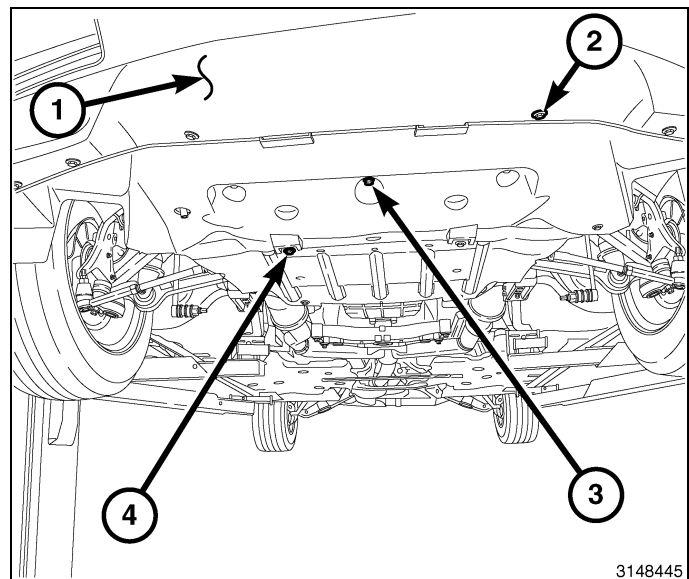

NOTE: The Dodge has only three tabs on the front bumper trim (fog lamp) bezels.

27. Remove both front bumper trim (fog lamp) bezels (1) by releasing the four tabs (2) and pulling from outside the bumper fascia.
28. Position the new fog lamp bezels and seat the retaining tabs by firmly pushing into the fascia. Make sure all tabs seat properly.

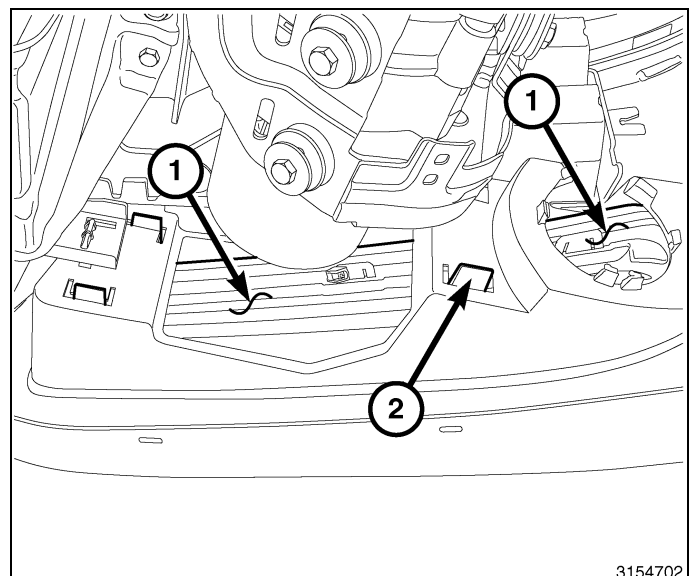

29. For Chrysler only, install the fog lamps from behind the bumper fascia by locating the five tabs to the slots (2) in the fog lamp housing (1) and firmly pressing into place. Make sure all tabs are fully seated.

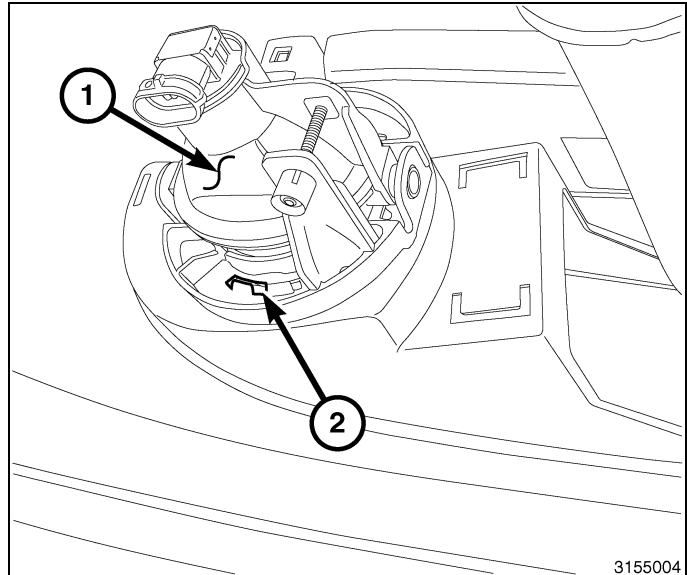

NOTE: If equipped, remove the screw retainer clips from the fascia before positioning the fog lamps.

30. For Dodge only, position the fog lamps from behind the bumper fascia and install the two screws through the fascia (from outside the fascia) directly across from each other.

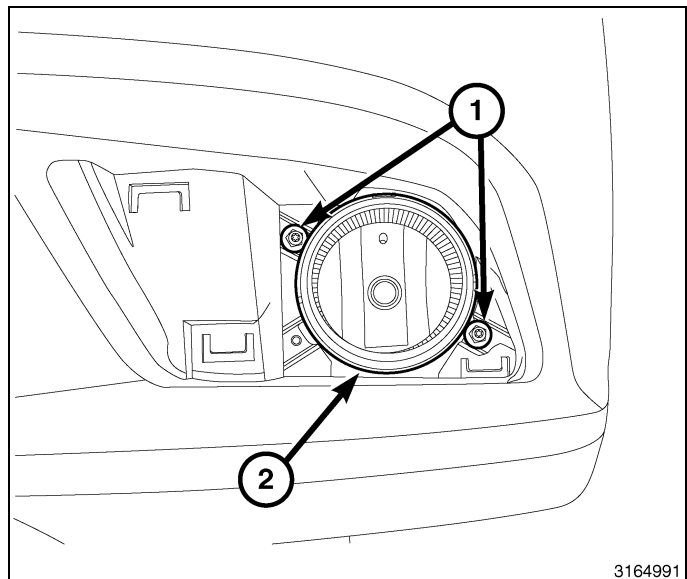

31. Route the RH side of the fog lamp harness (2) above the Electro-Hydraulic Power Steering (EHPS) pump (1) to the RH fog lamp and connect to the fog lamp.
32. Pass the fog lamp harness to BCM harness connector end (2) up inside the body for routing in the engine compartment (forward of Antilock Brake System (ABS) Module). Attach the harness to the body at this point using a tie strap (3), but leave tie strap (3) loose enough to pull wiring harness (2) slack out from above.

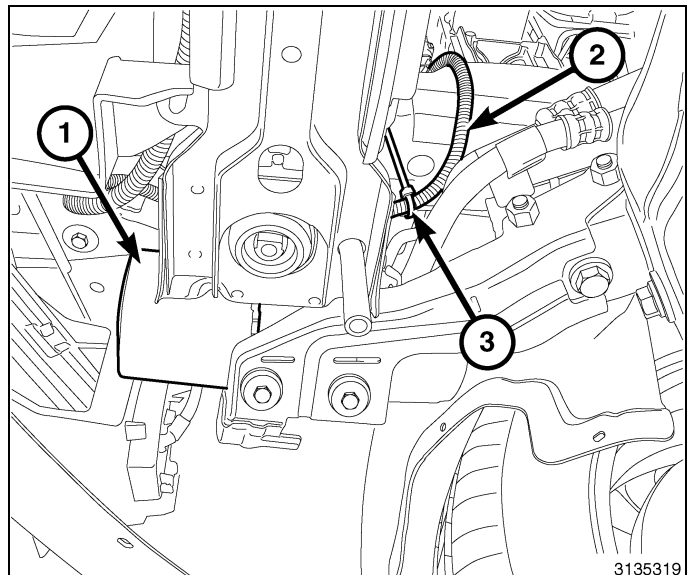

33. Route the LH side of the fog lamp harness (2) along the front of the lower radiator support (3) and connect to the LH fog lamp.
34. Attach the harness (2) using tie straps (1) as necessary.

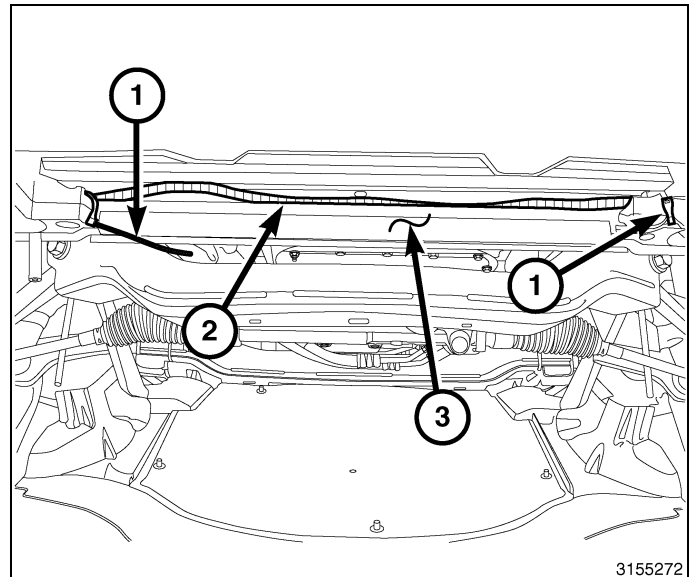

35. Under the hood in the engine compartment, and from in front of the ABS module (3), route the connector and ground wire (2) with the eyelet **under the ABS module (3)** and connect the fog lamp harness (4) to the fog lamp/BCM harness.
36. Remove the body ground nut (1), attach the ground wire (2) eyelet to the stud and install the nut (1).
37. Route the fog lamp harness (4) and fog lamp/BCM harness (4) with the engine harness and attach with tie straps (5) as necessary.

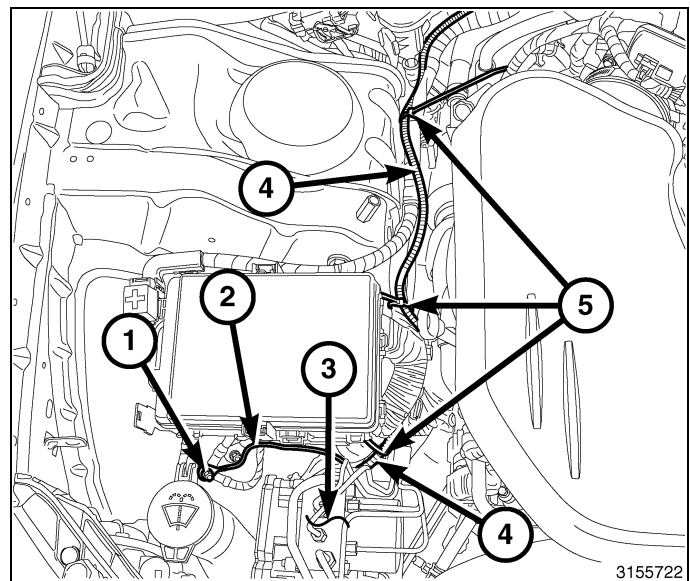

38. Connect the wiring harness connector and junction block to the back of the glove box compartment (1).
39. Position the glove compartment (1) and firmly push into place to seat the push in fasteners.
40. Install the two side screws (2) to the glove box compartment (1).
41. Install the six screws to the front of the glove box compartment (1).
42. Install the silencer.
43. Connect the battery negative (2) cable.

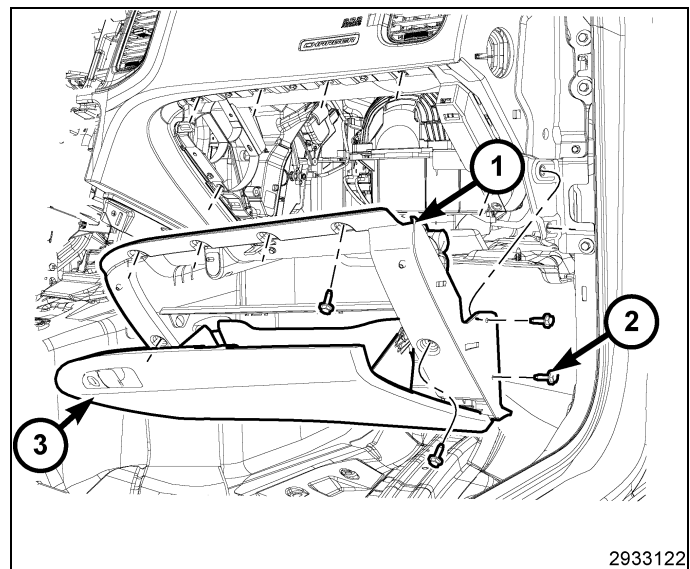

- b. In the "Vehicle Option" screen under the "Global Claims System" category in the "Service" tab, enter the vehicle VIN and add the sales code **LNJ (Fog Lamps)** as a "Dealer Installed Option".
- c. Confirm that the new sales code has been successfully added to the VIN.

NOTE: With the scan tool connected to both the internet (via Ethernet port or wireless connection) and the vehicle, follow the steps below:

- d. Using the scan tool select the **VEHICLE PREPARATION** and then select **RESTORE VEHICLE CONFIGURATION**.
 - e. Follow the step by step instructions on the scan tool to complete the Fog Lamps vehicle configuration.
45. **Set the fog lamp height** as follows:
- a. Place the vehicle on a level surface 25 feet from a wall or screen for viewing the fog lamp illumination height.
 - b. Turn on the ignition switch and the fog lamps.
 - c. Using the adjustment screw on the back of the fog lamps, adjust to 100 mm (4 in.) below the fog lamp centerline straight ahead of the lamp.
46. Raise and support the vehicle.
47. Position the splash shield and install the three push pin fasteners (3).
48. Install the eight screws (2) that secure the front belly pan (1) to the fascia.
49. Install the 2 bolts (4) that secure the front belly pan (1) (and rear belly pan) to the crossmember.

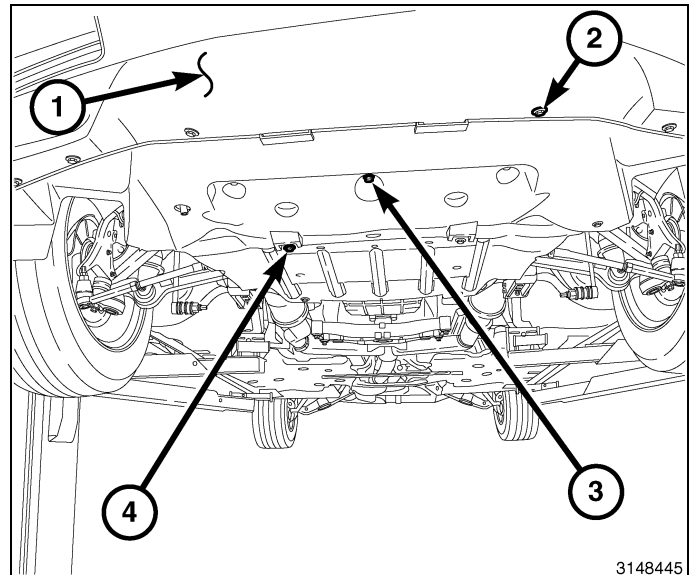

50. Install the four push pin fasteners (1) that secure the LH side of the front belly pan (2). Repeat for the three push pin fasteners on the RH side.
51. Verify the system operates correctly.

