



INSTALLATION GUIDE

**PERFORMANCE AIR INTAKE, FITS VOLKSWAGEN MK7
GOLF/GTI/R & AUDI A3/S3 2015+ | SKU: MMAI-MK7-15X**

TABLE OF CONTENTS

Pg 01 RESOURCES & CONTACT INFORMATION

Pg 02 EXPLODED DIAGRAM
PARTS BREAKDOWN

Pg 03 IMPORTANT SAFETY INFORMATION
TOOLS NEEDED
INSTALLATION TIME
INSTALLATION DIFFICULTY
INSTALLATION INSTRUCTIONS

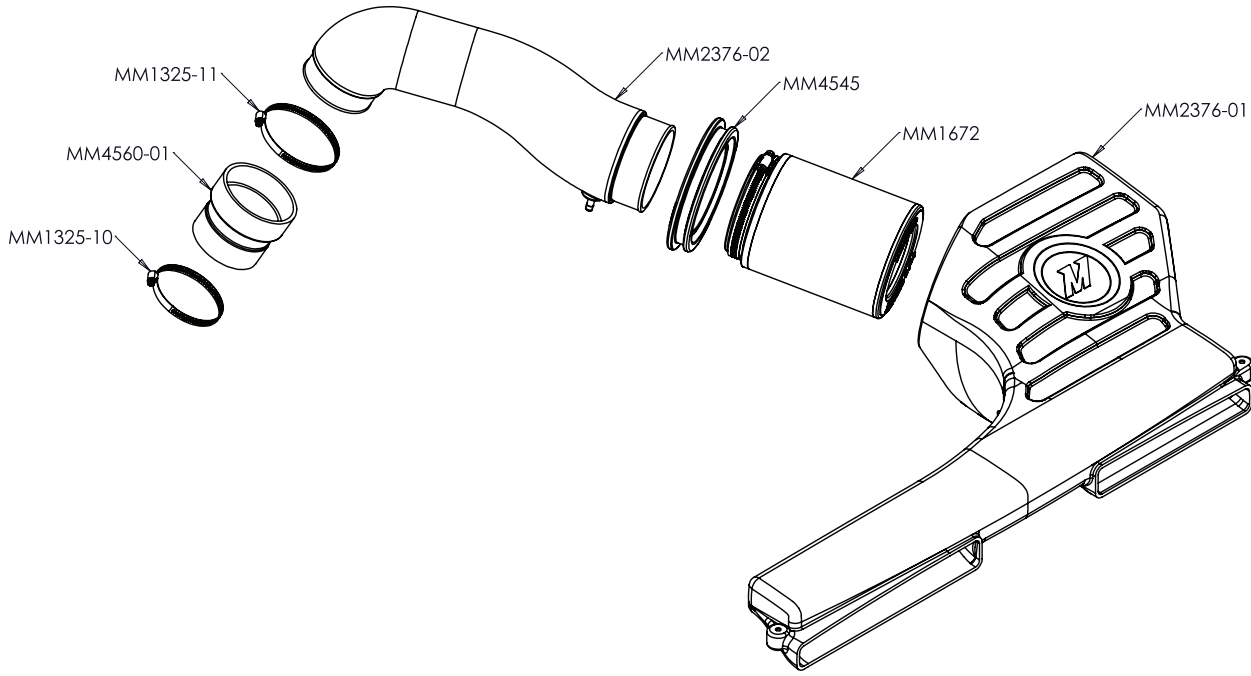

| PARTS BREAKDOWN | | |
|-----------------|---------------------------------|-----|
| PART NUMBER | DESCRIPTION | QTY |
| MM2376-01 | AIR BOX | 1 |
| MM2376-02 | INTAKE TUBE | 1 |
| MM79-09 | AIR FILTER 1 | 1 |
| MM1672 | AIR FILTER 2 | 1 |
| MM4545 | INTAKE TUBE GROMMET | 1 |
| MM4560-01 | COUPLER | 1 |
| MM1700-01 | SECONDARY AIR FILTER ADAPTER | 1 |
| MM1342-10 | RUBBER CAP | 1 |
| MM4572-01 | COOLANT HOSE | 1 |
| MM1325-2 | WORM GEAR CLAMP (12-20MM RANGE) | 2 |
| MM1325-10 | WORM GEAR CLAMP (60-80MM RANGE) | 1 |
| MM1325-11 | WORM GEAR CLAMP (70-90MM RANGE) | 1 |

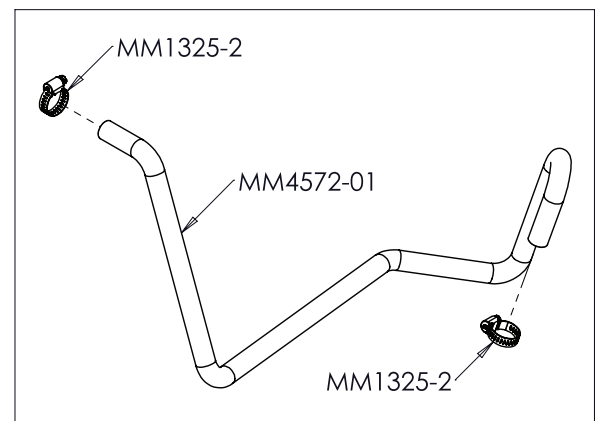
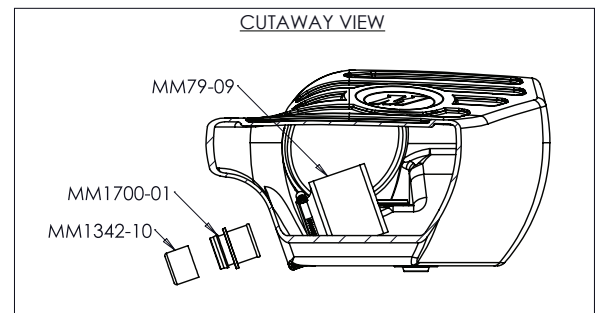

IMPORTANT SAFETY INFORMATION

- Mishimoto recommends you use safety glasses and protective gloves during the install of their products
- Raise vehicle only on jack stands or on a vehicle lift
- Allow vehicle to cool completely prior to attempting installation
- Do not run the engine or drive the vehicle while overheating; serious damage can occur
- Please dispose of any liquids properly
- Mishimoto is not responsible for any vehicle damage or personal injury due to installation errors, misuse, or removal of Mishimoto products

INSTALLATION TIME 1.5 HOURS

INSTALLATION DIFFICULTY 

TOOLS NEEDED

| | |
|--------------------------|-----------|
| 7MM SOCKET | PLIERS |
| 8MM SOCKET | DRAIN PAN |
| T25 TORX | FUNNEL |
| ¼" RATCHET AND EXTENSION | |

INSTALLATION INSTRUCTIONS

1. Drain the engine coolant.

The install can be completed without draining the engine coolant; however, this method will cause some coolant to spill into the engine bay

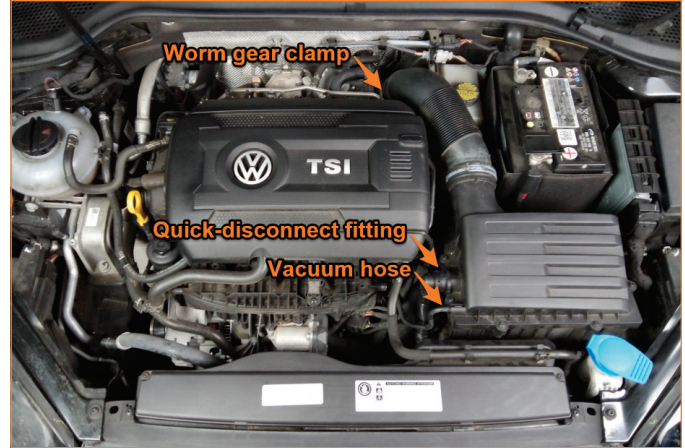

2. Remove the stock airbox and intake tube. (1x worm gear clamp, 1x vacuum hose, 1x quick-disconnect fitting)



3. Remove the stock air duct. (2x T25 torx screws)

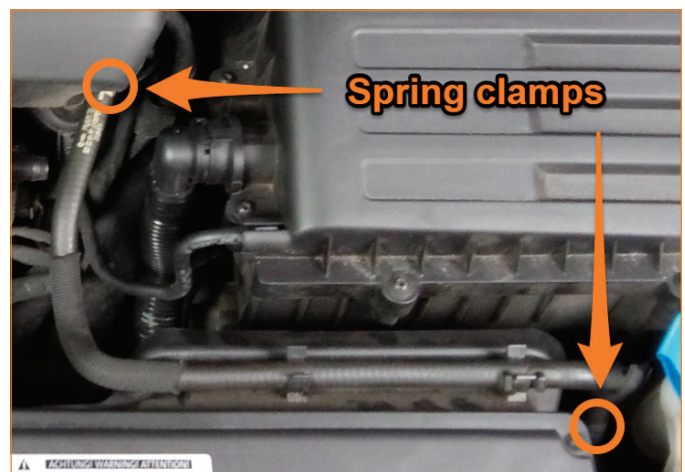

4. Remove the stock coolant hose from the driver's side of the radiator. (2x spring clamps)

CONTINUED ON FOLLOWING PAGE

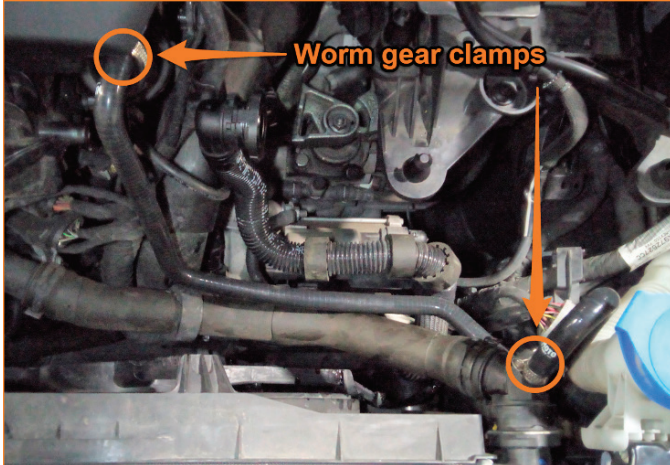

5. Install the Mishimoto coolant overflow hose using the provided clamps. (2x MM1325-2)



6. Install the secondary air injection system filter into the Mishimoto airbox. (1x MM79-09, 1x MM1700-01)

If the vehicle is not equipped with the secondary air injection system, place the provided MM1342-10 rubber cap over the MM1700-01 fitting.

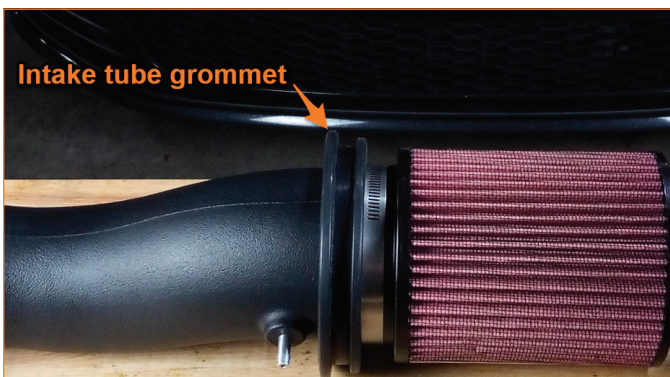

7. Slide the intake tube grommet over the intake tube, then install the air filter. (1x MM4545, 1x MM1672)



8. Install the coupler to the intake tube using the provided worm gear clamp. (1x MM1325-11)



9. Install the intake tube assembly into the airbox. Starting from one spot, push the intake tube grommet into the airbox cutout until it is fully seated.



10. Place the intake assembly into the engine bay and connect the vacuum hose and quick-disconnect fitting.

CONTINUED ON FOLLOWING PAGE



11. Secure the coupler to the turbo inlet pipe using the provided worm gear clamp. (1x MM1325-10)

12. Align the pre-installed grommets on the bottom of the airbox with the pegs in the engine bay, then push down on the airbox to secure it in place.



13. Secure the front of the airbox to the vehicle using the 2x T25 torx screws removed in step 2.

14. Refill and bleed the cooling system.

Congratulations! You have finished your installation.