



## Installation instructions for 99-5027

### APPLICATIONS

See application list inside

# Ford/Mazda multi-kit 1995-2011 99-5027/AW-586FT

### KIT FEATURES

- DIN radio provision with pocket
- ISO DIN radio provision with pocket
- DIN radio provision
- ISO DIN radio provision



### KIT COMPONENTS

- A) Radio housing
- B) Radio housing trim piece "A"
- C) Radio housing trim piece "B"
- D) ISO Brackets
- E) Rear support
- F) ISO Trim plate
- G) Mounting bracket
- H) (4) #8 x 3/8" Truss head Phillips screws

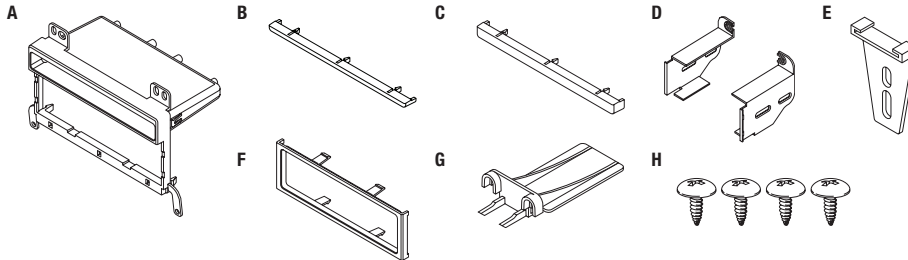

### WIRING & ANTENNA CONNECTIONS (sold separately)

#### Wiring Harness:

- 70-5519 - Ford amplified harness 1998-08
- 70-5520 - Ford harness 2003-up
- 70-5521 - Ford amplified harness 2003-up
- 70-1771 - Ford harness 1998-up

#### Antenna Adapter:

- Not required

### TOOLS REQUIRED

- Panel removal tool
- Phillips screwdriver
- Small flat blade screwdriver
- 86-5618 Ford radio removal keys

**CAUTION:** Metra recommends disconnecting the negative battery terminal before beginning any installation. All accessories, switches, and especially air bag indicator lights must be plugged in before reconnecting the battery or cycling the ignition.

**NOTE:** Refer to the instructions included with the aftermarket radio.

## Applications

### Ford

|  |           |
|--|-----------|
| Crown Victoria .....                   | 1995-2011 |
| Econoline .....                        | 1997-2008 |
| Expedition .....                       | 1997-2002 |
| Expedition ( <i>without NAV</i> )..... | 2003-2006 |
| Explorer .....                         | 1995-2001 |
| Explorer .....                         | 2002-2005 |
| F-150 .....                            | 1997-2004 |
| F-250 .....                            | 1999-2004 |
| F-350 .....                            | 1999-2004 |
| F-550 .....                            | 1999-2004 |
| Mustang .....                          | 2001-2004 |
| Ranger .....                           | 1995-2011 |
| Windstar .....                         | 1999-2003 |
| Excursion .....                        | 2000-2005 |

### Lincoln

|                                       |           |
|---------------------------------------|-----------|
| Aviator .....                         | 2003-2005 |
| Continental .....                     | 1995-1997 |
| Blackwood .....                       | 2001-2003 |
| Mark 8 .....                          | 1996-1998 |
| Town Car .....                        | 1995-2002 |
| Navigator .....                       | 1997-2002 |
| Navigator ( <i>without NAV</i> )..... | 2003-2006 |

### Mazda

|                       |           |
|-----------------------|-----------|
| B-Series Pickup ..... | 1995-2009 |
|-----------------------|-----------|

### Mercury

|                     |           |
|---------------------|-----------|
| Grand Marquis ..... | 1995-2010 |
| Mountaineer .....   | 1997-2001 |
| Mountaineer .....   | 2002-2005 |
| Marauder .....      | 2003-2004 |
| Mariner .....       | 2005-2007 |



## Dash Disassembly 99-5027

**Ford Crown Victoria 1995-2011/Econoline 1997-2008/Explorer 1995-2001/F-250 1999-2004/ F-350 1999-2004/F-550 1999-2004/Ranger 1995-2011, Lincoln Continental 1995-1997/Mark 8 1996-1998/Town Car 1995-2002, Mazda B-Series Pickup 1995-2009, Mercury Grand Marquis 1995-2010/Mountaineer 1997-2001/Marauder 2003-2004/Mariner 2005-2007**

1. Using Metra's 86-5618, pull the factory radio from the dash and disconnect the wiring. (Figure A)
2. Cut and remove the top mounting legs "A" and the bottom mounting legs "B" from the radio housing. (Figure B)

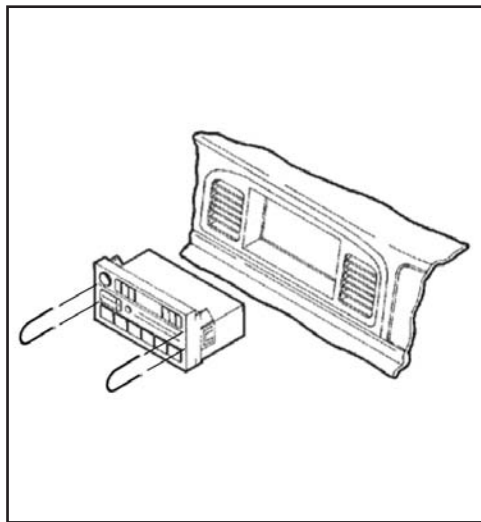

(Figure A)

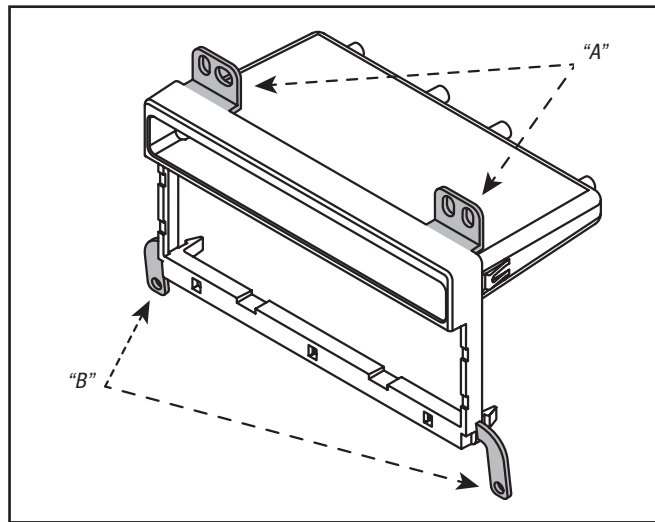

(Figure B)



## Dash Disassembly 99-5027

### Ford Expedition 1997-2002/F-150 1997-2004/ Excursion 2000-2005, Lincoln Blackwood 2001-2003/ Navigator 1997-2002

1. Place your index fingers on the inner edges of the A/C vents and push inward. Grasp the exposed lip of each vent opening and pull out on the radio trim bezel. Remove the dash trim bezel (airbag wiring does **not** need to be disconnected). (Figure A)

Using Metra's 86-5618, pull the factory radio from the dash and disconnect the wiring.

2. Cut and remove the top mounting legs "A" from the radio housing. (Figure B)

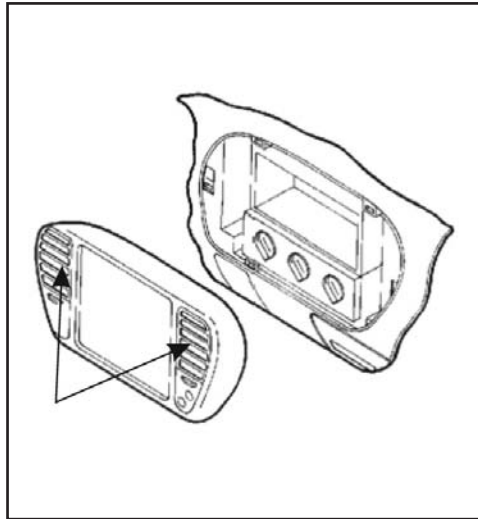

(Figure A)

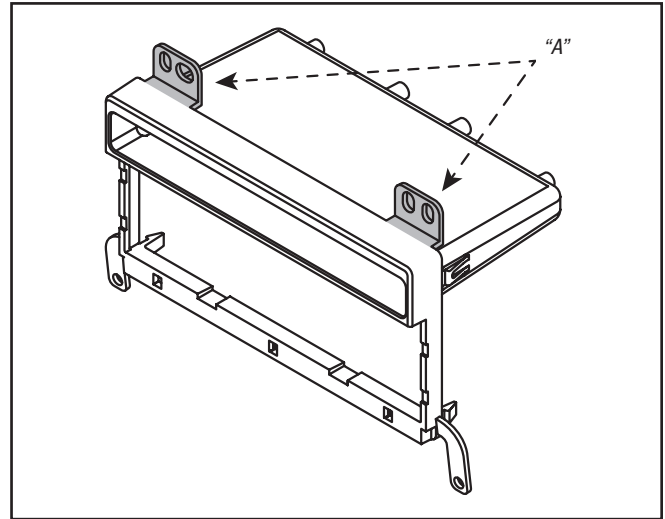

(Figure B)

**Ford Mustang  
2001-2004**

1. Unclip and remove shift lever trim panel. (Figure A)
2. Unclip and remove the entire panel surrounding the radio and climate controls including the vents. (Figure B)
3. Remove (2) 9/32" screws securing radio. (Figure B)

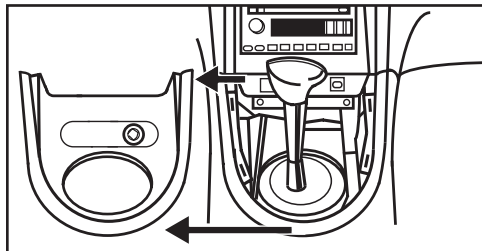
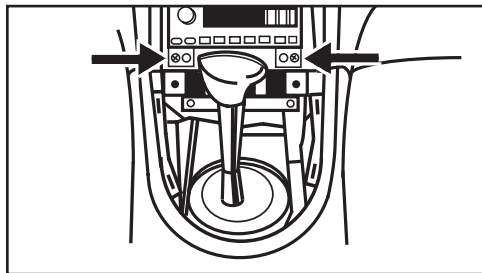
*(Figure A)**(Figure B)***Ford Expedition (without NAV)  
2003-2006**

1. Remove (2) 9/32" screws from above instrument cluster. (Figure A)
2. Unclip and remove entire panel surrounding radio, climate controls, and instrument cluster. (Figure B)
3. Remove (2) 9/32" screws securing radio. (Figure B)

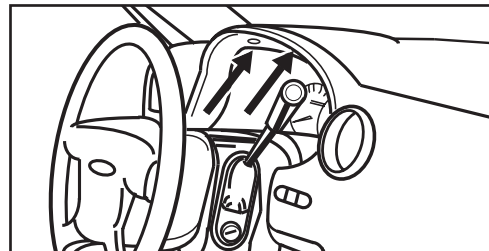
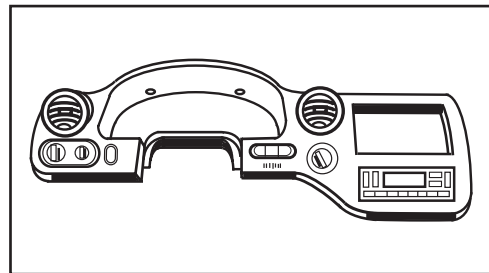
*(Figure A)**(Figure B)*

## Ford Explorer/Mercury Mountaineer 2002-2005

1. Unclip and remove entire panel surrounding radio including climate controls and vents. (Figure A)
2. Remove (2) 9/32" screws securing radio. (Figure B)

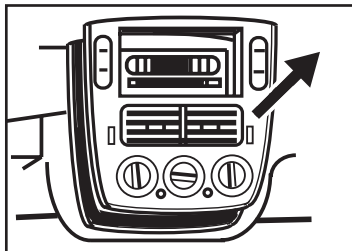

(Figure A)

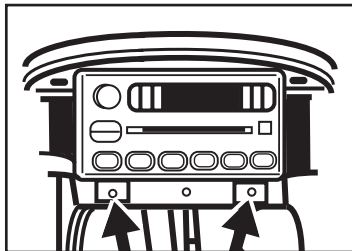

(Figure B)

## Lincoln Navigator (without NAV) 2003-2006

1. Open center console and remove (1) push pin from back of power window switch panel. (Figure A)
2. Unclip and remove panel.
3. Remove (2) 9/32" screws exposed on shifter panel then unclip and move shifter panel off to side. (Figure B, C)
4. Remove (2) 9/32" screws exposed under ashtray assembly. (Figure C)
5. Unclip and remove entire panel surrounding climate controls and radio.
6. Remove (2) 9/32" screws securing radio. (Figure C)

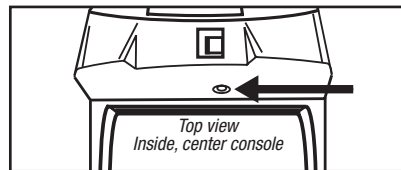

(Figure A)

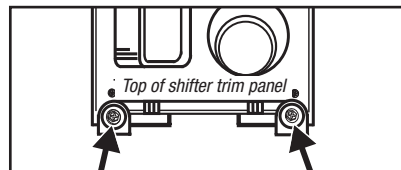

(Figure B)

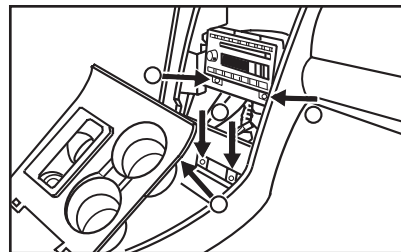

(Figure C)



## Dash Disassembly 99-5027

### Lincoln Aviator 2003-2005

1. Unclip and remove vent panel above radio on top of dashboard. (Figure A)
2. Remove (2) 9/32" screws exposed under panel removed in step 1. (Figure B)
3. Unclip and remove panel around radio with door in it. (Figure C)
4. Unclip and remove vents below radio. (Figure D)
5. Remove (2) 9/32" screws securing radio. (Figure E)

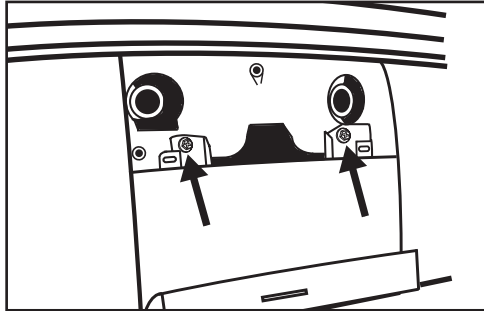

(Figure B)

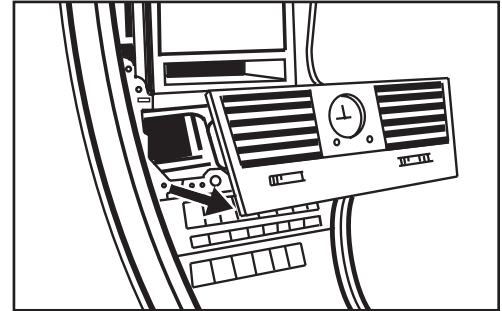

(Figure D)

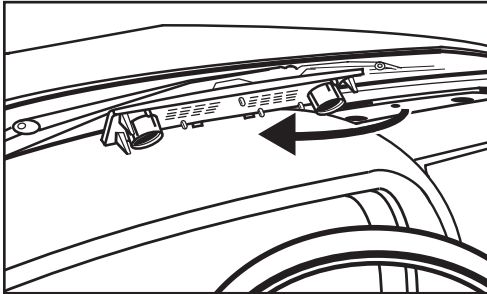

(Figure A)

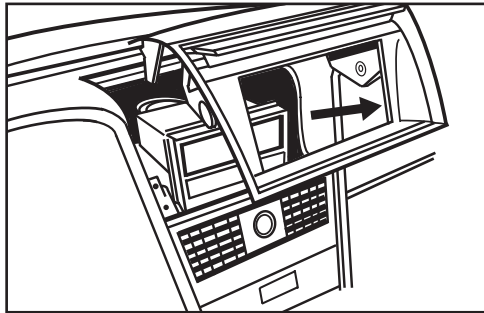

(Figure C)

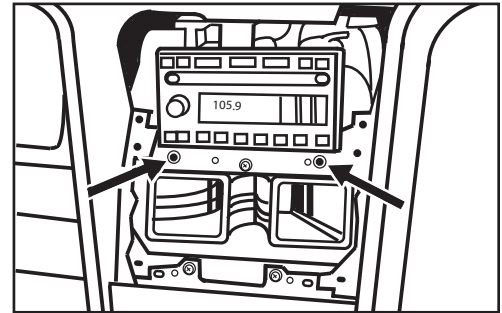

(Figure E)



99-5027

## All models

1. Attach the corresponding radio housing trim piece to the radio housing. (Figure A)

**The following applications will use radio housing trim piece “B” (thicker trim piece):**

Ford Mustang 2001-2004

Ford Expedition (without NAV) 2003-2006

Ford Explorer 2002-2005

Lincoln Aviator 2003-2005

Lincoln Navigator (without NAV) 2003-2006

Mercury Mountaineer 2002-2005

**All other applications will use radio housing trim piece “A” (thinner trim piece):**

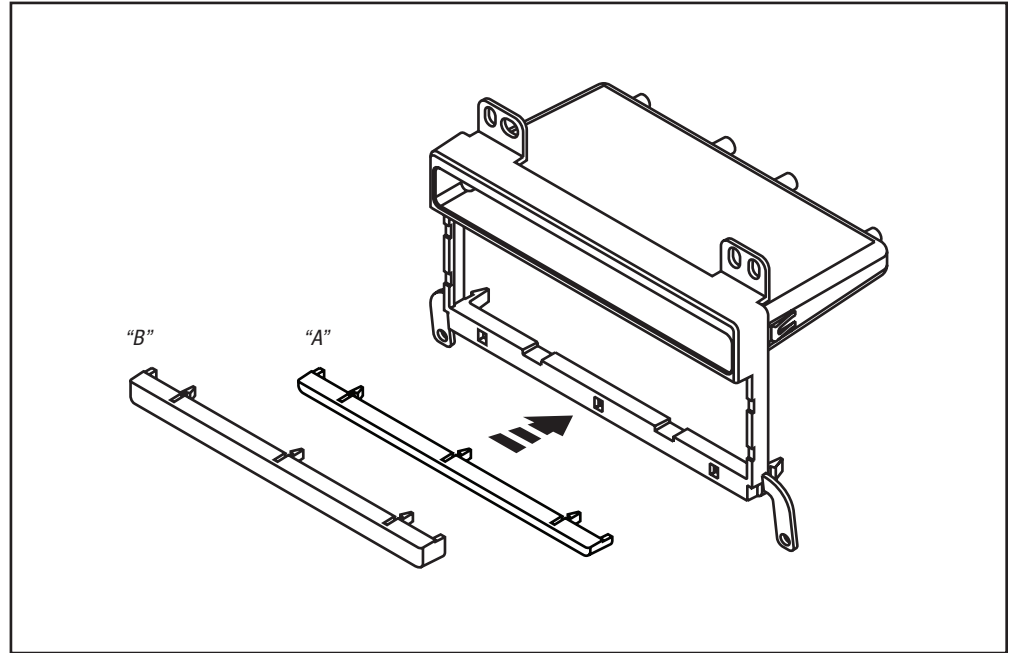

(Figure A)





## Kit Assembly 99-5027

### DIN radio provision with pocket

**Ford Mustang 2001-2004/Expedition (without NAV) 2003-2006/Explorer 2002-2005, Lincoln Aviator 2002-2005/Navigator (without NAV) 2003-2006, Mercury Mountaineer 2002-2005 (if your vehicle is not listed above go to page 11):**

1. Slide the DIN cage into the radio housing and secure by bending the metal locking tabs down. (Figure A)

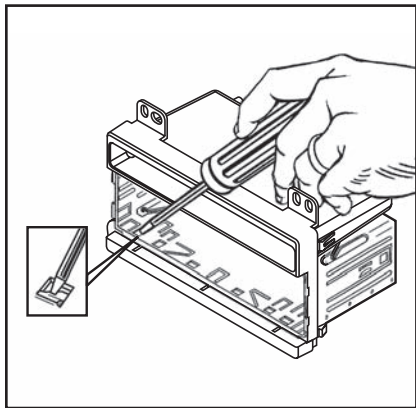

(Figure A)

2. Slide the aftermarket radio into the cage and secure. (Figure B)
3. Mount the support to the back of the radio using the hardware included with the unit. (Figure B)

**Note:** On Ford Expedition and Lincoln Navigator DIN head and ISO kit assemblies you must cut the rear support bracket for clearance. (Figure C)

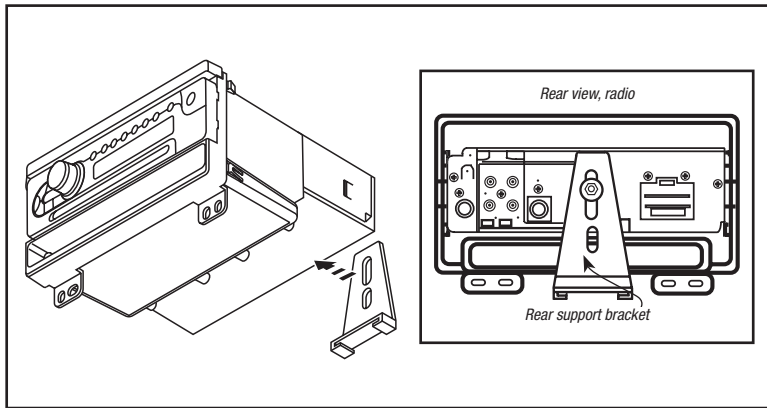

(Figure B)

4. Locate the factory wiring harness and antenna plug in the dash. Metra recommends using the proper mating adapters from Metra and/or AXXESS.
5. Reassemble dash in reverse order of disassembly.

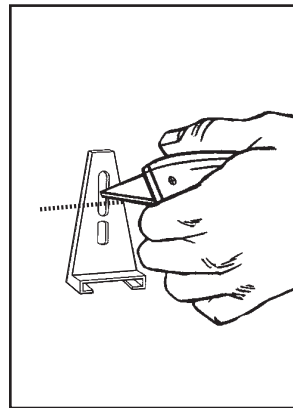

(Figure C)



## Kit Assembly 99-5027

### ISO DIN radio provision with pocket

**Ford Mustang 2001-2004/Expedition (without NAV) 2003-2006/Explorer 2002-2005, Lincoln Aviator 2002-2005/Navigator (without NAV) 2003-2006, Mercury Mountaineer 2002-2005 (if your vehicle is not listed above go to page 12):**

1. Secure the ISO brackets to the back of the radio housing with (2) #8 x 3/8" Phillips screws with the front edge of the bracket inside the radio opening.

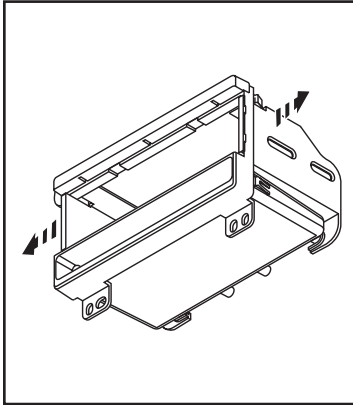

(Figure A)

(Figure A)

2. Slide the aftermarket radio into the radio opening and secure with the radio's supplied screws. (Figure B)
3. Mount the support to the back of the radio using the hardware included with the unit. (Figure B)

**Note:** On Ford Expedition and Lincoln Navigator DIN

head and ISO kit assemblies you must cut the rear support bracket for clearance. (Figure C)

4. Snap trim plate into the radio housing. (Figure B)
5. Locate the factory wiring harness and antenna plug in the dash. Metra recommends using the proper mating adapters from Metra and/or AXCESS.
6. Reassemble dash in reverse order of disassembly.

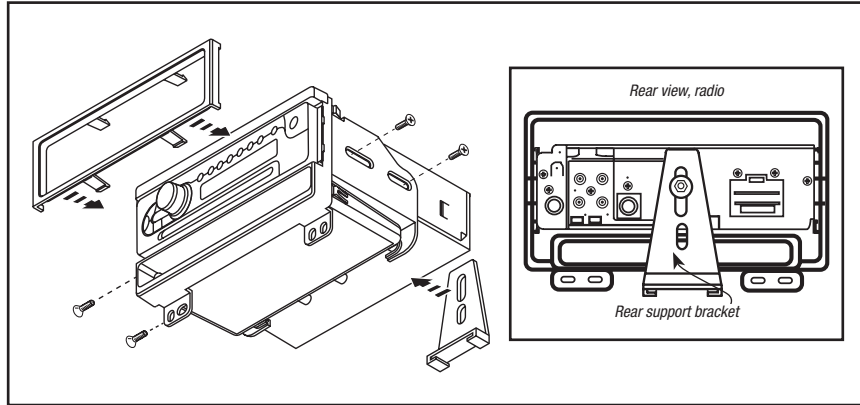

(Figure B)

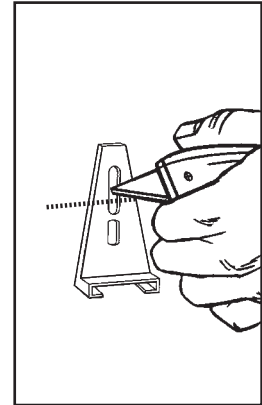

(Figure C)



## Kit Assembly 99-5027

### DIN radio provision

1. Slide the DIN cage into the radio housing and secure by bending the metal locking tabs down. (Figure A)
2. Secure the mounting bracket to the back of the radio housing with (2) 3/8" Phillips pan-head screws supplied. (Figure B)
3. Slide the aftermarket radio into the cage and secure. (Figure C)
4. Slide the rear support onto the mounting bracket and mount the support to the back of the radio using the hardware included with the unit. (Figure C)
5. Locate the factory wiring harness and antenna plug in the dash. Metra recommends using the proper mating adapters from Metra and/or AXCESS.
6. Reassemble dash in reverse order of disassembly.

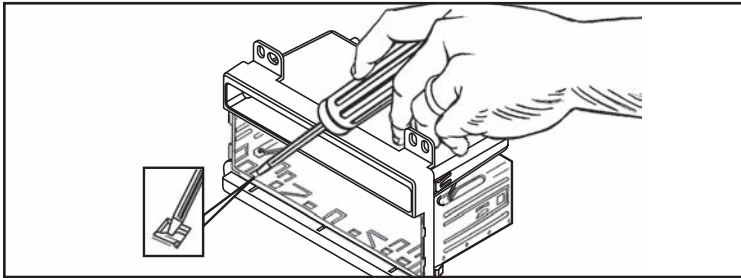

(Figure A)

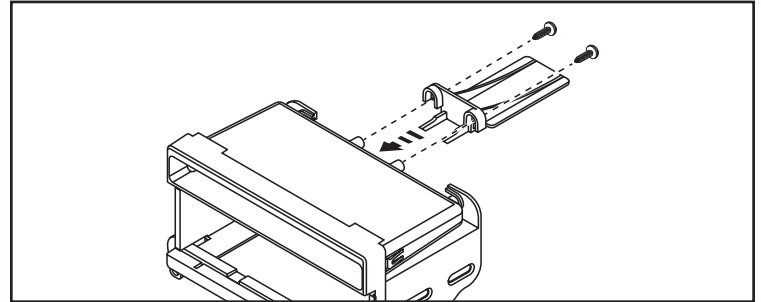

(Figure B)

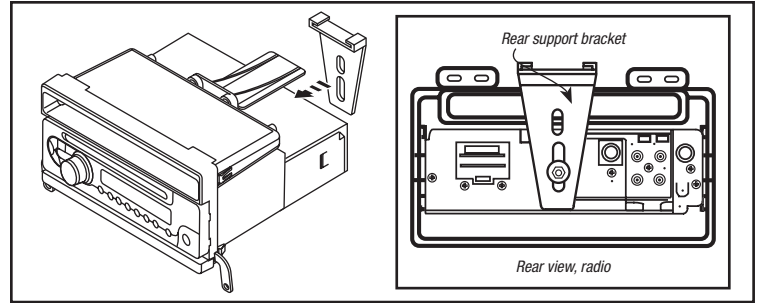

(Figure C)



## Kit Assembly 99-5027

### ISO DIN radio provision

1. Secure the ISO brackets to the back of the radio housing with (2) #8 x 3/8" Phillips screws with the front edge to the bracket inside the radio opening. (Figure A)
2. Secure the mounting bracket to the back of the radio housing with the (2) 3/8" Phillips pan-head screws supplied. (Figure A)
3. Slide the radio into the radio opening and secure with the radio's supplied screws. (Figure B)
4. Slide the rear support onto the mounting bracket and mount the support to the back of the radio using the hardware included with the unit. (Figure B)
5. Snap the trim plate into the radio housing. (Figure B)
6. Locate the factory wiring harness and antenna plug in the dash. Metra recommends using the proper mating adapters from Metra and/or AXCESS.
7. Reassemble dash in reverse order of disassembly.

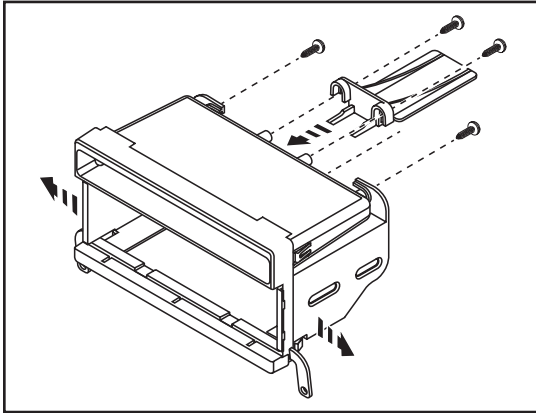

(Figure A)

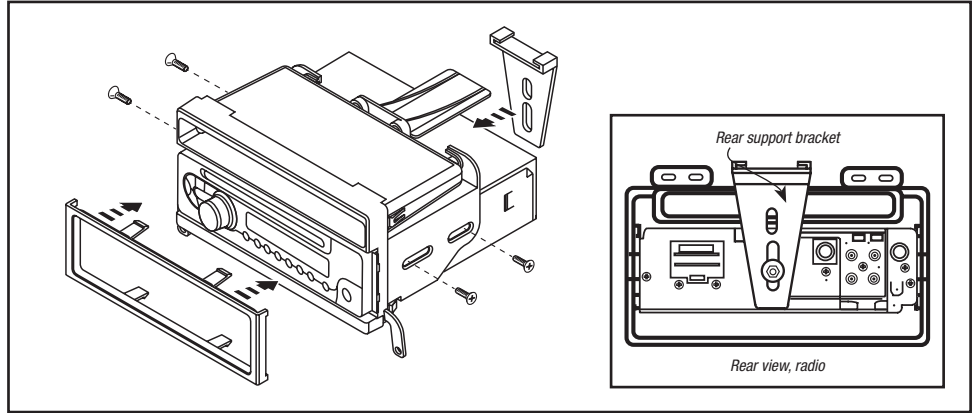

(Figure B)