



MPS-WHIPS

**UTV/ATV LED WHIP
INSTALLATION GUIDE**

USER MANUAL

INSTALL GUIDE:

IMPORTANT: READ CAREFULLY BEFORE ASSEMBLY AND USE.

- For Proper installation of this product the installer must have a good understanding of automotive electronics, systems, and wiring procedures.
- Mounting this product may require drilling holes, the installer MUST be sure that no vehicle components or other vital parts could be damaged by the drilling process. Check both sides of the mounting surface before drilling begins. Also de-burr any holes and remove any metal shards or remnants. Install grommets into all wire passage holes.
- Do not attempt to activate or control this device in a hazardous driving situation.
- Do not install this product or route any wires in the deployment area of your air bag equipment mounted or located in the air bag deployment area will damage or reduce the effectiveness of the air bag, or become a projectile that could cause serious personal injury or death. Refer to your vehicle owner's manual for the air bag deployment area. The User/Installer assumes full responsibility to determine proper mounting location, based on providing ultimate safety to all passengers inside the vehicle.
- This product contains either strobe light(s), halogen light(s), high-intensity LEDs and/or a combination of these lights. Do not stare directly into these lights. Momentary blindness and/or eye damage could result.



INSTALL GUIDE:

FULL RGB

MPS-RGBWHIP4
MPS-RGBWHIP6

GROUP 1

CONSISTS OF 2 MODELS
MPS-RGBWHIP4 (4 ft model)
MPS-RGBWHIP6 (6 ft model)

This whip must be connected to the MPS-RGBC-4, and controlled by the RGB MPS LED app using Micro DIN connection. (see Page 10 & 11)

NOTE: All Metra Whips come with a Flag and mounting hardware

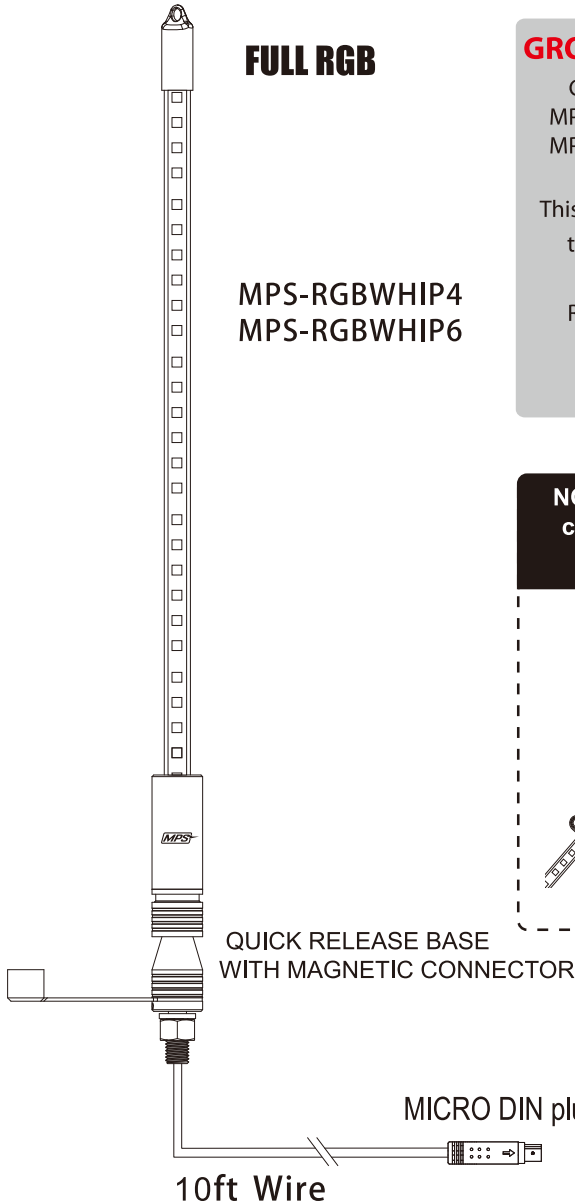
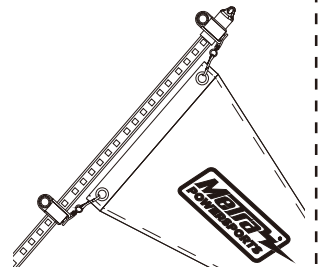

INSTALL GUIDE:

SINGLE COLOR LED

- MPS-OWhIP4
- MPS-OWhIP6
- MPS-BWhIP4
- MPS-BWhIP6
- MPS-GWhIP4
- MPS-GWhIP6
- MPS-WWhIP4
- MPS-WWhIP6
- MPS-RWhIP4
- MPS-RWhIP6
- MPS-PWhIP4
- MPS-PWhIP6

QUICK
RELEASE BASE

10ft Wire

12V+
GND

GROUP 2

CONSISTS OF 12 MODELS
MPS-#WhIP4 (4 ft model)
MPS-#WhIP6 (6 ft model)

Single color LED whip connects to 12VDC positive (Red) and negative (Black) either thru the ignition or a switch for power on/off.

IMPORTANT: Use the supplied ATC fuse holder with the red butt connector, between on the 12VDC red wire connection to fuse the power to the LED light whip.

INCLUDED WITH
THIS WHIP KIT

5Amp ATC Fuse

6inch 18AWG Red Wire

× 1PC

Red 22/18 Gauge Butt
× 1PC

INSTALL GUIDE:

SINGLE COLOR OPTIC FIBER

- MPS-FOOWHIP4
- MPS-FOOWHIP6
- MPS-FOBWHIP4
- MPS-FOBWHIP6
- MPS-FOGWHIP4
- MPS-FOGWHIP6
- MPS-FOWWHIP4
- MPS-FOWWHIP6
- MPS-FORWHIP4
- MPS-FORWHIP6
- MPS-FOPWHIP4
- MPS-FOPWHIP6

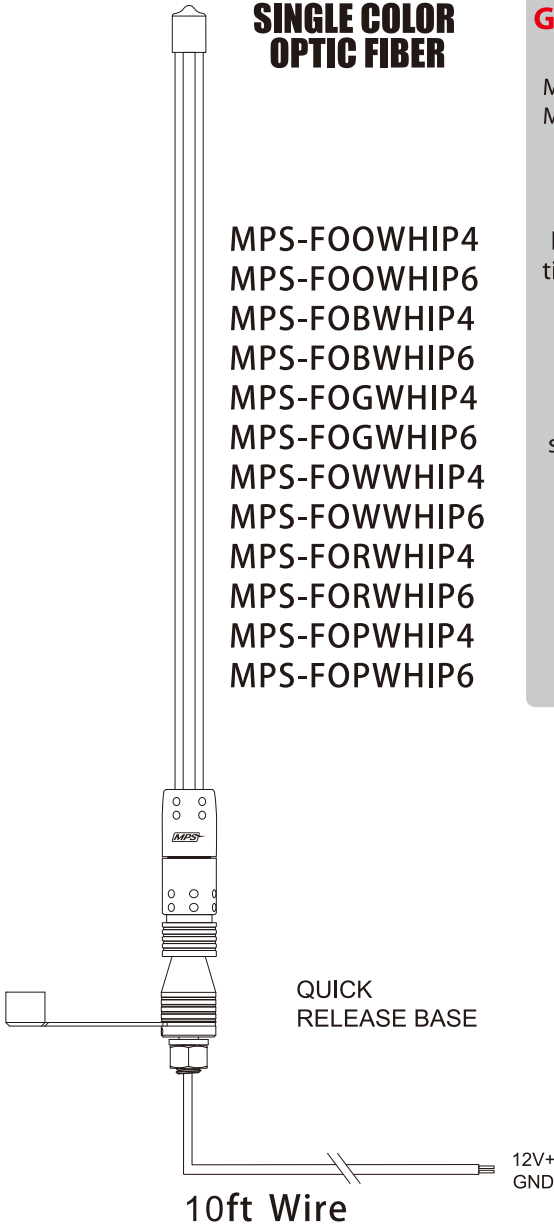

GROUP 3

CONSISTS OF 12 MODELS
MPS-####WHIP4 (4 ft model)
MPS-####WHIP6 (6 ft model)

Single color fiber optic whip connect to 12VDC positive (Red) and negative (Black) either thru the ignition or a switch for power on/off.

IMPORTANT: Use the supplied ATC fuse holder with the red butt connector, between on the 12VDC red wire connection to fuse the power to the LED light whip.

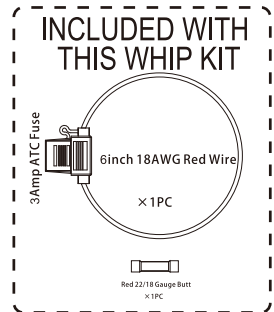

INSTALL GUIDE:

FULL RGB WITH CONTROLLER BUILT-IN

MPS-CRGBWHIP4
MPS-CRGBWHIP6

QUICK RELEASE BASE
WITH MAGNETIC CONNECTOR

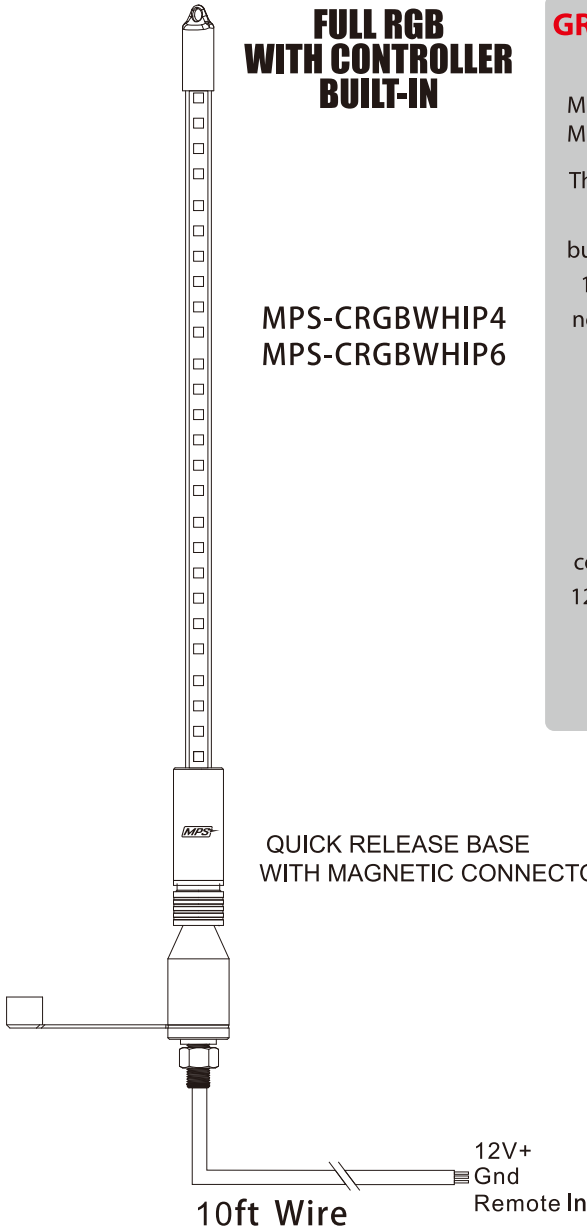

GROUP 4

CONSISTS OF 2 MODELS
MPS-CRGBWHIP4 (4 ft model)
MPS-CRGBWHIP6 (6 ft model)

These RGB LED whips come with lighting controller built-in the base, connect to 12VDC positive (Red) and negative (Black) either thru the ignition or a switch for power on/off.

IMPORTANT: Use the supplied ATC fuse holder with the red butt connector between on the 12VDC red wire connection to fuse the power to the LED light whip.

INCLUDED WITH
THIS WHIP KIT

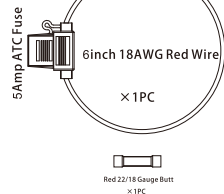

INSTALL GUIDE:

MOUNTING TO CHASSIS FRAME:

CAUTION! Permanent mounting of this product could require drilling. It is absolutely necessary to make sure that no other vehicle components could be damaged while performing this process. Like other wiring, brake lines, gas tanks, etc.

Check both sides of the mounting surface for obstruction visually before starting. If damage to other components is likely, select a different mounting location/position.

1. Remove the LED whip from the mounting base by sliding the locking ring up on the whip, releasing the locking mechanism, and pull the whip straight up. Refer to Diagram 1 (below)

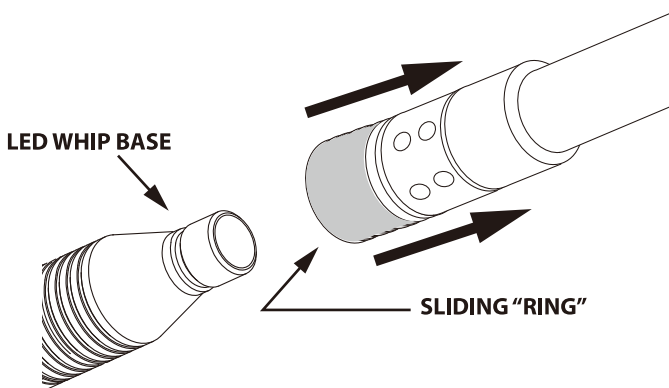

Mounting Diagram 1

2. Remove the nut, washer and split washer from the threaded post on the base. Refer to Diagram 2
3. Select the desired mounting surface.
4. Place the threaded base over the desired mounting surface, mark the area where the mounting hole is to be drilled. Confirm that no vehicle parts could be damaged by the drilling process.
5. Using a 5/8"(16mm) drill bit, drill the mounting hole, thoroughly de-burr the hole.

INSTALL GUIDE:

- Pull the power or connection wires through the hole, then replace the flat washer, split washer and threaded nut back onto the threaded base. Tighten firmly with the required size wrench. Refer to Diagram 2

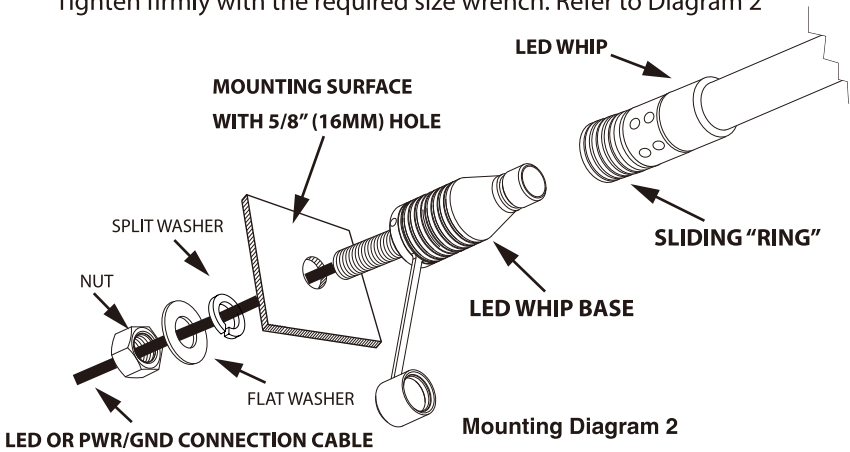

- Reconnect the light whip by pulling up on the locking slide ring on the whip, reinsert the whip, on certain models the whip bases are "Keyed" and you might need to turn slightly right or left to match the keys and have the whip drop onto the electrical connection.
- Attach the included "Warning Flag" to the whip using the included hardware. This flag is required in California and Arizona.

OPTIONAL LED "WHIP" MOUNT - MPS-WHIP (sold separately)

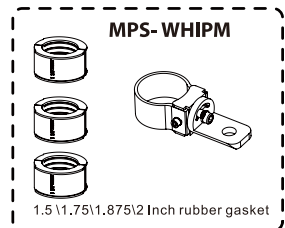
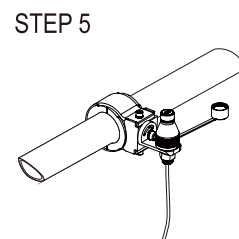
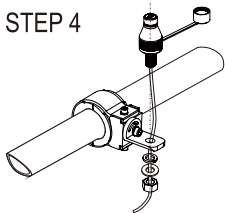
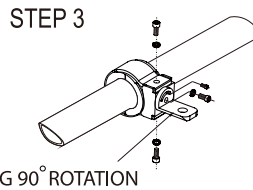
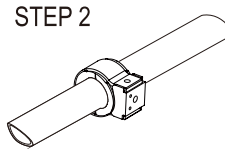
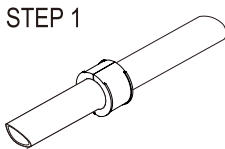

INSTALL GUIDE:

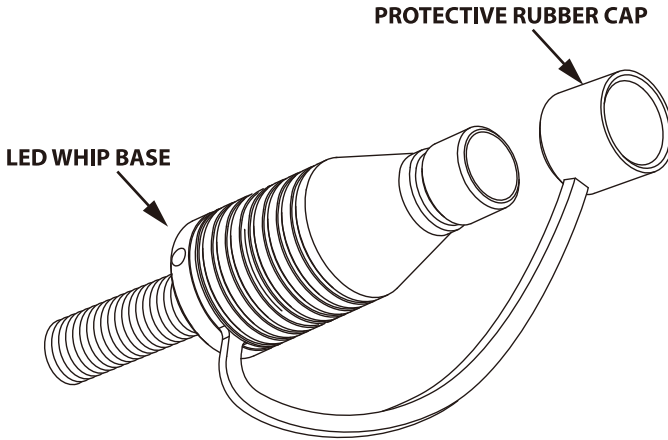

When not using the LED whip always place the supplied rubber cap over the output for the whip to protect the electrical connection from sand, dirt and water.

Wiring:

WARNING! All customer supplied wires that connect to the positive terminal of the battery must be sized to supply at least 125% of the maximum operating current and FUSED at the battery to carry that load.

RED - To 12V DC Power Source

BLACK - To Chassis Ground

SPECIFICATIONS

Input Voltage:

- 11 - 14V DC

Input Current:

- 1.2m Whip Light: Green, Red, Orange: Current 3A, Power@ 13.8VdDC . 41.4 W
- 1.2m Whip Light: Pink, White, Blue: Current 4A, Power@ 13.8VdDC . 55.2 W
- 1.8m Whip Light: Blue, Green, White, Pink: Current 2.2A, Power@ 13.8VdDC . 30.3W
- 1.8m Whip Light: BRed, Orange: Current 2A, Power@ 13.8VdDC . 27.6W

LED CONTROLLER INTRODUCTION/SETUP

MPS-RGBC-4 (sold separately)

RGB/LED 4 OUTPUT CONTROLLER

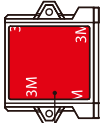
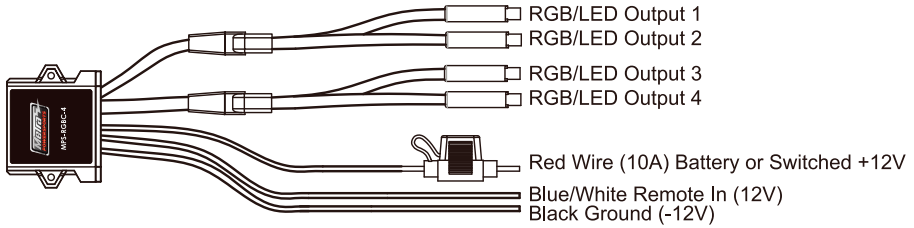

3M Tape on the back

NOTE: the MPS-RGBC-4 must operate at 11-14VDC. This controller can ONLY output 10A total current! Make sure to calculate LED current draw

INTRODUCTION

The MPS-RGBC-4 Mobile RGB LED Controller uses advanced PWM (Pulse Width Modulation) digital control technology for precise and accurate color control and management. The controller can ONLY be operated using the RGB MPS phone app. This app is available for both IOS and Android:



NOTE: The MPS-RGBC-4 must operate at 11-14VDC - Ensure you are using LED strips, OR speakers with LEDs which matches the output voltage/current of the controller.



MPS-RGBC-4 LED CONTROLLER PHONE APP

Click to show the controller list

Switch the color wheel

Frequent used color (can be changed)

Classic colors

Click to shift the Functions

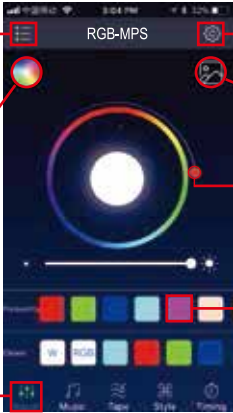

Click to display settings list

Pick up a color from the picture

Adjust the color

Click square icon to adjust the color

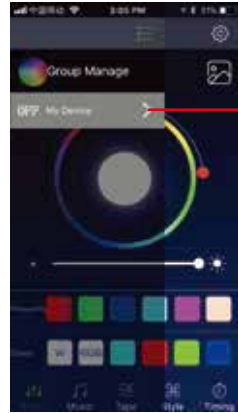

Controller list

Previous Track

Color change according to the music via device play list

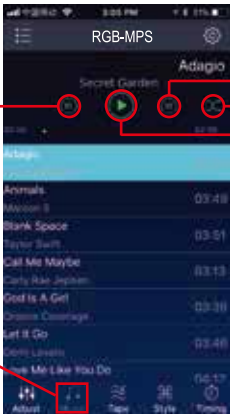

Next Track

Random Mode

Pause or play

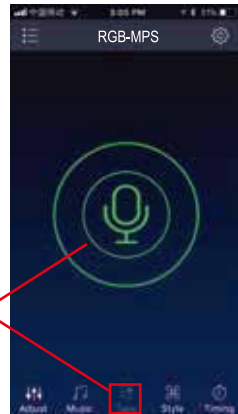

Color change according to the surrounding music via your device microphone

Adjust the speed



Rolling selection mode

