



Ford Mustang 2010-2014

KIT FEATURES

- ISO DIN radio provision with pocket
- ISO DDIN radio provision
- Painted charcoal with a matte black center
- Touchscreen interface for climate and personalization features

KIT COMPONENTS

- A) Radio/Display trim panel • B) Radio/Display sub-trim panel upper (a) • C) Radio/Display sub-trim panel lower (b) • D) Radio brackets upper (a) • E) Radio brackets lower (b) • F) Pocket • G) (4) Panel clips • H) (12) #6 x 3/8" Phillips pan-head screws • I) (8) #8 x 3/8" Phillips truss-head screws • J) Touchscreen display assembly and wiring harness

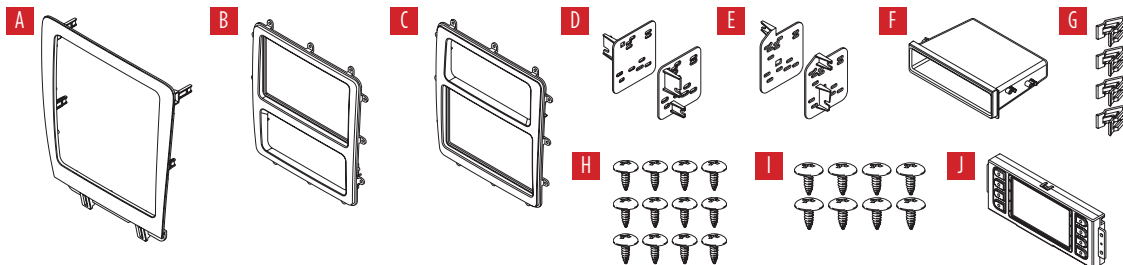

TABLE OF CONTENTS

Dash Disassembly	2
Kit Preparation	3
Kit Assembly	
–ISO DIN radio provision with pocket	4
–ISO DDIN radio provision	5
Axxess Interface Installation	6-11

WIRING & ANTENNA CONNECTIONS (sold separately)

Wiring Harness: Axxess interface and wiring harness included

Antenna Adapter: 40-CR10 (sold separately)

TOOLS REQUIRED

- Panel removal tool • Phillips screwdriver
- 9/32" Socket wrench

CAUTION! All accessories, switches, climate controls panels, and especially air bag indicator lights must be connected before cycling the ignition. Also, do not remove the factory radio with the key in the on position, or while the vehicle is running.

DASH DISASSEMBLY

1. Unclip and remove the trim panel surrounding the shifter including the cup holders. (Figure A)
2. Remove the (2) 9/32" screws from the bottom of the radio/climate control panel, and then unclip and remove the panel. (Figure B)
3. Remove the (4) Phillips screws securing the radio chassis, and then remove. (Figure C)

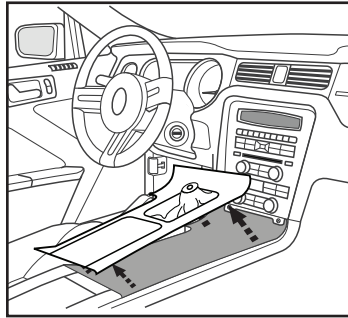

(Figure A)

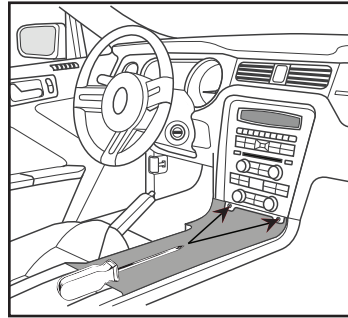

(Figure B)

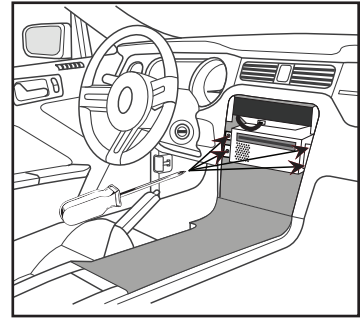

(Figure C)

Continue to Kit Preparation

KIT PREPARATION

1. There are two different *radio/display sub-trim panels* to choose from. One for mounting the radio in the upper portion of the kit, and another one for mounting it in the lower portion. (Figure A)
If mounting the radio in the upper portion, a factory module will need to be re-located:
 - a. Remove the module from the sub-dash and relocate it to the bottom of the dash opening. The mounting brackets attached to the module will need to be bent outward to make room for the radio.

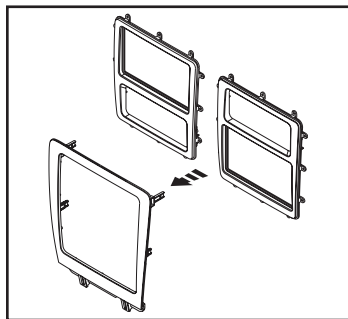

(Figure A)

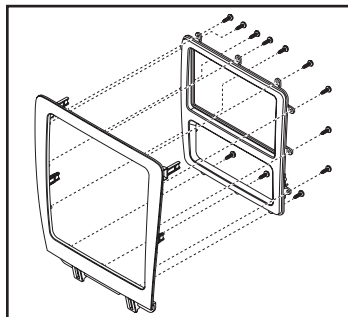

(Figure B)

2. Attach the desired *radio/display sub-trim panel* to the *radio/display panel* using the (12) #6 x 3/8" pan-head screws provided. (Figure B)
3. Attach the *touchscreen display assembly* to the *radio/display sub-panel* using the (4) #8 x 3/8" truss-head screws provided. (Figure C)
4. Attach the (4) *panel clips* provided to the *radio/display panel*. (Figure D)

Continue to Kit Assembly

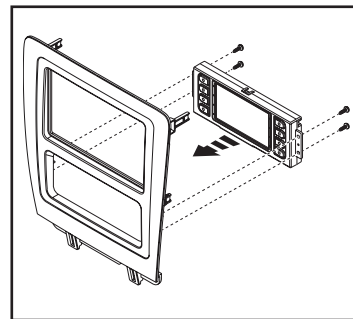

(Figure C)

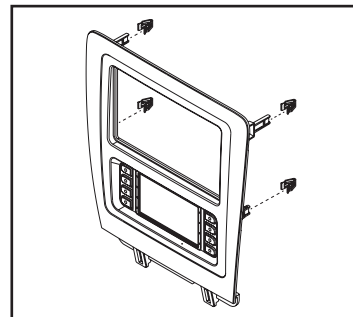

(Figure D)

KIT ASSEMBLY

ISO DIN radio provision with pocket

1. Attach the pocket to the appropriate *radio brackets* using the (4) #8 x 3/8" Phillips truss-head screws provided. (Figure A)
2. Remove the metal DIN sleeve and trim ring from the aftermarket radio.
3. Slide the radio into the bracket/pocket assembly, and then secure it using the screws supplied with the radio. (Figure B)

*Continue to Axxess
Interface Installation*

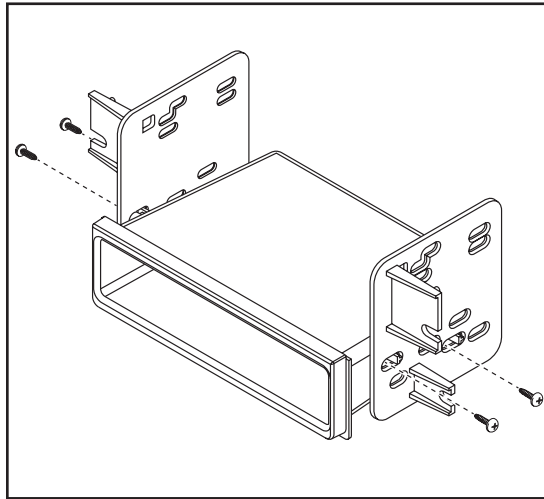

(Figure A)

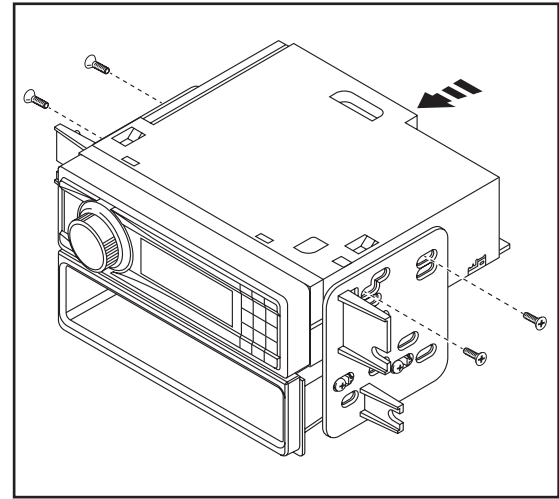

(Figure B)

KIT ASSEMBLY

ISO DDIN radio provision

1. Attach the appropriate *radio brackets* to the radio using the screws supplied with the radio. (Figure A)

*Continue to Axxess
Interface Installation*

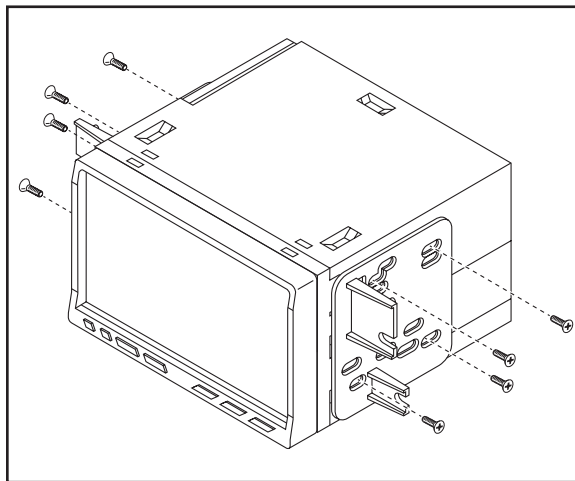

(Figure A)

AXXESS INTERFACE INSTALLATION

INTERFACE FEATURES

- Provides accessory power (12-volt 10-amp)
- Retains R.A.P. (retained accessory power)
- Provides NAV outputs (parking brake, reverse, speed sense)
- Retains audio controls on the steering wheel
- Retains SYNC
- Retains the factory AUX-IN jack
- Provides an aftermarket backup camera input
- Can be used in both amplified and non-amplified models
- Retains balance and fade
- Micro "B" USB updatable

INTERFACE COMPONENTS

- Axxess interface (built into the touchscreen display)
- 5839 harness
- 16-pin harness with stripped leads
- 4-pin harness with yellow RCA jacks
- Female 3.5mm jack with two loose wires

TOOLS REQUIRED

- Wire cutter • Crimp tool • Solder gun • Tape •
- Connectors (example: butt-connectors, bell caps, etc.)

CONNECTIONS TO BE MADE

From the 16-pin harness with stripped leads to the aftermarket radio:

- Connect the **Red** wire to the accessory wire.
- If the vehicle is equipped with a Shaker sound system or NAV, connect the **Blue/White** wire to the amp turn on wire. This wire must be connected to hear sound from the factory amplifier.
- If the aftermarket radio has an illumination wire, connect the **Orange/White** wire to it.
- If the aftermarket radio has a mute wire and the vehicle is equipped with SYNC, connect the **Brown** wire to it. If the mute wire is not connected, the radio will turn off when SYNC is activated.
- Connect the **Gray** wire to the right front positive speaker output.
- Connect the **Gray/Black** wire to the right front negative speaker output.
- Connect the **White** wire to the left front positive speaker output.
- Connect the **White/Black** wire to the left front negative speaker output.

The following (3) wires are only for multimedia/navigation radios that require these wires.

- Connect the **Blue/Pink** wire to the VSS/speed sense wire.
- Connect the **Green/Purple** wire to the reverse wire.
- Connect the **Light Green** wire to the parking brake wire
- Tape off and disregard the following (4) wires, they will not be used in this application:
Green, Green/Black, Purple, Purple/Black

Continued on the next page

CONNECTIONS TO BE MADE (CONT.)

From the 5839 harness to the aftermarket radio:

- Connect the **Black** wire to the ground wire.
- Connect the **Yellow** wire to the battery wire.
- Connect the **Blue** wire to the power antenna wire.
- If the vehicle is equipped with NAV, connect the **Blue/White** wire with a red connector to the amp turn on wire. This wire must be connected to hear sound from the factory amplifier.
- Connect the **Green** wire to the left rear positive speaker output.
- Connect the **Green/Black** wire to the left rear negative speaker output.
- Connect the **Purple** wire to the right rear positive speaker output.
- Connect the **Purple/Black** wire to the right rear negative output.
- If the vehicle is equipped with SYNC, connect the **Red** and **White** RCA jacks labeled "RSE/SYNC/SAT", to the audio AUX-IN jacks.
- Disregard the **Red** and **White** RCA jacks labeled "FROM 3.5" to the audio AUX-IN jacks they will not be used in this application.
- Disregard the DIN jack, it will not be used in this application.
- Connect the **White** RCA jack labeled "SUBWOOFER", to the subwoofer out jack.
- Disregard the **Red** RCA jack labeled "CENTER CHANNEL", it will not be used in this application.

4-pin harness with yellow RCA jacks:

This harness is to be used to add an aftermarket backup camera to the touchscreen display, if so desired.

- Connect the **Yellow** RCA jack labeled "Rearview camera", to the RCA jack on the aftermarket backup camera.
- Disregard the **Yellow** RCA jack labeled "AUX video", it will not be used in this application.

Continued on the next page

CONNECTIONS TO BE MADE (CONT.)

3.5mm jack steering wheel control retention:

- The 3.5mm jack is to be used to retain audio controls on the steering wheel control.
- For the radios listed below, connect the included *female 3.5mm connector with stripped leads* onto the male 3.5mm SWC jack. Any remaining wires tape off and disregard:
 - **Eclipse:** Connect the steering wheel control wire, normally **Brown**, to the **Brown/White** wire of the connector. Then connect the remaining steering wheel control wire, normally **Brown/White**, to the **Brown** wire of the connector.
 - **Metra OE:** Connect the steering wheel control Key 1 wire (**Gray**) to the **Brown** wire.
 - **Kenwood or select JVC with a steering wheel control wire:** Connect the **Blue/Yellow** wire to the **Brown** wire.

Note: If your Kenwood radio auto detects as a JVC, manually set the radio type to Kenwood. See the instructions under changing radio type.

- **XITE:** Connect the steering wheel control SWC-2 wire from the radio to the **Brown** wire.
- **Parrot Asteroid Smart or Tablet:** Connect the 3.5mm jack into the AX-SWC-PARROT (sold separately), and then connect the 4-pin connector from the AX-SWC-PARROT into the radio.

Note: The radio must be updated to rev. 2.1.4 or higher software.

- **Universal "2 or 3 wire" radio:** Connect the steering wheel control wire, referred to as Key-A or SWC-1, to the **Brown** wire of the connector. Then connect the remaining steering wheel control wire, referred to as Key-B or SWC-2, to the **Brown/White** wire of the connector. If the radio comes with a third wire for ground, disregard this wire.

Note: After the interface has been programmed to the vehicle, refer to the manual provided with the radio for assigning the SWC buttons. Contact the radio manufacturer for more information.

- **For all other radios:** Connect the 3.5mm jack into the port on the radio designated for an external steering wheel control interface. Refer to the manual provided with the radio if in doubt as to where the 3.5mm jack goes to.

INSTALLING THE INTERFACE

With the key in the off position:

1. Connect the 16-pin harness with stripped leads into port "B" in the touchscreen display.
2. Connect the 5389 harness into port "A" in the touchscreen display.
3. Connect the 4-pin harness with yellow RCA jacks into port "C" in the touchscreen display.
4. Disregard ports "D" and "E", they will not be used in this application.
5. Port "F" is an update port for future Firmware upgrades.

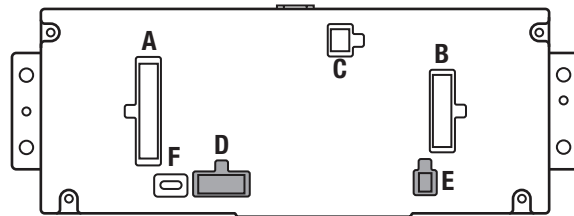

INITIALIZING THE INTERFACE

Attention! *If the interface loses power for any reason, the following steps will need to be performed again.*

1. Turn the key to the ignition position and wait until the radio comes on.
Note: *If the radio does not come on within 60 seconds, turn the key to the off position, disconnect the interface, check all connections, reconnect the interface, and then try again.*
2. Turn the key to the off position, pause for a moment, and then start the vehicle.
3. Test all functions of the installation for proper operation, before reassembling the dash.

FINAL ASSEMBLY

1. Reassemble the dash in reverse order of disassembly.

EXTRA FEATURES

SYNC:

If the vehicle is equipped with SYNC, the 99-5839CH can retain this feature.

1. Change the source of the radio to AUX-IN.
2. Press the “Info” button on the touchscreen display to enter the SYNC menu.
Press the “HVAC” button to get back to the main menu.

TOUCHSCREEN DISPLAY OPERATION



- This is the HVAC control screen which will be displayed on the *touchscreen display*. This is considered the main screen.
- The upper left tab with (3) arrows will take you to the **Heated/Cooled** seats screen.
- The upper right tab with the gear icon will take you to the **Configuration Settings** screen.

Heated/Cooled seats screen:

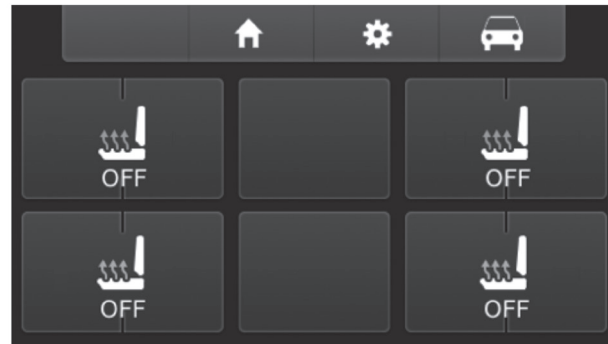

Auto Climate: The climate controls will function in the same manner that they did with the factory climate controls.

Manual Climate: The climate controls will function in the same manner that they did with the factory climate controls, yet via touchscreen buttons instead. The temperature control will display a numerical scale, with “LO” being the coldest, and “HI” being the hottest: LO / 1-9 / HI

Note: The “Info” button will only be shown if SYNC is to be retained.

Continued on the next page

TOUCHSCREEN DISPLAY OPERATION (CONT.)

Configuration Settings screen

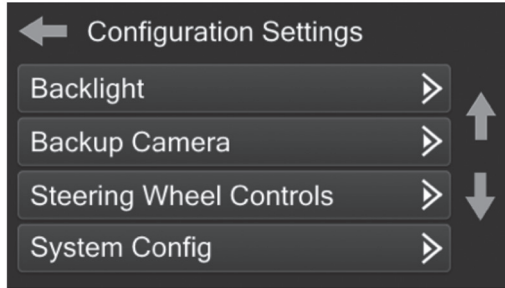

- **Backlight**

- Four slide bars control the color of the buttons and the back-light intensity:
Red / Green / Blue / Backlight

- **Backup Camera**

- Enable – Enables the backup camera image to the touchscreen display
- Disable – Disables the backup camera image to the touchscreen display (default)

- **Steering Wheel Controls**

- Remap Buttons – For remapping the steering wheel control buttons
- Dual Assign – For dual assigning the steering wheel control buttons (long button press)
- Select Radio – For auto detecting the radio, or changing the radio type

- **Ambient Lighting**

- Factory colors available from Ford

- **System Configuration**

- Firmware version

Touchscreen calibration:

- Press and hold the upper two soft buttons on the main screen for 10 seconds.
- A screen will pop up asking for you to press the target in the screen.
- After pressing the target with your finger, the calibration process will be complete, and the screen will disappear.

STEERING WHEEL CONTROL SETTINGS

Select Radio screen



- To show which brand radio is “auto detected” to the interface, press the “Autodetect” button. The radio detected will have a filled in circle. If the incorrect radio is shown, select the proper radio.
- Following is a list of radio manufacturers that the interface presently acknowledges. Others may be added at a later date. Universal “2 or 3 wire” radios can show up as any of these radio manufacturers.

Eclipse (Type 1) †	JVC	Clarion (Type 2) †	Parrot **
Kenwood ‡	Pioneer/Jensen	Metra OE	XITE
Clarion (Type 1) †	Alpine *	Eclipse (Type 2) †	Philips
Sony / Dual	Visteon	LG	JBL
	Valor		

*** Note:** If the interface shows an Alpine radio, and you do not have an Alpine radio, that means the interface does not detect a radio connected it, i.e., an open connection. Verify that the 3.5mm jack is connected to the correct steering wheel jack/wire in the radio.

**** Note:** The AX-SWC-PARROT is required (sold separately). Also, the Parrot radio must be updated to rev. 2.1.4.

† Note: If you have a Clarion radio and the steering wheel controls do not work, change the radio type to the other Clarion radio type; same for Eclipse.

‡ Note: If you have a Kenwood radio and the touchscreen display shows a JVC radio, change the radio type to Kenwood.

Continued on the next page

STEERING WHEEL CONTROL SETTINGS (CONT.)

Remap Button screen



- The interface has the ability to change the button assignment for the steering wheel control audio buttons, except Volume-Up and Volume-Down. Follow the prompts on the touchscreen display to remap the steering wheel control audio button(s) to your liking.

Note: The aftermarket radio may not have all of these commands. Please refer to the manual provided with the radio, or contact the radio manufacturer, for specific commands recognized by that particular radio.

Dual Assign screen

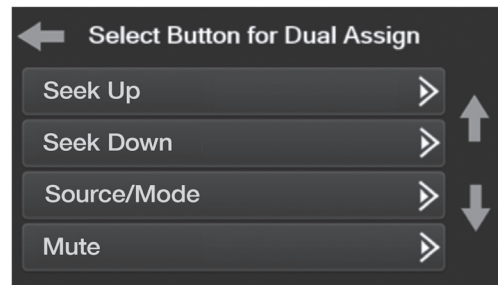

- The interface has the capability to assign two functions to a single button, except Volume-Up and Volume-Down. Follow the prompts on the touchscreen display to program the button(s) to your liking.

Note: Seek-Up and Seek-Down come programmed as Preset-Up and Preset-Down for a long button press.