



### Acura MDX 2007-2013

#### KIT FEATURES

- ISO DDIN radio provision
- Painted matte black

#### KIT COMPONENTS

- A) Radio housing • B) Radio brackets • C) (4) #8 x 3/8" Phillips screws

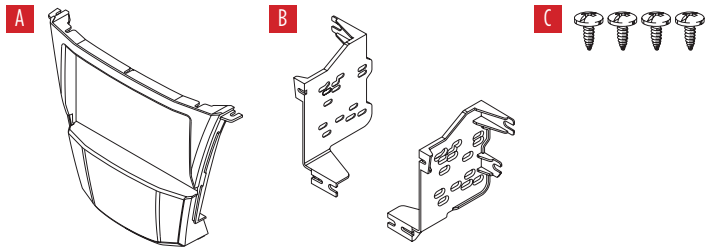

#### TABLE OF CONTENTS

Dash Disassembly .....	2
Kit Assembly .....	3

#### TOOLS REQUIRED

- Panel removal tool • Phillips screwdriver

**CAUTION!** All accessories, switches, climate controls panels, and especially air bag indicator lights must be connected before cycling the ignition. Also, do not remove the factory radio with the key in the on position, or while the vehicle is running.

## DASH DISASSEMBLY

1. Open the passenger door, then unclip and remove the panel on the side of the dashboard. Remove (1) Phillips screw exposed. (Figure A)
2. Unclip and remove the dashboard trim panel above the glovebox. (Figure B)
3. Unclip and remove the dashboard trim panel between the steering column and the radio. (Figure B)
4. Remove (4) screws securing the radio. Slide the radio out, then unplug and remove the radio. (Figure C)

*Continue to Kit Assembly*

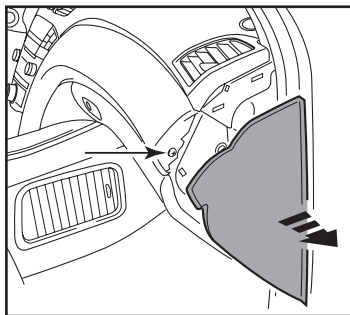

(Figure A)

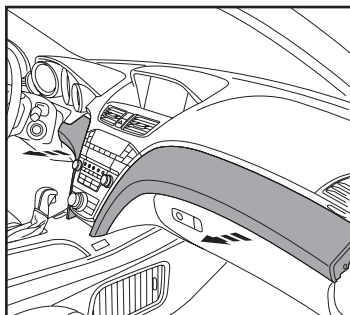

(Figure B)

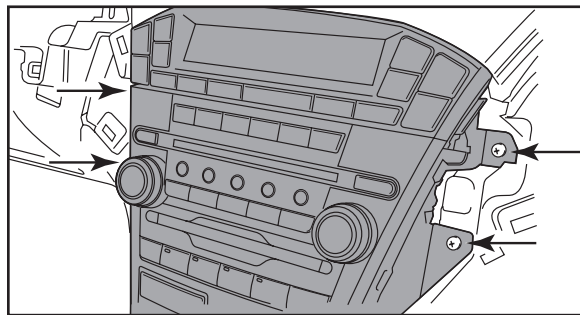

(Figure C)

## KIT ASSEMBLY

1. Secure the radio brackets to the radio housing using the (4) #8 x 3/8" Phillips screws provided. (Figure A)
2. Slide the radio into the bracket/housing assembly, then secure it using the screws supplied with the radio. (Figure B)
3. Locate the factory wiring harness and antenna connector in the dash and complete all necessary connections to the radio. Metra recommends using the proper mating adapter from Metra and/or Axxess. Test the radio for proper operation.
4. Secure the radio assembly to the dash using the factory screws.
5. Reassemble the dash in reverse order of disassembly to complete the installation.

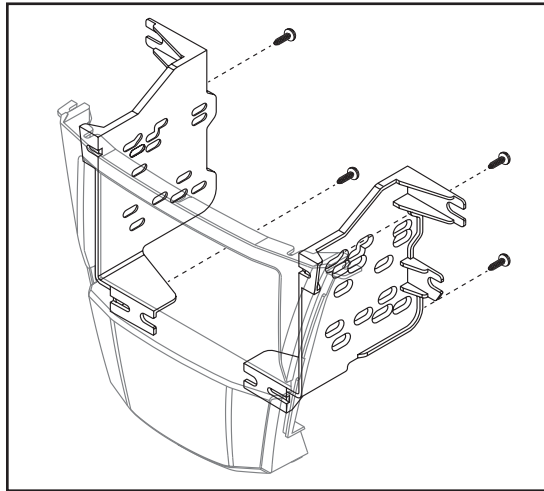

(Figure A)

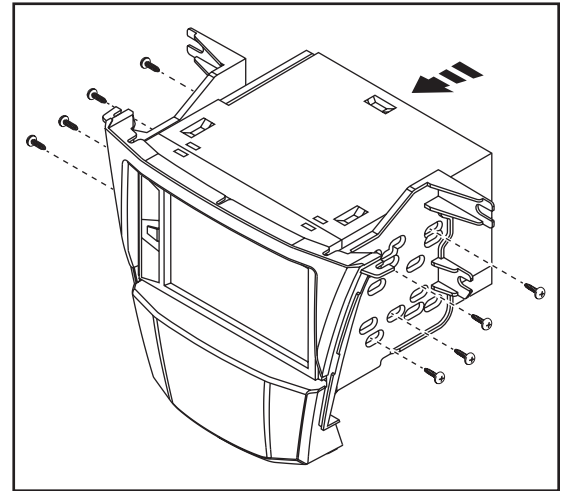

(Figure B)