

**S7002304**

**2006 CHEVROLET C6 CORVETTE  
6.0L, 6 SPEED MANUAL TRANS.**

**MBRP**  
INC.  
**PERFORMANCE EXHAUST**

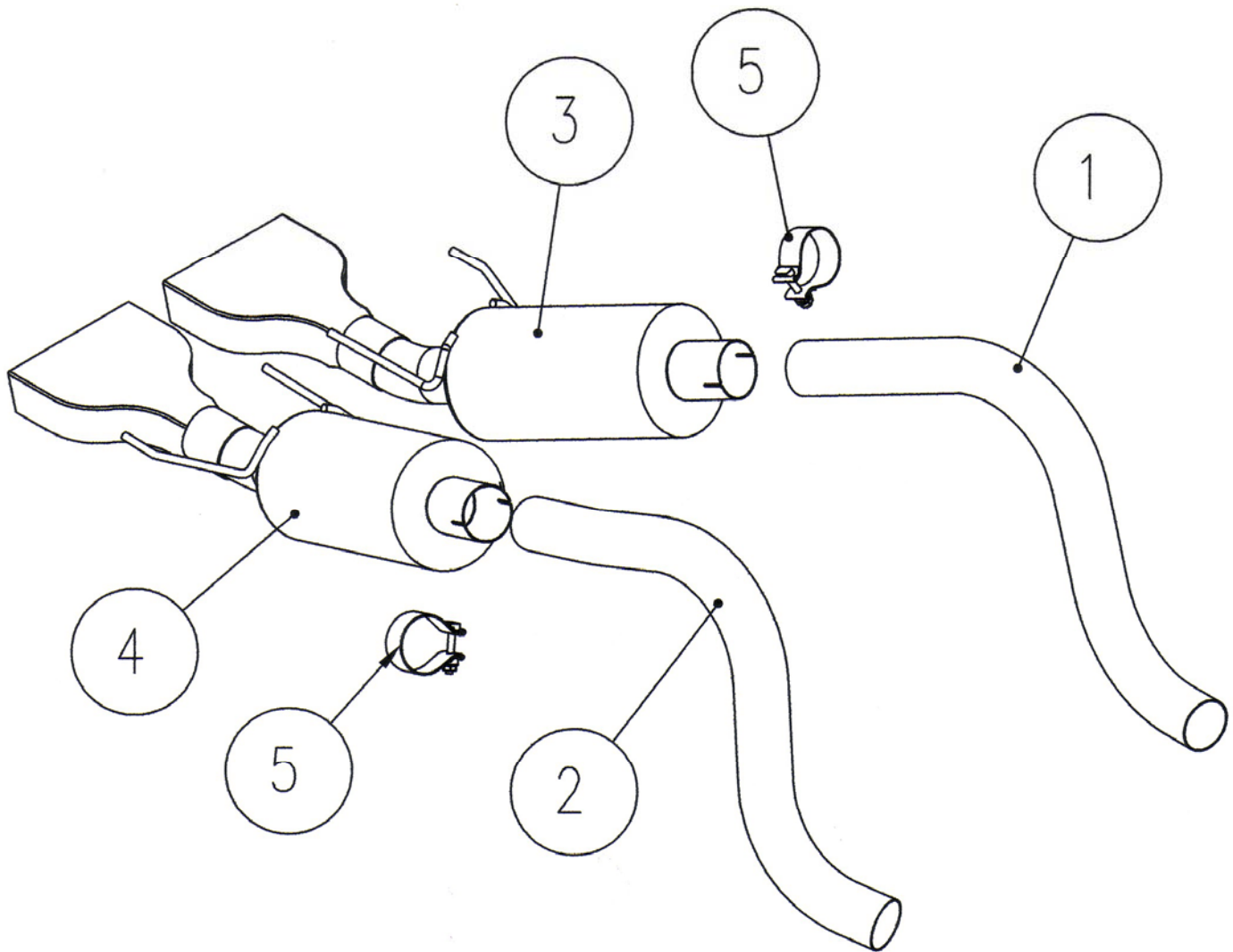

1. DRIVER SIDE OVER AXLE PIPE
2. PASSENGER SIDE OVER AXLE PIPE
3. DRIVER SIDE MUFFLER
4. PASSENGER SIDE MUFFLER
5. 2.5" ACCUSEAL CLAMPS

**2006 Chevrolet C6 Corvette**  
**6.0L, 6 Speed Manual Trans.**

**PLEASE READ BEFORE STARTING INSTALLATION**

**While MBRPinc has made every effort to ensure that all components of this system are of superior quality and properly packaged, it is the installer's responsibility to ensure the following before removal of the factory exhaust:**

- that ALL components shown in the illustration on page 1 are present.
- that ALL mating components fit together.
- that there are no damaged components.
- that the system you have purchased is appropriate for your vehicle year, model and configuration.
- that the system will not interfere with any modifications previously installed.
- that you have read and understand these instructions.

If you have any questions or are uncertain about any aspect of the installation of this system to your vehicle please contact your dealer before commencing installation.

**REMOVAL OF STOCK SYSTEM:**

1. Apply a penetrating lubricant liberally to all exhaust fasteners, hangers and rubber insulators.
2. Remove the bushings holding the anti-sway bar to the rear sub frame and move the anti-sway bar down. This will create more room to remove the factory mufflers.
3. Loosen the band clamp located just in front of the rear axle on both the driver and passenger side.
4. Remove the bolts retaining the rubber insulators and remove the muffler assembly from the vehicle. Do not discard the bolts or the insulators as they are required for the installation of the MBRPinc mufflers.

**INSTALLATION OF MBRPinc PERFORMANCE EXHAUST:**

1. Slide the expanded end of the **Driver Side Over Axle Pipe** from the rear of the car, over the rear axle following the same path as the factory exhaust. Slip the expanded end over the factory exhaust.
2. Install the rubber insulators previously removed onto the hangers welded to the **Driver Side Muffler**.
3. Slide a **2.5" Accuseal Clamp** over the **Driver Side Over Axle Pipe**. Now slip the **Driver Side Muffler** onto the **Driver Side Over Axle Pipe**.
4. Move the **Driver Side Muffler** into place and attach the rubber insulators using the bolts previously removed.
5. Slide the expanded end of the **Passenger Side Over Axle Pipe** from the rear of the car, over the rear axle following the same path as the factory exhaust. Slip the expanded end over the factory exhaust.
6. Install the rubber insulators previously removed onto the hangers welded to the **Passenger Side Muffler**.
7. Slide a **2.5" Accuseal Clamp** over the **Passenger Side Over Axle Pipe**. Now slip the **Passenger Side Muffler** onto the **Passenger Side Over Axle Pipe**.
8. Move the **Passenger Side Muffler** into place and attach the rubber insulators using the bolts previously removed.
9. Align the exhaust as required before tightening **Clamps**.
10. Check along the whole length of the exhaust system to ensure that there is adequate clearance around the fuel and brake lines or any wiring. If any interference is detected relocate or adjust.

**Congratulations!** You are ready to begin enjoying the improved performance and driving experience of your MBRP Inc. performance exhaust system. We hope you enjoy your purchase.