

S60300

**07-10 CHEV/GMC 2500/3500 6.6L
DURAMAX, PARTICULATE FILTER BACK, 5"
SINGLE SIDE**

MBRP
INC.

PERFORMANCE EXHAUST

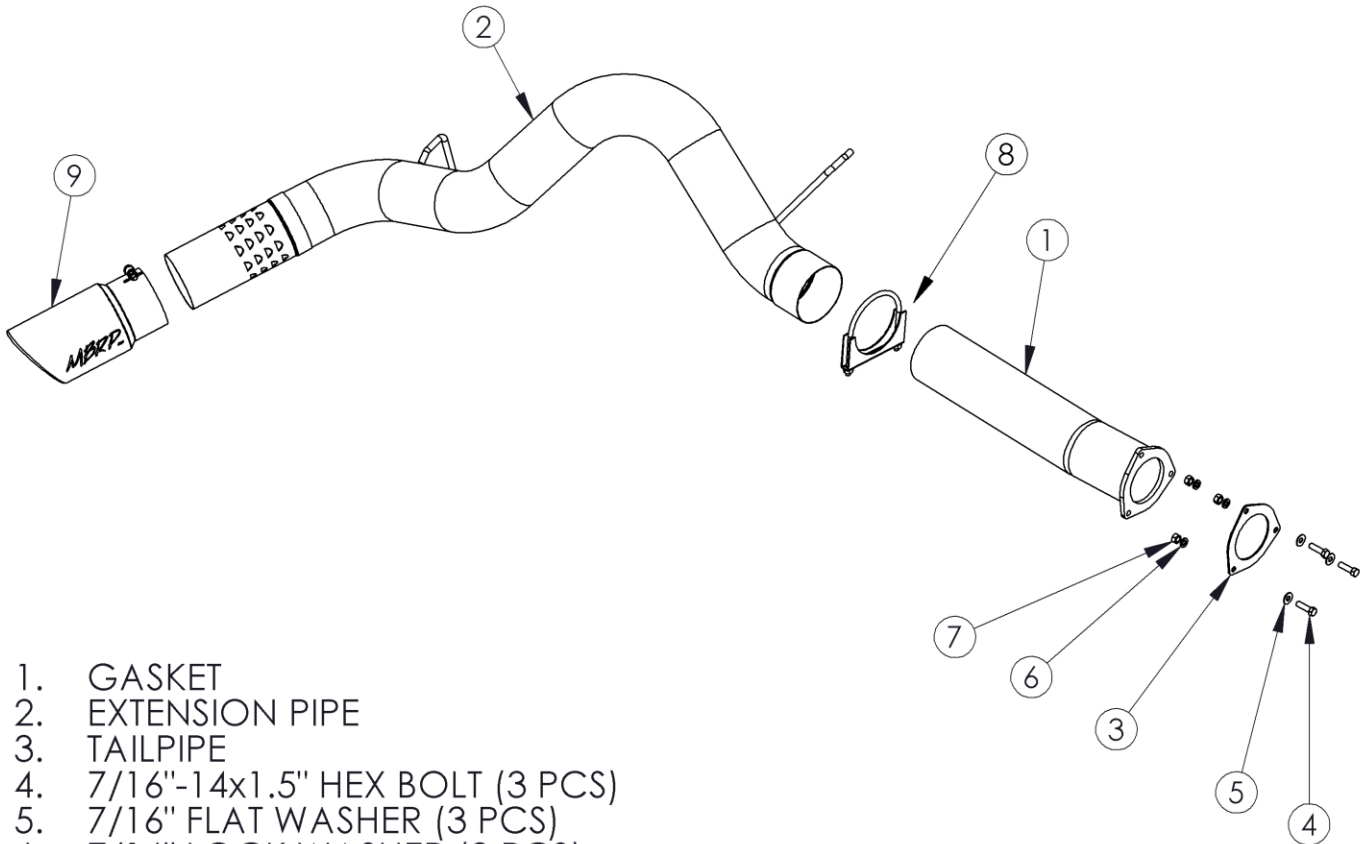

1. GASKET
2. EXTENSION PIPE
3. TAILPIPE
4. 7/16"-14x1.5" HEX BOLT (3 PCS)
5. 7/16" FLAT WASHER (3 PCS)
6. 7/16" LOCK WASHER (3 PCS)
7. 7/16" HEX NUT (3 PCS)
8. 5" CLAMP
9. EXHAUST TIP

PLEASE READ BEFORE STARTING INSTALLATION

While MBRP Inc. has made every effort to ensure that all components of this system are of superior quality and properly packaged it is the installer's responsibility to ensure the following before removal of the factory exhaust:

- that ALL components shown above are present.
- that ALL mating components fit together.
- that there are no damaged components.
- that the system you have purchased is appropriate for your vehicle year, model and configuration.
- that the system will not interfere with any modifications previously installed.
- that you have read and understand these instructions.

If you have any questions or are uncertain about any aspect of the installation of this system to your vehicle please contact your dealer before commencing installation.

Removal of stock system:



Figure 1

1. Apply a penetrating lubricant liberally to all exhaust fasteners, hangers and rubber isolators.

2. Remove the factory tail pipe assembly from the factory rubber isolators. **Refer to Figures 1 and 2.**



Figure 2

3. Cut the factory tail pipe as shown and remove the rear section. **Refer to Figure 3.**

4. Remove the three nuts at the muffler inlet flange and remove the muffler. **Refer to Figure 4.**



Figure 3



Figure 4

Installation of MBRP Inc. Performance Exhaust:



Figure 5



Figure 6



Figure 7



Figure 8

1. Install the three supplied **7/16" Bolts** in the existing flange and place the supplied **Gasket** over the **7/16" Bolts**. Refer to **Figure 5**.

2. Install the Extension Pipe onto the flange. There is a slight bend in the **Extension Pipe**. The inside of this bend must face the driveshaft. If the outlet of the **Extension Pipe** angles slightly towards the driveshaft you have installed it correctly. Failure to install this pipe correctly will result in the **Tail Pipe** not fitting properly. Secure with the three supplied **7/16" Flat Washers**, three **7/16" Lock Washers** and three **7/16" Nuts**. Refer to **Figure 6**.

3. Slide the **5" Clamp** over the outlet of the **Extension Pipe**. Install the **Tail Pipe** from the rear of the truck over the axle and slide on to the **Extension Pipe**. Install the **Tail Pipe** hangers into the factory rubber isolators. Refer to **Figure 7**.

4. Align the system and tighten the **5" Clamp**. Refer to **Figure 8**.

5. Check along the whole length of the exhaust system to ensure that there is adequate clearance around the spare tire, fuel and brake lines or any wiring. If this is any interference detected relocate or adjust.

6. Install and adjust the **Exhaust Tip** to suit. Tighten the lock bolt located on **Exhaust Tip**

7. Make sure the exhaust is in place before tightening the clamps. Start at the front of the exhaust system and tighten all connections.



Congratulations! You are ready to begin experiencing the improved power, sound and driving experience of your MBRP Inc. performance exhaust system. We are certain that you will enjoy your purchase.