

S5404

07-13 NISSAN TITAN, CAT BACK SINGLE
SIDE

MBRP
INC.
PERFORMANCE EXHAUST

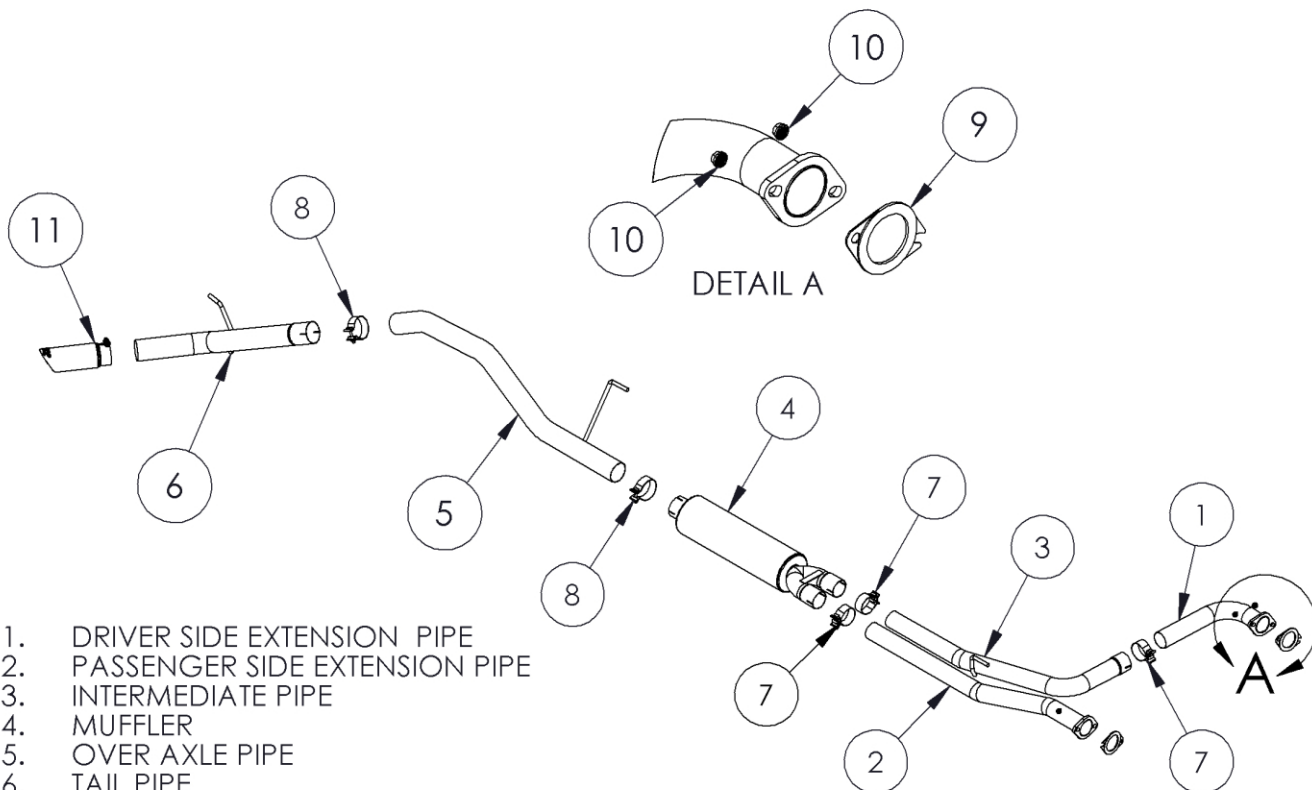

1. DRIVER SIDE EXTENSION PIPE
2. PASSENGER SIDE EXTENSION PIPE
3. INTERMEDIATE PIPE
4. MUFFLER
5. OVER AXLE PIPE
6. TAIL PIPE
7. 2.5" BAND CLAMP (3PCS)
8. 3" BAND CLAMP (2PCS)
9. GASKET (2PCS)
10. 10mm FLANGE NUT (4PCS)
11. EXHAUST TIP

NOTE:SADDLE CLAMPS USED IN ALUMINIZED SYSTEMS

PLEASE READ BEFORE STARTING INSTALLATION

While MBRP Inc. has made every effort to ensure that all components of this system are of superior quality and properly packaged, it is the installer's responsibility to ensure the following before removal of the factory exhaust:

- that ALL components shown above are present.
- that ALL mating components fit together.
- that there are no damaged components.
- that the system you have purchased is appropriate for your vehicle year, model and configuration.
- that the system will not interfere with any modifications previously installed or planned.
- that you have read and understand these instructions.

If you have any questions or are uncertain about any aspect of the installation of this system to your vehicle please contact your dealer before commencing installation.

2007-2013 Nissan Titan

Removal of Stock System

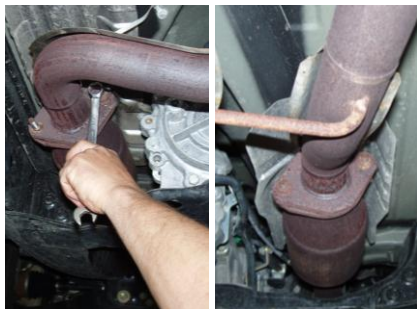

Figure 1



Figure 2



Figure 3



Figure 4



Figure 5

1. Apply a penetrating lubricant liberally to all exhaust fasteners, hangers and rubber insulators.
2. Remove the nuts from the exhaust flanges behind the catalytic converters. **Refer to Figure 1.**
3. Remove the existing exhaust hanger. **Refer to Figure 2.**
4. Lubricate then remove the hardware from the rearmost exhaust hanger. Keep for reinstallation. **Refer to Figure 3.**
5. Remove the hardware from the flange behind the muffler. Remove the hanger from the rubber insulator and remove the exhaust from the vehicle.

Installation of MBRP Inc. Performance Exhaust

1. Install the Driver Side Extension Pipe using one of the provided **2 1/2" Gaskets** and existing hardware whenever possible. The nuts can be replaced with the **10mm Flange Nuts**. Leave hardware loose enough for some adjustment. **Refer to Figure 4.**
2. Slide a **2 1/2" Clamp** over the **Intermediate Pipe** and install it to the **Driver Side Front Pipe**.
3. Slide the existing factory hanger onto the **Extension Pipe** and reattach it to the vehicle. **Refer to Figure 5.**
4. Install the **Passenger Side Extension Pipe** using a **2 1/2" Gasket** and existing hardware whenever possible. The nuts can be replaced with the **10mm Flange Nuts**. Leave hardware loose enough for some adjustment.
5. Slide two **2 1/2" Clamps** onto the **Muffler** and attach it to the **Passenger Side Extension Pipe** and the **Intermediate Pipe**. Leave the **2 1/2" Clamps** loose enough for some adjustment. **Refer to Figure 6.**



Figure 6

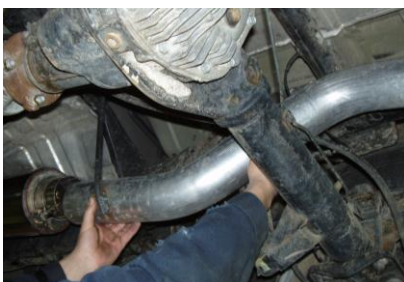

Figure 7



Figure 8



Figure 9



Figure 10

6. Slide a **3" Clamp** over the outlet side of the **Muffler**. Position the **Over Axle Pipe** over the axle and loosely attach it to the **Muffler**. Install the **Over Axle Pipe** hanger into the factory rubber insulator. **Refer to Figure 7.**

7. Slide a **3" Band Clamp** over the **Tail Pipe** and install it onto the **Over Axle Pipe**. Slide the **Tail Pipe** hanger into the rearmost rubber insulator and reattach it to the frame. **Refer to Figure 8.**

8. Install and adjust the **Exhaust Tip** to suit. Using an 8mm Allen wrench, tighten the lock bolt located on the **Exhaust Tip**. **Refer to Figure 9.**

9. Align the exhaust as required. Starting at the front of the exhaust, tighten all clamps and connections.

10. Carefully position the ABS line to provide clearance to the exhaust. **Refer to Figure 10.**

11. Check along the entire length of the exhaust system to ensure that there is adequate clearance around the spare tire, fuel and brake lines, and any wiring. If any interference is detected relocate or adjust.



Congratulations! You are ready to begin experiencing the improved power, sound, and driving experience of your MBRP Inc. performance exhaust system. We know you will enjoy your purchase.