

S5224

1998-2011 FORD RANGER/MAZDA B SERIES, RC/EC 6FT BED, CAT BACK, SINGLE TURN DOWN

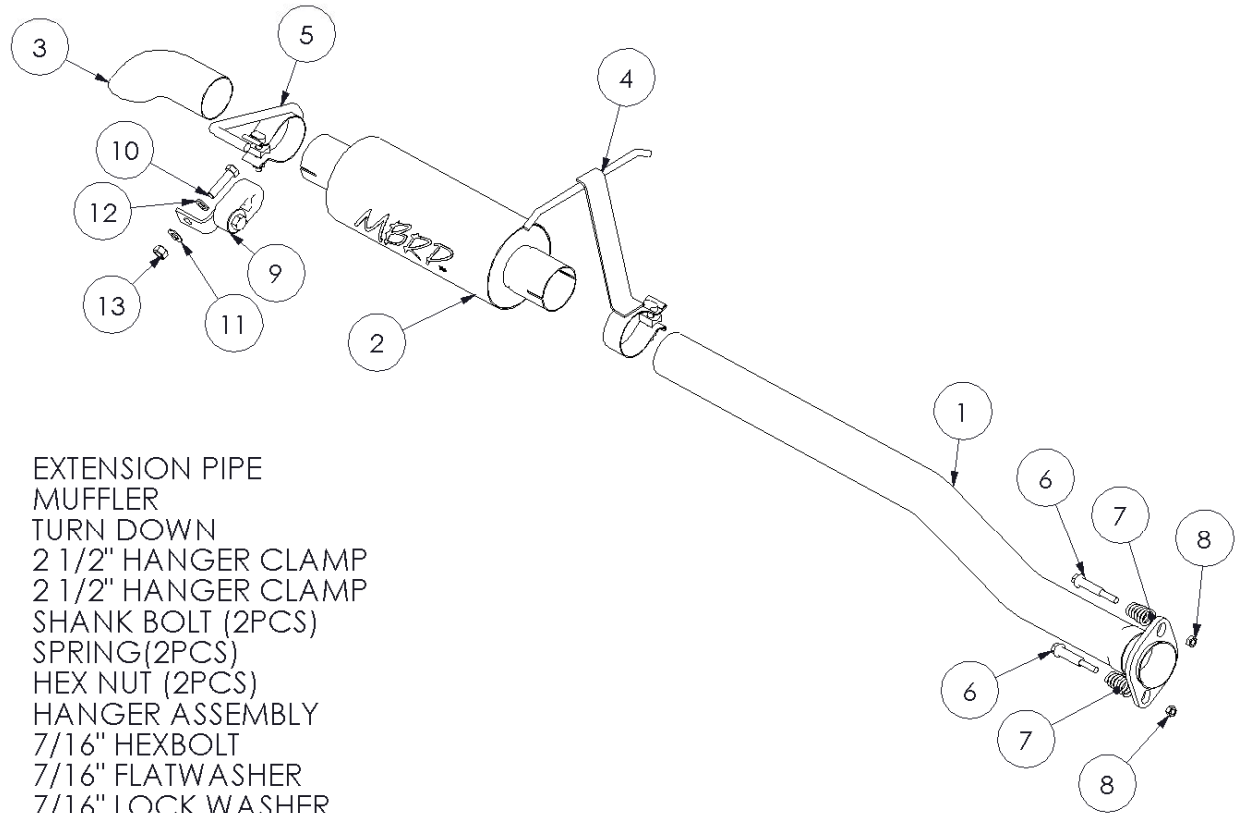

1. EXTENSION PIPE
2. MUFFLER
3. TURN DOWN
4. 2 1/2" HANGER CLAMP
5. 2 1/2" HANGER CLAMP
6. SHANK BOLT (2PCS)
7. SPRING(2PCS)
8. HEX NUT (2PCS)
9. HANGER ASSEMBLY
10. 7/16" HEXBOLT
11. 7/16" FLATWASHER
12. 7/16" LOCK WASHER
13. 7/16" HEX NUT

NOTE:SADDLE CLAMPS USED IN ALUMINIZED VERSION

PLEASE READ BEFORE STARTING INSTALLATION

While MBRP Inc. has made every effort to ensure that all components of this system are of superior quality and properly packaged, it is the installer's responsibility to ensure the following before removal of the factory exhaust:

- that ALL components shown above are present.
- that ALL mating components fit together.
- that there are no damaged components.
- that the system you have purchased is appropriate for your vehicle year, model and configuration.
- that the system will not interfere with any modifications previously installed or planned.
- that you have read and understand these instructions.

If you have any questions or are uncertain about any aspect of the installation of this system to your vehicle please contact your dealer before commencing installation.



Removal of Stock System

1. Apply a penetrating lubricant liberally to all exhaust fasteners, hangers and rubber insulators.
2. Remove the bolts and springs holding the front flange together and disconnect the exhaust system. **Refer to Figure 1.**
3. Remove the hangers from the rubber insulators and remove the exhaust from the vehicle. **Refer to Figures 2 & 3.**



Figure 1



Figure 2

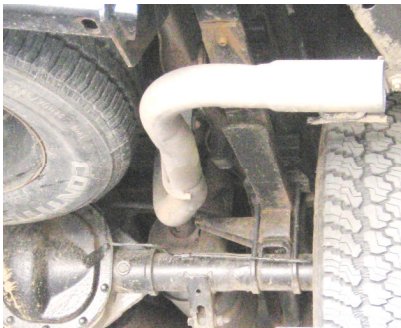

Figure 3

Installation of MBRP Inc. Performance Exhaust:

1. Loosely attach the **Extension Pipe** to the flange using the **Shank Bolts** and **Springs** provided. **Refer to Figure 4.**
Note: The **Extension Pipe** will need to be trimmed on some models. Refer to the illustration below.



Figure 4

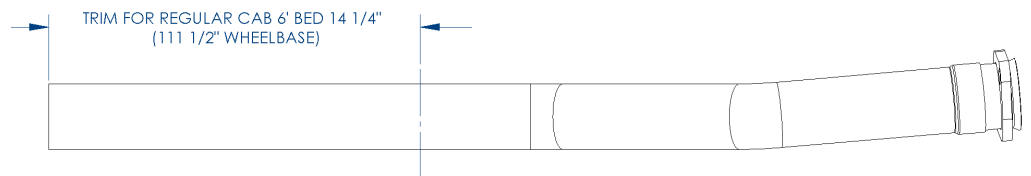

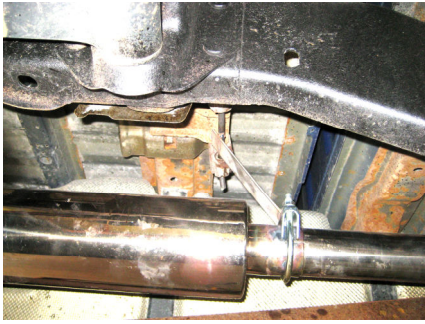

Figure 5

2. Install the Muffler onto the Extension Pipe using the **Hanger Clamp** provided. Then install the **2 ½” Hanger Clamp** into the factory rubber insulator. Do not tighten the clamp at this time. **Refer to Figure 5.**



Figure 6

3. Loosely install the **Turn Down** connecting it to the **Muffler** outlet with the **2 ½” Hanger Clamp**. Install the **Hanger Assembly** to the **2 ½” Hanger Clamp** and to an existing hole in the frame using the fasteners provided. **Refer to Figures 6 & 7.**

4. Ensure that the exhaust is properly in place before tightening clamps. Start at the front of the exhaust system and begin tightening all connections.



Figure 7

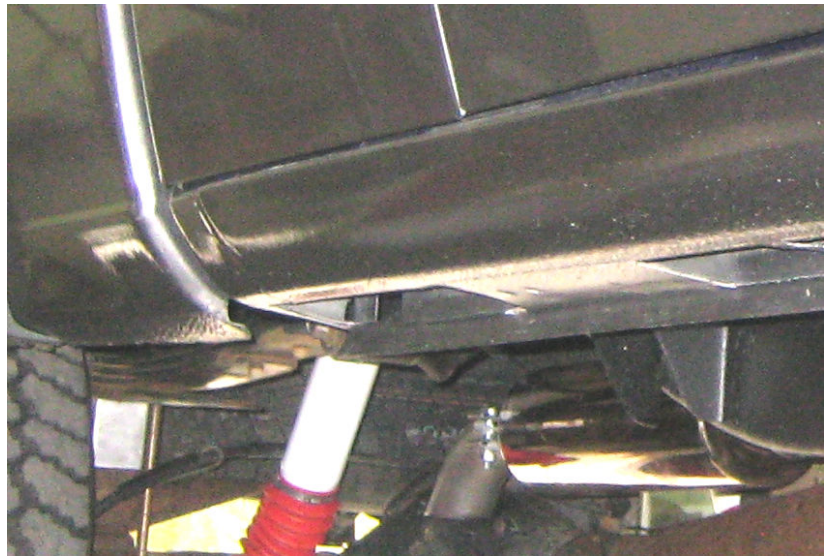

Congratulations! You are ready to begin experiencing the improved power, sound and driving excitement of your MBRP Inc. performance exhaust system. We know you will enjoy your purchase.