

S5092

2019-UP CHEV/GM 1500 SERIES, 4.3L & 5.3L PRE-AXLE DUAL SIDE EXIT, EXCLUDING REGULAR CAB SHORT BOX

MBRP INC.
PERFORMANCE EXHAUST

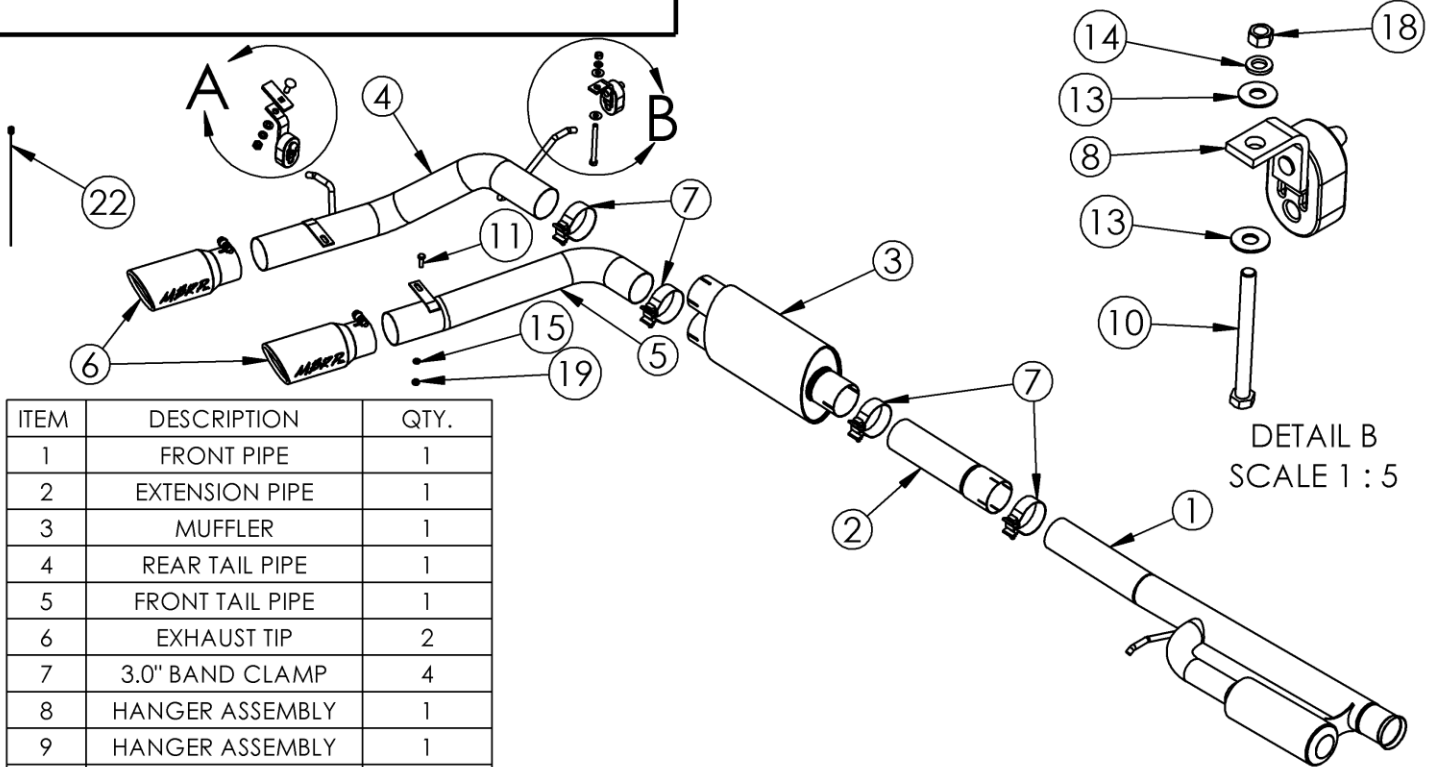

ITEM	DESCRIPTION	QTY.
1	FRONT PIPE	1
2	EXTENSION PIPE	1
3	MUFFLER	1
4	REAR TAIL PIPE	1
5	FRONT TAIL PIPE	1
6	EXHAUST TIP	2
7	3.0" BAND CLAMP	4
8	HANGER ASSEMBLY	1
9	HANGER ASSEMBLY	1
10	3/8" HEX BOLT X 4"	1
11	5/16" HEX BOLT X 1"	1
12	M10 CARRIAGE BOLT	1
13	3/8" FLAT WASHER	2
14	3/8" LOCK WASHER	1
15	5/16" LOCK WASHER	1
16	M10 FLAT WASHER	1
17	M10 LOCK WASHER	1
18	3/8" HEX NUT	1
19	5/16" HEX NUT	1
20	M10 HEX NUT	1
21	BOLT SPACER	1
22	BOLT LEADER	1

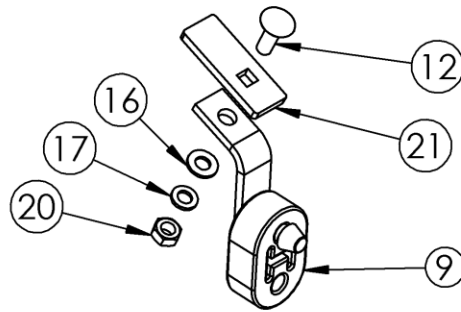

DETAIL A
SCALE 1 : 5

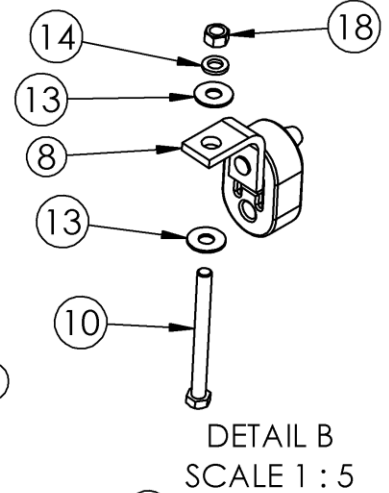

DETAIL B
SCALE 1 : 5

PLEASE READ BEFORE STARTING INSTALLATION

While MBRP Inc. has made every effort to ensure that all components of this system are of superior quality and properly packaged, it is the installer's responsibility to ensure the following before removal of the factory exhaust:

- that ALL components shown above are present.
- that ALL mating components fit together.
- that there are no damaged components.
- that the system you have purchased is appropriate for your vehicle year, model and configuration.
- that the system will not interfere with any modifications previously installed or planned.
- that you have read and understand these instructions.

Removal of Stock System

1. Apply penetrating lubricant liberally to all exhaust fasteners, hangers and rubber insulators. Lower the spare tire and remove the heat shield.

Refer to Figure 1.

2. Remove the clamp after the catalytic converter and save the clamp for the installation.

Refer to Figure 2.

3. Remove the hangers from the rubber insulators and remove the exhaust from the vehicle. The rear suspension will need to be relaxed to allow the factory exhaust to be removed without cutting it.



Figure 1

Installation of MBRP Inc. Performance Exhaust:

1. The **Front Pipe** will not need cutting for the Crew Cab short bed or the Crew Cab long bed. For the Regular Cab long box 7.5" need to be cut off the **Front Pipe**

Refer to Figure 4.



Figure 2

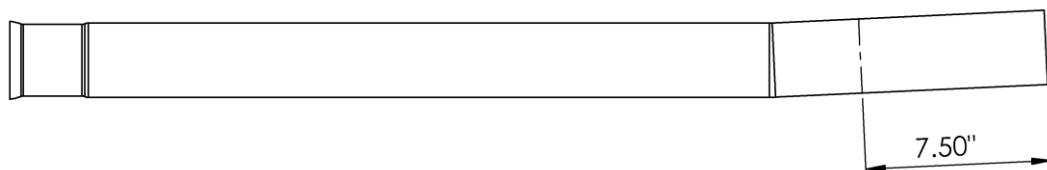

Figure 4

2. Once cut to the correct length loosely attach the **Front Pipe** onto the catalytic converter and into the rubber insulator.

Refer to Figure 3.

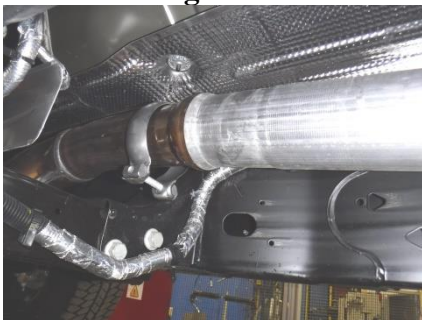

Figure 3

3. For Crew Cab Long Box vehicles using a 3" **Clamp** install the **Extension Pipe** onto the **Front Pipe**.

4. Using the 3" **Clamp**, loosely install the **Muffler** onto the **Front Pipe** or **Extension Pipe** if used at approximately a 90 degree angle.

Refer to Figure 5.



Figure 5



Figure 6

5. Slide the **3/8" Hex Bolt X 4"** onto the **3/8" Flat Washer** and the 90 degree bend **Hanger Assembly**. Slide them through the hole in the frame above the muffler and secure it with the **3/8" Lock Washer** and **3/8" Nut**.
Refer to Figures 6.

6. Slide the **Bolt Spacer** onto the **Bolt Leader** and then thread **M10 Carriage Bolt** onto it. Fish the **Bolt Spacer** and **M10 Carriage Bolt** through the frame (Arrow in Figure 8). Install the remaining **Hanger Assembly** onto the **M10 Carriage Bolt** using the **M10 Flat Washer**, **M10 Lock Washer** and **M10 Hex Nut**.

Refer to Figure 7.

7. Using a **3" Clamp**, install the **Front Tail Pipe** into the **Muffler**.

8. Using a **3" Clamp**, install the **Rear Tail Pipe** into the **Muffler** and the two **Hanger Assemblies**, keeping the mounting tab below the **Front Tail Pipe** mounting tab and attaching with the supplied **5/16" Bolt**, **5/16 Lock & Flat Washer** and **5/16 Nut**.

Refer to Figure 8 and Page 1.

9. Install the **Exhaust Tips** and adjust to your liking.

Refer to Figure 8.

10. Re-install the heat shield and raise the spare tire into position.

11. Tighten all hardware, tips and clamps, starting at the front and working rearward to secure the system. Ensure the **Front Pipe Hanger** is level where it passes through the rubber insulator. Check along the full length of the exhaust system to ensure there is adequate clearance for fuel lines, brake lines, frame, bodywork, suspension and any wiring, etc. If there is any interference detected, relocate or adjust to provide adequate clearance.



Figure 7



Figure 8



Congratulations! You are ready to begin experiencing the improved power, sound and driving experience of your *MBRP Inc.* performance exhaust system. We know you will enjoy your purchase.