

# S5064

2007-2010 GMC SIERRA DENALI,  
SILVERADO 1500, 6.2L V8, EXTENDED  
CAB 6.5' BOX / CREW CAB, CAT  
BACK, SINGLE

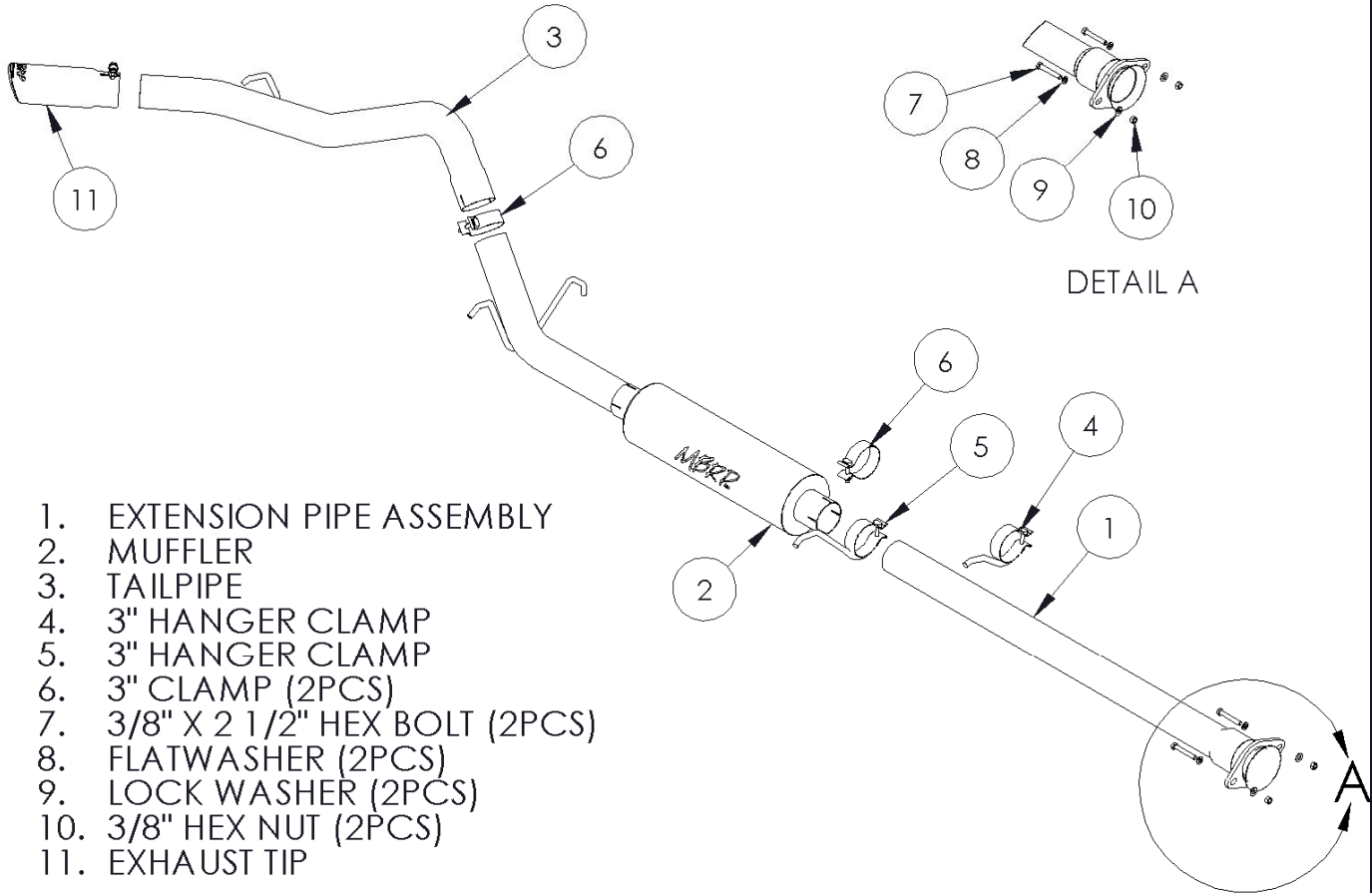

1. EXTENSION PIPE ASSEMBLY
2. MUFFLER
3. TAILPIPE
4. 3" HANGER CLAMP
5. 3" HANGER CLAMP
6. 3" CLAMP (2PCS)
7. 3/8" X 2 1/2" HEX BOLT (2PCS)
8. FLATWASHER (2PCS)
9. LOCK WASHER (2PCS)
10. 3/8" HEX NUT (2PCS)
11. EXHAUST TIP

NOTE : CLAMPS 4 AND 6 ARE USED FOR 2010 MODELS  
SADDLE CLAMPS ARE USED IN ALUMIMINIZED SYSTEMS

## PLEASE READ BEFORE STARTING INSTALLATION

**While MBRP Inc. has made every effort to ensure that all components of this system are of superior quality and properly packaged, it is the installer's responsibility to ensure the following before removal of the factory exhaust:**

- that ALL components shown above are present.
- that ALL mating components fit together.
- that there are no damaged components.
- that the system you have purchased is appropriate for your vehicle year, model and configuration.
- that the system will not interfere with any modifications previously installed or planned.
- that you have read and understand these instructions.

If you have any questions or are uncertain about any aspect of the installation of this system to your vehicle please contact your dealer before commencing installation.



**Figure 1**



**Figure 2**



**Figure 3**



**Figure 4**

### **Removal of stock system:**

1. Apply a penetrating lubricant liberally to all exhaust fasteners, hangers and rubber insulators.
2. Remove the nuts from the studs holding the front flange together and disconnect exhaust system. **Refer to Figure 1.**
3. Remove the hangers from the rubber insulators and remove the exhaust from the vehicle.
4. If a hoist or hydraulic lift is not being used the tail pipe may need to be cut to clear the rear axle. **Refer to Figure 2**
5. The studs located in the exhaust flange must be removed. This can be accomplished using a hammer. The studs will be replaced by hardware supplied with the system.

### **Installation of MBRP Inc. Performance Exhaust:**

1. Loosely attach the **Extension Pipe** to the flange using the fasteners provided. Attach the **Extension Pipe** hangers to the rubber insulators located on the frame. **Refer to Figure 3.**
2. Slide a **3" Hanger Clamp** and a **3" Clamp** if required onto the rear of the **Extension Pipe**. Install the **Muffler** onto the **Extension Pipe** and install the hangers into the factory rubber insulator located above the rear of the **Muffler**. **Refer to Figure 4.**



**Figure 5**

3. Slide a **3” Clamp** onto the rear of the **Muffler**. Feed the **Tail Pipe** over the axle and loosely attach it to the **Muffler**. Refer to **Figure 5**.

4. Install the **Tail Pipe** hanger into the factory rubber insulator located directly above the hanger. Refer to **Figure 5**.

5. Install and adjust the Exhaust Tip to suit. Using a 17mm wrench tighten the lock bolt located on the **Exhaust Tip**. Refer to **Figure 6**.



**Figure 6**

6. Align the exhaust as required. Starting at the front of the exhaust, tighten all clamps and connections.

7. Check along the whole length of the exhaust system to ensure that there is adequate clearance around the spare tire, fuel and brake lines or any wiring. If any interference is detected relocate or adjust.



**Congratulations!** You are ready to begin experiencing the improved power, sound and driving excitement of your MBRP Inc. performance exhaust system. We know you will enjoy your purchase.