

S4901

2017-2021 HONDA CIVIC, TYPE R, 2.0L,
CAT-BACK, 3.0", TRIPLE CENTER OUTLET

MBRP®

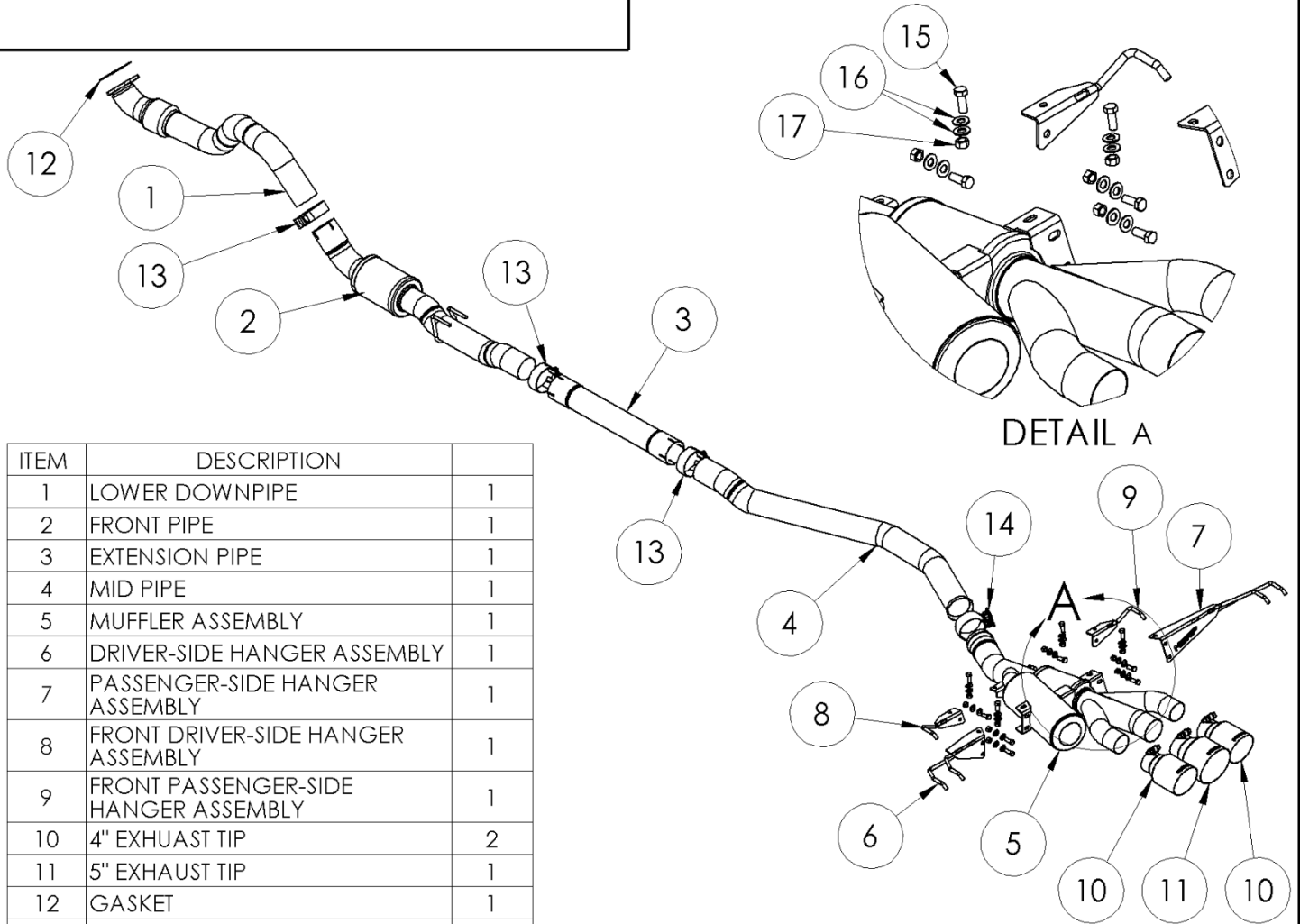

ITEM	DESCRIPTION	
1	LOWER DOWNPIPE	1
2	FRONT PIPE	1
3	EXTENSION PIPE	1
4	MID PIPE	1
5	MUFFLER ASSEMBLY	1
6	DRIVER-SIDE HANGER ASSEMBLY	1
7	PASSENGER-SIDE HANGER ASSEMBLY	1
8	FRONT DRIVER-SIDE HANGER ASSEMBLY	1
9	FRONT PASSENGER-SIDE HANGER ASSEMBLY	1
10	4" EXHUAUST TIP	2
11	5" EXHAUST TIP	1
12	GASKET	1
13	3.0" CLAMP	3
14	3.0" SWIVEL CLAMP	1
15	3/8" X 1" HEX BOLT	10
16	3/8" FLAT WASHER	20
17	3/8" HEX NUT	10

PLEASE READ BEFORE STARTING INSTALLATION

While MBRP has made every effort to ensure that all components of this system are of superior quality and properly packaged, it is the installer's responsibility to ensure the following before removal of the factory exhaust:

- that ALL components shown above are present.
- that ALL mating components fit together.
- that there are no damaged components.
- that the system you have purchased is appropriate for your vehicle year, model and configuration.
- that the system will not interfere with any modifications previously installed or planned.
- that you have read and understand these instructions.

If you have any questions or are uncertain about any aspect of the installation of this system to your vehicle please contact your dealer before commencing installation.

MBRP



Figure 1



Figure 2



Figure 3



Figure 4



Figure 5

Removal of Stock System

1. Apply penetrating lubricant liberally to all exhaust fasteners, hangers, and rubber isolators.
2. Remove the heat shield at the front of the vehicle. It is helpful to remove the rear fasteners from the plastic under tray to allow better access to the front pipe fasteners.
Refer to Figure 1.
3. Un-bolt the rear of the OEM cat-back from the front pipe.
Refer to Figure 2.
4. Remove the clips holding the bumper liner at the rear of the car on both sides so it may be folded down to make room for the outside exhaust hangers to drop down.
Refer to Figure 3.
5. Disconnect all rubber isolators and remove the rear of the factory exhaust. It is recommended to have a support under the exhaust or a second person to assist in this step.
6. Un-bolt the front pipe from the down pipe. Remove the rubber isolator from the hanger on the vehicle. Pull the front pipe back from the down pipe, then remove the front pipe towards the front of the vehicle. The rear flange is a tight fit but can be removed with some rotation and gentle pulling without damaging the heat shielding.
Refer to Figures 4 and 5.

Retain all rubber isolators as they will be reused.

Installation of MBRP Performance Exhaust

1. Install the new 3.0" **Lower Downpipe** over the steering rack and into the factory rubber isolator. Secure the flange to the downpipe using the OEM hardware and the supplied Gasket.
Refer to Figure 6.
2. Install the OEM dual rubber isolator onto the **Front Pipe** hangers and slide it all the way to the inlet side of the hangers. Using a **3" Band Clamp**, install the **Front Pipe** onto the **Lower Downpipe**. Slide the dual rubber isolator onto the factory chassis hanger.
Refer to Figures 7 and 8.
3. Install the **Extension Pipe** and **Mid Pipe** using **3" Band Clamps**
4. Install the rear **Driver-side Hanger Assembly** and **Passenger-side Hanger Assembly** (dual hangers) into the outermost OEM rubber isolators at the rear of the vehicle. Re-install the bumper liners. Rotate the brackets downward to leave room for the **Muffler Assembly** to be installed.

MBRP



Figure 6



Figure 7

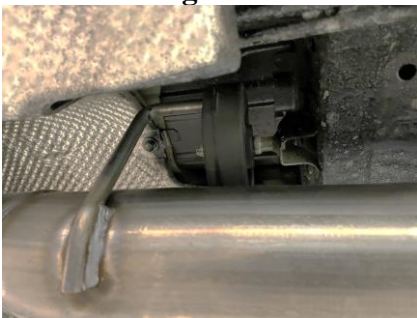

Figure 8

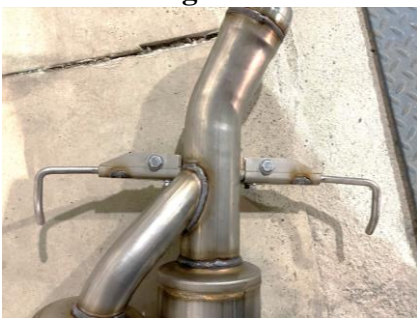

Figure 9



Figure 10

5. Install the **Front Driver-side Hanger Assembly** and **Front Passenger-side Hanger Assembly (single hanger)** onto the **Muffler Assembly** using the supplied hardware.

Refer to **Figure 9**.

6. Install the **Muffler Assembly** into the factory rubber isolators below the cross member with the previously assembled **Front Driver-side Hanger Assembly** and **Front Passenger-side Hanger Assembly**. Secure it to the **Mid Pipe** with the **3" Swivel Clamp**.

7. Attach the **Muffler Assembly** to the **Driver-side Hanger Assembly** and **Passenger-side Hanger Assembly** using the supplied hardware. Leave the Hardware loose enough for adjustment.

Refer to **Figure 10**.

8. Install the **Exhaust Tips** onto the outlets of the **Muffler Assembly** and adjust to your preference utilizing the **3" Swivel Clamp** joint and the slotted holes in the **Driver-side Hanger Assembly** and **Passenger-side Hanger Assembly**.

9. Tighten all hardware and clamps, starting at the front and working rearward to secure the system. Check along the full length of the exhaust system to ensure there is adequate clearance for fuel lines, vent lines, brake lines, frame, bodywork, suspension, and any wiring, etc. If there is any interference detected, relocate, or adjust to provide adequate clearance. Ensure all clamp connections are secure and components are unable to rotate or slide. Band clamps require approximately 45 lb-ft (60 N-m) of torque. Verify clearances, system security and band clamp torque after 30-60 miles (50-100 km) of driving.

Congratulations! You are ready to begin experiencing the improved power, sound and driving experience of your **MBRP** Performance Exhaust. We know you will enjoy your purchase!

