

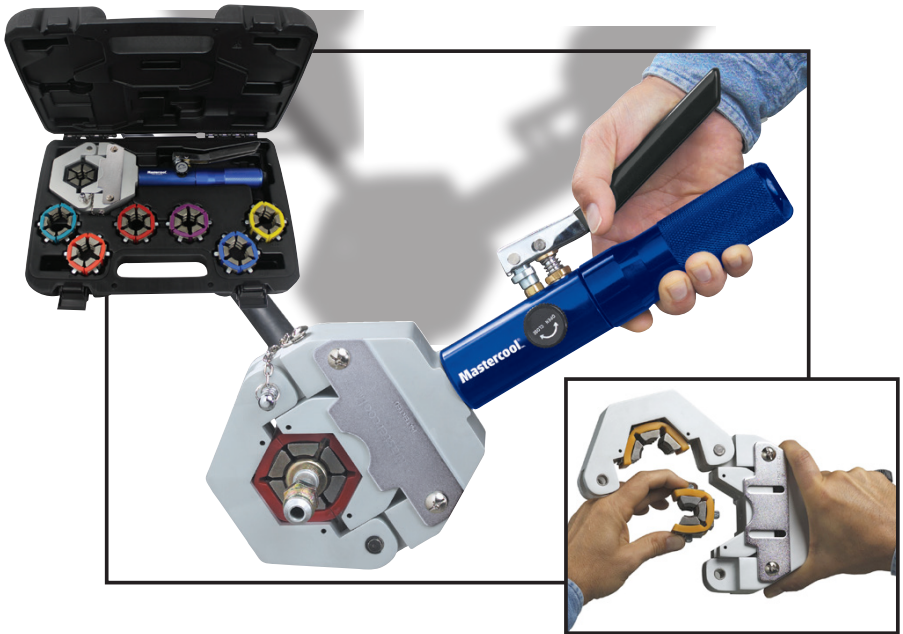

Mastercool[®]
"World Class Quality"

Instruction Manual
71500-A HYDRA-KRIMP



HYDRA-KRIMP

PRE-OPERATION SET-UP

- Open the relief valve to fully recess the piston. Then, close tightly.
- Rotate the yoke fully counter clockwise to bottom out the adapter seat.
- READY TO GO!

OPERATING INSTRUCTIONS

WARNING: DO NOT actuate the piston without having a hose and fitting in place to crimp. This could cause damage to the tool. BE CAREFUL not to place hands near any pinch point while using the tool!

1. Remove pin and “Open” top yoke.
***Note: It may be necessary to turn body counter clockwise until top yoke can be rotated away from piston.**
2. Select correct die set. (Either measure or get the information from the manufacturer.)
***Note: Be sure to use correct size die set! Failure to do so could cause leakage or failure of the crimp!**
3. Insert dies into yoke.
4. Position fitting and hose in crimper and close top yoke.
5. Insert pin securely
***Note: Make sure pin snaps into place and is secure before crimping process is started.**
6. a. Turn body of tool clockwise until dies are snug against hose fitting.
b. Now turn pump body counter-clockwise (2-3 turns) to create ca. 2 mm space between yoke edge and rim of pump body. Failure to observe this may cause damage to pump body.
7. Turn hydraulic valve to “closed” position.
8. Pump handle to crimp fitting onto hose. Continue pumping until handle comes to a stop.
***Note: Place the body of the tool against a solid body to create more leverage during the crimping process.**
9. Once crimp is complete, turn hydraulic valve to “OPEN” position.
10. Turn body of tool counter clockwise until top yoke can be rotated away from piston portion of yoke.
11. Remove holding pin and open yoke.
12. Remove hose assembly.

