

RAM PROMASTER CITY

SHELVING MODULES INSTALLATION INSTRUCTIONS

Recommended Tools



AIR / HAND RATCHET



Drill



7/16" SOCKET
M13 SOCKET



7/16" COMBO WRENCH
M13 COMBO WRENCH



3/8" DRILL BIT



TORQUE WRENCH

Hardware



1/4-20 x 1.75
HH BOLT GR8



1/4-20 x .75
HWH BOLT GR5



1/4-20 x 1.25
HWH BOLT GR8



M8 x 1.25 x 35
HWH BIK. Zinc



1/4
Lock Washer



M8
Lock Washer



1/4
Flat Washer



M8
Flat Washer



1/4-20
E-Stop Nut



#SRT25PB280
PRE-BULB PLUSNUT

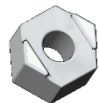

Plusnut
Tool



Floor Spacer

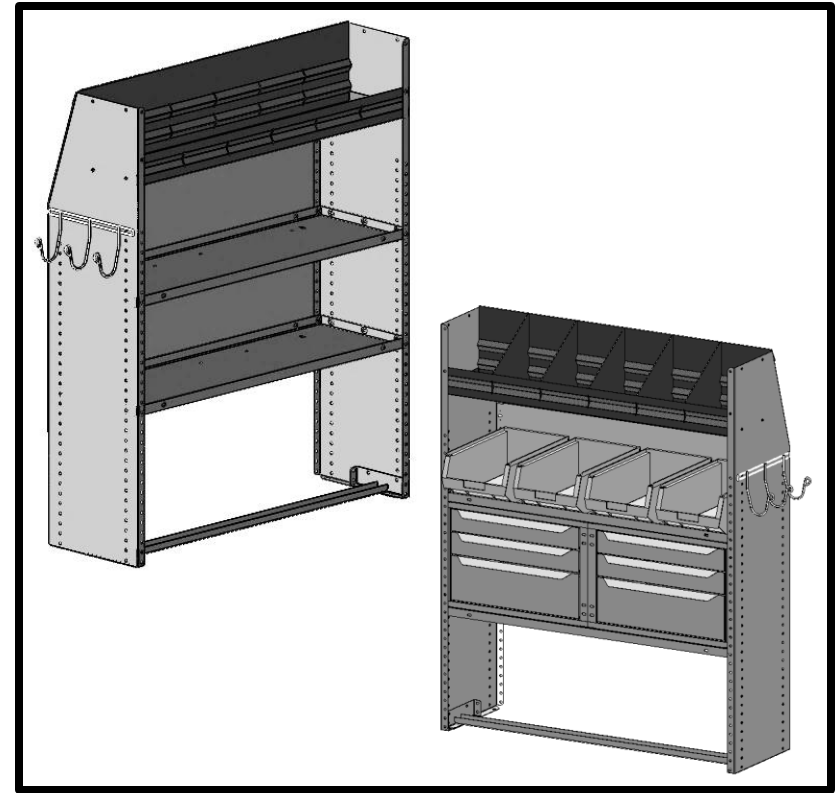

02J642KP RACKS & BINS PACKAGE

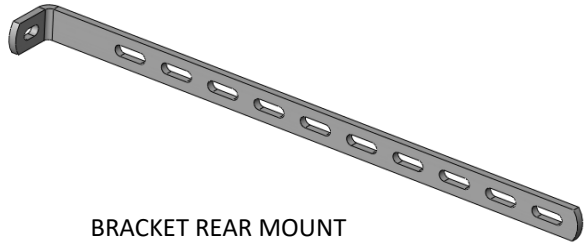

BRACKET REAR MOUNT
P/N – M831860ZN

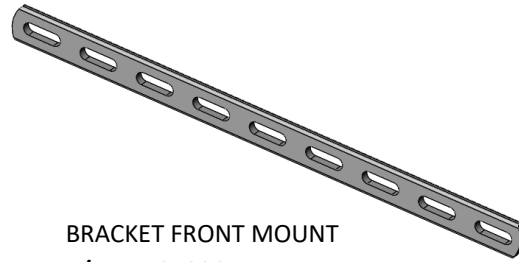

BRACKET FRONT MOUNT
P/N – M940064

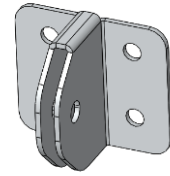

T-BRACKET FRONT MOUNT
P/N – 025483

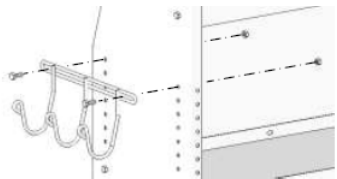
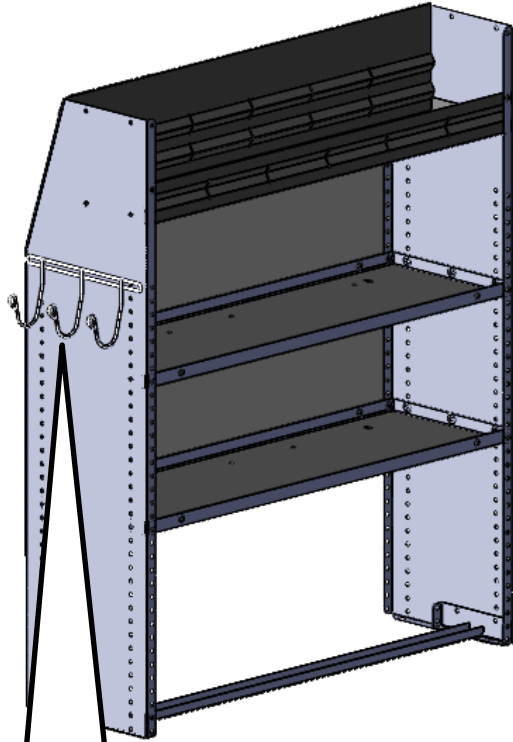

Position **Triple Hook** at the desired location, and secure to Upright using:
 (2) 1/4-20 x 3/4 Hex Head Screws
 (2) 1/4-20 E-Stop Nuts

ON MODULE 02B967KP CURB SIDE
TRIPLE HOOK
MOUNTS TO THE RIGHT UPRIGHT

TORQUE SETTING:
 Size - 1/4 = 7-9.5 Ft.-Lbs.

**ATTACHING
TOOL DROP TRAY**

See page 10
 (Attaching Side Mounting Bracket)

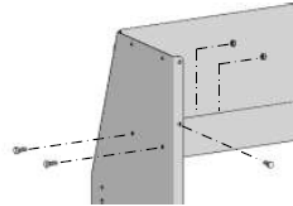

Attach Tool Drop Tray as shown, using:
 (6) 1/4-20 x 3/4 Hex Head Screws
 (6) 1/4-20 E-Stop Nuts

**ATTACHING
BOTTOM SHELF**

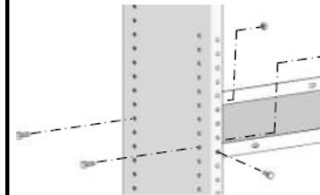

Position Middle Shelf at 27th hole location from bottom as shown, and secure to Uprights using:
 (6) 1/4-20 x 3/4 Hex Head Screws
 (6) 1/4-20 E-Stop Nuts

**ATTACHING
MIDDLE SHELF**

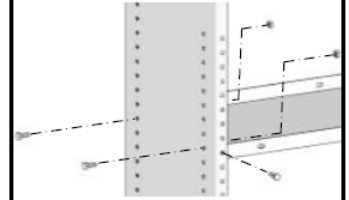

Position Bottom Shelf at 16th hole location from bottom as shown, and secure to Uprights using:
 (6) 1/4-20 x 3/4 Hex Head Screws
 (6) 1/4-20 E-Stop Nuts

**ATTACHING
FLOOR ATTACHMENT**

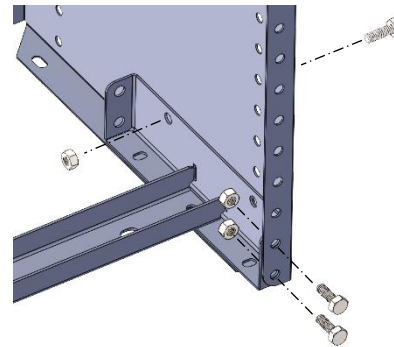

Secure Floor Attachment as shown here using:
 (6) 1/4-20 x 3/4 Hex Head Screws
 (6) 1/4-20 E-Stop Nuts



ASSEMBLING MODULES

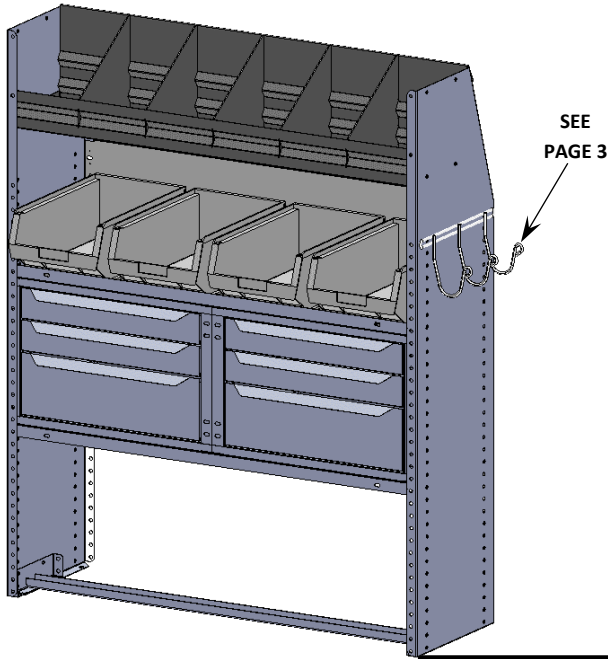

ATTACHING TOOL DROP TRAY
See page 10
(Attaching Side Mounting Bracket)

Attach Tool Drop Tray as shown, using:
(6) 1/4-20 x 3/4 Hex Head Screws
(6) 1/4-20 E-Stop Nuts

ATTACHING BOTTOM SHELF

Position Bottom Shelf inverted (With flanges facing down) at 13th hole location from bottom as shown, and secure to Uprights using:
(6) 1/4-20 x 3/4 Hex Head Screws
(6) 1/4-20 E-Stop Nuts

TORQUE SETTING:
Size - 1/4 = 7-9.5 Ft.-Lbs.

ATTACHING FLOOR ATTACHMENT

Secure Floor Attachment as shown here using:
(6) 1/4-20 x 3/4 Hex Head Screws
(6) 1/4-20 E-Stop Nuts

ATTACHING 3 DRAWER CABINETS

1 Place the (2) J-Clip Nuts over the top most and bottom most slots of both cabinets as shown.

2 Place Cabinets on the shelf, and secure using:
(4) 1/4-20 x 3/4 Hex Head Screws
(4) 1/4-20 E-Stop Nuts

1

NOTE: BOTTOM DRAWERS REMOVED TO ACCESS MOUNTING HOLES

2

INSTALLATION EXAMPLE SECURING TO FLOOR

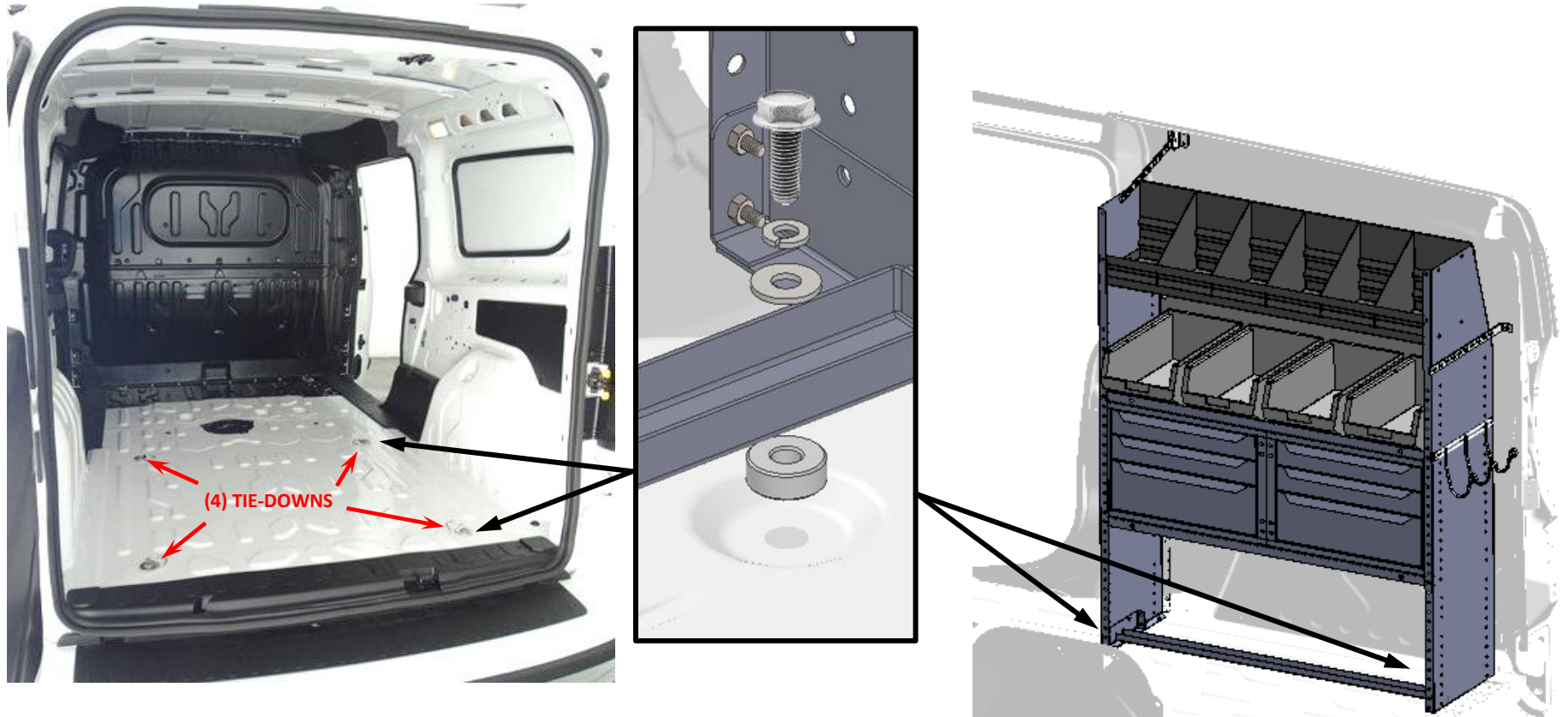

***** LOCATE AND REMOVE 4 TIE-DOWNS FROM VAN FLOOR. (TWO PER SIDE)**

SECURE MODULE TO THE FLOOR OF THE VEHICLE INTO THOSE EXISTING THREADS IN THE FLOOR.
AS SHOWN HERE USING;

- (2) M8 x 35 HWH Screws
- (2) M8 Flat Washers
- (2) M8 Flat Washers
- (2) Floor Spacers

REPEAT MOUNTING FOR OTHER SIDE

TORQUE SETTING:
Size – M8 = 20-27 NM

INSTALLATION EXAMPLES

SECURING T-BRACKET

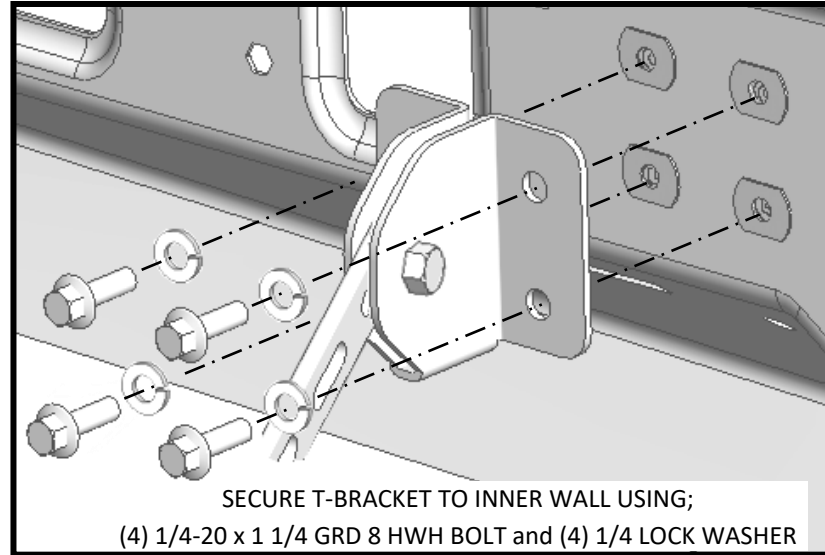
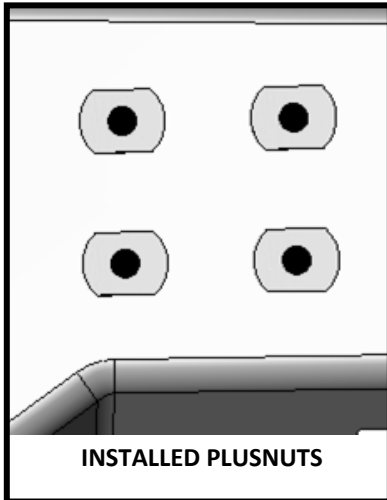
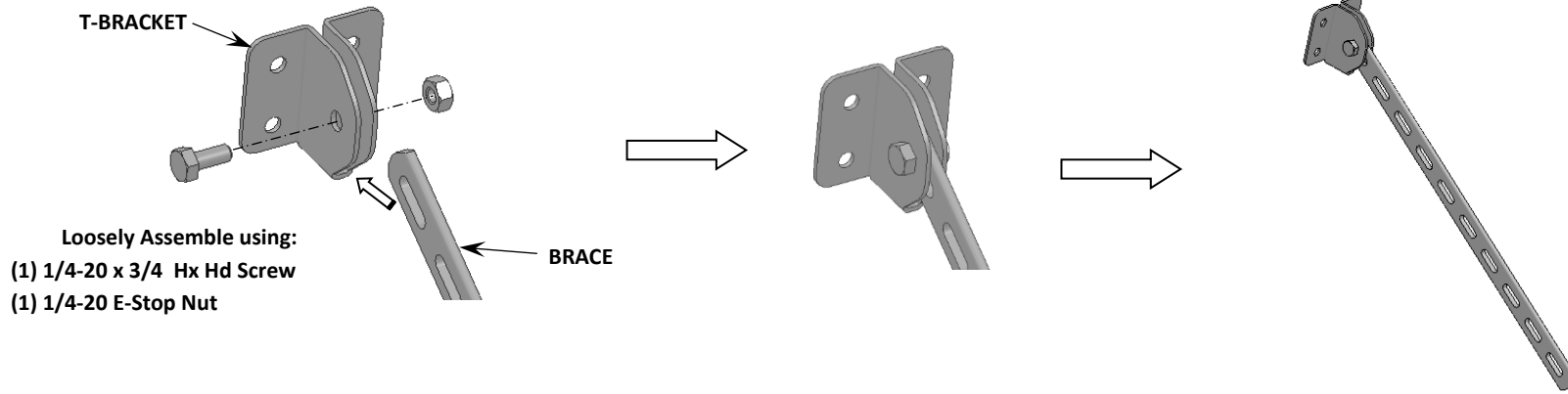

TORQUE SETTING:
Size - 1/4 = 7 - 9.5 Ft.-Lbs.

INSTALLATION EXAMPLES

SECURING TO THE WALL



**STREETSIDE
REAR**

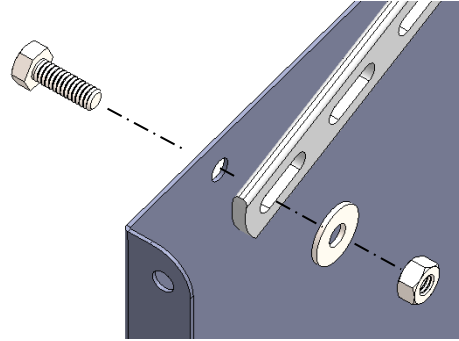

- SECURE TO MODULE USING:**
- (1) 1/4-20 x 3/4 Hex Hd. Screw
 - (1) 1/4 Flat Washer
 - (1) 1/4-20 E-Stop Nut

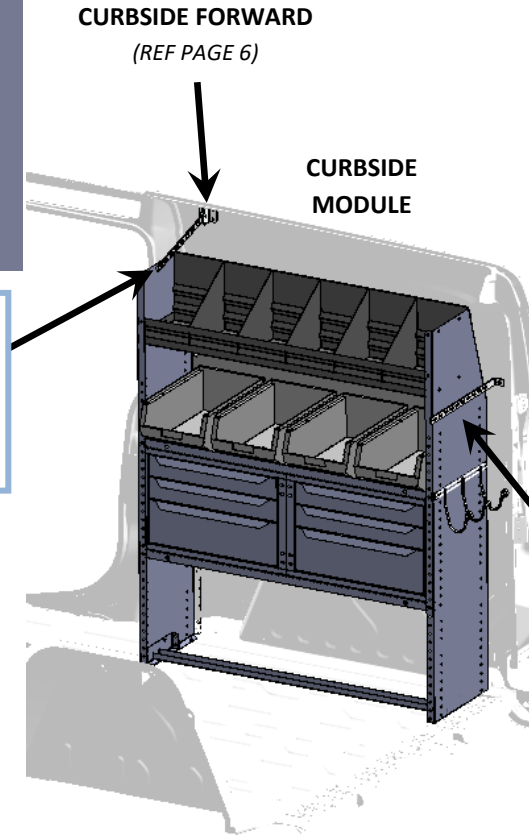

CURBSIDE FORWARD
(REF PAGE 6)

**CURBSIDE
MODULE**



**CURBSIDE
REAR**

- SECURE TO MODULE USING:**
- (2) 1/4-20 x 3/4 Hex Hd. Screw
 - (2) 1/4 Flat Washer
 - (2) 1/4-20 E-Stop Nut

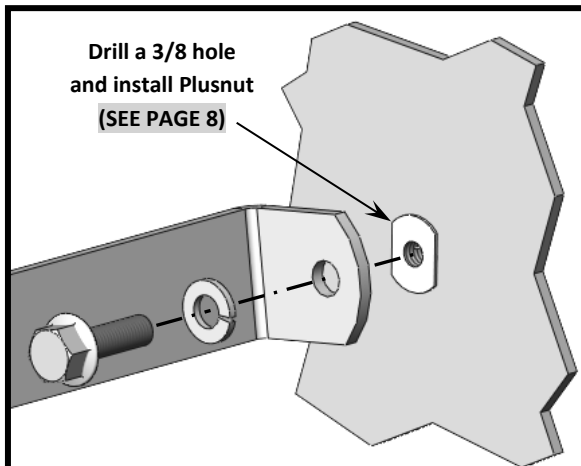

Drill a 3/8 hole
and install Plusnut
(SEE PAGE 8)

SECURING MODULE TO THE WALL OF THE VEHICLE

- (1) 1/4-20 Plus-nut @ Existing Hole
- (1) 1/4-20 x 1-1/4 Hex Hd. Screw
- (1) 1/4 Lock Washer

TORQUE SETTING:
Size - 1/4 = 7 - 9.5 Ft.-Lbs.

STOP **BEFORE DRILLING** **STOP**
CHECK ALL MOUNTING LOCATIONS TO PREVENT PENETRATING
GAS LINES, GAS TANKS, BRAKE LINES, WIRING OR ANY OTHER STRUCTURE OF VEHICLE

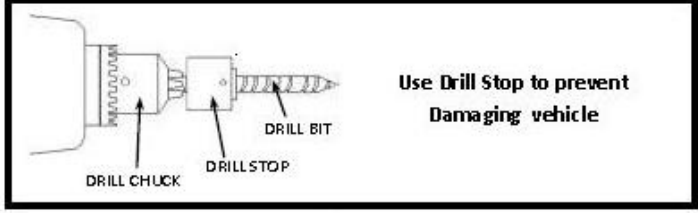

The Plusnut® is pre-bulbed for easy installation

1

The Plusnut® is pre-assembled with hex cap and hex bolt. Then it is inserted into a pre-drilled hole

2

As the bolt is tightened, the Plusnut® upsets and provides outstanding blind fastening holding power

3

C-500 tool tightens bolt thru hex head cap into Plusnut®. A ratchet, open-end or closed -end wrench can be used.

4

Fully upset Plusnut® provides a reliable nut plate for fastening.

5