

## Recommended Tools

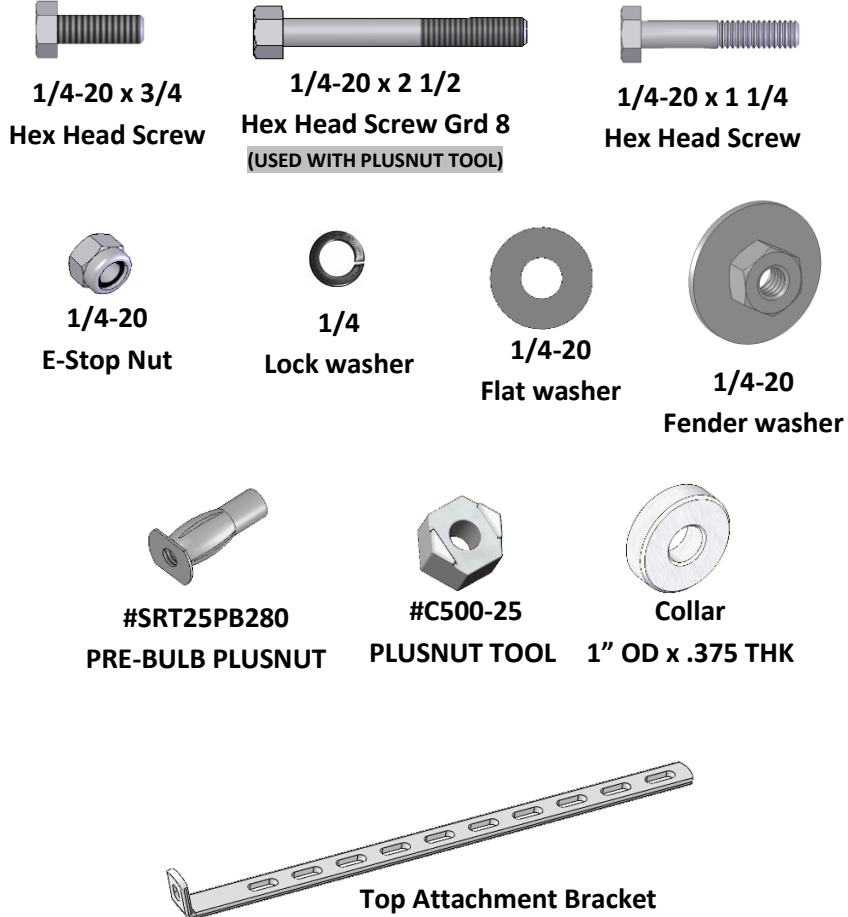

## Hardware



**SOLID END SHELVING MODULES**

**EXPLODED VIEW**

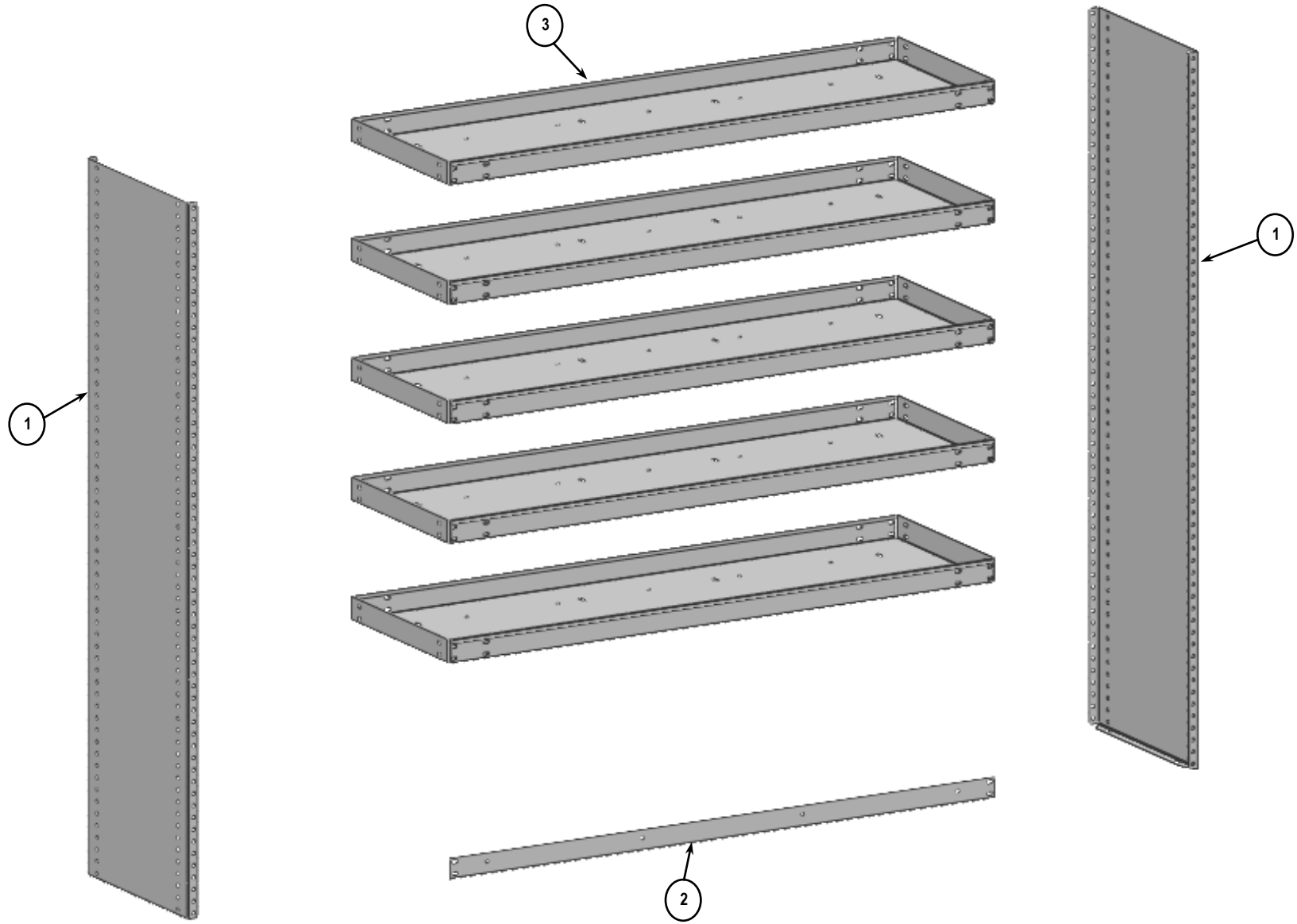

**COMPONENTS**

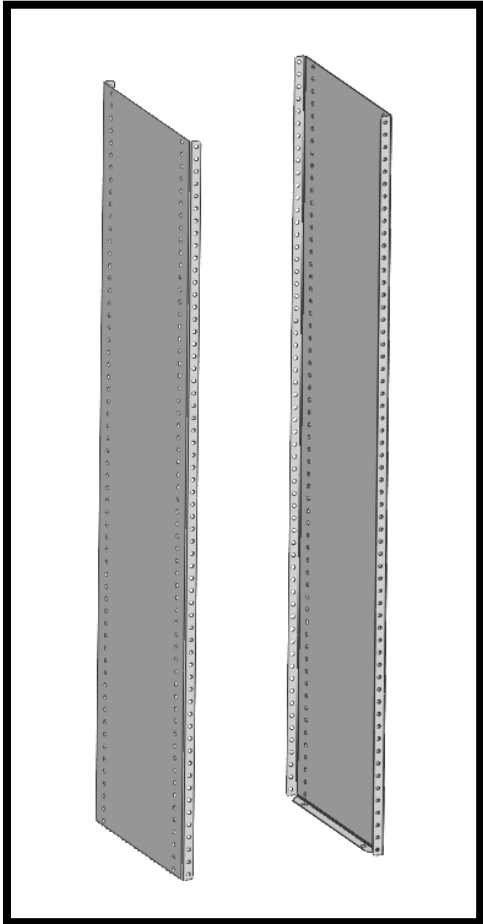

1 SOLID END UPRIGHT (SET OF 2)

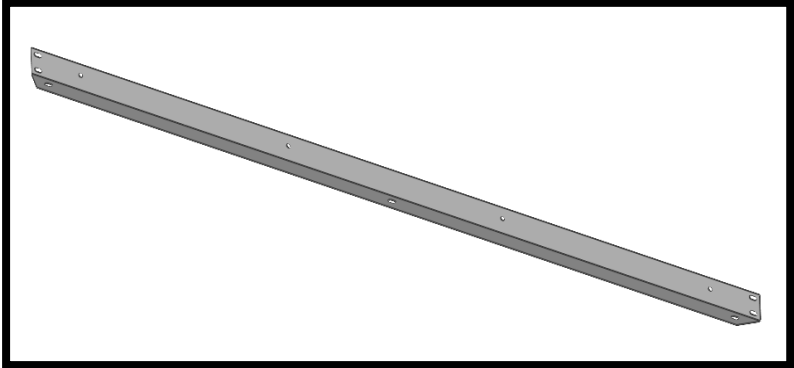

2 FLOOR BRACE

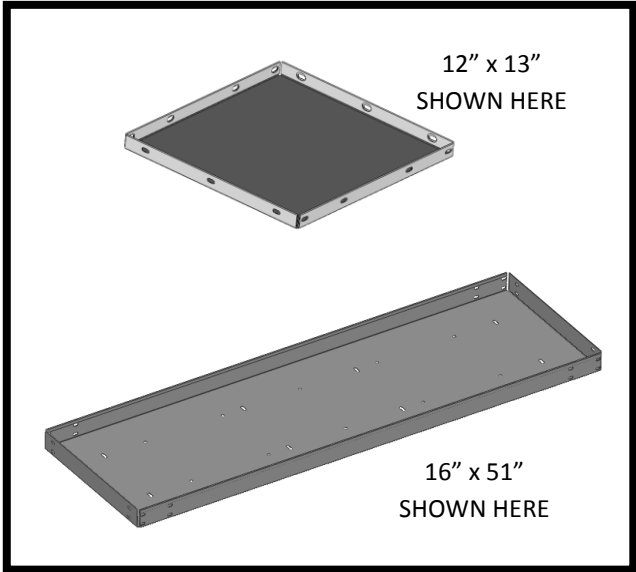

3 METAL SHELF

<b>SHELVING MODULE</b>	<b>UPRIGHTS</b> <i>(SET OF 2)</i> ①	<b>FLOOR BRACE</b> ②	<b>METAL SHELF</b> ③
022842KP [28H x 13W x 12D]	022348KP		021377KP – QTY. 3
022836KP [36H x 13W x 12D]	022347KP		021377KP – QTY. 3
022826KP [46H x 13W x 12D]	025367KP		021377KP – QTY. 3
027562KP [60H x 13W x 12D]	026438KP		021377KP – QTY. 5
022841KP [28H x 19W x 12D]	022348KP	023055KP	021378KP – QTY. 3
022835KP [36H x 19W x 12D]	022347KP	023055KP	021378KP – QTY. 3
022825KP [46H x 19W x 12D]	025367KP	023055KP	021378KP – QTY. 3
027563KP [60H x 19W x 12D]	026438KP	023055KP	021378KP – QTY. 5
022840KP [28H x 25W x 12D]	022348KP	023056KP	021379KP – QTY. 3
022834KP [36H x 25W x 12D]	022347KP	023056KP	021379KP – QTY. 3
022824KP [46H x 25W x 12D]	025367KP	023056KP	021379KP – QTY. 3
027564KP [60H x 25W x 12D]	026438KP	023056KP	021379KP – QTY. 5
022839KP [28H x 31W x 12D]	022348KP	023057KP	021380KP – QTY. 3
022833KP [36H x 31W x 12D]	022347KP	023057KP	021380KP – QTY. 3
022823KP [46H x 31W x 12D]	025367KP	023057KP	021380KP – QTY. 3
027565KP [60H x 31W x 12D]	026438KP	023057KP	021380KP – QTY. 5
022838KP [28H x 37W x 12D]	022348KP	023058KP	021381KP – QTY. 3
022832KP [36H x 37W x 12D]	022347KP	023058KP	021381KP – QTY. 3
022822KP [46H x 37W x 12D]	025367KP	023058KP	021381KP – QTY. 3
027566KP [60H x 37W x 12D]	026438KP	023058KP	021381KP – QTY. 5
022837KP [28H x 43W x 12D]	022348KP	023059KP	021382KP – QTY. 3
022831KP [36H x 43W x 12D]	022347KP	023059KP	021382KP – QTY. 3
022821KP [46H x 43W x 12D]	025367KP	023059KP	021382KP – QTY. 3
027567KP [60H x 43W x 12D]	026438KP	023059KP	021382KP – QTY. 5

<b>SHELVING MODULE</b>	<b>UPRIGHTS</b> <i>(SET OF 2)</i> ①	<b>FLOOR BRACE</b> ②	<b>METAL SHELF</b> ③
027559KP [28H x 51W x 12D]	022348KP	025680KP	025572KP – QTY. 3
027560KP [36H x 51W x 12D]	022347KP	025680KP	025572KP – QTY. 3
027561KP [46H x 51W x 12D]	025367KP	025680KP	025572KP – QTY. 3
027568KP [60H x 51W x 12D]	026438KP	025680KP	025572KP – QTY. 5
027524KP [36H x 19W x 16D]	022473KP	023055KP	025153KP – QTY. 3
027531KP [60H x 19W x 16D]	026439KP	023055KP	025153KP – QTY. 5
022830KP [36H x 25W x 16D]	022473KP	023056KP	022816KP – QTY. 3
027570KP [60H x 25W x 16D]	026439KP	023056KP	022816KP – QTY. 5
022829KP [36H x 31W x 16D]	022473KP	023057KP	022398KP – QTY. 3
027571KP [60H x 31W x 16D]	026439KP	023057KP	022398KP – QTY. 5
022828KP [36H x 37W x 16D]	022473KP	023058KP	022397KP – QTY. 3
027572KP [60H x 37W x 16D]	026439KP	023058KP	022397KP – QTY. 5
022827KP [36H x 43W x 16D]	022473KP	023059KP	022396KP – QTY. 3
027573KP [60H x 43W x 16D]	026439KP	023059KP	022396KP – QTY. 5
027569KP [36H x 51W x 16D]	022473KP	025680KP	025571KP – QTY. 3
027574KP [60H x 51W x 16D]	026439KP	025680KP	025571KP – QTY. 5

## ATTACHING FLOOR BRACE

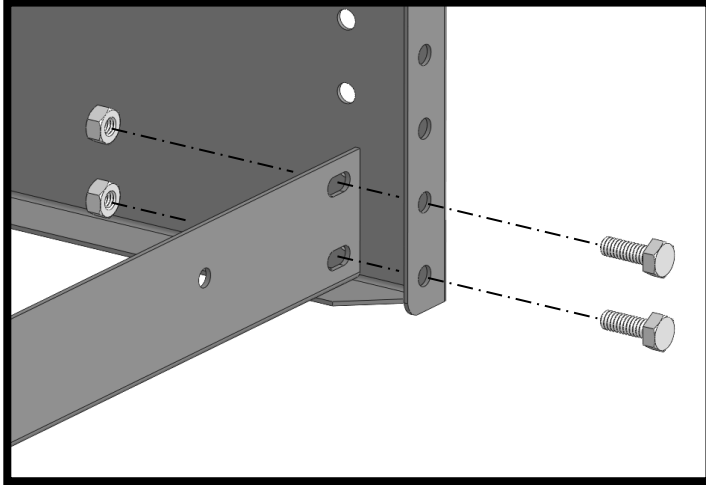

Attach as shown using:  
(4) 1/4-20 x 3/4 Hex Head Screws  
(4) 1/4-20 E-Stop Nuts

**TORQUE SETTING:**  
Size - 1/4 = 7 - 9.5 Ft.-Lbs.

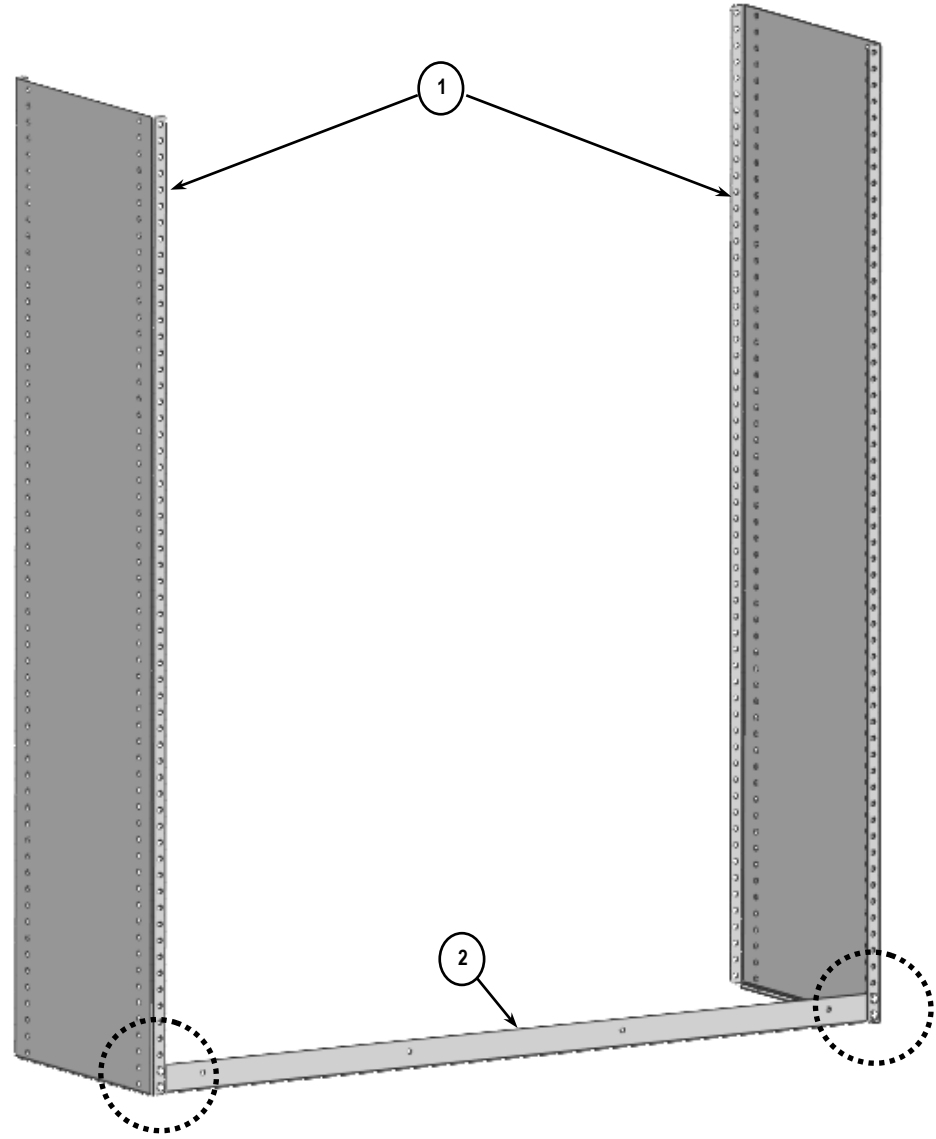

## ATTACHING BOTTOM SHELF

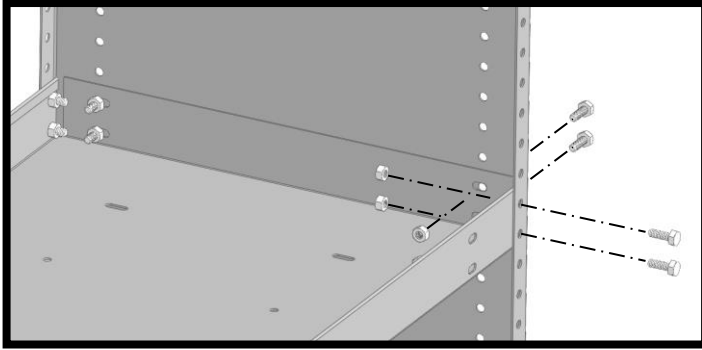

Attach **Heavy Duty Shelves** as shown using:  
(16) 1/4-20 x 3/4 Hex Head Screws  
(16) 1/4-20 E-Stop Nuts

**TORQUE SETTING:**  
Size - 1/4 = 7 - 9.5 Ft.-Lbs.

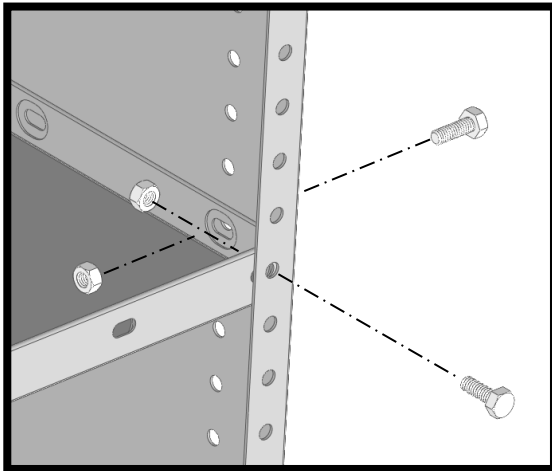

Attach **Standard Shelves** as shown, using:  
(8) 1/4-20 x 3/4 Hex Head Screws  
(8) 1/4-20 E-Stop Nuts

**PER SHELF**

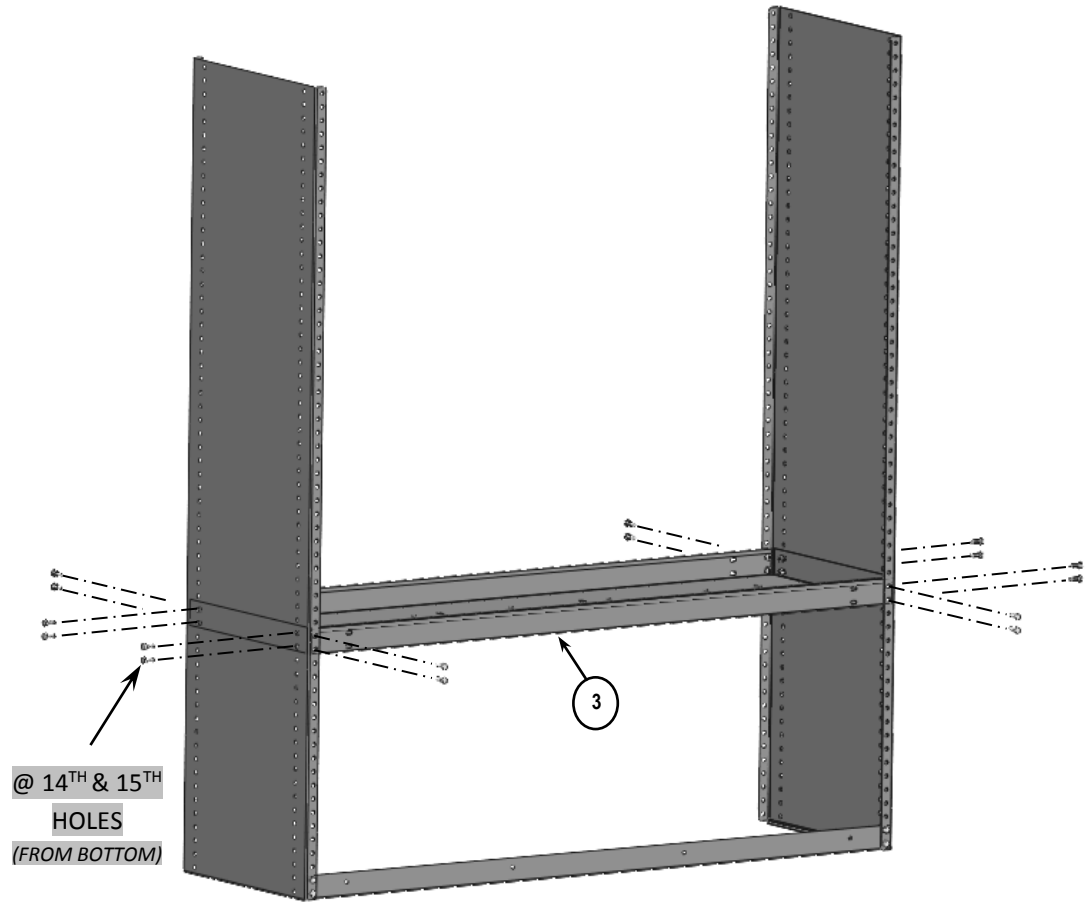

@ 14<sup>TH</sup> & 15<sup>TH</sup>  
HOLES  
(FROM BOTTOM)

## ATTACHING REMAINING SHELVES

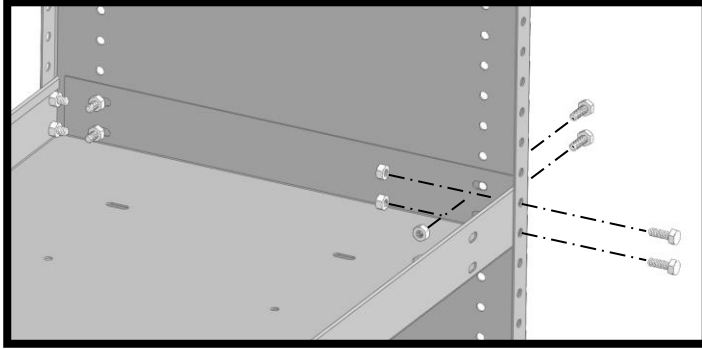

Attach **Heavy Duty Shelves** as shown using:  
(16) 1/4-20 x 3/4 Hex Head Screws  
(16) 1/4-20 E-Stop Nuts

**PER SHELF**

**TORQUE SETTING:**  
Size - 1/4 = 7 - 9.5 Ft.-Lbs.

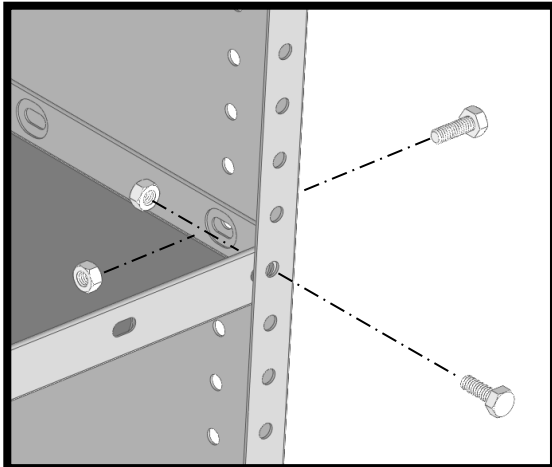

Attach **Standard Shelves** as shown, using:  
(8) 1/4-20 x 3/4 Hex Head Screws  
(8) 1/4-20 E-Stop Nuts

**PER SHELF**

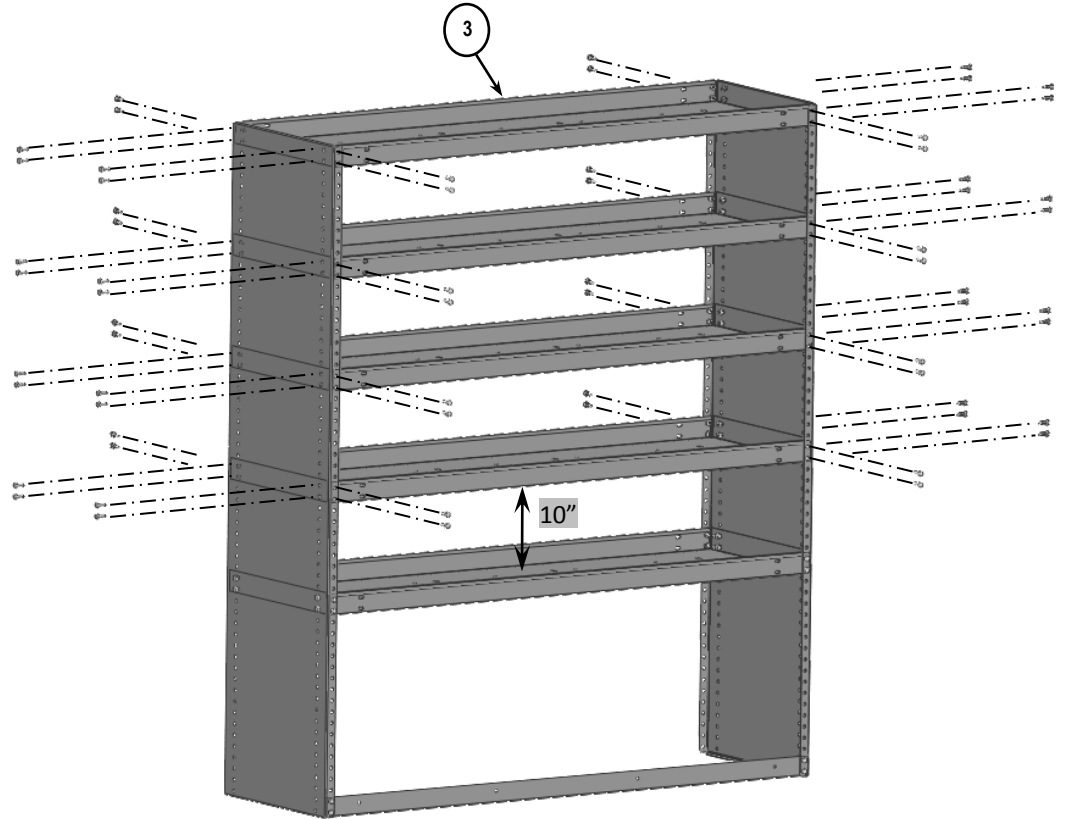

### **NOTE:**

SHELVES ARE ADJUSTABLE TO FIT REQUIRED NEED.  
MOUNTING LOCATIONS SHOWN ARE STANDARD  
MOUNTING LOCATIONS **10 INCHES** APART.



## JOINING MODULES

(TYPICAL)

- Join modules as shown using:  
(2) 1/4-20 x 3/4 Hex Head Screws  
(2) 1/4-20 E-Stop Nuts

PER SHELF

**NOTE: FOR MODULES WITH HEAVY DUTY SHELVES,**

- (4) 1/4-20 x 3/4 Hex Head Screws  
(4) 1/4-20 E-Stop Nuts

PER SHELF

**TORQUE SETTING:**  
Size - 1/4 = 7 - 9.5 Ft.-Lbs.

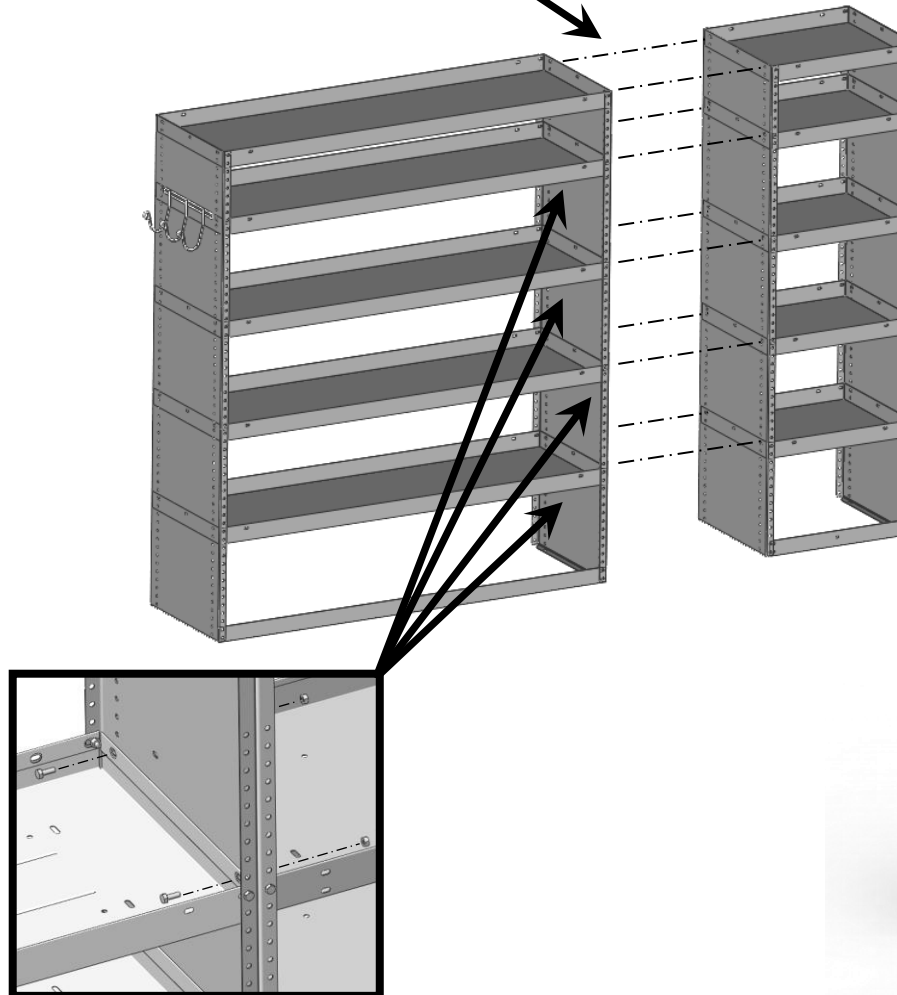
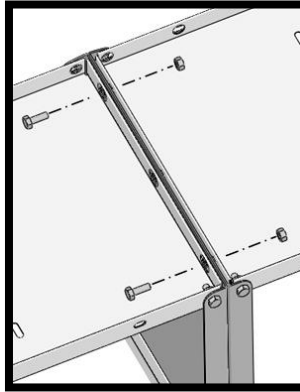

**STANDARD INSTALLATION**

**BEFORE DRILLING**

**STOP** CHECK ALL MOUNTING LOCATIONS TO PREVENT PENETRATING GAS LINES, GAS TANKS, BRAKE LINES, WIRING OR ANY OTHER STRUCTURE OF VEHICLE **STOP**

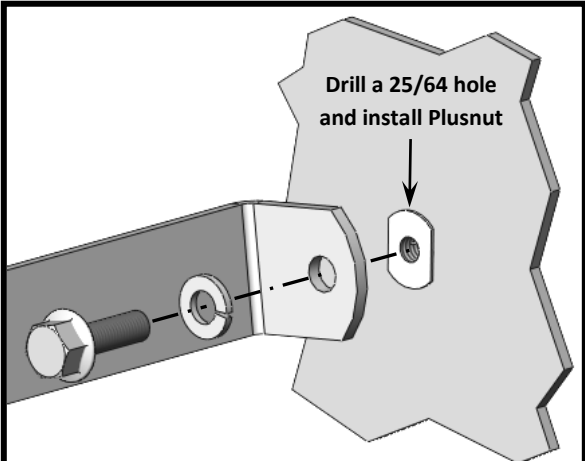

Drill a 25/64 hole and install Plusnut

With module properly positioned in desired location in vehicle, attach brackets loosely at the locations shown. Mark and drill 25/64 holes to install Plusnuts and secure as shown using:

- (1) 1/4-20 x 1 1/4 Hex Head Screws
- (1) 1/4-20 Lock Washer

**AT EACH MOUNTING LOCATON**

**TORQUE SETTING:**  
Size - 1/4 = 7 - 9.5 Ft.-Lbs.

**SPECIAL MOUNTING USED ON 46" MODULES MOUNTED IN THE REARMOST POSITION IN VEHICAL**

**TYPICAL MOUNTING**

**TYPICAL MOUNTING**

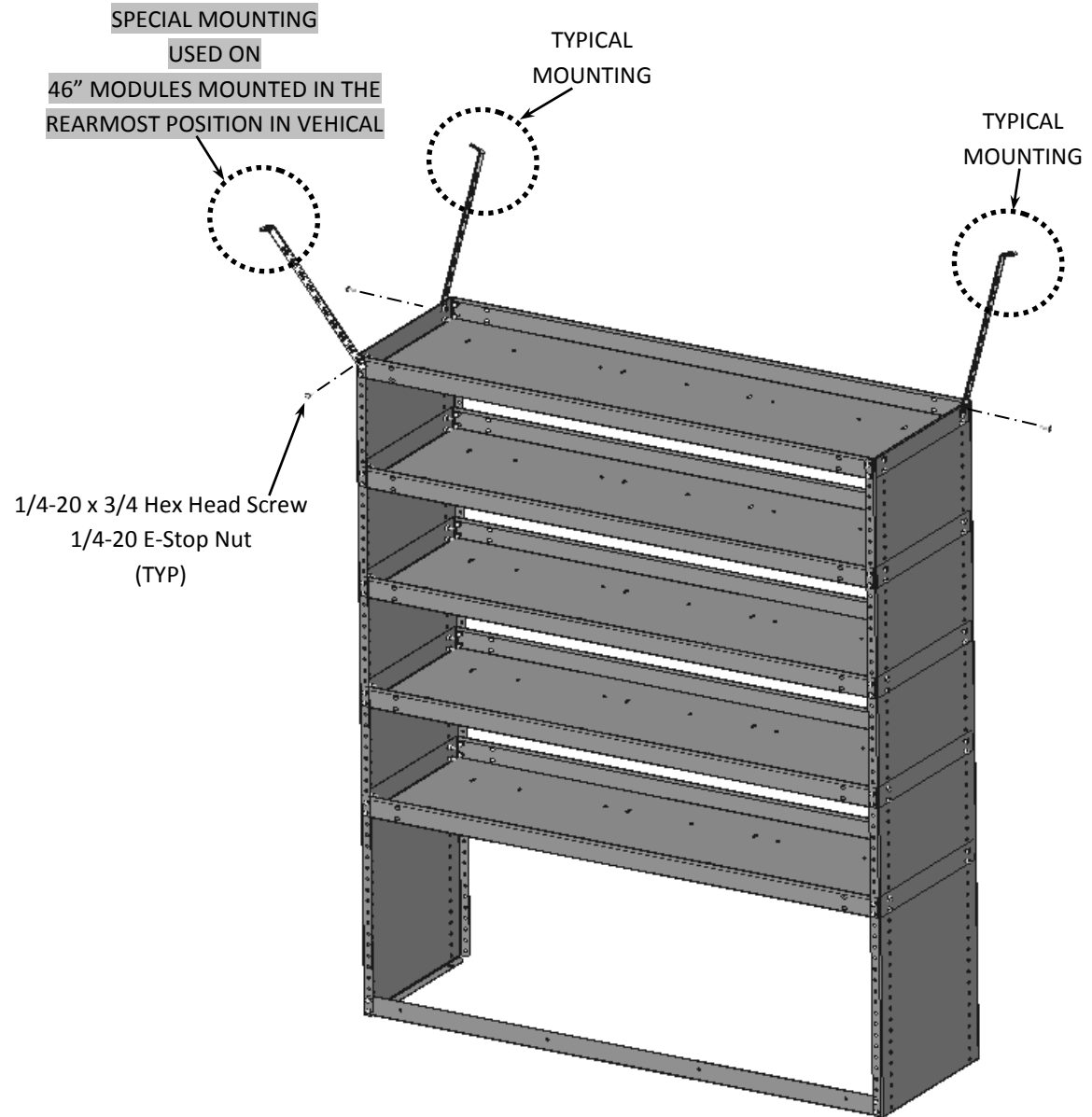

1/4-20 x 3/4 Hex Head Screw  
1/4-20 E-Stop Nut (TYP)

**STANDARD INSTALLATION**

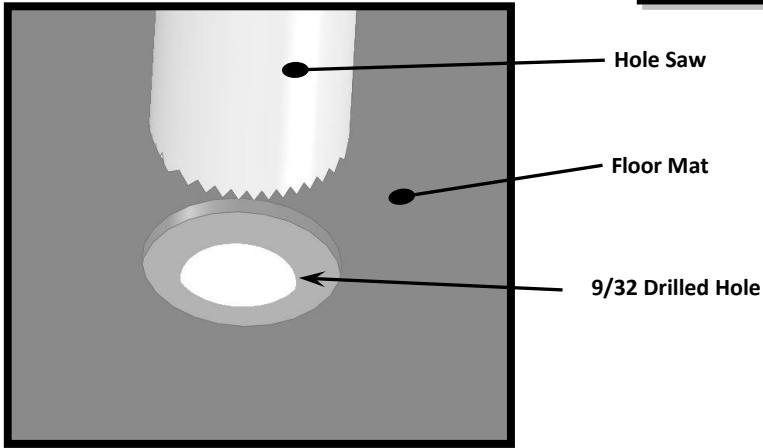

**NOTE:**

Using a 1-1/8" Hole Saw specially made for mat cutting, hole saw out all holes in the mat making sure to align hole saw with pre drilled holes. **Make sure not to drill through the metal floor of the van.** Once drilled clear out each area of excess debris

**BEFORE DRILLING**

**STOP** CHECK ALL MOUNTING LOCATIONS TO PREVENT PENETRATING GAS LINES, GAS TANKS, BRAKE LINES, WIRING OR ANY OTHER STRUCTURE OF VEHICLE **STOP**

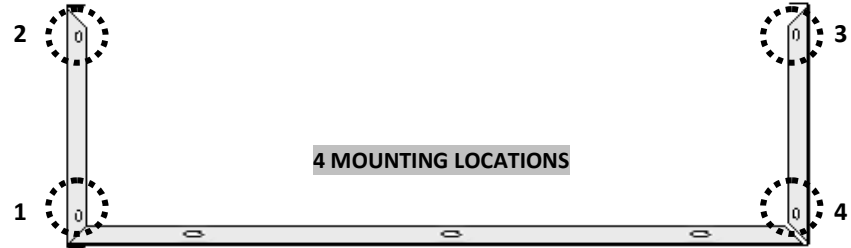

With module properly positioned attach module to floor of vehicle  
Using either method described below.

**NOTE: SPACER ONLY USED WHEN MOUNTING LOCATION FALL IN A VALLEY IN THE FLOOR**

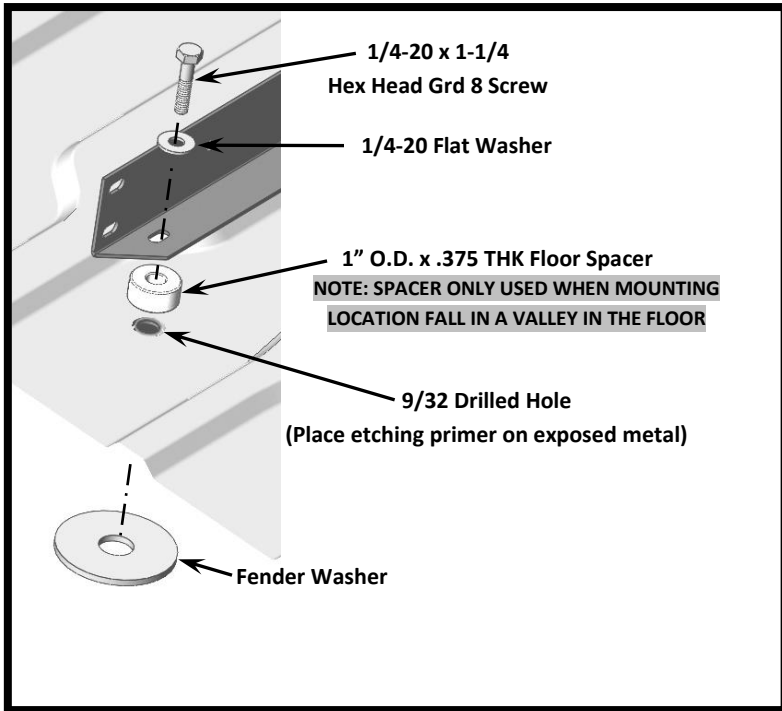

**MOUNTING THROUGH FLOOR**  
**(WHERE SPACE PERMITS UNDER VEHICLE)**

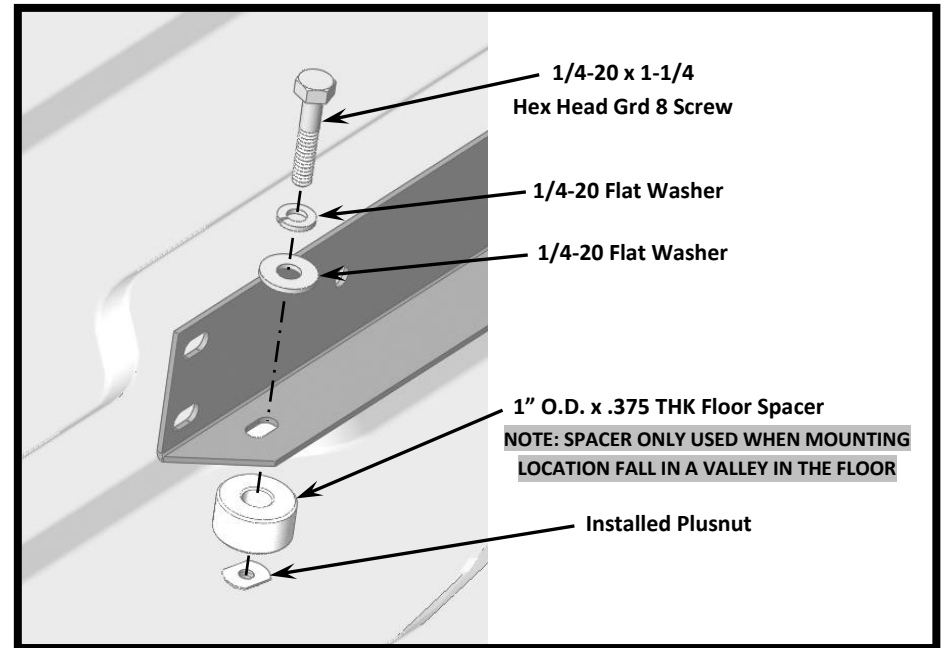

**MOUNTING WITH PLUSNUT**  
**(LIMITED SPACE UNDER VEHICLE)**  
**(SEE PAGE 11 FOR PLUSNUT INSTALLATION)**

**BEFORE DRILLING**

**STOP** **CHECK ALL MOUNTING LOCATIONS TO PREVENT PENETRATING GAS LINES, GAS TANKS, BRAKE LINES, WIRING OR ANY OTHER STRUCTURE OF VEHICLE** **STOP**

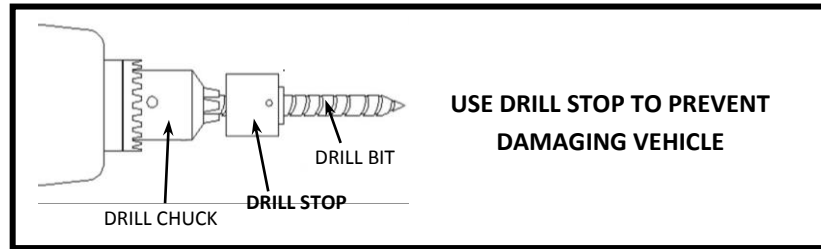

The Plusnut® is pre-bulbed for easy installation

**1**

The Plusnut® is pre-assembled with hex cap and hex bolt. Then it is inserted into a pre-drilled hole

**2**

As the bolt is tightened, the Plusnut® upsets and provides outstanding blind fastening holding power

**3**

C-500 tool tightens bolt thru hex head cap into Plusnut® A ratchet, open-end or closed –end wrench can be used.

**4**

Fully upset Plusnut® provides a reliable nut plate for fastening.

**5**

**CHECK EACH BOLT LOCATION**  
to ensure they are tightened to the specified torque setting.

**TORQUE SETTING:**  
Size – 1/4 GRD 5 = 7- 9.6 Ft.-Lbs.  
Size – 1/4 GRD 8 = 10- 13.5 Ft.-Lbs.