

# Cab Organizer Assembly Instructions



■ **Recommended Tools**



■ **Hardware**

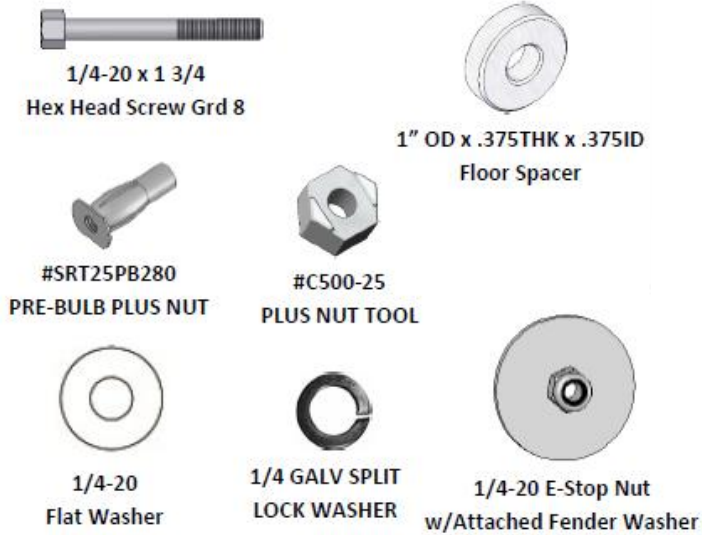

■ **Cab Organizer 021742**



■ **Cab Organizer (For Minivans) 022536**



**■ Mounting Location**

Center the cab organizer between the front seats and at proper distance from partition (refer to chart), and mark (4) mounting hole locations:

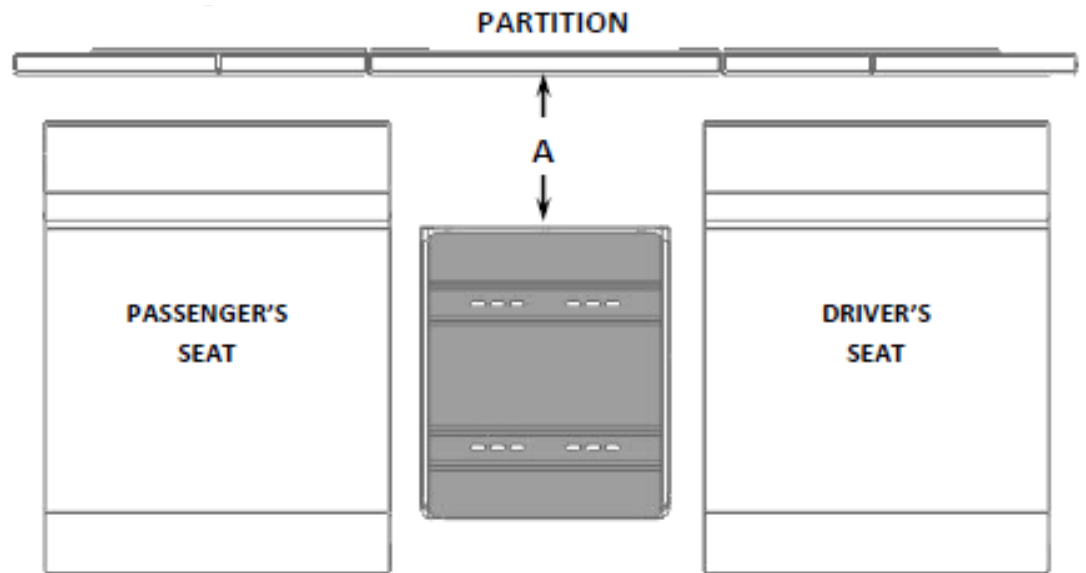
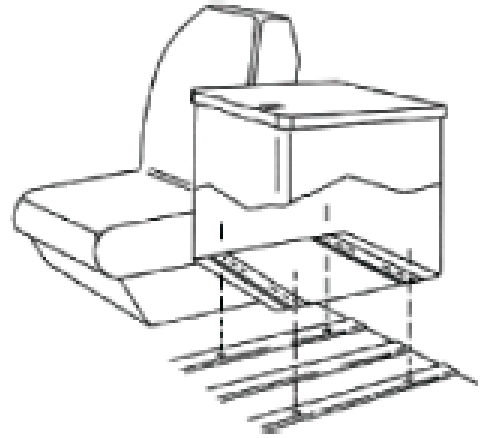
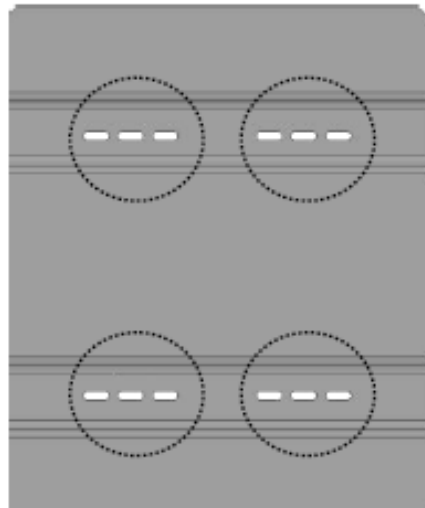

Partition	A=Distance from partition
Steel partition w/ standard setback panels	2.5"
Steel partition w/ 3" setback panels	3"
Steel partition w/ 6" setback panels	4"
Quiet flex partition	2"

■ **Installation Methods**

**Note:** Using a 1-1/8" hole saw specifically made for mat cutting, hole saw out all holes in the mat making sure to align hole saw with pre-drilled holes. **Make sure not to drill through the metal floor of the van.** Once drilled, clear out each area of excess debris.

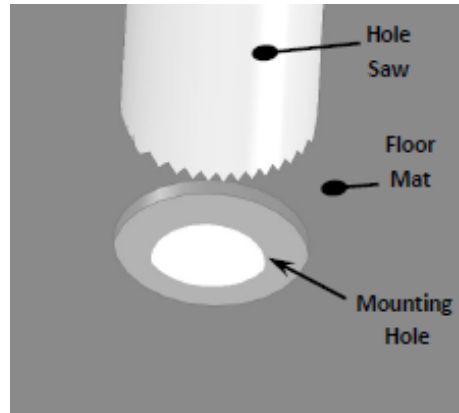

**BEFORE DRILLING - CHECK ALL MOUNTING LOCATIONS TO PREVENT PENETRATING GAS LINES, GAS TANKS, BRAKE LINES, WIRING OR ANY OTHER STRUCTURE OF VEHICLE**

■ **Plusnut**

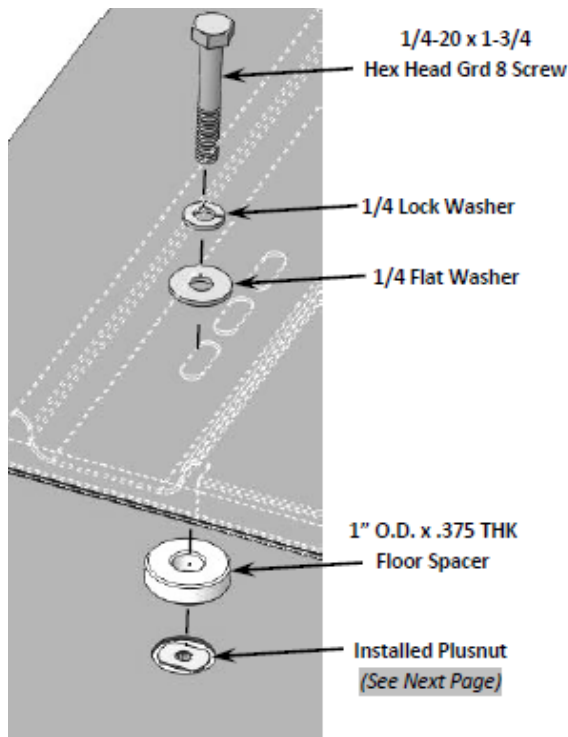

■ **Through Floor**

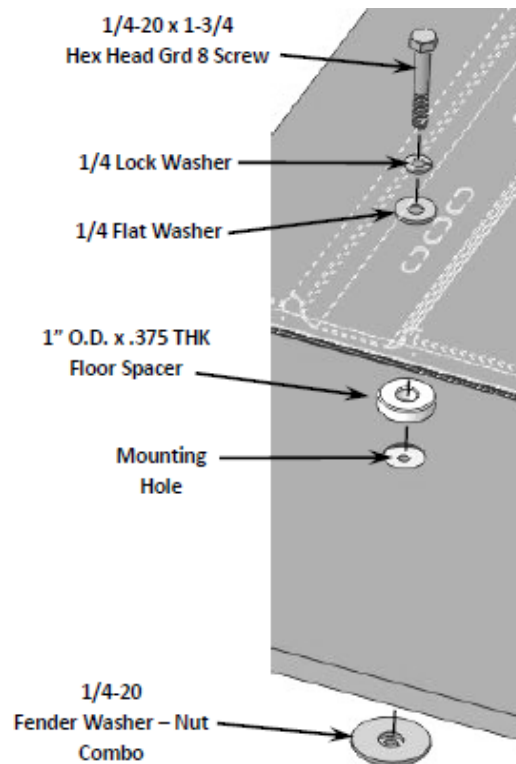

**TORQUE SETTING: Size - 1/4 = 7 - 9.6 Ft. Lbs.**

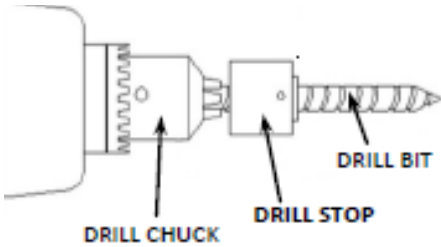

**USE DRILL STOP TO PREVENT  
DAMAGING VEHICLE**

**BEFORE DRILLING - CHECK  
ALL MOUNTING LOCATIONS  
TO PREVENT PENETRATING  
GAS LINES, GAS TANKS, BRAKE  
LINES, WIRING OR ANY OTHER  
STRUCTURE OF VEHICLE**



The Plusnut® is pre-bulbed for easy installation

1



The Plusnut® is pre-assembled with hex cap and hex bolt.  
Then it is inserted into a pre-drilled hole

2

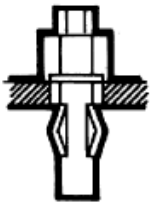

As the bolt is tightened, the Plusnut® upsets  
and provides outstanding  
blind fastening holding power

3



C-500 tool tightens bolt thru hex head cap into Plusnut® A  
ratchet, open-end or closed -end wrench can be used.

4



Fully upset Plusnut® provides  
a reliable nut plate for fastening.

5

■ **Cab Organizer Features**

Your cab organizer will enable you to:

- A.** Lock valuables in a theft resistant box.
- B.** Lift the double-action lid for easy access.
- C.** Slide the double-action forward for a convenient writing surface. A safety latch/ release button is provided.
- D.** Organize papers by using standard “Pendaflex” style hanging folders on the bottom tracks.
- E.** Have safe and easy access to equipment or small items using the upper sliding tray.
- F.** Safeguard against premature lid falling with a counter-balance spring.

