

INSTALLATION INSTRUCTIONS

Recommended Tools

Air or Hand Ratchet



5/16" Combo Wrench



Torque Wrench



5/16" Socket



Drill



Hardware

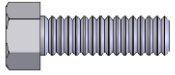

5/16-18 x 1
HHC SCREW



5/16
FLAT WASHER



5/16
E-STOP NUT

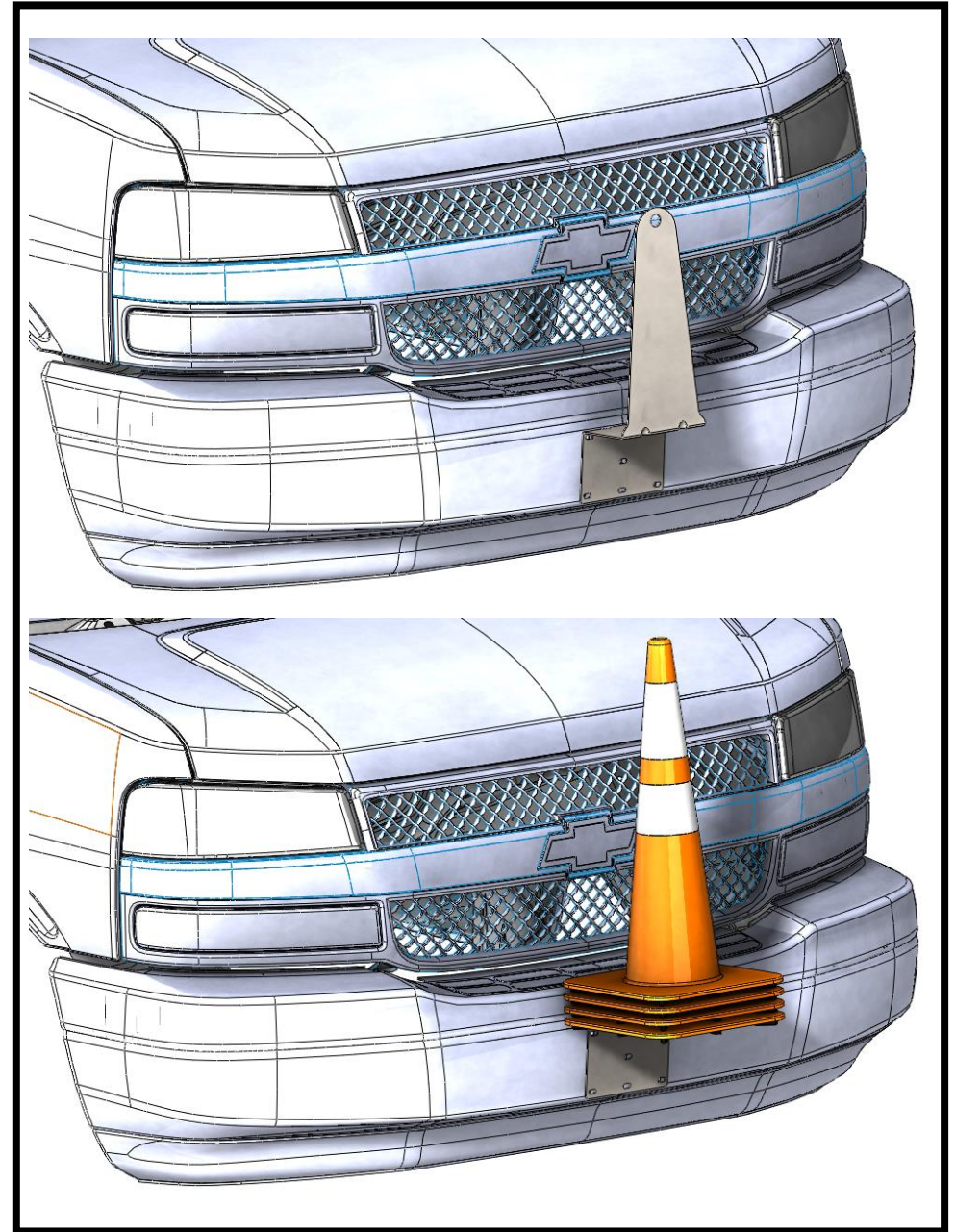

CONE HOLDER

021604KP

ATTACHING CONE HOLDER

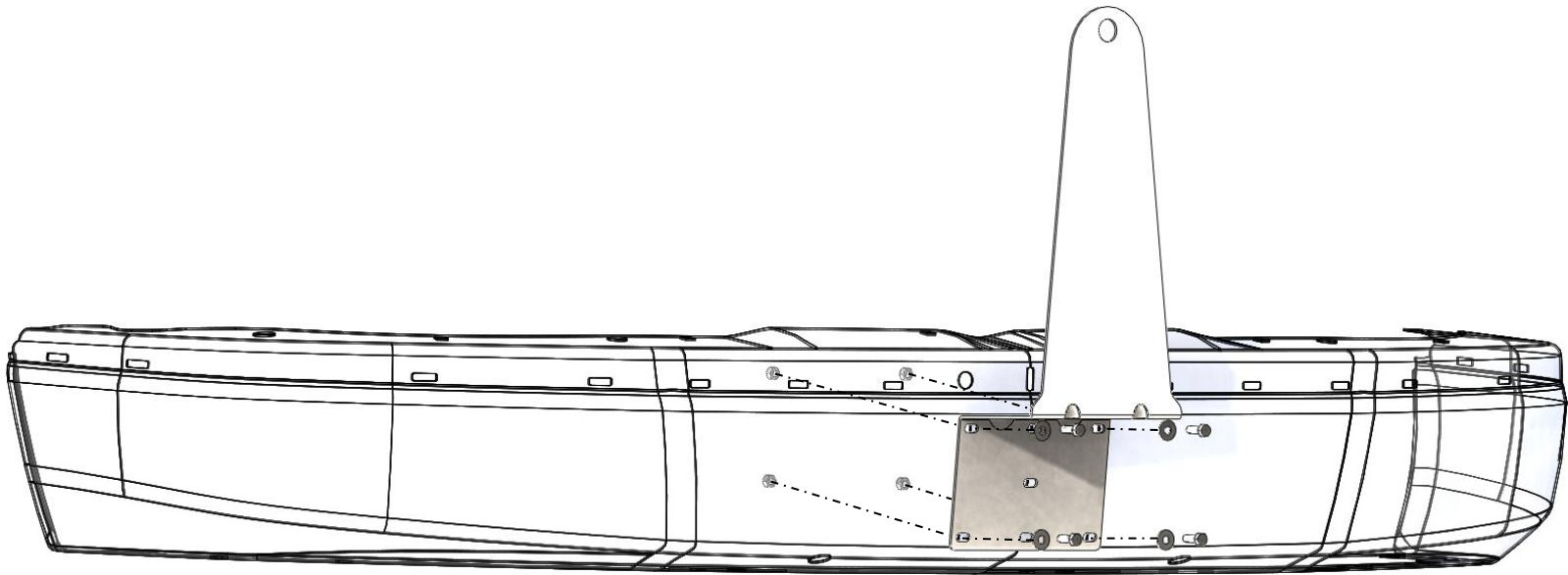

Secure to bumper using:
(4) 5/16 x 1 Hex Head Screws
(4) 5/16 Flat washers
(4) 5/16-18 E-Stop Nuts

TORQUE SETTING:
Size - 5/16= 17 - 24 Ft.-Lbs.