



#22020, 22030, 22035, 22050, 22060, 22065

Chevy Small Block Double Serpentine Kit Long Water Pump

#22021, 22031, 22051, 22061 Deluxe Kits (w/o Alt Fan, W/P Nose Cover, and A/C Nose Cover)

NOTE: Bracket shown in instructions are of our Deluxe Style Kit. Installation is the same for your Ultra Style Brackets

NOTE: Power Steering unit is a 1971 Impala style Keyway pump or 1977 Camaro V-8 Press-fit pump, you should have a 3/8" tap hole at the 6 O'clock both on the front and the rear of the unit. If you have a stud on the rear of the pump remove it.

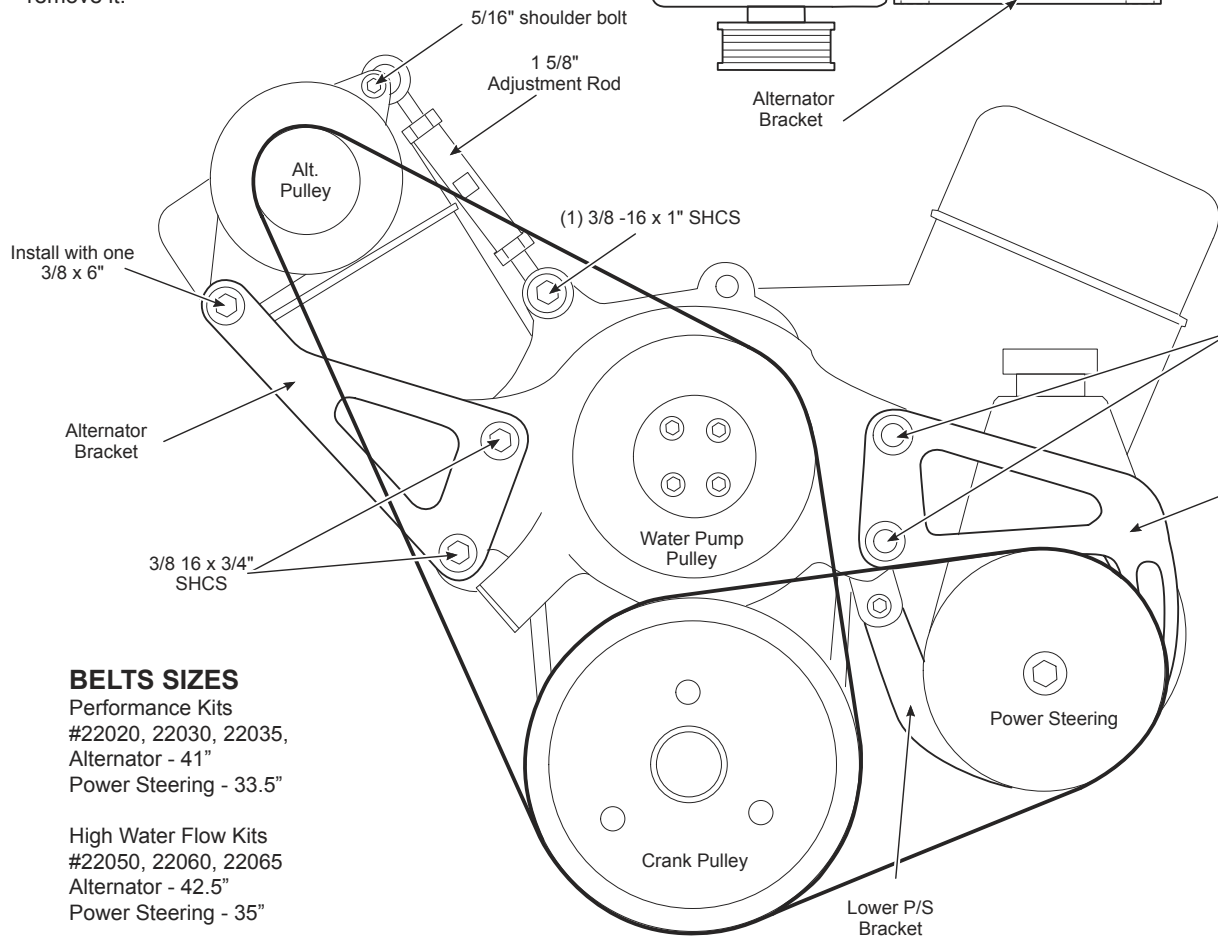
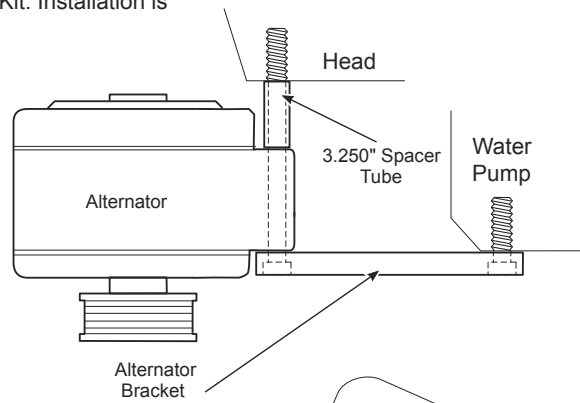

BELTS SIZES

Performance Kits
 #22020, 22030, 22035,
 Alternator - 41"
 Power Steering - 33.5"

High Water Flow Kits
 #22050, 22060, 22065
 Alternator - 42.5"
 Power Steering - 35"

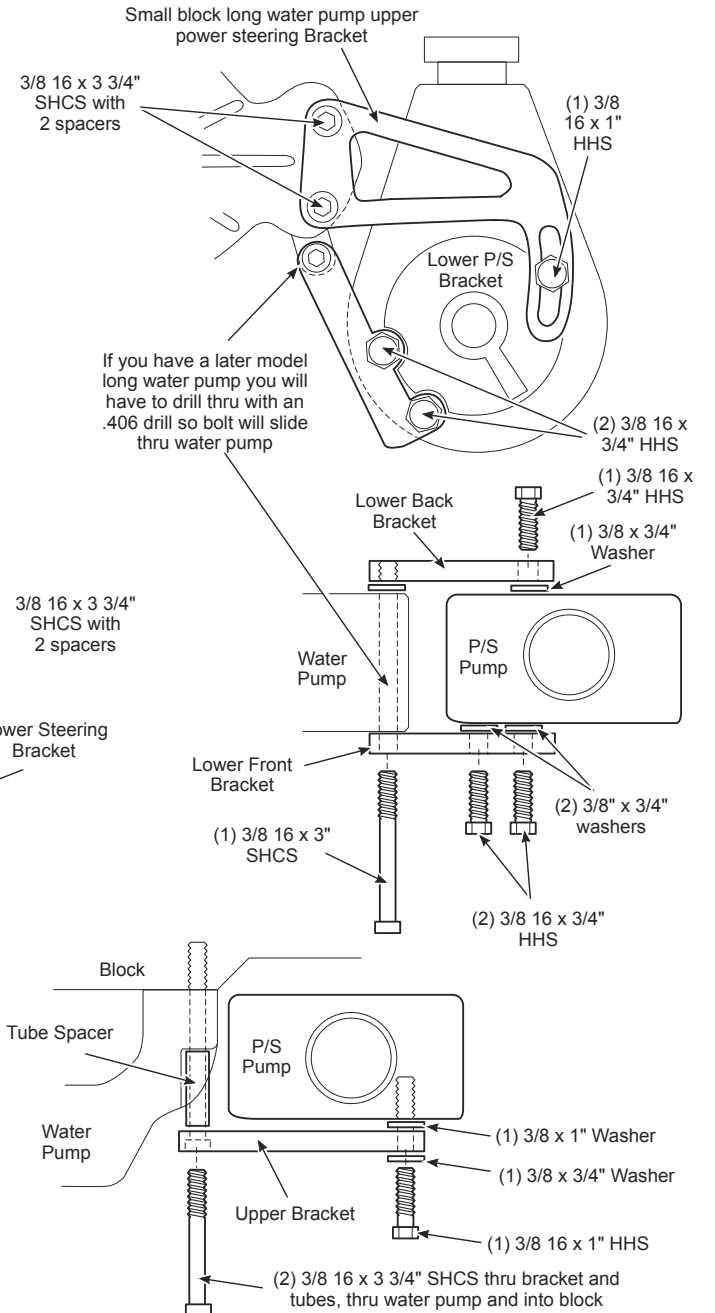



Kits# 22070 22080 22085 Chevy Small Block Double Serpentine Kit Long Water Pump

NOTE: Bracket shown in instructions are of our Deluxe Style Kit. Installation is the same for your Ultra Style Brackets

NOTE: Power Steering unit is a 1971 Impala style Keyway pump or 1977 Camaro V-8 Press-fit pump, you should have a 3/8" tap hole at the 6 O'clock both on the front and the rear of the unit. If you have a stud on the rear of the pump remove it.

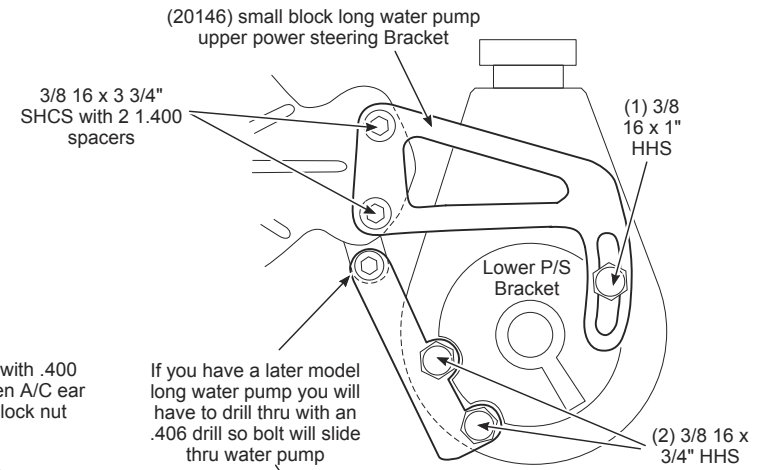
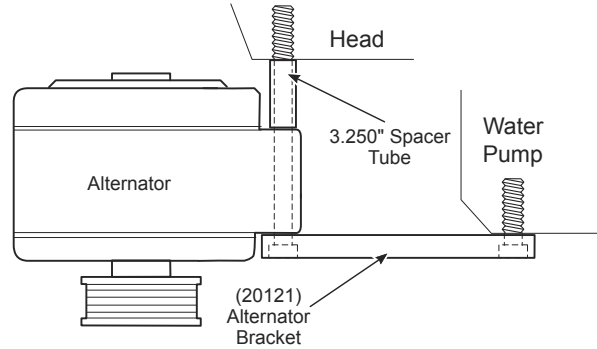

If you have a later model long water pump you will have to drill thru with an .406 drill so bolt will slide thru water pump

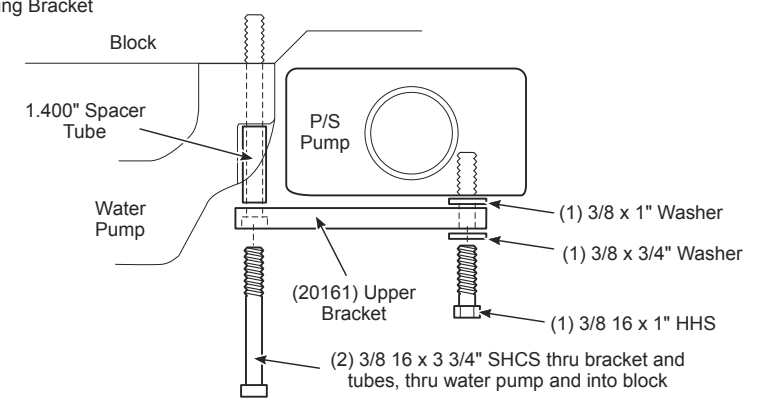
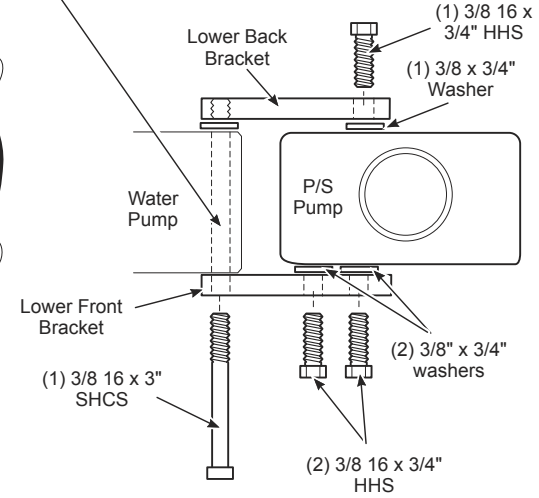
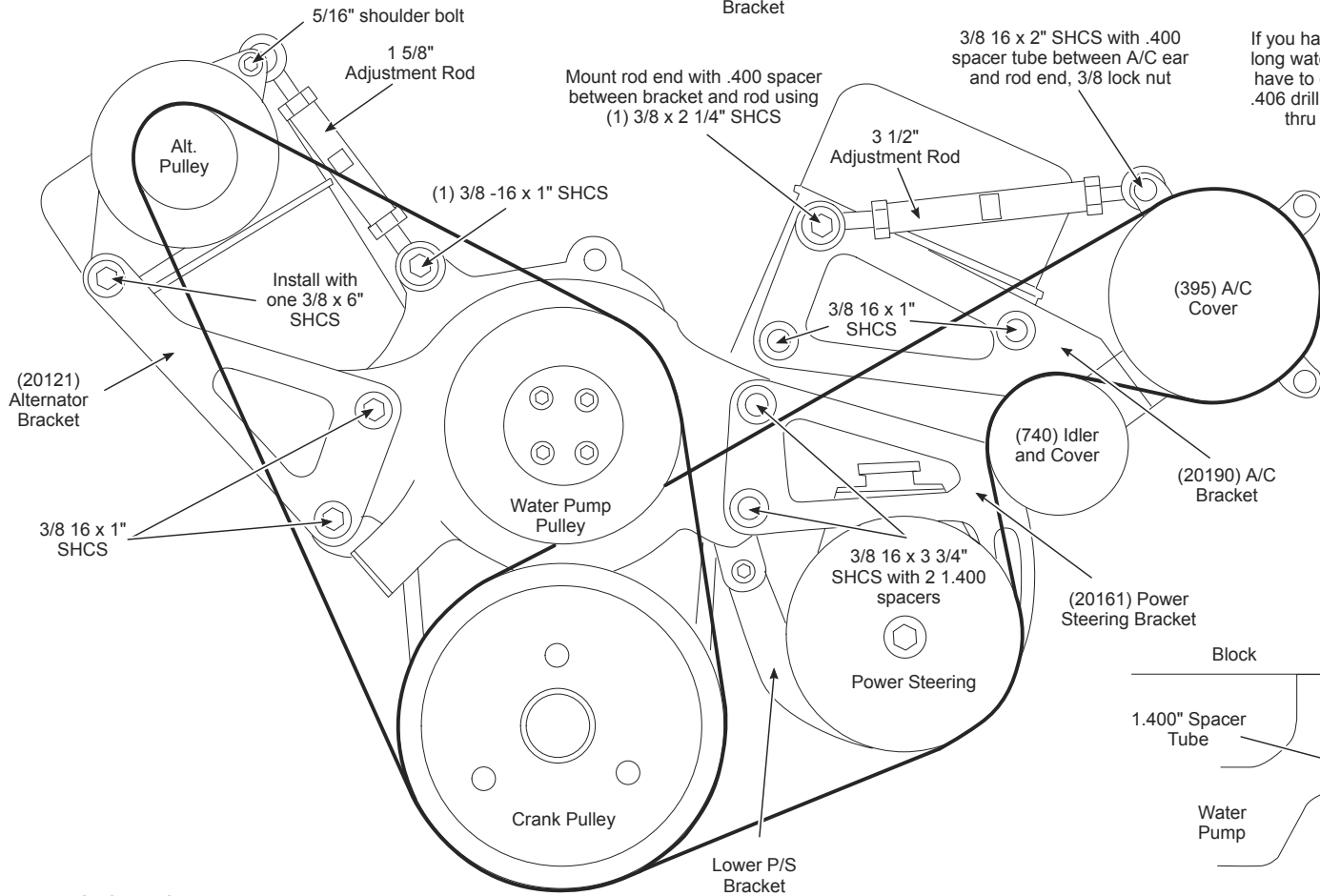

BELTS FOR KITS

Dayco 5060425 for Alternator and Water Pump
Dayco 5060560 for A/C and Power Steering

CHEVY SMALL BLOCK MID MOUNT KIT

A/C belt = 61" P/S belt = 35"

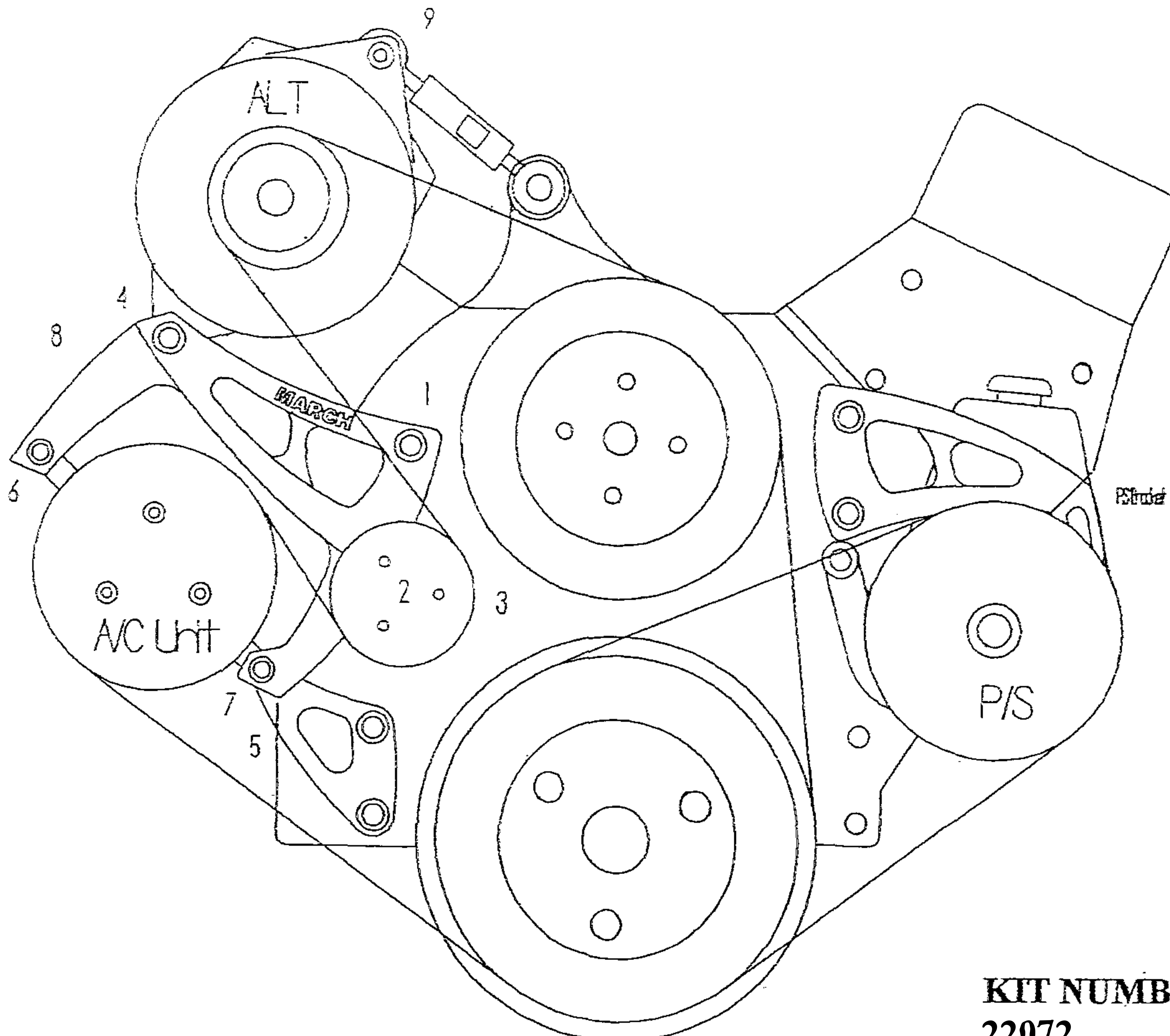

CHEVY SMALL BLOCK KIT

KIT NUMBERS

22072

22082

22087

Mounting of Alt / AC Bracket

- 1 Mount Bracket to Water Pump using 1 3/8x1" socket cap bolt and a 3/8 x 3/4" socket cap (lower Counter bore) (do NOT lock at this time)
- 2 Mount Idler Pulley to Main Bracket using 1 3/8 x 1 3/4" hex bolt and 3/8 washer
- 3 Mount Cap on Idler Bracket
- 4 Mount Alt to Bracket using a 3/8 x 6" socket cap and a 3 250 spacer between alt and the head
- 5 Mount Lower A/C support Bracket to the face of the block as shown using (2) 3/8x 2 1/4" socket caps Space from the block using (2) 1 400 steel spacers
- 6 Mount A/C unit to the main bracket using (2) 8mm socket caps
- 7 Line up your rear support bracket and install a 5/16x 1 1/2" socket cap thru the front face of the lower bracket in the rear support of the A/C unit
- 8 Torque bolts at this time leaving the 6" socket cap for last after installing belt
- 9 Install rod on Alt at this time using the 5/16 shoulder bolt (Alt side) and to your waerpump with a 3/8x 1" socket cap

If using power steering bracket Pt # 20160 or 20165 use instructions with bracket

NOTE) If mounting P/S install P/S bracket before adding your alt/ac belt

(P/S drive belt goes to the rear se p)