

MALONE®

CHANGING THE WAY YOU GET THERE

VersaRail™

UNIVERSAL CROSS BAR SYSTEM



Important Notes: Make sure your vehicle roof is clean from any dust and dirt before installing. This product May Not be Suitable for use on vehicles that are fitted with side curtain or overhead airbags. The straps can prohibit the airbags from deploying properly. Moisture can potentially wick down nylon strapping when wet and into vehicle. Crossbars must be at least 24" apart for safe transport. Do not tamper with load strap and/or buckle while in transit.

Installation & Loading Instructions - Please Read Before Beginning

IMPORTANT WARNING: All vehicular transports are potentially hazardous. Any person(s) using Malone products are personally responsible for following the given directions for use and/or installation and accepts full responsibility for any and all damages or injury of any kind including death, which may result from their use and/or installation.

It is critical that all Malone racks and accessories be properly and securely attached to your vehicle. Improper attachment could result in a serious accident, and could cause serious bodily injury or death to you or to others. You are responsible for securing the racks and accessories to your car, checking the attachment's prior to use, and periodically inspecting the products for adjustment, wear, and damage.

You must read and understand all of the instructions and cautions supplied with your Malone products(s) prior to installation or use. If you do not understand all of the instructions and cautions, or, if you have no mechanical experience and are not thoroughly familiar with the installation procedures, you should have the product installed by a professional installer.



WARNING



Rain water can potentially run down wet straps
and leak into vehicle.

This is not a permanent rack system
and should be removed from vehicle after each use.

MALONE[®]

CHANGING THE WAY YOU GET THERE

VersaRail[™]

UNIVERSAL CROSS BAR SYSTEM

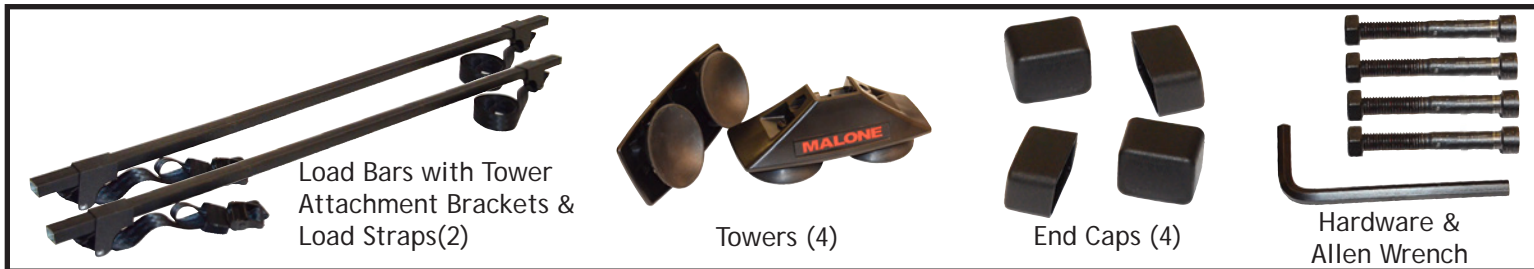

Load Bars with Tower Attachment Brackets & Load Straps(2)

Towers (4)

End Caps (4)

Hardware & Allen Wrench

Assembly & Use Instructions - Please Read Before Beginning

FOR USE WITH BARE ROOFED VEHICLES

Assembling The Cross Bars

- Insert the tower attachment bracket into the top of the tower as pictured in figure 1.



•

- Capture the nylon lock nut in the hex shaped hole of the tower. See Figure 2

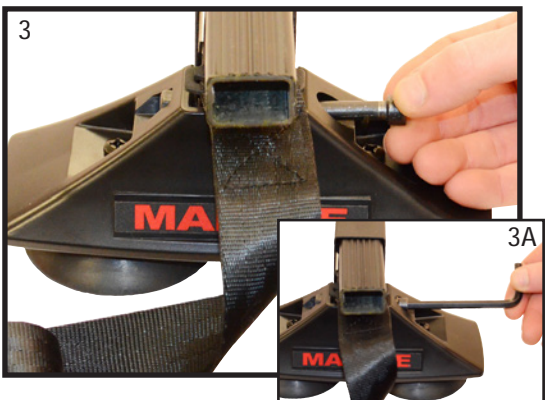

- Insert Allen bolt into the remaining round hole and secure with provided wrench. Do not over tighten. See Figures 3 & 3A

- Add the end caps to cross bars. Push firmly to secure. See Figure 4. Repeat steps 1 thru 4 to complete remaining 3 towers.

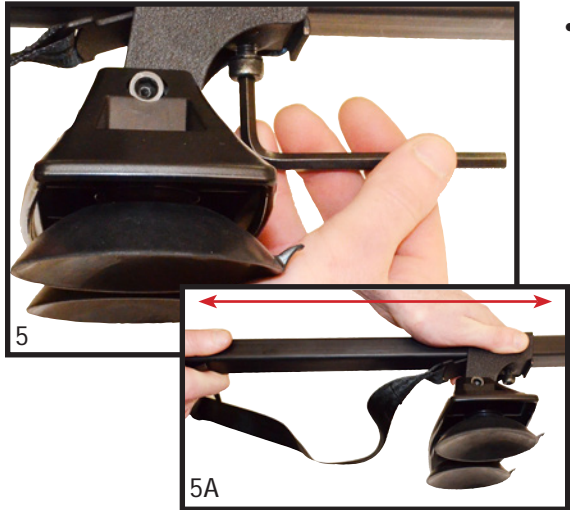

- With assembly complete, loosen the towers set screw on the underside of the tower attachment bracket. This will allow the tower to slide along the cross bar so we can fit it to the vehicle's width. NOTE: We will tighten this screw after fitting the vehicle. See Figures 5 & 5A

You should now have two(2) completely assembled cross bars ready to install. Review the previous steps if yours does not look like the photo below.



Important Notes: Make sure your vehicle roof is clean from any dust and dirt before installing. This product May Not be **Suitable for use on vehicles that are fitted with side curtain or overhead airbags. The straps can prohibit the airbags from deploying properly.** Moisture can potentially wick down nylon strapping when wet and into vehicle. Crossbars must be at least 24" apart for safe transport. Do not tamper with load strap and/or buckle while in transit.

Mounting The Cross Bars

IMPORTANT: Careful attention should be made to the placement of the towers on the vehicles roof. The preferred placement is right along the edge of the roof, at it's strongest point. The vacuum cups will act as cushions or pads even if placed over roof ridge lines preventing a full seal. Do Not place towers inwards or on a glass sunroof.

NOTE TOWER POSITION: PLACE TOWERS OVER/ON ROOF- RIDGE LINES FOR PROPER PLACEMENT

WRONG

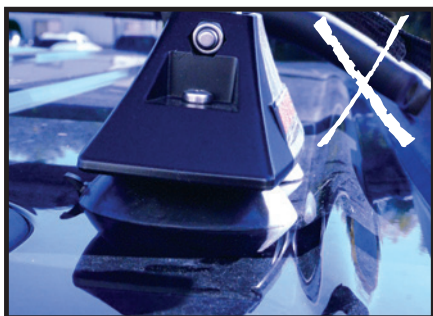

CORRECT



- Open the vehicle's doors and place cross bars in desired location *With the towers placed as to close to the edge as possible.* Measuring at least 24" between them. See Figure 1

- *With the towers placed as to close to the edge as possible,* secure the towers by firmly pressing them downwards securing them to the roof. See Figures 2 & 2A

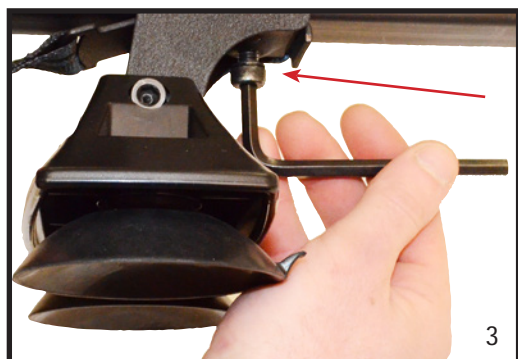
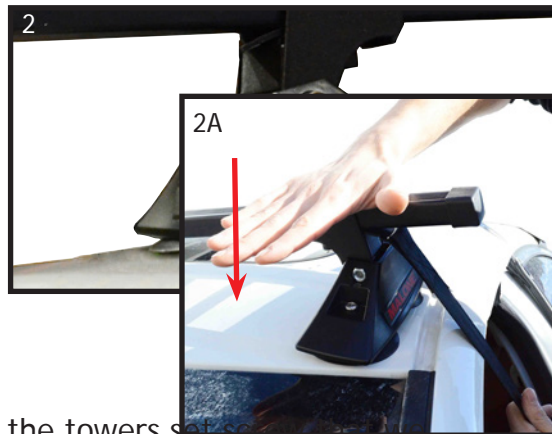

- Go back and fully tightening the towers set screw that was loosened in step 5 of the assembly. See Figure 3

- Dress the load strap through the vehicle, and into the large cam buckle. Pulling firmly to tighten. See Figure 4



- Neatly fold up any leftover strapping and secure with hook and loop enclosure. See Figure 5



Your VersaRail system is now complete!
Be sure to double check all hardware and straps prior to transport.



Important Notes: Make sure your vehicle roof is clean from any dust and dirt before installing. This product May Not be **Suitable for use on vehicles that are fitted with side curtain or overhead airbags. The strap can prohibit the airbags from deploying properly.** Moisture can potentially wick down nylon strapping when wet and into vehicle. Crossbars must be at least 24" apart for safe transport. Do not tamper with load strap and/or buckle while in transit.