

2010 Ford Taurus 3.5L SHO Dual Split Rear Exit

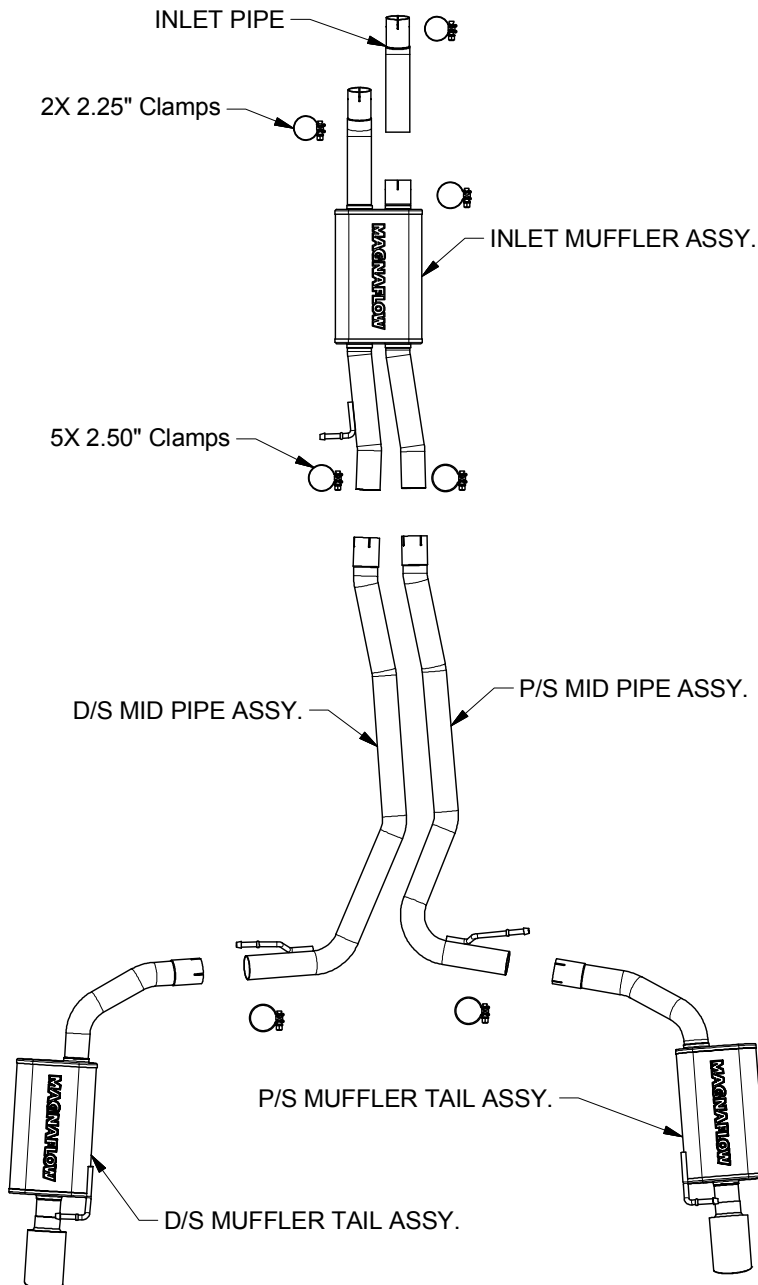

Warning: When working on, under, or around any vehicle exercise caution. Please allow the vehicle's exhaust system to cool before removal, as exhaust system temperatures may cause severe burns. If working without a lift, always consult vehicle manual for correct lifting specifications. Always wear safety glasses and ensure a safe work area. Serious injury or death could occur if safety measures are not followed.

Step 1: (Carefully read all instructions before installation) Start the removal process of the OEM exhaust system. First measure and cut both OEM inlet pipes 4.75" rearward of the catalytic converter. Working front to rear carefully remove all hangers from the rubber isolators and remove the system.

Step 2: Begin the installation of your new MAGNAFLOW Performance Exhaust System by first laying out all components to check content and orientation. Slip the inlet of the Inlet Pipe over the passenger side outlet pipe from the catalytic converter that you have cut. Loosely secure using the supplied clamp. Next slip the inlets of the Inlet Muffler Assembly over the cut inlet pipe and the new Inlet Pipe. Loosely secure using the supplied clamps. Mount both Mid Pipe Assemblies by slipping each inlet over the Inlet Muffler Assemblies outlet pipes. Locate hangers into rubber isolators and loosely secure using the supplied clamps. Mount both Tail Pipe Muffler Assemblies by slipping each inlet over the Mid Pipe Assemblies outlet pipes. Locate hangers into rubber isolators and loosely secure using the supplied clamps.

Step 3: With all components mounted loosely, adjust the system for overall aesthetics and clearance of frame & bodywork. (MAGNAFLOW recommends at least 1/2" of clearance between the exhaust system and any body panels to prevent heat-related body damage or fire.)

Step 4: Once a final position has been chosen for the new system, evenly tighten all fasteners from front to rear. The supplied band clamps must be VERY tight to properly align the pipes and prevent leaks (Approximately 65ft-lbs). U-bolt clamps should be tightened to approximately 30-35ft-lbs. Inspect all fasteners after 25-50 miles of operation and retighten if necessary.

**** Magnaflow Performance Exhaust recommends professional installation on all their products**